

F.A.I. RTE.	SECTION	COUNTY	TOTAL SHEETS	SHEET NO.
57	.	ALEXANDER	22	1

02-(1,1-1,1-2,1-3)RS-1

STATE OF ILLINOIS
DEPARTMENT OF TRANSPORTATION
DIVISION OF HIGHWAYS

**PROPOSED
INTERSTATE HIGHWAY PLANS**

F.A.I. ROUTE 57 (I-57)
SECTION 02-(1, 1-1, 1-2, 1-3)RS-1

ALEXANDER COUNTY
C-99-017-05

D-99-011-05

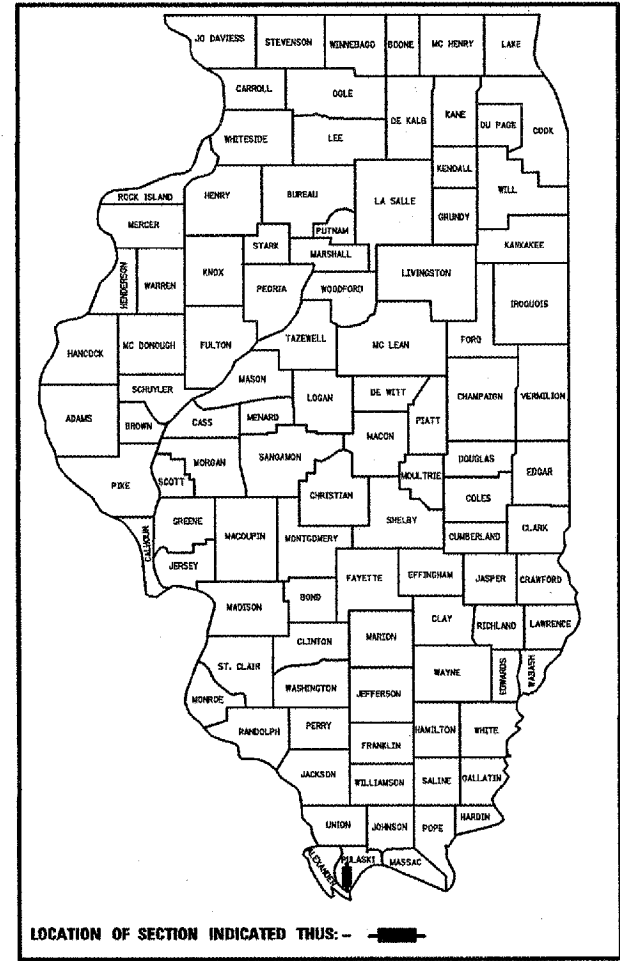

LOCATION OF SECTION INDICATED THUS: -

FOR INDEX OF SHEETS, SEE SHEET NO. 2
FOR SUMMARY OF QUANTITIES, SEE SHEET NO. 4

STATION EQUATIONS

- EQ. STA. 1019+23.07 BK.(C MEDIAN) = STA. 1017A+42.64 AH. (C MEDIAN)
- EQ. STA. 1020A+00.0 BK.(C MEDIAN)= STA. 1020+00.0 AH. (C MEDIAN)
- EQ. STA. 1083+00.00 BK.(C MEDIAN)= STA. 1083+00.00 AH. (C NBL & C SBL)
- EQ. STA. 1134+12.70 BK.(C SBL) & STA. 1134+36.20 BK. (C NBL) = STA. 1134+24.45 AH. (C MEDIAN)

TRAFFIC DATA

- I-57 TRAFFIC DATA
- 2005 ADT = 10,500 WITH 47% TRUCKS
- PV = 5600
- SU = 600
- MU = 4300

TOWNSHIPS

- CACHE NO. 1
- CACHE NO. 2

STRUCTURES TO BE OMITTED:

- S.N. 002-0001 - N.B. STA. 965+84
- S.N. 002-0002 - S.B. STA. 965+84
- S.N. 002-0023 - N.B. STA. 1089+22.46 TO STA. 1120+11.74
- S.N. 002-0024 - S.B. STA. 1089+37.39 TO STA. 1120+11.74
- S.N. 002-0025 - RAILROAD OVERPASS STA. 1030+85.86

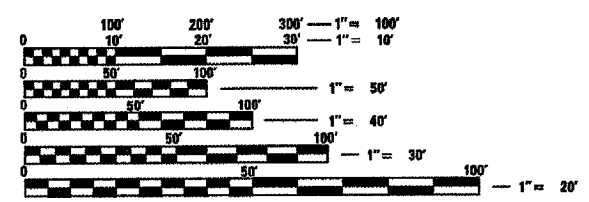
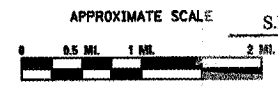
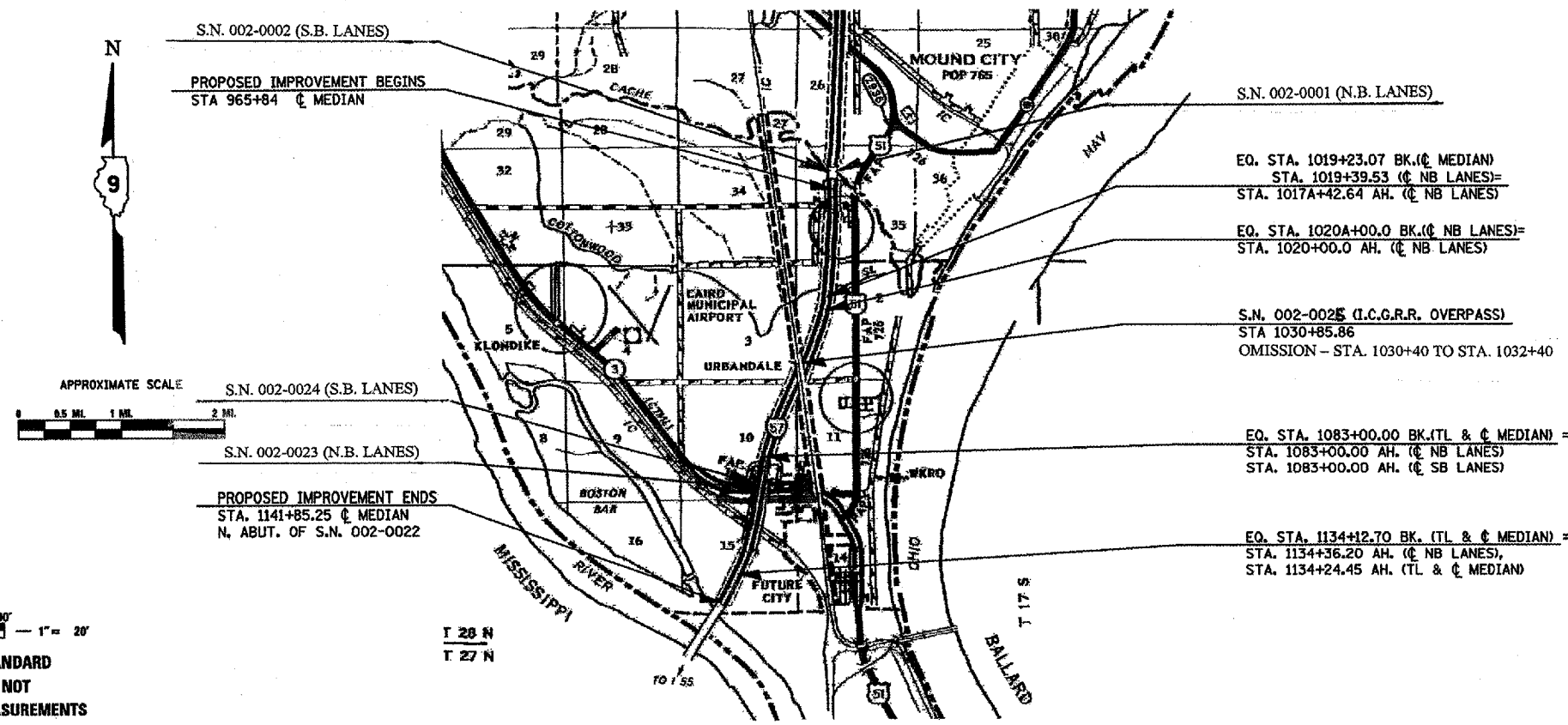

FULL SIZE PLANS HAVE BEEN PREPARED USING STANDARD ENGINEERING SCALES. REDUCED SIZED PLANS WILL NOT CONFORM TO STANDARD SCALES. IN MAKING MEASUREMENTS ON REDUCED PLANS, THE ABOVE SCALES MAY BE USED.

J.U.L.I.E.
JOINT UTILITY LOCATION INFORMATION FOR EXCAVATION
1-800-892-0123 or www.julie1call.com

GROSS LENGTH OF PROJECT = 17,770 FT = 3.36 MILES (SB)
17,775 FT = 3.37 MILES (NB)

NET LENGTH OF PROJECT = 14,695 FT = 2.78 MILES (SB)
14,685 FT = 2.78 MILES (NB)

STATE OF ILLINOIS
DEPARTMENT OF TRANSPORTATION
DIVISION OF HIGHWAYS

SUBMITTED April 2 2007
May 11 2007
May 11 2007
May 11 2007

DEPUTY DIRECTOR OF HIGHWAYS, REGION ENGINEER
ENGINEER OF DESIGN AND ENVIRONMENT
DIRECTOR OF HIGHWAYS, CHIEF ENGINEER

**PRINTED BY THE AUTHORITY
OF THE STATE OF ILLINOIS**

PROJECT ENGINEER: CHARLES STEIN
DESIGN TECHNICIAN: KATHI MCCORD
(618)351-5210
(618)351-5291

F.A.I. RTE.	SECTION	COUNTY	TOTAL SHEETS	SHEET NO.
57	02-11.1-1.1-2.1-3RS-1	ALEXANDER	22	2
STA.		TO STA.		
FED. ROAD DIST. NO.	ILLINOIS	FED. AID PROJECT		

Prepared By: *Joe McLaughlin*
DISTRICT STUDIES & PLANS ENGINEER

Examined By: *James Travis Emery*
DISTRICT LAND ACQUISITION ENGINEER

Examined By: *Carrie Nelson*
DISTRICT PROGRAM DEVELOPMENT ENGINEER

Examined By: *Kerim Grammer*
DISTRICT OPERATIONS ENGINEER

Examined By: *Joseph Lynn*
DISTRICT CONSTRUCTION ENGINEER

Examined By: *Bruce Richles*
DISTRICT MATERIALS ENGINEER

Examined By: *Joe Smother*
DISTRICT PROJECT IMPLEMENTATION ENGINEER

Examined By: *Danny Clayton*
ASSISTANT REGIONAL ENGINEER

Approved By: *May C. Lane*
DEPUTY DIRECTOR OF HIGHWAYS, REGION ENGINEER

DATE: *Apr. 2* 20*07*

SIGNATURE BLOCK

F.A.L. RTE.	SECTION	COUNTY	TOTAL SHEETS	SHEET NO.
57	02-03-1,1-2,1-3RS-1	ALEXANDER	22	3
STA.		TO STA.		
FED. ROAD DIST. NO.		ILLINOIS	FED. AID PROJECT	

INDEX OF SHEETS

SHEET NO.	DESCRIPTION
1	COVER SHEET
2	SIGNATURE BLOCK
3	INDEX OF SHEETS, HIGHWAY STANDARDS GENERAL NOTES, MIXTURE REQUIREMENTS
4	SUMMARY OF QUANTITIES
5-6	FAI 57 TYPICAL SECTIONS
7	RAMP AND TRANSITION DETAILS
8-9	SCHEDULES OF QUANTITIES
10-13	PLAN LAYOUT
14	DETAILS: RAILROAD OVERPASS TAPER DETAIL
15-16	DETAILS: RAISED REFLECTIVE PAVEMENT MARKER FOR RAMPS
17	DETAILS: CAIRO INTERCHANGE RAMPS INFORMATION
18	DETAILS: MEDIAN CROSSOVER - STA. 1043+44
19-20	DETAILS: TEMPORARY BITUMINOUS CONCRETE TRANSITIONS; UNEVEN PAVEMENT SIGN; GROOVED PAVEMENT SIGN
21-22	DETAILS: EX. CONTINUOUSLY REINFORCED PCC PAVEMENT STANDARD (FOR INFORMATION ONLY)

ILLINOIS HIGHWAY STANDARDS

001001-01	701411-03
701101-01	701426-02
701400-02	702001-06
701401-03	780001-01
701406-04	781001-02

MISSOURI HIGHWAY STANDARDS
TRAFFIC CONTROL

SHEETS NO. 1 - 10 IN BACK OF PLANS

GENERAL NOTES

FACTORS USED FOR ESTIMATING PLAN QUANTITIES ARE AS FOLLOWS AND SHALL NOT BE USED FOR THE BASIS OF FINAL QUANTITIES:

- ALL BITUMINOUS CONCRETE
2.016 TONS/CU. YD.
- ALL AGGREGATE
2.05 TONS/CU. YD.
- RIPRAP
1.50 TONS/CU. YD.
- BITUMINOUS MATERIALS:
 - ON PAVEMENT
0.09 GAL./SQ. YD.
 - INTERMEDIATE LIFTS (FOG COAT)
0.04 GAL./SQ. YD.
 - ON AGGREGATE SURFACE
0.32 GAL./SQ. YD.
- AGGREGATE (PRIME COAT)
0.0015 TONS/SQ. YD.

THE QUANTITY OF SHORT TERM PAVEMENT MARKING SHOWN IN THE PLANS IS BASED ON APPLICATIONS FOR BITUMINOUS BINDER COURSE AND FOR BITUMINOUS SURFACE COURSE.

THE EXISTING PAVEMENT HAS 22 #5 BARS AT 6.5" CENTERS AND #4 TRANSVERSE BARS AT 4'-0" CENTERS.

THE QUANTITY SHOWN FOR MIXTURE FOR CRACKS, JOINTS AND FLANGEWAYS IS AN ESTIMATE. THE ACTUAL AMOUNT USED WILL BE DETERMINED BY THE ENGINEER.

THE CONTRACTOR SHALL STAMP STATIONING IN THE BITUMINOUS SURFACE AT 300 FT. INTERVALS ON THE OUTSIDE EDGE OF PAVEMENT AND AS DIRECTED BY THE ENGINEER. THE STATION SYMBOL STAMPS USED SHALL BE FURNISHED BY THE CONTRACTOR. THEY SHALL BE 5 1/2 IN. TALL OF A DESIGN APPROVED BY THE ENGINEER, AND SHALL REMAIN THE PROPERTY OF THE CONTRACTOR.

WHEN AT THE END OF A DAY'S OPERATION THE EXPOSED CENTERLINE EDGE IS GREATER THAN 2,000 FT., THE CONTRACTOR SHALL BE REQUIRED TO PAVE IN THE ADJACENT LANE ON THE FOLLOWING WORK DAY. PRIOR TO WINTER SHUTDOWN, RESURFACING ON ADJACENT LANES IS TO BE BROUGHT UP TO THE SAME ELEVATION.

THERE ARE NO AVAILABLE WASTE SITES ON THE EXISTING RIGHT OF WAY WITHING THE PROJECT LIMITS. DISPOSAL WILL BE THE RESPONSIBILITY OF THE CONTRACTOR AND WASTE MUST BE DISPOSED OF IN ACCORDANCE WITH ART. 202.03 OF THE STANDARD SPECIFICATIONS.

SAW CUTS REQUIRED FOR BUTT JOINTS SHALL NOT BE PAID FOR SEPARATELY BUT SHALL BE INCLUDED IN THE COST OF THE BUTT JOINT.

PRIOR TO PLACEMENT OF THE FINAL PAVEMENT MARKINGS, THE RESIDENT ENGINEER SHOULD CONTACT THE BUREAU OF OPERATIONS AND ARRANGE FOR INSPECTION AND APPROVAL OF THE PAVEMENT MARKING LAYOUT.

IN ADDITION TO THE REQUIREMENTS OF ARTICLE 107.16, THE CONTRACTOR SHALL PROTECT THE SURFACE OF ALL BRIDGE DECKS AND BRIDGE APPROACH PAVEMENTS IN A MANNER SATISFACTORY TO THE ENGINEER BEFORE ANY EQUIPMENT IS

ALLOWED TO CROSS THE STRUCTURE. PROTECTION SHALL BE PROVIDED FOR ALL EQUIPMENT AS DEFINED IN ARTICLE 101.16 REGARDLESS IF TRACK MOUNTED OR WHEELED.

EXISTING PIPE UNDERDRAIN OUTLETS IN THE FORESLOPES OR MEDIAN SLOPES SHALL BE PRESERVED AND PROTECTED DURING CONSTRUCTION. ANY DAMAGE TO AN UNDERDRAIN OUTLET RESULTING FROM CONSTRUCTION ACTIVITY SHALL BE REPAIRED AT THE CONTRACTOR'S EXPENSE.

THE CONTRACTOR IS TO CLEAN ALL MEDIAN INLETS OF RIPRAP, GRASS CLIPPINGS, SILT, AND OTHER DEBRIS. THE COST FOR THIS WORK SHALL BE PAID FOR AS PER ARTICLE 109.04(b) OF THE STANDARD SPECIFICATIONS.

PRIOR TO RESURFACING OPERATIONS, ANY VEGETATION PRESENT ON THE EXISTING BITUMINOUS SHOULDERS SHALL BE REMOVED TO THE SATISFACTION OF THE ENGINEER. THIS WORK SHALL BE INCLUDED IN THE COST OF HOT-MIX ASPHALT SHOULDERS.

COMMITMENTS

NONE

MIXTURE REQUIREMENTS

LOCATION(S):	HOT-MIX ASPHALT SURFACE COURSE
MIXTURE USE(S):	POLYMERIZED HOT-MIX ASPHALT SURFACE COURSE, MIX D, N105
AC/PG:	SBS PG76-22
RAPZ (MAX):	0
DESIGN AIR VOIDS:	4.0%, 105 GYRATION DESIGN
MIXTURE COMPOSITION (GRADATION MIXTURE):	IL-9.5 MM OR IL 12.5 MM
FRICITION AGGREGATE:	D SURFACE

LOCATION(S):	HOT-MIX ASPHALT SHOULDERS (TOP LIFT)
MIXTURE USE(S):	HOT-MIX ASPHALT SURFACE COURSE, MIX C, N70
AC/PG:	PG64-22
RAPZ (MAX):	10
DESIGN AIR VOIDS:	4.0%, 70 GYRATION DESIGN
MIXTURE COMPOSITION (GRADATION MIXTURE):	IL-9.5 MM OR IL 12.5 MM
FRICITION AGGREGATE:	C SURFACE

LOCATION(S):	HOT-MIX ASPHALT BINDER COURSE
MIXTURE USE(S):	POLYMERIZED HOT-MIX ASPHALT BINDER COURSE, IL-19.0, N105
AC/PG:	SBS PG76-22
RAPZ (MAX):	0
DESIGN AIR VOIDS:	4.0%, 105 GYRATION DESIGN
MIXTURE COMPOSITION (GRADATION MIXTURE):	IL-19.0
FRICITION AGGREGATE:	NONE

LOCATION(S):	HOT-MIX ASPHALT SHOULDERS (BOTTOM LIFT)
MIXTURE USE(S):	HOT-MIX ASPHALT SHOULDERS
AC/PG:	PG58-22
RAPZ (MAX):	50
DESIGN AIR VOIDS:	2.0%, 30 GYRATION DESIGN
MIXTURE COMPOSITION (GRADATION MIXTURE):	BITUMINOUS AGGREGATE MIXTURE, SUPERPAVE
FRICITION AGGREGATE:	NONE

F.A.I. RTE.	SECTION	COUNTY	TOTAL SHEETS	SHEET NO.
57	02-01-11-21-3MS-1	ALEXANDER	22	4
STA.		TO STA.		
FED. ROAD DIST. NO.	ILLINOIS	FED. AID PROJECT		

SUMMARY OF QUANTITIES

CODE NUMBER	ITEM DESCRIPTION	UNIT	TOTAL QUANTITY	RURAL	
				100% STATE	
				ALEXANDER COUNTY	
				SOUTHBOUND LANES	NORTHBOUND LANES
				1000 QUANTITY	1000 QUANTITY
X0322729	MATERIAL TRANSFER DEVICE	TON	17,652.0	8,645.0	9,007.0
X0325750	PORTABLE CHANGEABLE MESSAGE SIGN	CAL MO	3.0	1.5	1.5
40603550	POLYMERIZED HOT-MIX ASPHALT SURFACE COURSE, MIXTURE "D" N105	TON	7,000.0	3,470.0	3,530.0
40603245	POLYMERIZED HOT-MIX ASPHALT BINDER COURSE, IL-19.0, N105	TON	10,652.0	5,175.0	5,477.0
40600200	BITUMINOUS MATERIALS (PRIME COAT)	TON	7,376.0	3,670.0	3,706.0
40600300	AGGREGATE (PRIME COAT)	TON	126.5	61.2	65.3
40600400	MIXTURE FOR CRACKS, JOINTS AND FLANGWAYS	TON	12.0	6.0	6.0
40600895	CONSTRUCTING TEST STRIP	EACH	2.0	1.0	1.0
40600985	PORTLAND CEMENT CONCRETE SURFACE REMOVAL - BUTT JOINT	SQ YD	1,920.0	960.0	960.0
40600990	TEMPORARY RAMP	SQ YD	396.0	198.0	198.0
44000161	HOT-MIX ASPHALT SURFACE REMOVAL, 3"	SQ YD	5,046.0	2,523.0	2,523.0
44200525	CLASS A PATCHES, TYPE 1, 8 INCH	SQ YD	140.0	47.0	93.0
44200529	CLASS A PATCHES, TYPE 2, 8 INCH	SQ YD	435.0	188.0	247.0
44200533	CLASS A PATCHES, TYPE 3, 8 INCH	SQ YD	98.0	0.0	98.0
44212900	PAVEMENT PATCHING (PARTIAL DEPTH)	SQ YD	265.0	81.0	184.0
44213000	PATCHING REINFORCEMENT	SQ YD	673.0	235.0	438.0
44213200	SAW CUTS	FOOT	4,096.0	1,438.0	2,658.0
48101200	AGGREGATE SHOULDERS, TYPE B	TON	1,350.0	722.0	628.0
48203100	HOT-MIX ASPHALT SHOULDERS	TON	11,118.0	5,530.0	5,588.0
64200105	SHOULDER RUMBLE STRIP	FOOT	58,761.0	29,390.0	29,371.0
67000400	ENGINEER'S FIELD OFFICE, TYPE A	CAL MO	3.0	1.5	1.5
67100100	MOBILIZATION	L SUM	1.0	0.5	0.5
70100420	TRAFFIC CONTROL AND PROTECTION, STANDARD 701411	EACH	1.0	0.5	0.5
70100700	TRAFFIC CONTROL AND PROTECTION, STANDARD 701406	L SUM	1.0	0.5	0.5
70100800	TRAFFIC CONTROL AND PROTECTION, STANDARD 701401	L SUM	1.0	0.5	0.5
70300100	SHORT-TERM PAVEMENT MARKING	FOOT	2,289.0	1,176.0	1,113.0
70300220	TEMPORARY PAVEMENT MARKING - LINE 4"	FOOT	67,299.0	34,590.0	32,709.0
70301000	WORK ZONE PAVEMENT MARKING REMOVAL	SQ FT	23,173.0	11,910.0	11,263.0
* 78000200	THERMOPLASTIC PAVEMENT MARKING - LINE 4"	FOOT	60,148.0	30,916.0	29,232.0
78006110	PREFORMED THERMOPLASTIC PAVEMENT MARKING - LINE 4"	FOOT	7,151.0	3,674.0	3,477.0
* 78100100	RAISED REFLECTIVE PAVEMENT MARKER	EACH	470.0	248.0	222.0
78300200	RAISED REFLECTIVE PAVEMENT MARKER REMOVAL	EACH	470.0	248.0	222.0

* SPECIALTY ITEMS

Rev.

SUMMARY OF QUANTITIES

PLT DATE = 4/12/2007
 FILE NAME = C:\Users\jrburke\Documents\98905.dwg
 PLOT SCALE = 1/8" = 1'-0"
 USER NAME = jrburke

F.A. RTE.	SECTION	COUNTY	TOTAL SHEETS	SHEET NO.
57	02-11-1-1-2-1-3RS-1	ALEXANDER	22	5
STA. TO STA.		FED. ROAD DIST. NO. - ILLINOIS FED. AID PROJECT		

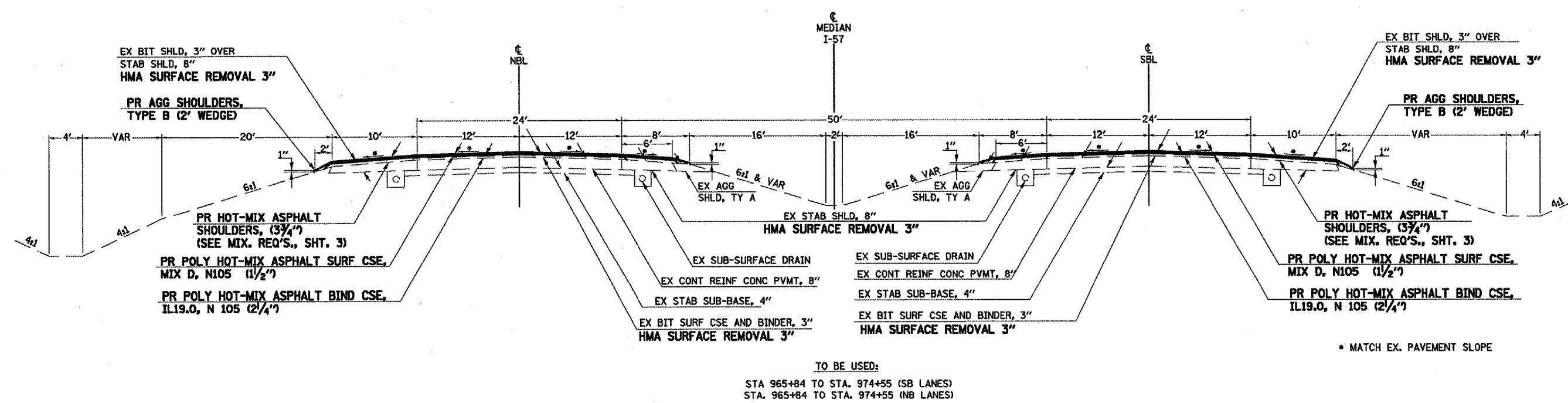
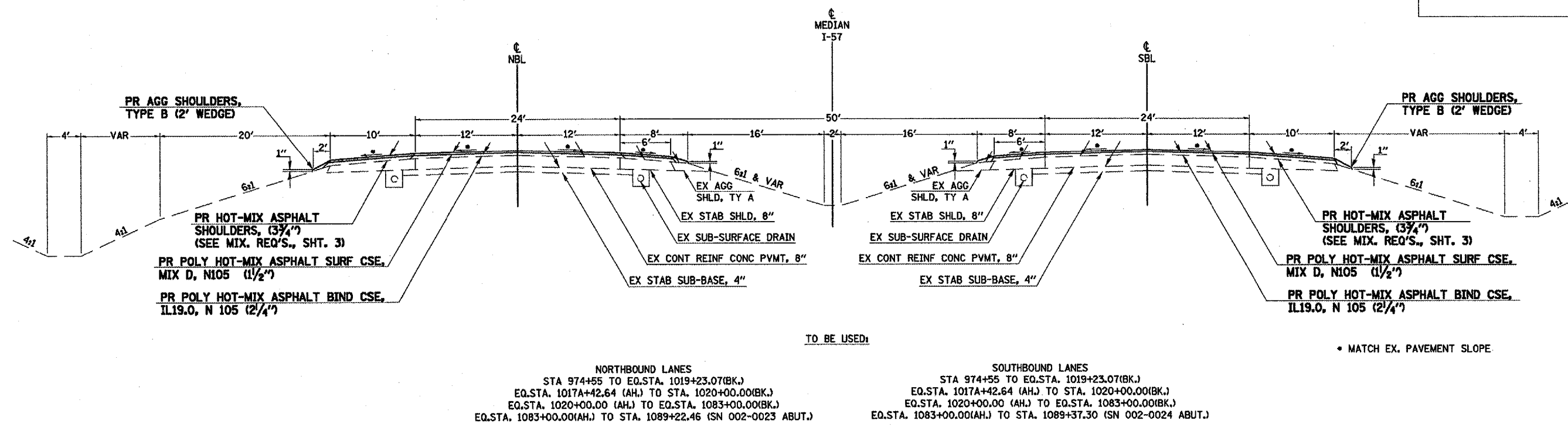

F.A. RTE	SECTION	COUNTY	TOTAL SHEETS	SHEET NO
57	02-01-11-21-3RS-1	ALEXANDER	22	6
STA.		TO STA.		
FED. ROAD DIST. NO.		ILLINOIS	FED. AID PROJECT	

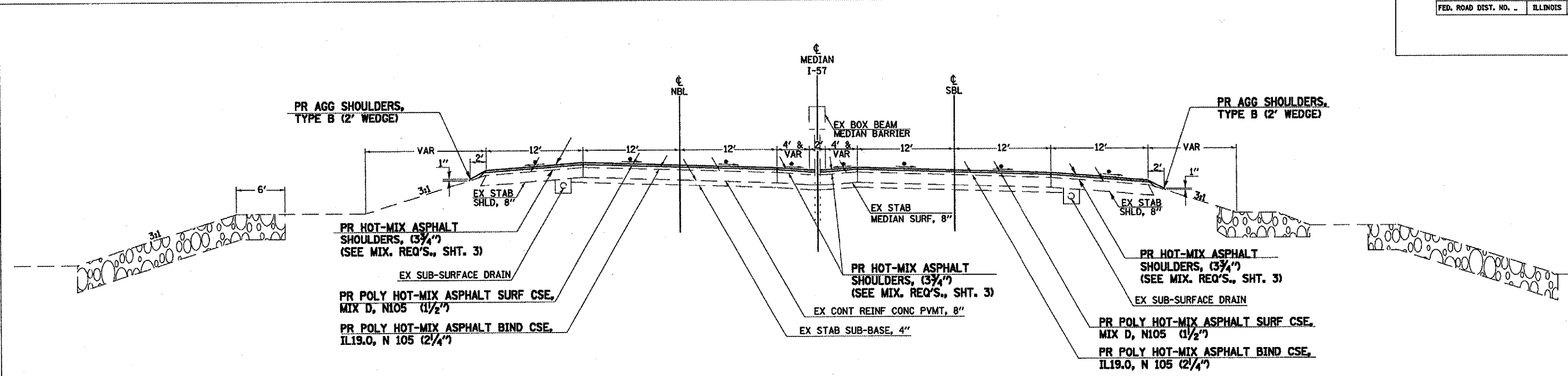

TO BE USED:

NORTHBOUND LANES
 STA 1120+11.74 TO EQ. STA. 1134+12.70 (BK.)
 STA. 1134+36.20 (AH.) TO STA. 1141+85.25

SOUTHBOUND LANES
 STA 1120+11.74 TO EQ. STA. 1134+12.70 (BK.)
 STA. 1134+24.45 (AH.) TO STA. 1141+85.25

• MATCH EX. PAVEMENT SLOPE

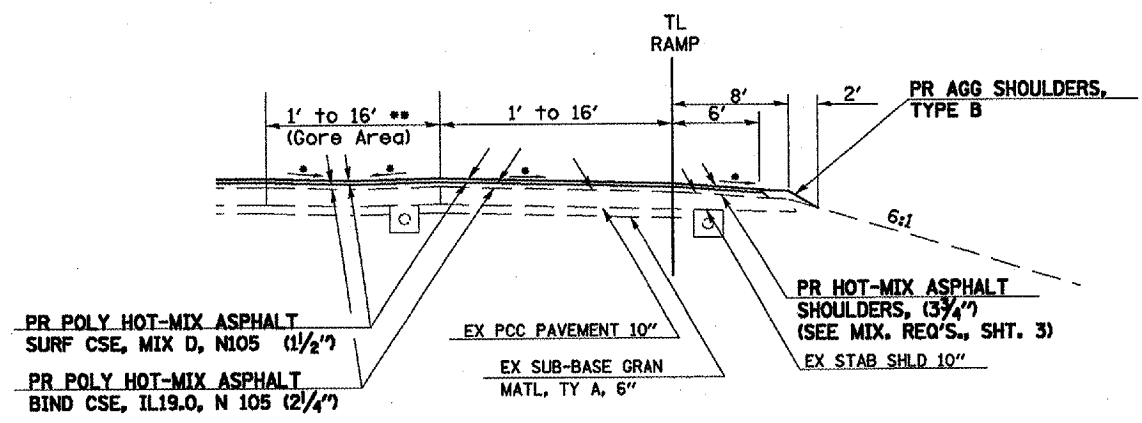

• MATCH EX. PAVEMENT SLOPE

TO BE USED AT RAMP LOCATIONS:

RAMP A: LT. STA. 1062+00 TO STA. 1073+54
 Ramp AA: LT. STA. 1083+85 TO STA. 1089+22.46
 Ramp D: RT. STA. 1069+35 TO STA. 1076+70
 Ramp DD: RT. STA. 1086+48 TO STA. 1089+37.30

****GORE STATIONING:**

RAMP A: LT. STA. 1069+03 TO LT. STA. 1072+13
 Ramp AA: LT. STA. 1086+36 TO LT. STA. 1089+22.46
 Ramp D: RT. STA. 1071+98 TO RT. STA. 1074+66
 Ramp DD: RT. STA. 1088+72 TO RT. STA. 1089+37.30

• MATCH EXISTING SLOPE

F.A. RTE.	SECTION	COUNTY	TOTAL SHEETS	SHEET NO.
57	02-0.1-1.1-2.1-3RS-1	ALEXANDER	22	7
STA.		TO STA.		
FED. ROAD DIST. NO.		ILLINOIS	FED. AID PROJECT	

PROPOSED BUTT JOINT
 BEGINNING STATION 965+84
 ENDING STATION 1141+85.25

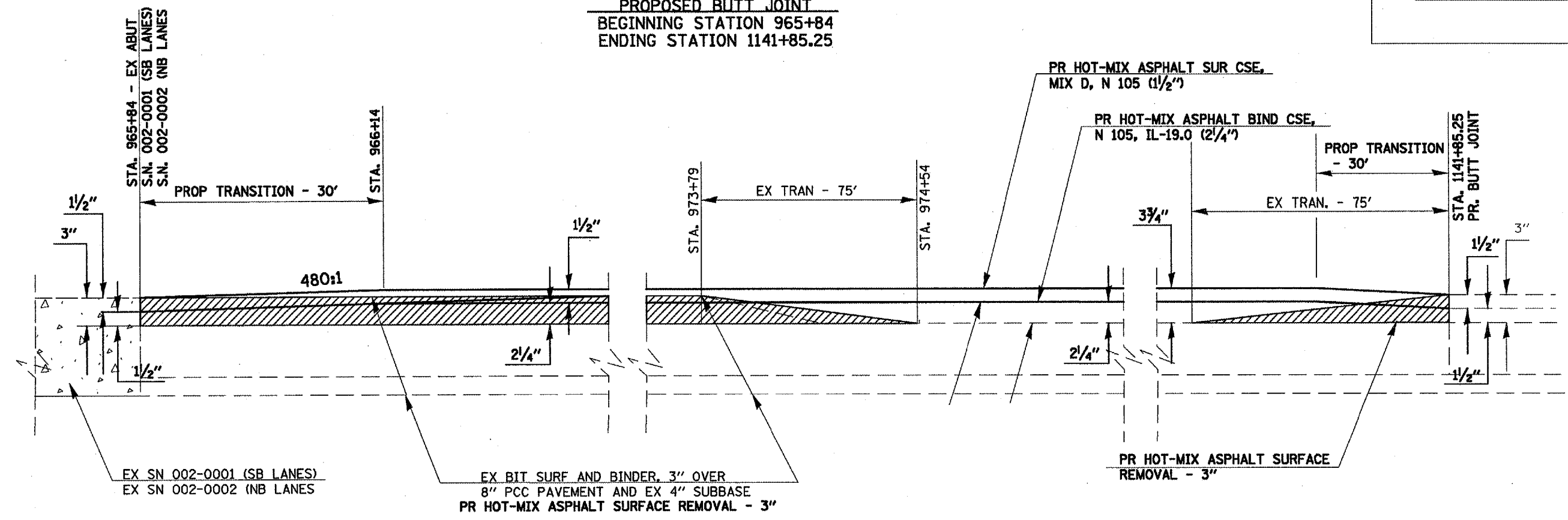

DETAIL OF 150' TRANSITION

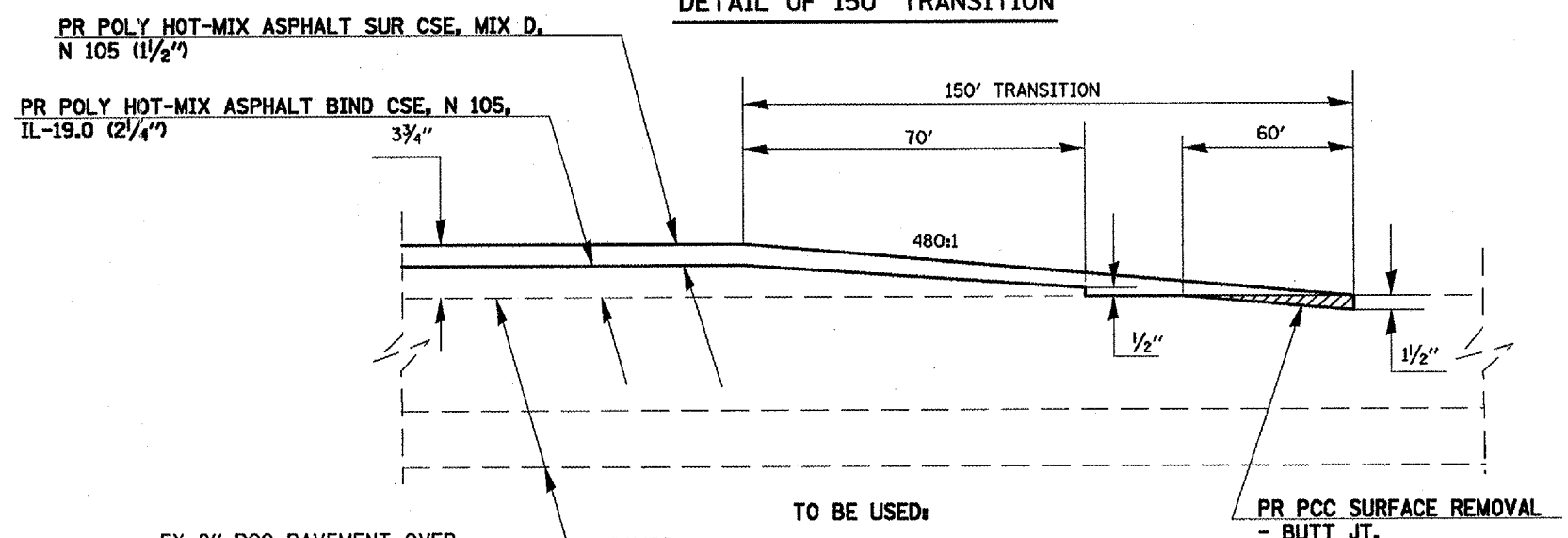

EX 8" PCC PAVEMENT OVER
EX 4" SUBBASE

- TO BE USED:**
- RAMPS:**
 LT. STA. 1072+04 TO LT. STA. 1073+54 (RAMP A)
 LT. STA. 1083+85 TO LT. STA. 1085+35 (RAMP AA)
 RT. STA. 1075+20 TO RT. STA. 1076+70 (RAMP D)
 RT. STA. 1086+48 TO RT. STA. 1087+98 (RAMP DD)
- MAINLINE:**
 STA. 1087+87.39 TO STA. 1089+37.39 (SB LANES)
 STA. 1087+72.46 TO STA. 1089+22.46 (NB LANES)

HOT-MIX ASPHALT SHOULDERS DETAIL AT RAMPS

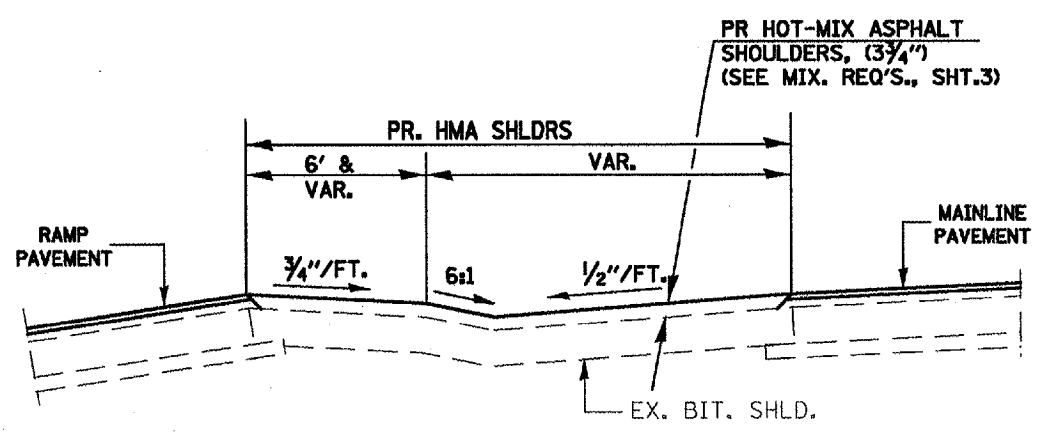

- SECTION A-A**
- RAMP A: LT. STA. 1072+13 TO LT. STA. 1072+90
 RAMP D: RT. STA. 1074+66 TO RT. STA. 1075+98
 RAMP AA: LT. STA. 1084+60 TO LT. STA. 1086+36
 RAMP DD: RT. STA. 1087+30 TO RT. STA. 1088+72

• MATCH EXISTING SLOPE

F.A.I. RTE.	SECTION	COUNTY	TOTAL SHEETS	SHEET NO.
57	02-01-11-21-3RS-1	ALEXANDER	22	8
STA.		TO STA.		
FED. ROAD DIST. NO.		ILLINOIS FED. AID PROJECT		

PROPOSED RESURFACING AND SHOULDER SCHEDULE

LOCATION STATION TO STATION	LENGTH (INFORMATION ONLY)	PCC SURF REMOVAL - BUTT JOINT	HMA SURF REMOVAL 3"	SHOULDERS				PRIME COAT		POLY HMA SUR CSE, MIX D, N105	POLY HMA BINDER CSE, N105, IL-19.0	NOTES	
				BITUMINOUS		AGGREGATE		BITUMINOUS MATERIALS	AGGREGATE				
				10' OUTSIDE	6' INSIDE	LT. 2' WEDGE	RT. 2' WEDGE						GAL
		SQ YD	SQ YD	TON	TON	TON	TON	TON	TON	TON	TON		
SOUTHBOUND													
RT. 965+84.0	TO 974+55.0		2323	203	122	21	21	211	3.5	196	298	Mainline	
RT. 974+55.0	TO 1019+23.1		4468	1043	626	106	106	1084	18.1	1006	1529	Mainline	
EQ. STA. 1019+23.07 (BK.) = STA. 1017+42.64 (AH.)													
RT. 1017+42.6	TO 1029+32.0		1189	278	167	28	28	288	4.8	268	407	Mainline	
RT. 1029+32.0		160										RR Overpass	
RT. 1031+32.0		160										RR Overpass	
RT. 1031+32.0	TO 1069+35.0		3803	887	532	90	90	922	15.4	856	1301	Mainline	
RT. 1069+35.0	TO 1075+98.0		663	155	93	16		161	2.7	149	227	Mainline	
RT. 1069+35.0	TO 1071+98.0		263		37		19	43	0.7	44	61	Ramp D Taper	
RT. 1071+98.0	TO 1076+70.0	107	472		66		34	77	1.3	75	108	Along Ramp D	
RT. 1071+98.0	TO 1074+66.0		268									Along Ramp D Gore	
RT. 1074+66.0	TO 1076+70.0		204		77							Ramp D Gore Shld	
RT. 1076+70.0	TO 1086+48.0		978	205		23	23	237	4.0	220	335	Mainline	
RT. 1086+48.0	TO 1089+37.9		66					6	0.1	3	5	Ramp DD Gore	
RT. 1086+48.0		107			63							Ramp DD Gore Shld	
RT. 1086+48.0	TO 1089+37.9		290		130		7	47	0.8	45	67	Along Ramp DD	
RT. 1089+37.9	TO 1089+37.9		290		41	7		70	1.2	65	99	Mainline	
OMISSION S.N. 002-0024 STA. 1089+37.9 TO STA. 1120+11.74													
RT. 1120+11.7	TO 1134+12.7		1401	327	196	33	33	340	5.7	315	479	Mainline	
EQ. STA. 1134+12.7 (BK.) = STA. 1134+24.45 (AH.)													
RT. 1134+24.5	TO 1141+85.3		761	200	178	18	18	184	3.1	171	260	Mainline	
SB SUBTOTALS			960	2,523	3,275	2,255	343	379	3,670	61.2	3,470	5,175	
NORTHBOUND													
LT. 965+84.0	TO 974+55.0		2323	203	122	21	21	211	3.5	196	298	Mainline	
LT. 974+55.0	TO 1019+23.1		4468	1043	626	106	106	1084	18.1	1006	1529	Mainline	
EQ. STA. 1019+23.07 (BK.) = STA. 1017+42.64 (AH.)													
LT. 1017+42.6	TO 1030+40.0		1297	303	182	31	31	315	5.2	292	444	Mainline	
LT. 1030+40.0		160										RR Overpass	
LT. 1032+40.0		160										RR Overpass	
LT. 1032+40.0	TO 1089+22.4		5682	737	796	75	135	1378	23.0	1279	1944	Mainline & Inside shld	
LT. 1030+40.0	TO 1062+00.0		3160	164	98			170	2.8	52	82	Outside shld	
LT. 1062+00.0	TO 1069+03.0		703		63			73	1.2	68	154	Ramp A Taper	
LT. 1069+03.0	TO 1073+54.0	107	451	105				25	0.4	23	35	Along Ramp A	
LT. 1069+03.0	TO 1072+13.0		310		42							Ramp A Gore	
LT. 1072+13.0	TO 1073+54.0		141		75			87	1.5	81	184	Ramp A Gore Shld	
LT. 1083+85.0	TO 1089+22.5	107	538	113				44	0.7	40	60	Along Ramp AA	
LT. 1083+85.0	TO 1089+22.5		537									Ramp AA Gore	
LT. 1083+85.0	TO 1086+36.0		251		100							Ramp AA Gore Shld	
OMISSION S.N. 002-0024 STA. 1089+37.9 TO STA. 1120+11.74													
LT. 1120+11.7	TO 1134+36.2		1425	332	199	34	34	345	5.8	321	487	Mainline	
EQ. STA. 1134+36.2 (BK.) = STA. 1134+24.45 (AH.)													
LT. 1134+24.5	TO 1141+85.3		761	200	178	18	18	184	3.1	171	260	Mainline	
NB SUBTOTALS			960	2,523	3,178	2,410	284	344	3,706	65.3	3,530	5,477	
TOTALS			1,920	5,046	6,453	4,665	627	723	7,376	126.5	7,000	10,652	
				11,118		1,350							

PLT DWE
PLT SWALE
PLT SCALE
USER NAME

F.A.I. RTE.	SECTION	COUNTY	TOTAL SHEETS	SHEET NO.
57	02-11-11-21-3RS-1	ALEXANDER	22	9
STA.		TO STA.		
FED. ROAD DIST. NO.		ILLINOIS FED. AID PROJECT		

THERMOPLASTIC AND PREFORMED PAVEMENT MARKING

LOCATION STATION TO STATION	PREFORMED		THERMOPLASTIC		SHORT TERM PAVEMENT MARKING (WHITE)	RAISED REFLECTIVE PAVEMENT MARKER REMOVAL	RAISED REFLECTIVE PAVEMENT MARKERS		WORK ZONE PAVEMENT MARKING REMOVAL	NOTES
	LINE 4" WHITE SKIP DASH		LINE 4"				SKIP DASH	CRYSTAL		
	FOOT	FOOT	SOLID WHITE FOOT	SOLID YELLOW FOOT	FOOT	EACH			EACH	
SOUTHBOUND										
RT. 965+84.0 TO 1019+23.1	1335		5339	5339	427	68	68		4143	Rt., Lt. EP and Centerline SB Lanes
EQ. STA. 1019+23.07 (BK.) = STA. 1017+42.64 (AH.)										
RT. 1017+42.6 TO 1089+37.9	1799		5192	7195	576	91	91		3187	Lt. EP and Centerline SB Lanes
RT. 1017+42.6 TO 1069+35.0			735			38	38		1729	Rt. EP of SB Lanes
RT. 1069+35.0 TO 1076+70.0			472			13	8	5	245	RT. EP of Ramp D
RT. 1071+98.0 TO 1076+70.0			472			10	10		157	Along Gore for Ramp D Lt EP
RT. 1071+98.0 TO 1076+70.0			1268						157	Rt EP SB lanes at Ramp D Along Gore
RT. 1076+70.0 TO 1089+37.9			290						422	Rt EP of SB Lanes
RT. 1086+48.0 TO 1089+37.9			290						97	Along Gore of Ramp DD Lt EP
RT. 1086+48.0 TO 1089+37.9			290						97	Rt. EP of Ramp DD
OMISSION S. N. 002-0024 STA. 1089+37.9 TO STA. 1120+11.74										
RT. & LT. 1120+11.7 TO 1134+12.7	350		1401	1401	112	19	19		1087	Rt., Lt. EP and Centerline SB Lanes
EQ. STA. 1134+12.7 (BK.) = STA. 1134+24.45 (AH.)										
RT. & LT. 1134+24.5 TO 1141+85.3	190		761	761	61	11	11		590	Rt., Lt. EP and Centerline SB Lanes
SB SUBTOTALS	3,674		16,220	14,696	1,176	248	243	5	11,910	
NORTHBOUND										
LT. 973+79.0 TO 1019+23.1	1136		4544	4544	364	58	58		3526	Rt., Lt. EP and Centerline NB Lanes
EQ. STA. 1019+23.07 (BK.) = STA. 1017+42.64 (AH.)										
LT. 1017+42.6 TO 1062+00.0	1114		4457	4457	357	57	57		3458	Rt., Lt. EP and Centerline NB Lanes
LT. 1062+00.0 TO 1072+80.0			1080						360	Lt. EP of Ramp A
LT. 1069+32.0 TO 1072+80.0			348						116	Along Gore for Ramp A Rt EP
LT. 1069+32.0 TO 1088+63.0			1931						643	Lt. EP of NB Lanes
LT. 1062+00.0 TO 1089+22.5	681			2722	218	35	35		1206	Rt. EP and Centerline NB Lanes
LT. 1085+04.0 TO 1086+36.0				132		4	2	2	44	Along Gore for Ramp AA Rt EP
LT. 1086+36.0 TO 1088+63.0			227			6	6		76	Along Gore for Ramp AA Rt EP
LT. 1085+04.0 TO 1089+22.5			418			22	22		139	Lt. EP of Ramp AA
LT. 1085+04.0 TO 1088+63.0						10	10			At Ramp AA Gore on Lt EP NB Lanes
OMISSION S. N. 002-0024 STA. 1089+37.9 TO STA. 1120+11.74										
RT. & LT. 1120+11.7 TO 1134+36.2	356		1425	1425	114	19	19		1105	Rt., Lt. EP and Centerline NB Lanes
EQ. STA. 1134+36.2 (BK.) = STA. 1134+24.45 (AH.)										
RT. & LT. 1134+24.5 TO 1141+85.3	190		761	761	61	11	11		590	Rt., Lt. EP and Centerline NB Lanes
NB SUBTOTALS	3477		15191	14043	1,113	222	220	2	11,263	
TOTALS	7,151		31,411	28,739	2,288	470	463	7	23,173	
			60,150				470			

NOTES: TEMPORARY PAVEMENT MARKING QUANTITIES ARE CALCULATED FROM THE PERMANENT PAVEMENT MARKING.

PLT DATE = 4/2/2007
 FILE NAME = c:\pavmark\98905\98905m.mxd
 USER = mwoodrck

F.A. RTE.	SECTION	COUNTY	TOTAL SHEETS	SHEET NO.
57	02-G1-1,1-2,1-3RS-1	ALEXANDER	22	10
STA.		TO STA.		
FED. ROAD DIST. NO.		ILLINOIS	FED. AID PROJECT	



NOT TO SCALE

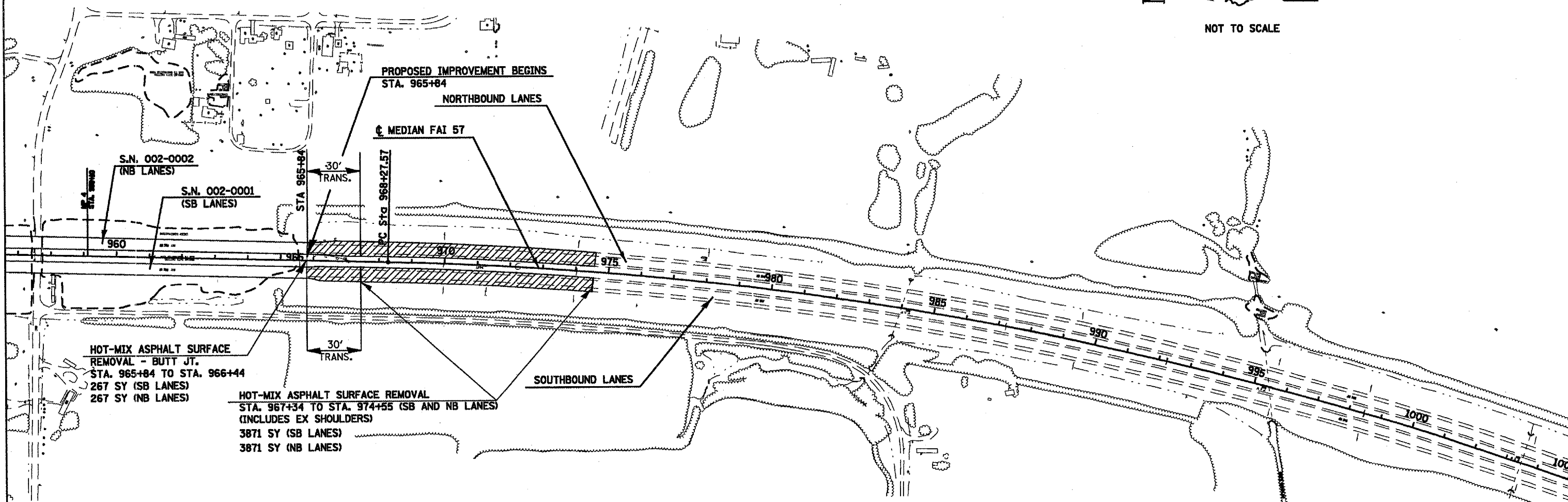

S.N. 002-0002
(NB LANES)

S.N. 002-0001
(SB LANES)

PROPOSED IMPROVEMENT BEGINS
STA. 965+84

☐ MEDIAN FAI 57

HOT-MIX ASPHALT SURFACE
REMOVAL - BUTT JT.
STA. 965+84 TO STA. 966+44
267 SY (SB LANES)
267 SY (NB LANES)

HOT-MIX ASPHALT SURFACE REMOVAL
STA. 967+34 TO STA. 974+55 (SB AND NB LANES)
(INCLUDES EX SHOULDERS)
3871 SY (SB LANES)
3871 SY (NB LANES)

SOUTHBOUND LANES

PROP. CURVE 10
PI STA. = 994+18.19
 $\Delta = 25^\circ 29' 24''$ (RT)
D = $0^\circ 30' 01''$
R = 11,453.52'
T = 2,590.62'
L = 5,095.50'
E = 289.33'
e = -----
T.R. = -----
S.E. RUN = -----
P.C. STA = 968+27.57
P.T. STA = 1019+23.07

NOTE:
FOR DETAIL OF EX SURFACE REMOVAL AND TRANSITIONS,
SEE SHEET 7.

PLOT DATE = 4/23/87
FILE NAME = s:\projects\98905\98905.dwg
PLOT SCALE = 1/8"=1'-0"
USER NAME = mcorcoran

F.A.I. RTE.	SECTION	COUNTY	TOTAL SHEETS	SHEET NO.
57	02-41-11-2.1-3RS-1	ALEXANDER	22	11
STA.		TO STA.		
FED. ROAD DIST. NO.		ILLINOIS	FED. AID PROJECT	



NOT TO SCALE

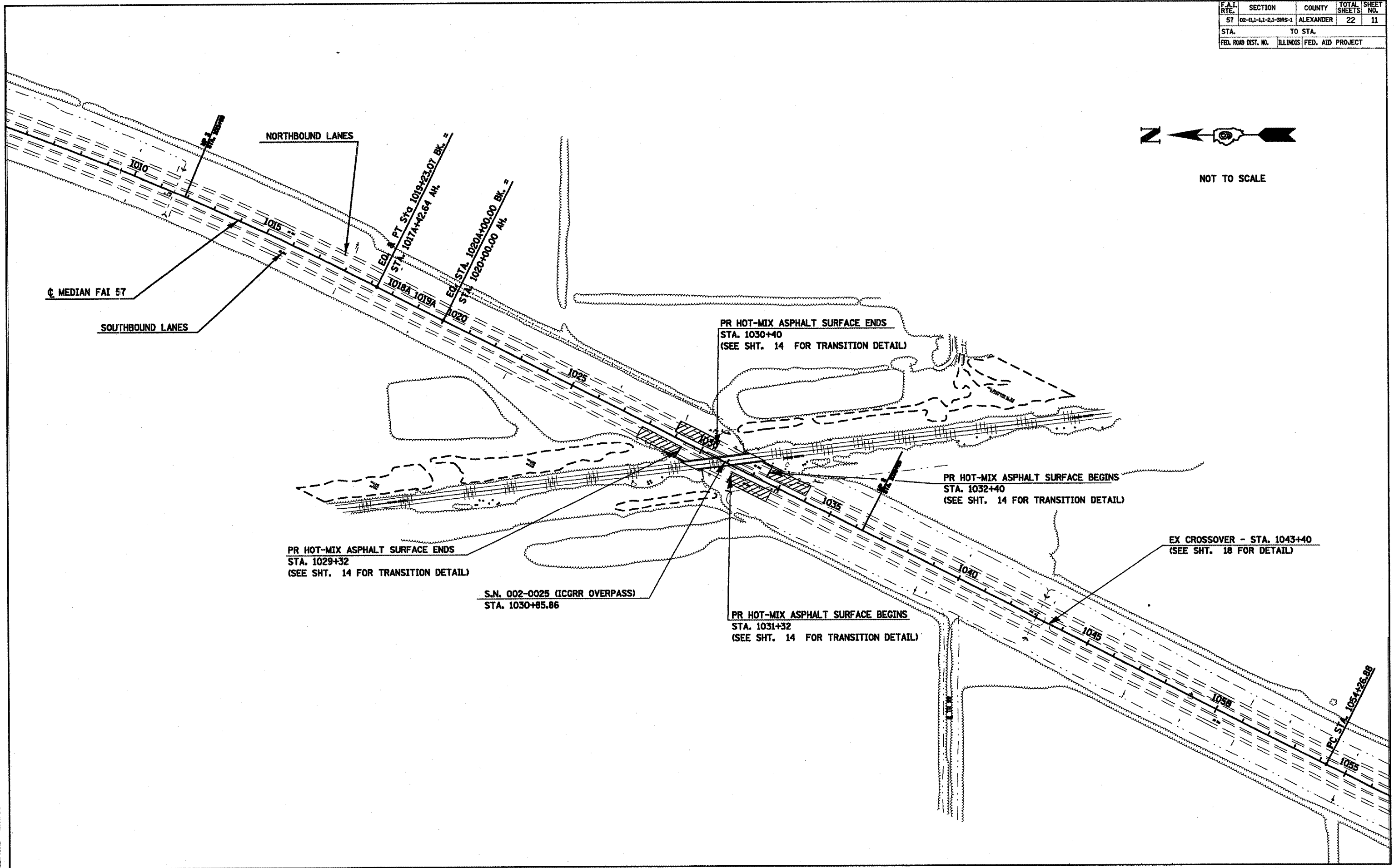

PLOT DATE = 4/2/2007
 FILE NAME = c:\projects\fa57\p11\p11.dwg
 PLOT SCALE = 1/8" = 1'-0"
 USER NAME = mcorcoran

F.A.I. RTE.	SECTION	COUNTY	TOTAL SHEETS	SHEET NO.
57	02-0.1-1.1-2.1-3RS-1	ALEXANDER	22	12
STA.		TO STA.		
FED. ROAD DIST. NO.	ILLINOIS		FED. AID PROJECT	



NOT TO SCALE

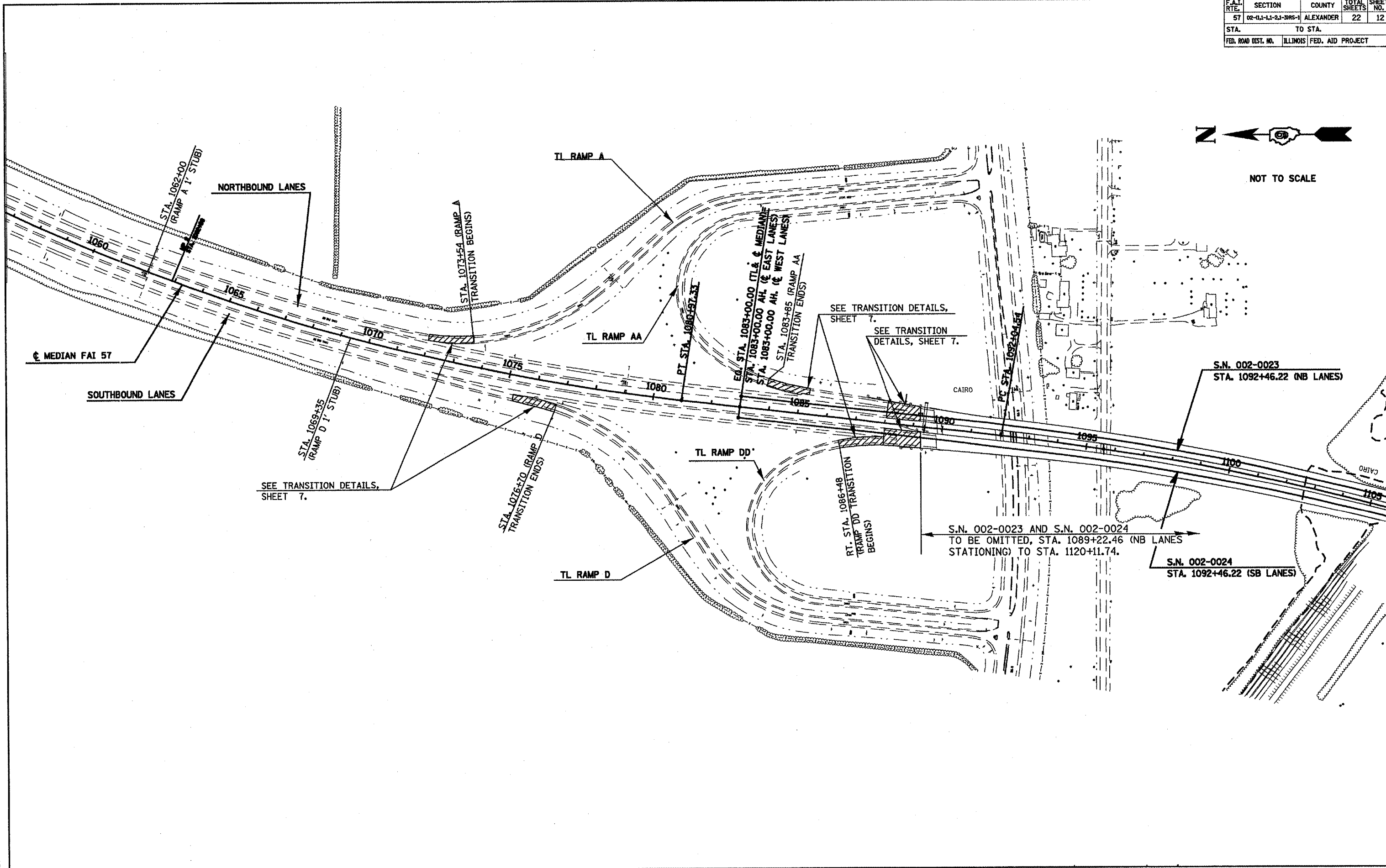

PLOT DATE = 4/2/2007
 FILE NAME = c:\pwworkspace\1081185\1081185.dwg
 PLOT SCALE = 1/8" = 1' IN.
 USER NAME = mcorcoran

F.A.I. RTE.	SECTION	COUNTY	TOTAL SHEETS	SHEET NO.
57	02-01-1.1-2.1-3RS-1	ALEXANDER	22	13
STA. TO STA.				
FED. ROAD DIST. NO.		ILLINOIS	FED. AID PROJECT	



NOT TO SCALE

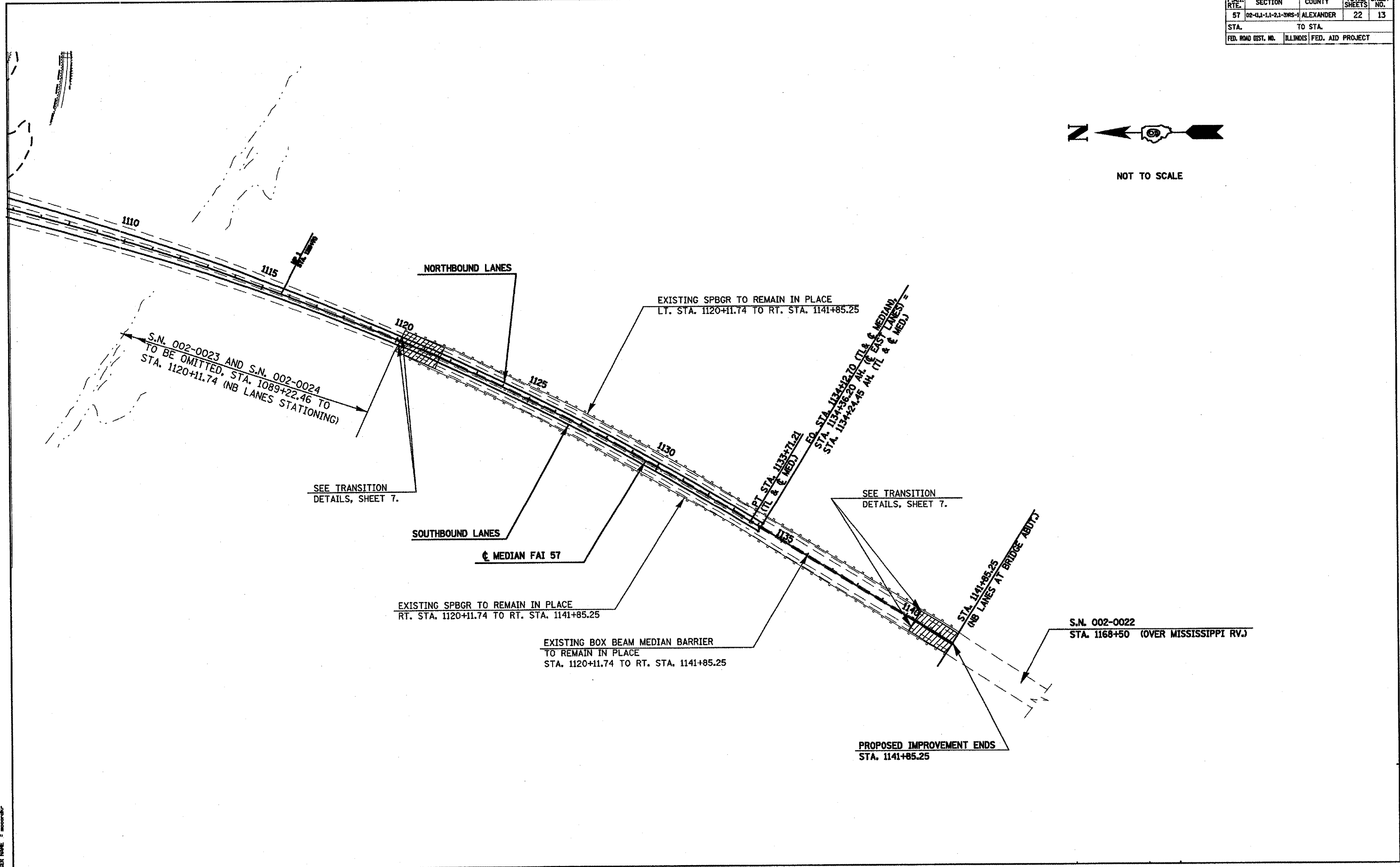

PLOT DATE = 4/2/2007
 FILE NAME = I:\Projects\98905\FAI57\FAI57.dwg
 USER NAME = mcorcoran

F.A.I. RTE.	SECTION	COUNTY	TOTAL SHEETS	SHEET NO.
57	02-0.1-1.1-2.1-3MS-1	ALEXANDER	22	14
STA.		TO STA.		
FED. ROAD DIST. NO.		ILLINOIS FED. AID PROJECT		

RAILROAD OVERPASS TAPER DETAIL

NOT TO SCALE

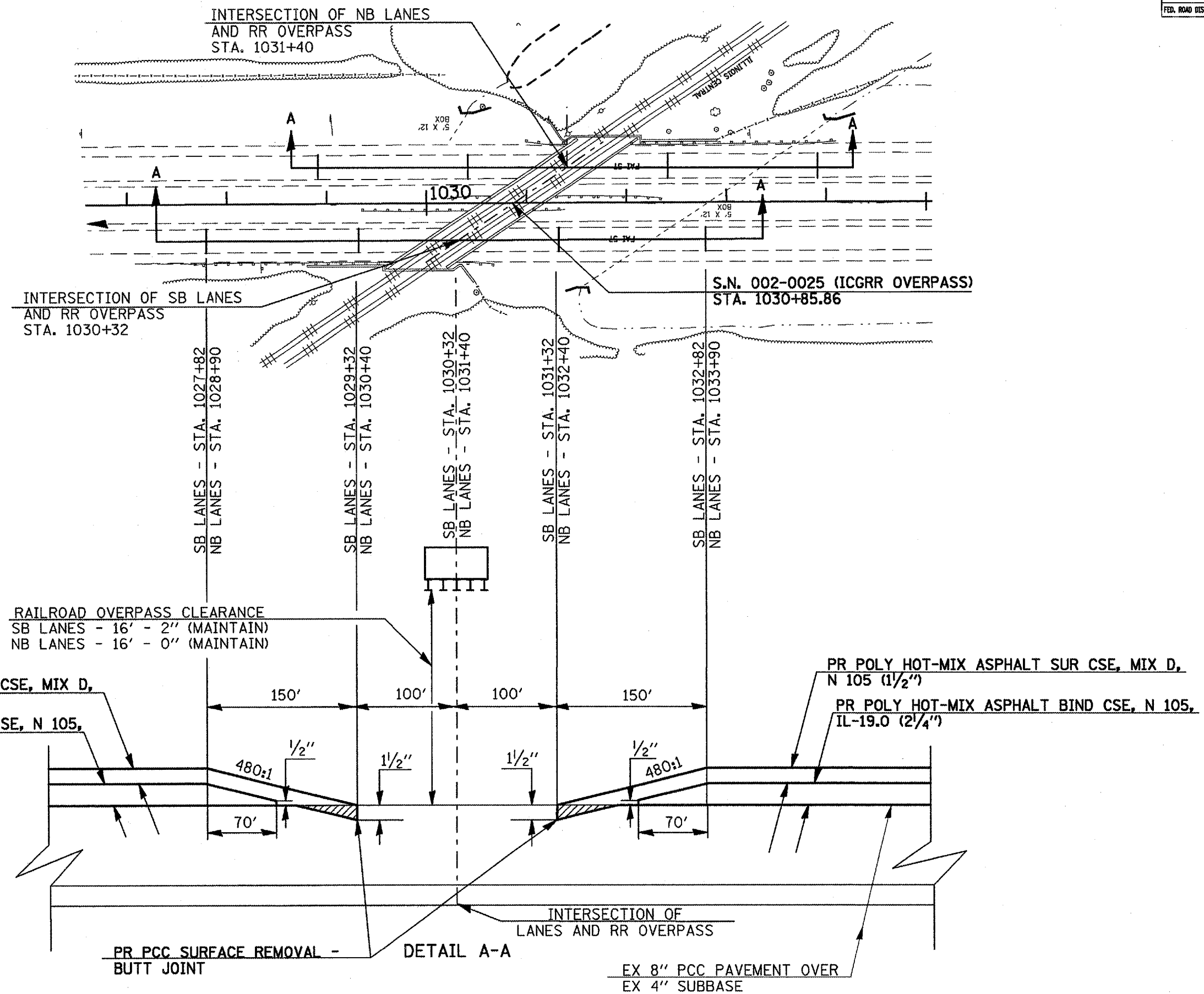

PLOT DATE = 4/2/2007
 FILE NAME = ...
 PLOT SCALE = 1/4" = 100'
 USER NAME = ...

F.A.I. RTE.	SECTION	COUNTY	TOTAL SHEETS	SHEET NO.
57	02-01-1A-2J-3RS-1	ALEXANDER	22	15
STA.		TO STA.		
FED. ROAD DIST. NO.	ILLINOIS	FED. AID PROJECT		

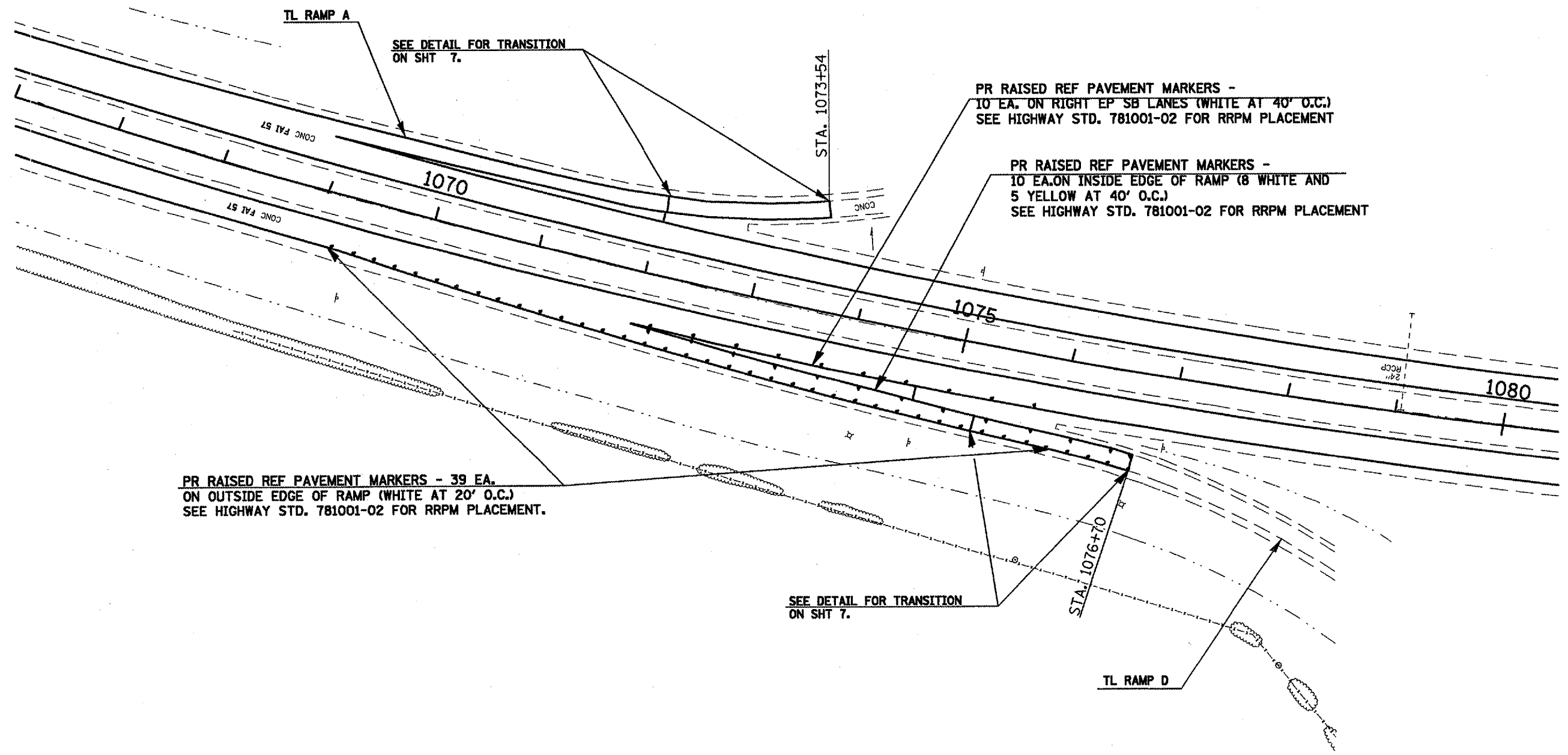
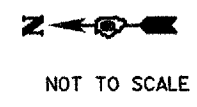

PR RAISED REF PAVEMENT MARKERS - 39 EA.
ON OUTSIDE EDGE OF RAMP (WHITE AT 20' O.C.)
SEE HIGHWAY STD. 781001-02 FOR RRPM PLACEMENT.

PR RAISED REF PAVEMENT MARKERS -
10 EA. ON RIGHT EP SB LANES (WHITE AT 40' O.C.)
SEE HIGHWAY STD. 781001-02 FOR RRPM PLACEMENT

PR RAISED REF PAVEMENT MARKERS -
10 EA. ON INSIDE EDGE OF RAMP (8 WHITE AND
5 YELLOW AT 40' O.C.)
SEE HIGHWAY STD. 781001-02 FOR RRPM PLACEMENT

SEE DETAIL FOR TRANSITION
ON SHT 7.

SEE DETAIL FOR TRANSITION
ON SHT 7.

PLOT DATE = 4/3/2007
FILE NAME = c:\projects\p81181\p81181.dwg
PLOT SCALE = 1/8" = 1'-0"
USER NAME = mcdonald

RAISED REFLECTIVE PAVEMENT MARKER DETAILS - RAMP A AND RAMP D

F.A.I. RTE.	SECTION	COUNTY	TOTAL SHEETS	SHEET NO.
57	02-01-11-21-SRS-1	ALEXANDER	22	16
STA.		TO STA.		
FED. ROAD DIST. NO.	ILLINOIS	FED. AID PROJECT		



NOT TO SCALE

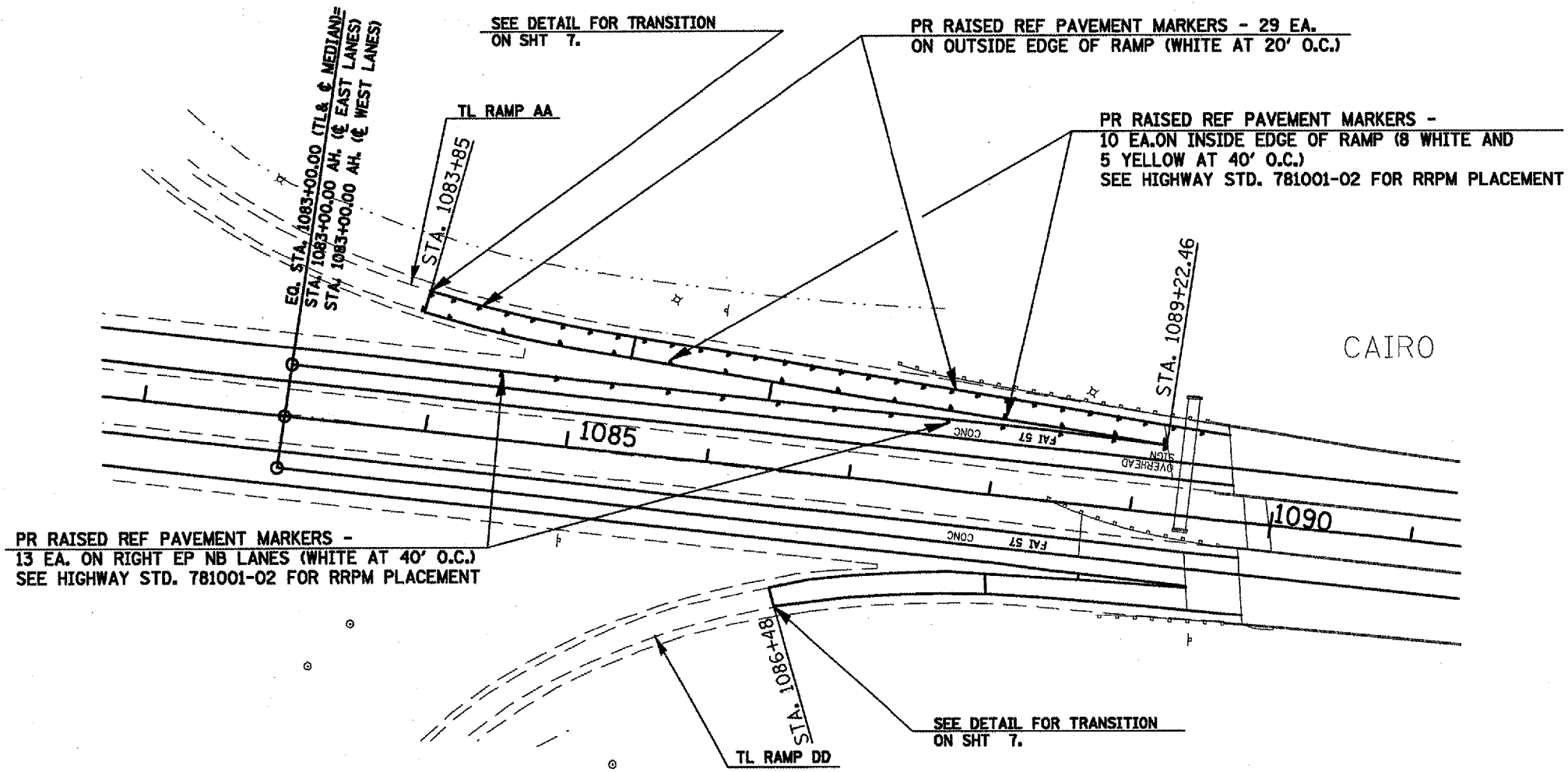

PLOT DATE = 4/2/2007
 FILE NAME = c:\pwworkspace\p181185\p181185.dwg
 PLOT SCALE = 1/8" = 1'-0"
 USER NAME = masonrdr

RAISED REFLECTIVE PAVEMENT MARKER DETAILS - RAMP AA AND RAMP DD

F.A.I. RTE.	SECTION	COUNTY	TOTAL SHEETS	SHEET NO.
57	02-01-11-21-3WS	ALEXANDER	22	17
STA.		TO STA.		
FED. ROAD DIST. NO.	ILLINOIS	FED. AID PROJECT		

CAIRO INTERCHANGE RAMP DETAILS (FOR INFORMATION ONLY)

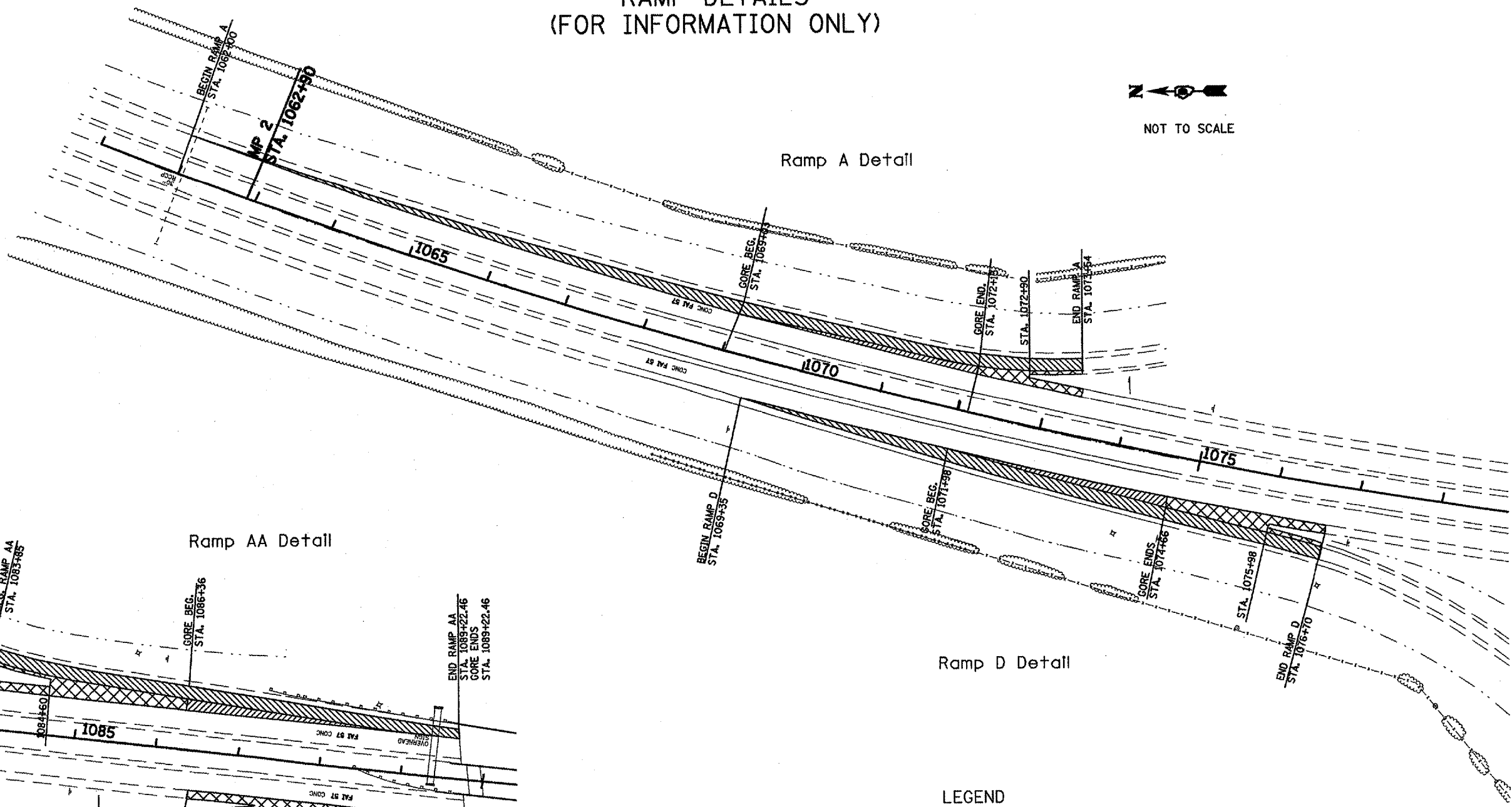
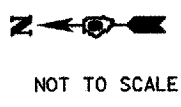
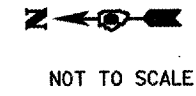



Ramp A Detail

Ramp AA Detail

Ramp D Detail

Ramp DD Detail

LEGEND

-  EX GORE SHOULDER
-  EX RAMP LANE
-  EX GORE SURFACE

PLOT DATE = 4/22/2007
 FILE NAME = c:\projects\cairo\cairo\plottings\m32
 PLOT SCALE = 1/8"=1'-0"
 USER NAME = m32

F.A.I. RTE.	SECTION	COUNTY	TOTAL SHEETS	SHEET NO.
57	02-01-11-21-3RS-1	ALEXANDER	22	18
STA.		TO STA.		
FED. ROAD DIST. NO.	ILLINOIS	FED. AID PROJECT		

**CROSSOVER RESURFACING
DETAIL**

NOT TO SCALE

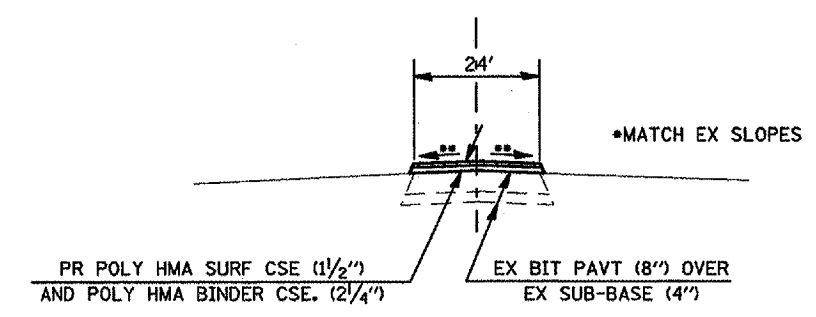
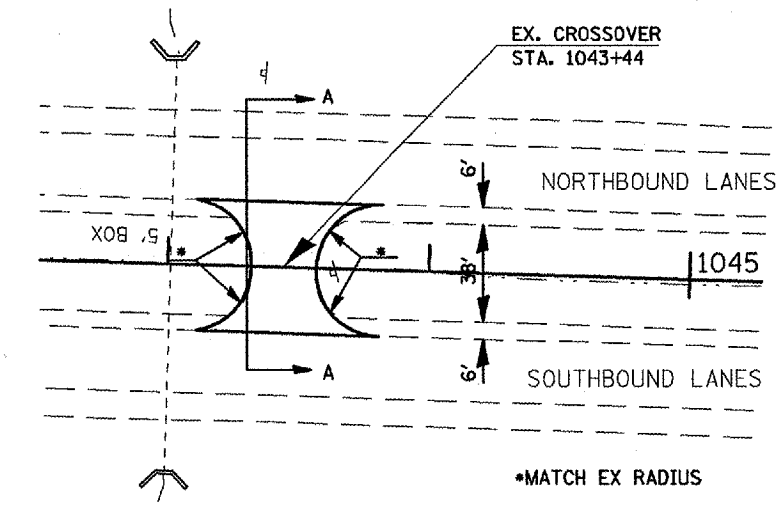

CROSSOVER TYPICAL

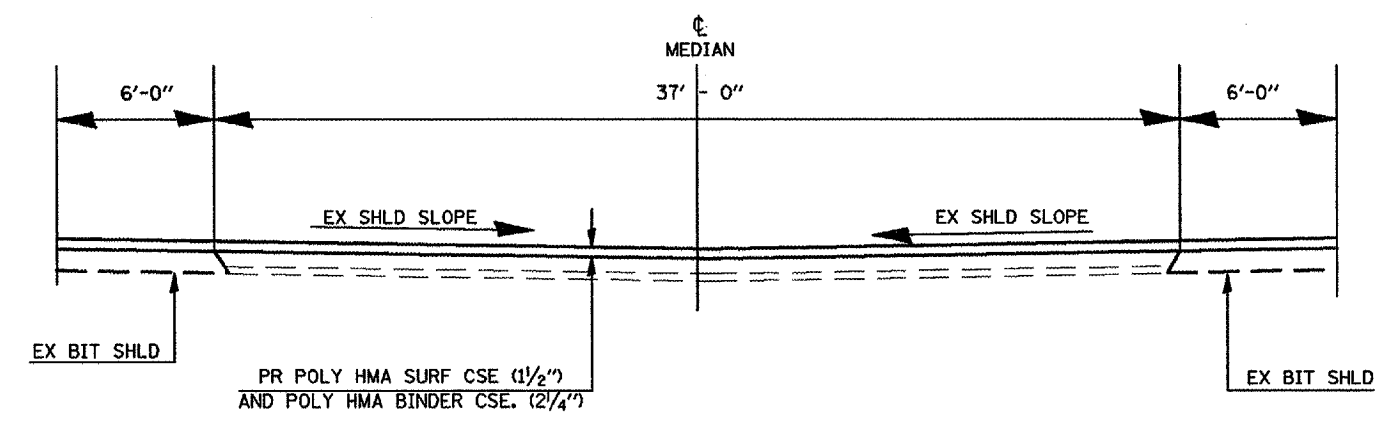

DETAIL A-A

PLOT DATE = 4/2/2007
 PLOT SCALE = 1/4" = 1'-0"
 USER NAME = masonr

ILLINOIS STANDARD

W8-1106

F.A.I. RTE.	SECTION	COUNTY	TOTAL SHEETS	SHEET NO.
57	02-01-11-21-3RS-1	ALEXANDER	22	19
STA.		TO STA.		
FED. ROAD DIST. NO.	ILLINOIS	FED. AID PROJECT		

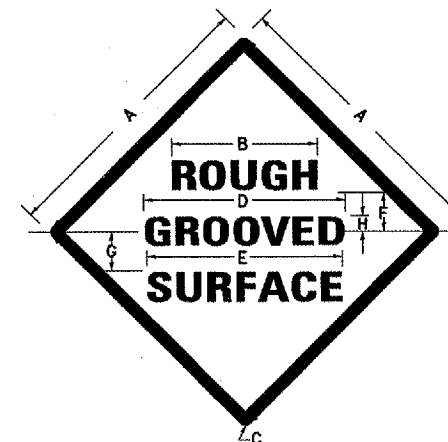

COLORS:

LEGEND AND BORDER - BLACK NON-REFLECTORIZED
BACKGROUND - ORANGE REFLECTORIZED

SIGN SIZE	DIMENSIONS							
	A	B	C	D	E	F	G	H
48X48	48.0	24.1	3.0	34.0	33.0	6.0	13.0	3.5

SIGN SIZE	SERIES LINES			MAR-GIN	BOR-DER	BLANK STD.
	1	2	3			
48X48	7C	7C	7C	0.8	1.2	B4-48D

ALL DIMENSIONS IN INCHES

NOTES:

PRIOR TO ALLOWING TRAFFIC ON ANY PORTION OF THE ROADWAY THAT HAS BEEN COLDMILLED, THE CONTRACTOR SHALL HAVE ERECTED "ROUGH GROOVED SURFACE" SIGNS THAT CONFORM TO THE ABOVE DETAILS. A MINIMUM OF ONE SIGN AT EACH END OF THE IMPROVEMENT WILL BE REQUIRED. THE CONTRACTOR SHALL MAINTAIN THE "ROUGH GROOVED SURFACE" SIGNS UNTIL THE COLDMILLED SURFACE IS COVERED WITH LEVELING BINDER OR SURFACE COURSE.

IF AT ANY TIME THE SIGNS ARE IN PLACE BUT NOT APPLICABLE, THEY SHALL BE TURNED FROM THE VIEW OF MOTORISTS OR COVERED AS DIRECTED BY THE ENGINEER.

THE COST OF FURNISHING, ERECTING, MAINTAINING, AND REMOVING THE REQUIRED SIGNS SHALL BE INCLUDED IN THE CONTRACT.

REVISIONS
REDRAWN 2-15-88
REVISED 4-5-88
REVISED
REVISED

STD. 9-39

UNEVEN LANES SIGN

W8-11 (48" x 48")

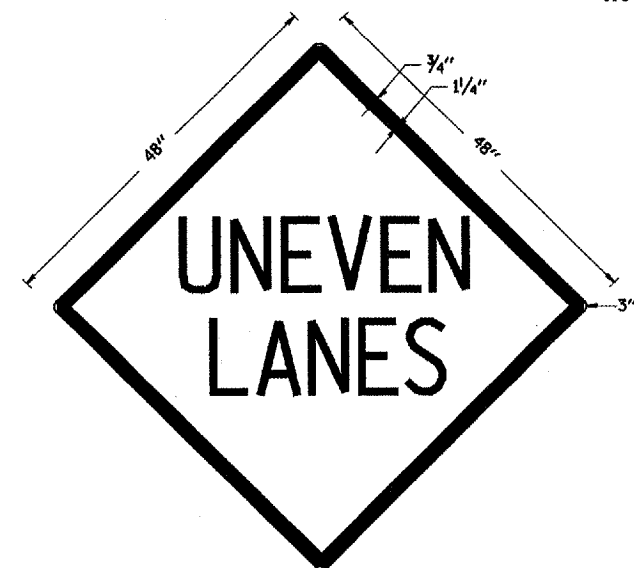

COLORS:

LEGEND AND BORDER - BLACK NON-REFLECTORIZED
BACKGROUND - ORANGE REFLECTORIZED

NOTE: PRIOR TO ALLOWING TRAFFIC ON ANY PORTION OF THE ROADWAY THAT HAS BEEN COLDMILLED OR BEFORE RESURFACING OPERATIONS BEGIN, THE CONTRACTOR SHALL HAVE ERECTED "UNEVEN PAVEMENT" SIGNS THAT CONFORM TO THE ABOVE DETAILS. A MINIMUM OF ONE SIGN AT EACH END OF THE IMPROVEMENT WILL BE REQUIRED. THE CONTRACTOR SHALL MAINTAIN THE "UNEVEN PAVEMENT" SIGNS UNTIL THE RESURFACING OPERATIONS ARE COMPLETED.

IF AT ANY TIME THE SIGNS ARE IN PLACE BUT NOT APPLICABLE, THEY SHALL BE TURNED FROM THE VIEW OF MOTORISTS OR COVERED AS DIRECTED BY THE ENGINEER.

THE COST OF FURNISHING, ERECTING, MAINTAINING, AND REMOVING THE REQUIRED SIGNS SHALL BE INCLUDED IN THE CONTRACT.

REVISIONS
DRAWN 1-15-88
REVISED 1-15-88
REVISED 1-25-04

STD. 9-41

F.A.I. RTE.	SECTION	COUNTY	TOTAL SHEETS	SHEET NO.
57	D2-01-11-24-3RS-1	ALEXANDER	22	20
STA.		TO STA.		
FED. ROAD DIST. NO.	ILLINOIS	FED. AID PROJECT		

TEMPORARY HOT-MIX ASPHALT TRANSITIONS

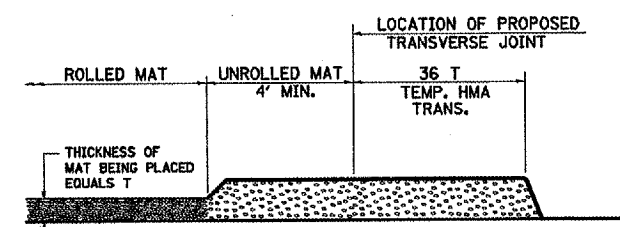

STEP I

1. PLACE HOT-MIX ASPHALT MAT, LENGTH 36 TIMES THE THICKNESS OF THE MAT BEING PLACED PAST THE PROPOSED TRANSVERSE JOINT LOCATION USING NORMAL OPERATING PROCEDURES.
2. EXTREME CARE SHOULD BE TAKEN TO MAINTAIN ENOUGH MATERIAL IN FRONT OF THE SCREED TO MAINTAIN REQUIRED PAVING DEPTH.

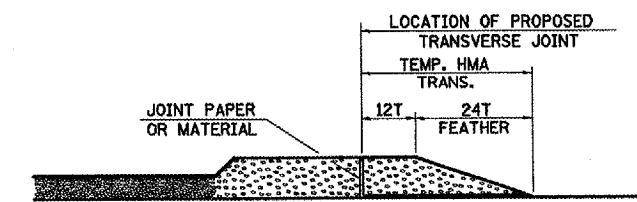

STEP III

1. JOINT PAPER OR OTHER PRESELECTED JOINT MATERIAL IS THEN PLACED IN THE CLEARED AREA AND THE EXCESS ASPHALT USED TO HAND FORM A TRANSITION TO THE DIMENSIONS SHOWN ABOVE.
2. NOTE THAT IN CONSTRUCTING THE TRANSITION, THE MAT DEPTH IS CONTINUED AS PART OF THE TRANSITION BEFORE FORMING THE FEATHER.

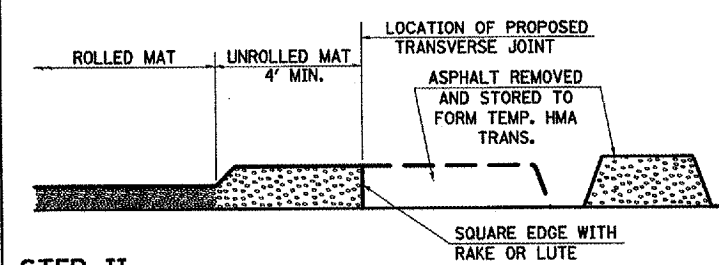

STEP II

1. MOVE THE PAVER OUT OF THE WAY AND REMOVE THE ASPHALT FROM THE AREA OF THE PROPOSED TEMPORARY HOT-MIX ASPHALT TRANSITION.
2. SQUARE UP THE END OF THE MAT WITH A RAKE OR LUTE.
3. NOTE THAT THE MAT WITHIN 4' OF THE END OF JOINT IS NOT TO BE ROLLED AT THIS TIME.

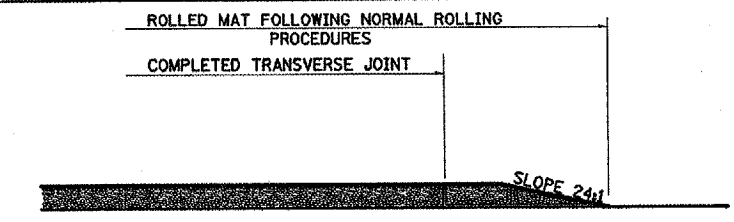

STEP IV

1. COMPLETE TEMPORARY TRANSITION BY ROLLING.
2. TO RESUME PAVING, AT THE JOINT, REMOVE TEMPORARY TRANSITION AND DISPOSE OF THE MATERIAL ACCORDING TO ART. 202.03 OF THE STD. SPECS. (COST INCLUDED IN THE CONTRACT).
3. CONSTRUCTING THE TEMPORARY TRANSITIONS WILL NOT BE PAID FOR SEPARATELY IN ACCORDANCE WITH ARTICLE 406.14 OF THE STANDARD SPECIFICATIONS.

REVISIONS
REDRAWN 2-18-89
REVISED 8-16-89
REVISED 01-03-91

STD. 9-26

DATE = 4/2/87
 FILE NAME = alexander\p8105\p8105.dwg
 PLOT SCALE = 1/8"=1'-0"
 USER NAME = mcorradin

STANDARD DESIGN

24 FT.-CONTINUOUSLY REINFORCED PORTLAND CEMENT CONCRETE PAVEMENT
(OPTIONAL BITUMINOUS AGGREGATE MIXTURE PAD)

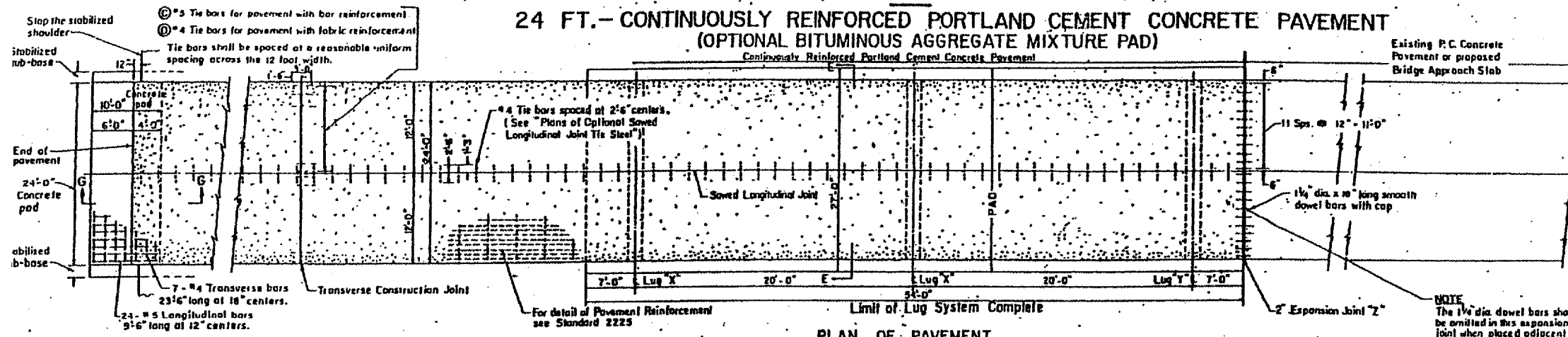

NOTE:
When a slip form paver not equipped with approved automatic grade controls is to be used, it shall operate on the BAM pad which shall be extended so that the overall width is 6 inches greater than the width from outside to outside of the slip form paver's tracks. Such extended width will not be measured for payment but shall be considered incidental to the contract.
If the slip form paver is equipped with approved automatic grade controls that control the four corner supports of the paver and the Contractor elects to use these controls, the BAM pad shall be 12 inches wider than the design pavement width.

NOTE:
The 1 1/2" dia. dowel bars shall be omitted in this expansion joint when placed adjacent to existing pavement.

When pavement is adjacent to bridge approach slab, this expansion joint shall be provided in lieu of the 4" expansion joint shown on the Standard Drawings for Bridge Approaches.

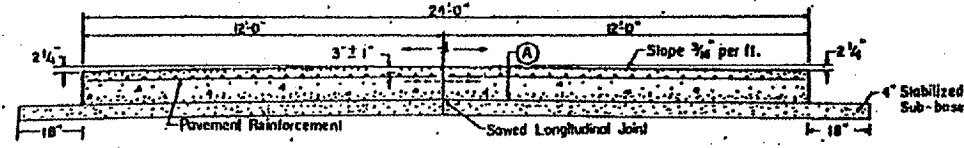

CROSS SECTION E-E

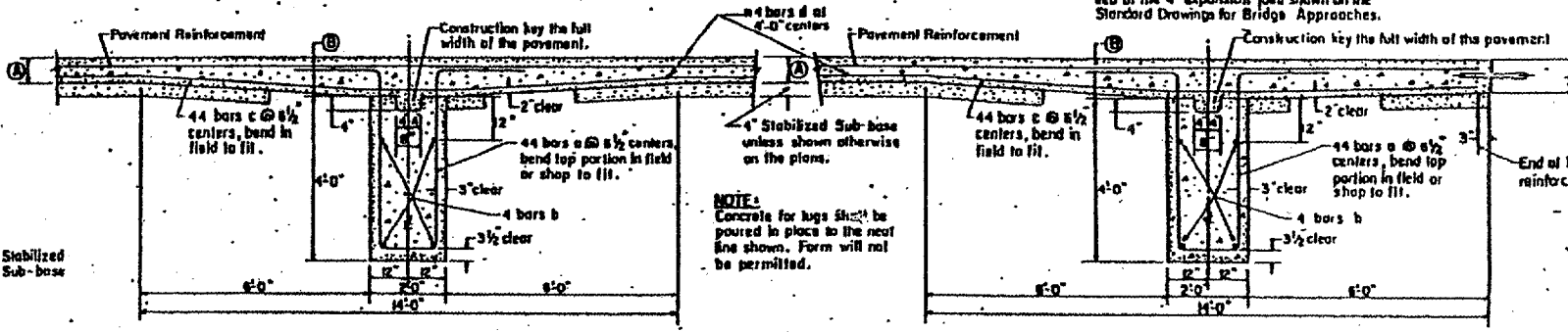

SECTION AT LUG 'X'

SECTION AT LUG 'Y'

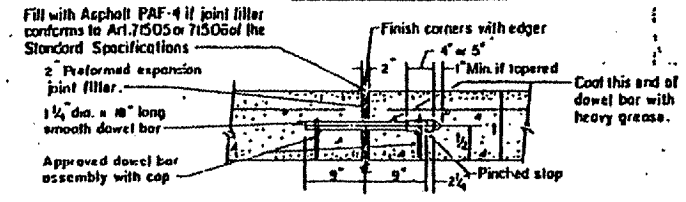

DETAIL OF EXPANSION JOINT

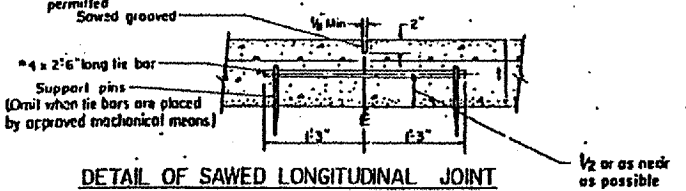

DETAIL OF SAWED LONGITUDINAL JOINT

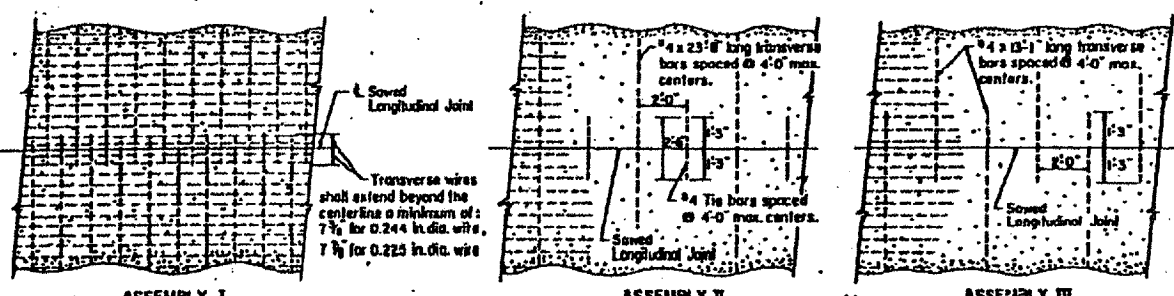

PLANS OF OPTIONAL SAWED LONGITUDINAL JOINT TIE STEEL

BILL OF MATERIAL FOR LUG SYSTEM
(Excluding pavement concrete and pavement reinforcement)

Bar No.	Size	Length	Shape
a	132	#7	14'-0"
b	12	#5	24'-9"
c	132	#5	20'-0"
d	28	#4	11'-5"

Class X Concrete, Cu.Yds. 2085
Reinforcing Bars, Lbs. 7062
BAM Pad, Sq.Yds. 146

Part	(A)	(B)	(C)	(D)
8"		12"	8"	12"
9"		14"	9"	14"

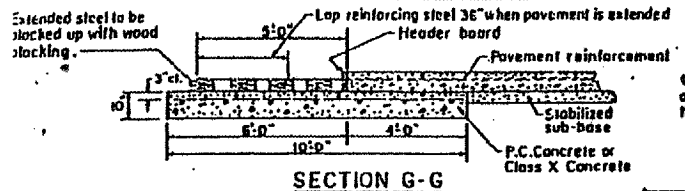

SECTION G-G

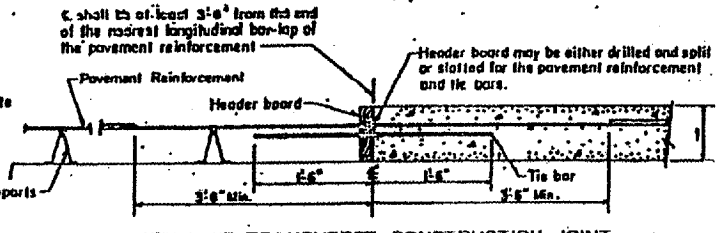

DETAIL OF TRANSVERSE CONSTRUCTION JOINT

Sawed joints shall be sealed with hot poured material meeting the requirements of the Tentative Specifications for Concrete Joint Sealer, Hot-Poured Elastic Type, ASTM Designation: D190-52 T, or sealed with a cold applied, ready-mixed concrete joint sealing compound meeting the requirements of Article 716.03

GENERAL NOTES

The 54 tests shown above of Bituminous Aggregate Mixture Pad, between and adjacent to the lugs will be considered incidental to the Lug System.

Expansion joint shall be considered incidental to the cost of Continuously Reinforced Concrete Pavement.

Details shown in Section G-G shall apply only at the end of the construction section; the 10" reinforced concrete pad, header board, wood blocking, and the 5 ft. of extended pavement reinforcement will be considered incidental to the cost of the C.R.C. Pavement.

Lug and anchorages shall be constructed at the locations shown except that when the distance between two expansion joints marked "Z" is less than 1500 ft., the anchorage shall be as shown on the detailed construction plans.

STATE OF ILLINOIS
DEPARTMENT OF PUBLIC WORKS & BUILDINGS
DIVISION OF HIGHWAYS

ISSUED 1-4-43 W.F. 3-10-69
REVISIONS J.K.P. 10-15-69
W.F. 4-1-63 W.F. 3-18-70
W.F. 6-25-65
W.F. 4-20-66
W.F. 8-11-62
W.F. 1-15-69

APPROVED: [Signature] 1970

FOR INFORMATION ONLY
FULL SIZE PLANS SHEETS ARE AVAILABLE AT THE DISTRICT 9 OFFICE
FOR REVIEW.

STANDARD 2224-8
[Full Size]
FAI 57 (I-57)
SECTION 02-(1, 1-1, 1-2, 1-3)RS-1
ALEXANDER
SHEET 21 OF 22 C.N.98905

REINFORCEMENT FOR CONTINUOUSLY REINFORCED P.C.C. PAVEMENT

BAR REINFORCEMENT

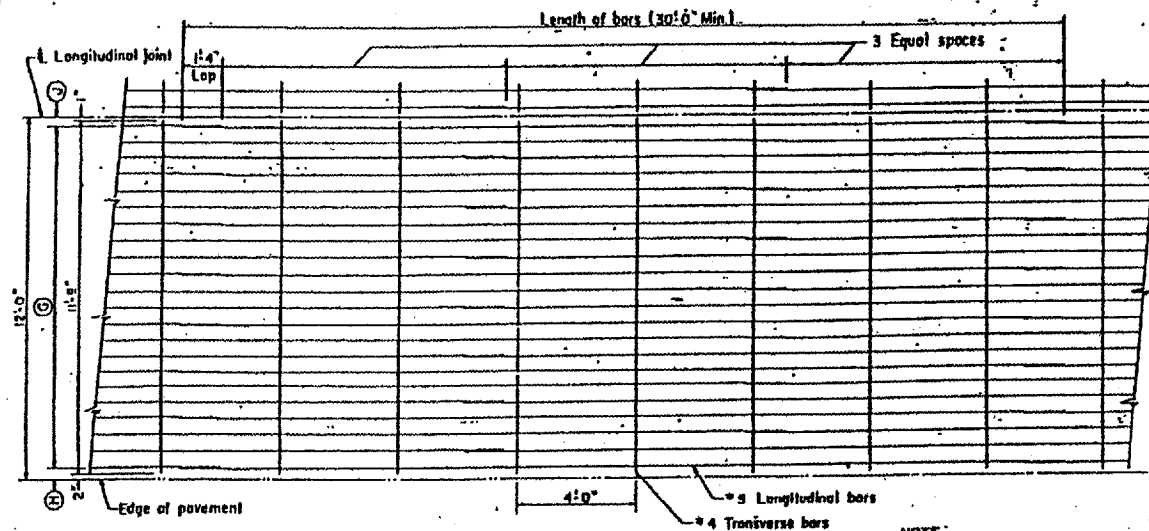

LAP DETAIL I

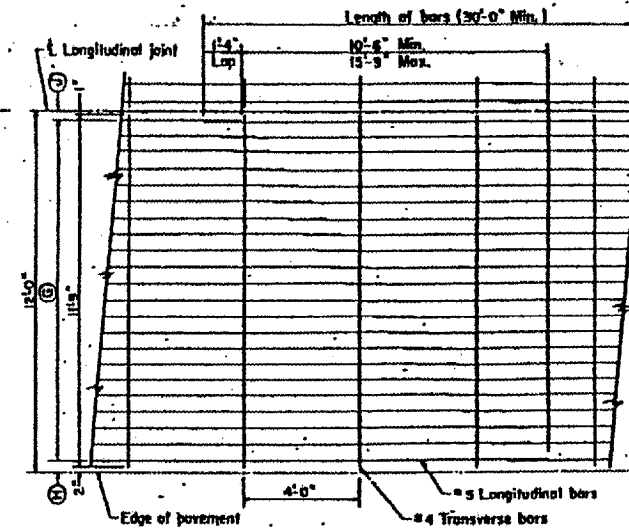

LAP DETAIL II

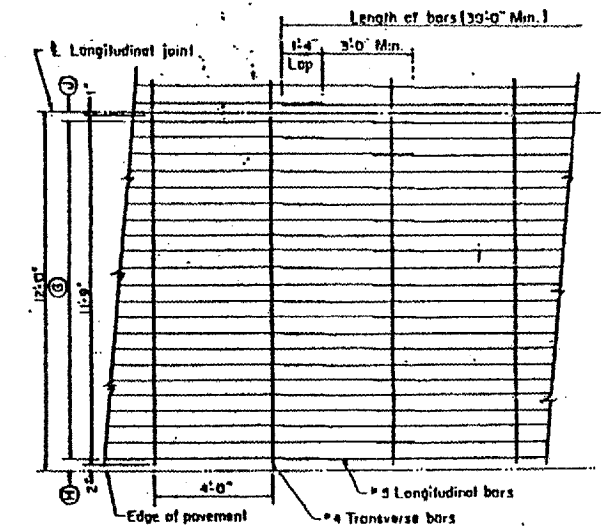

LAP DETAIL III

NOTE:
For optional transverse bar construction see
"Plans of Optional Longitudinal Sowed Joint Tie Steel"
shown on the pavement detail drawings.

FABRIC REINFORCEMENT

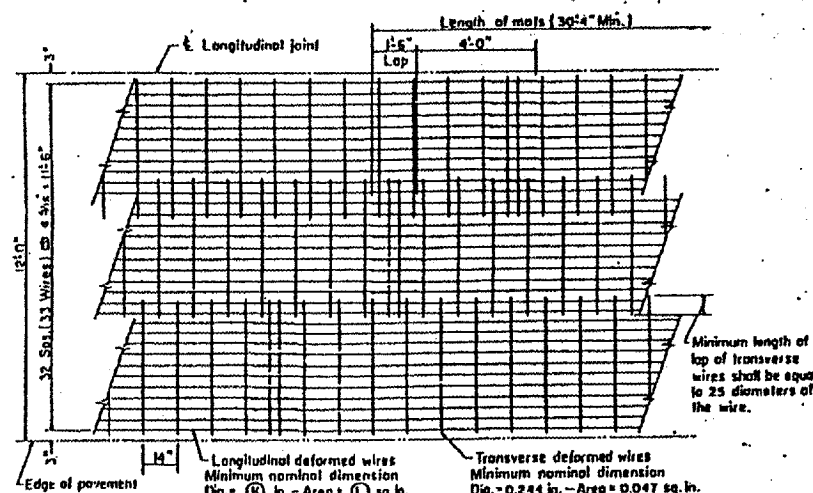

DETAIL OF 4 5/16 x 14 FABRIC

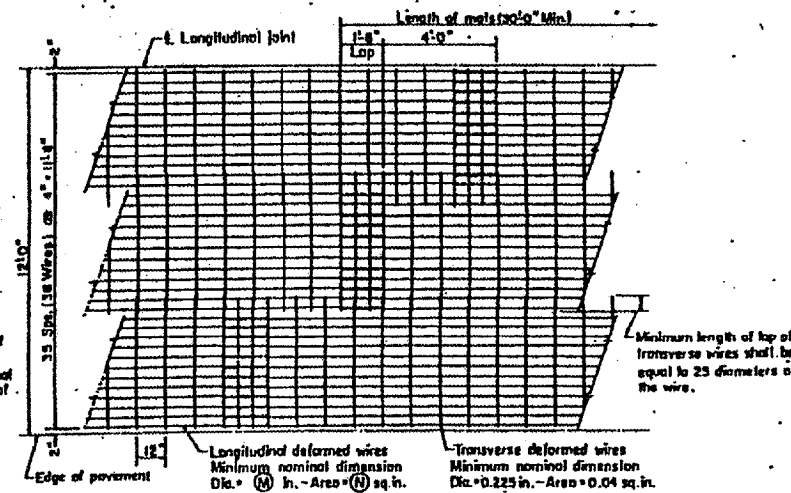

DETAIL OF 4 x 12 FABRIC

NOTE:
Fabric reinforcement may be placed in position
with the transverse wires on top or bottom of
the longitudinal wires.
When approved by the Engineer the Contractor
may use fabric widths other than those shown.
For optional transverse deformed wire construction see
"Plans of Optional Longitudinal Sowed Joint Tie Steel"
shown on the pavement detail drawings.

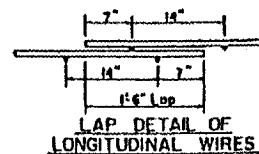

**LAP DETAIL OF
LONGITUDINAL WIRES**

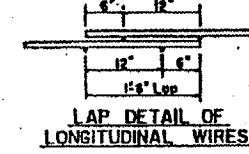

**LAP DETAIL OF
LONGITUDINAL WIRES**

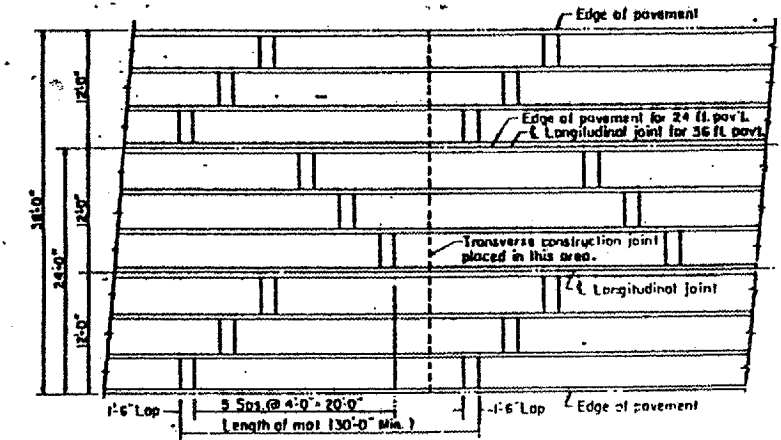

TYPICAL MAT PLACEMENT PATTERN

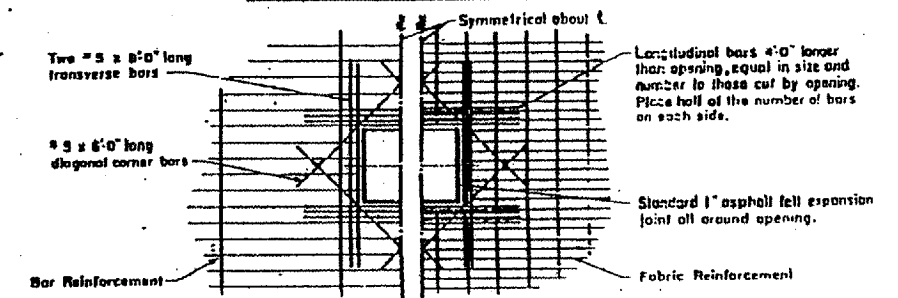

**TYPICAL DETAIL OF ADDED REINFORCEMENT AT
OPENINGS FOR MANHOLES, ETC. UP TO 4 FT. WIDE**

STATE OF ILLINOIS
DEPARTMENT OF PUBLIC WORKS & BUILDINGS
DIVISION OF HIGHWAYS
PASSED... Oct. 19, 1963
Ed. J. ...
APPROVED... Oct. 19, 1969
W. B. ...

ISSUED	REVISIONS
1-4-63	
W.F. 4-1-65	
W.F. 4-20-66	
W.F. 10-15-69	

Pav't, Thk's.	(G)	(H)	(J)	(K)	(L)	(M)	(N)
8"	21 Sps. (22 Bars) @ 6 1/2" x 11-4 1/2"	4 1/2	3 1/2	0.516	0.209	0.495	0.192
9"	24 Sps. (25 Bars) @ 5 3/4" x 11-6"	3 1/2	2 1/2	0.548	0.236	0.524	0.216

STANDARD 2225-3

FOR INFORMATION ONLY
FULL SIZE PLANS SHEETS ARE AVAILABLE AT THE DISTRICT 9 OFFICE
FOR REVIEW.

FAI 57 (1-57)
SECTION 02-(1, 1-1, 1-2, 1-3)RS-1
ALEXANDER COUNTY
SHEET 22 OF 22 CN 48905