

F.A.I. RTE.	SECTION	COUNTY	TOTAL SHEETS	SHEET NO.
57	(X1-6-2)HBK	WILLIAMSON	272	27
STA. 115+00		TO STA. END		
FED. ROAD DIST. NO. 9 ILLINOIS FED. AID PROJECT				

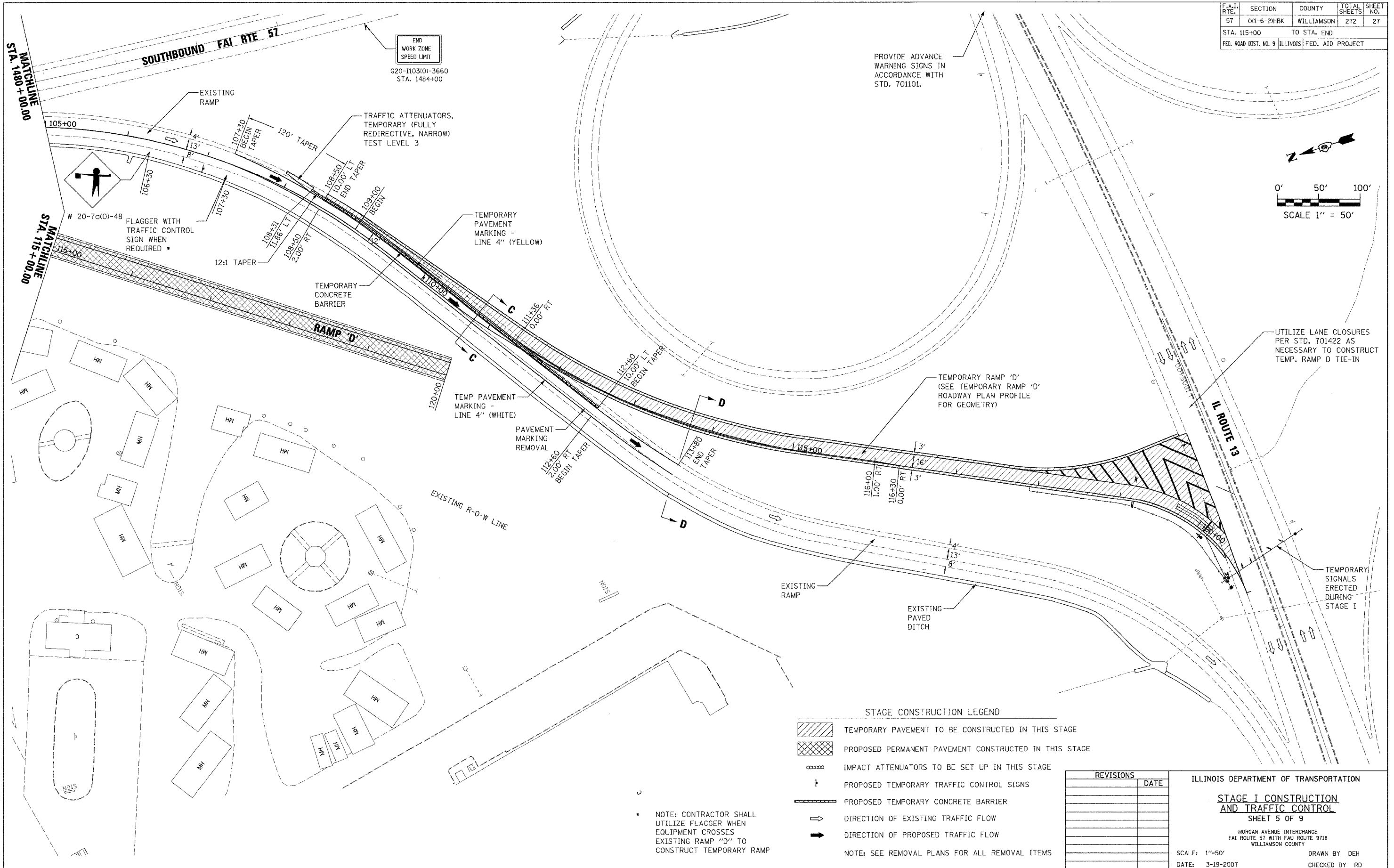
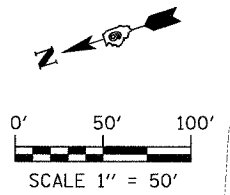

PROVIDE ADVANCE WARNING SIGNS IN ACCORDANCE WITH STD. 701101.

UTILIZE LANE CLOSURES PER STD. 701422 AS NECESSARY TO CONSTRUCT TEMP. RAMP D TIE-IN

TEMPORARY RAMP 'D' (SEE TEMPORARY RAMP 'D' ROADWAY PLAN PROFILE FOR GEOMETRY)

TEMPORARY SIGNALS ERECTED DURING STAGE I

END WORK ZONE SPEED LIMIT
G20-1103(O)-3660
STA. 1484+00

W 20-7(0)-48
FLAGGER WITH TRAFFIC CONTROL SIGN WHEN REQUIRED

NOTE: CONTRACTOR SHALL UTILIZE FLAGGER WHEN EQUIPMENT CROSSES EXISTING RAMP "D" TO CONSTRUCT TEMPORARY RAMP

STAGE CONSTRUCTION LEGEND

- TEMPORARY PAVEMENT TO BE CONSTRUCTED IN THIS STAGE
- PROPOSED PERMANENT PAVEMENT CONSTRUCTED IN THIS STAGE
- IMPACT ATTENUATORS TO BE SET UP IN THIS STAGE
- PROPOSED TEMPORARY TRAFFIC CONTROL SIGNS
- PROPOSED TEMPORARY CONCRETE BARRIER
- DIRECTION OF EXISTING TRAFFIC FLOW
- DIRECTION OF PROPOSED TRAFFIC FLOW

NOTE: SEE REMOVAL PLANS FOR ALL REMOVAL ITEMS

REVISIONS	
NO.	DATE

ILLINOIS DEPARTMENT OF TRANSPORTATION
STAGE I CONSTRUCTION AND TRAFFIC CONTROL
SHEET 5 OF 9
MORGAN AVENUE INTERCHANGE
FAI ROUTE 57 WITH FAI ROUTE 9718
WILLIAMSON COUNTY
SCALE: 1"=50'
DATE: 3-19-2007
DRAWN BY DEH
CHECKED BY RD

PLOT DATE = 3/19/2007
FILE NAME = P:\046600\046600.dgn
PLOT SCALE = 1"=50'
USER NAME = dhoerner