

F.A.I. RTE.	SECTION	COUNTY	TOTAL SHEETS	SHEET NO.
57	(X1-6-2)HRK	WILLIAMSON	272	30
STA. 1470+00		TO STA. 1484+00		
FED. ROAD DIST. NO. 9 ILLINOIS FED. AID PROJECT				

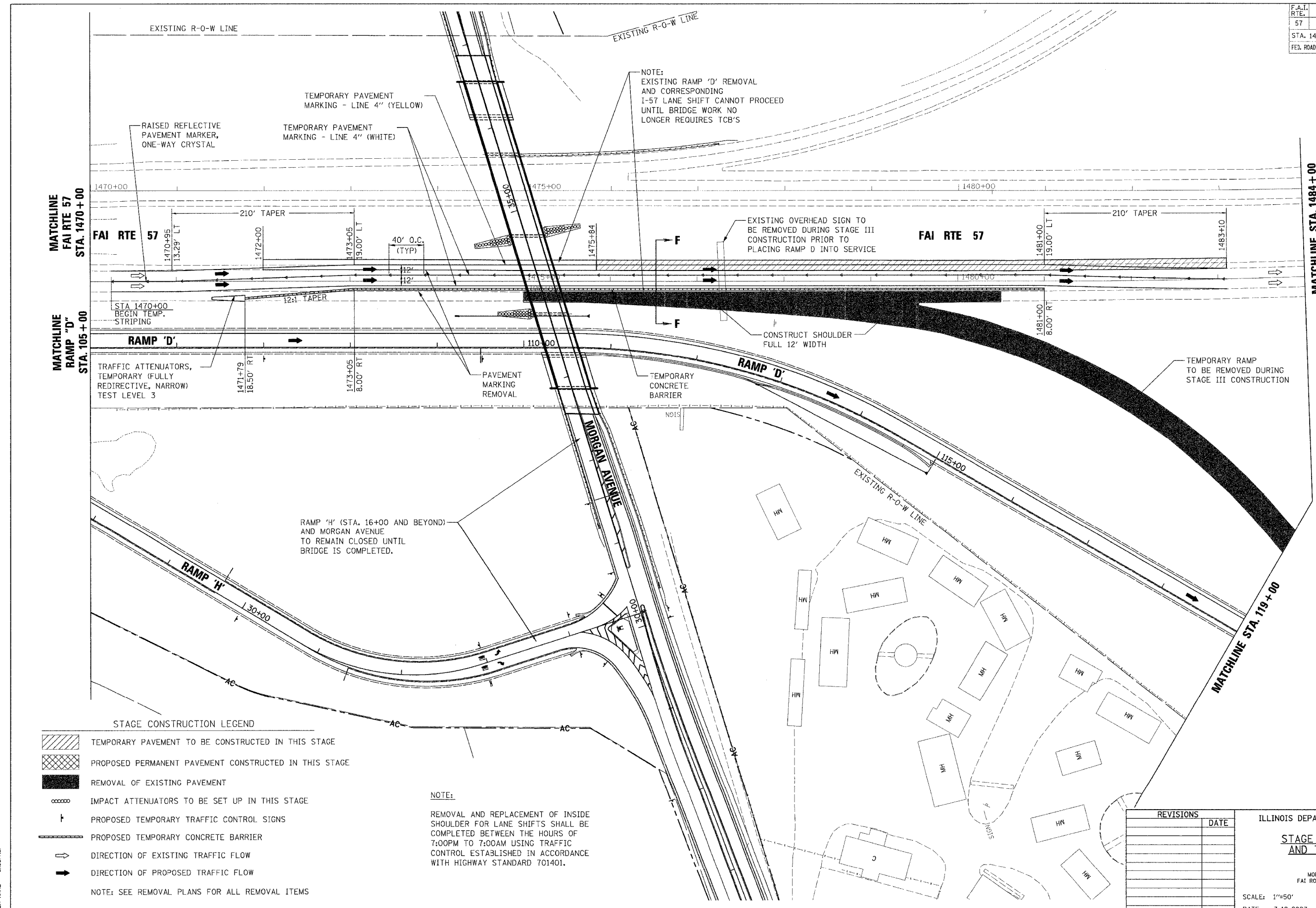
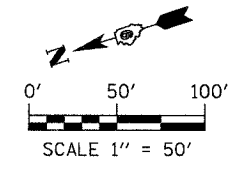

NOTE:
EXISTING RAMP 'D' REMOVAL
AND CORRESPONDING
I-57 LANE SHIFT CANNOT PROCEED
UNTIL BRIDGE WORK NO
LONGER REQUIRES TCB'S

EXISTING OVERHEAD SIGN TO
BE REMOVED DURING STAGE III
CONSTRUCTION PRIOR TO
PLACING RAMP D INTO SERVICE

CONSTRUCT SHOULDER
FULL 12' WIDTH

TEMPORARY RAMP
TO BE REMOVED DURING
STAGE III CONSTRUCTION

TEMPORARY PAVEMENT
MARKING - LINE 4" (YELLOW)

TEMPORARY PAVEMENT
MARKING - LINE 4" (WHITE)

RAISED REFLECTIVE
PAVEMENT MARKER,
ONE-WAY CRYSTAL

TRAFFIC ATTENUATORS,
TEMPORARY (FULLY
REDIRECTIVE, NARROW)
TEST LEVEL 3

PAVEMENT
MARKING
REMOVAL

TEMPORARY
CONCRETE
BARRIER

RAMP 'H' (STA. 16+00 AND BEYOND)
AND MORGAN AVENUE
TO REMAIN CLOSED UNTIL
BRIDGE IS COMPLETED.

STAGE CONSTRUCTION LEGEND

- TEMPORARY PAVEMENT TO BE CONSTRUCTED IN THIS STAGE
 - PROPOSED PERMANENT PAVEMENT CONSTRUCTED IN THIS STAGE
 - REMOVAL OF EXISTING PAVEMENT
 - IMPACT ATTENUATORS TO BE SET UP IN THIS STAGE
 - PROPOSED TEMPORARY TRAFFIC CONTROL SIGNS
 - PROPOSED TEMPORARY CONCRETE BARRIER
 - DIRECTION OF EXISTING TRAFFIC FLOW
 - DIRECTION OF PROPOSED TRAFFIC FLOW
- NOTE: SEE REMOVAL PLANS FOR ALL REMOVAL ITEMS

NOTE:
REMOVAL AND REPLACEMENT OF INSIDE
SHOULDER FOR LANE SHIFTS SHALL BE
COMPLETED BETWEEN THE HOURS OF
7:00PM TO 7:00AM USING TRAFFIC
CONTROL ESTABLISHED IN ACCORDANCE
WITH HIGHWAY STANDARD 701401.

REVISIONS	DATE

ILLINOIS DEPARTMENT OF TRANSPORTATION

**STAGE III CONSTRUCTION
AND TRAFFIC CONTROL**

SHEET 8 OF 9

MORGAN AVENUE INTERCHANGE
FAI ROUTE 57 WITH FAU ROUTE 971B
WILLIAMSON COUNTY

SCALE: 1"=50'
DATE: 3-19-2007

DRAWN BY: DEH
CHECKED BY: RD

PLOT DATE = 3/19/2007
 FILE NAME = P:\0408994\dm\9408994.dgn
 PLOT SCALE = 50.0000 / 1.00
 USER NAME = dhooper