

F.A.I. RTE.	SECTION	COUNTY	TOTAL SHEETS	SHEET NO.
57	CX1-6-2JHBK	WILLIAMSON	272	85
STA. 235+00		TO STA. 265+00		
FED. ROAD DIST. NO. 9		ILLINOIS FED. AID PROJECT		

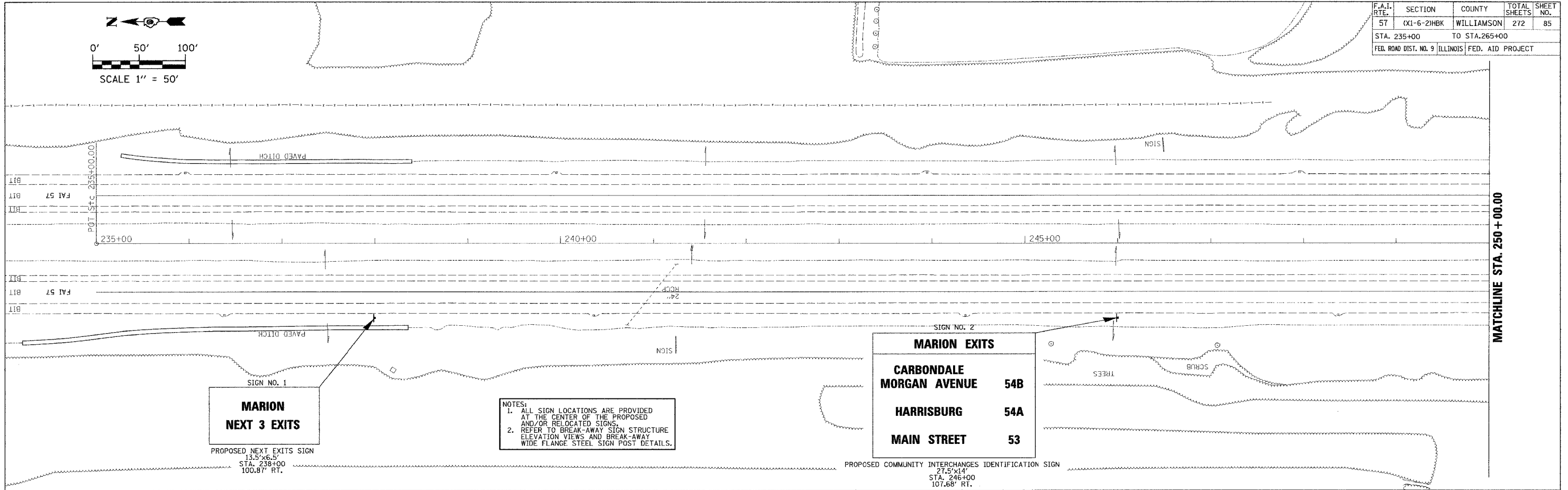
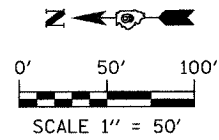

SIGN NO. 1
MARION
NEXT 3 EXITS
 PROPOSED NEXT EXITS SIGN
 13.5'x36.5'
 STA. 238+00
 100.87' RT.

NOTES:
 1. ALL SIGN LOCATIONS ARE PROVIDED AT THE CENTER OF THE PROPOSED AND/OR RELOCATED SIGNS.
 2. REFER TO BREAK-AWAY SIGN STRUCTURE ELEVATION VIEWS AND BREAK-AWAY WIDE FLANGE STEEL SIGN POST DETAILS.

SIGN NO. 2
MARION EXITS
CARBONDALE
MORGAN AVENUE 54B
HARRISBURG 54A
MAIN STREET 53

PROPOSED COMMUNITY INTERCHANGES IDENTIFICATION SIGN
 27.5'x14'
 STA. 246+00
 107.68' RT.

MATCHLINE STA. 250+00.00

MATCHLINE STA. 265+00.00

PLOT DATE = 3/18/2007
 FILE NAME = F:\046680\sign\04060809.dgn
 PLOT SCALE = 50.0000 / IN.
 USER NAME = chester

MATCHLINE STA. 250+00.00

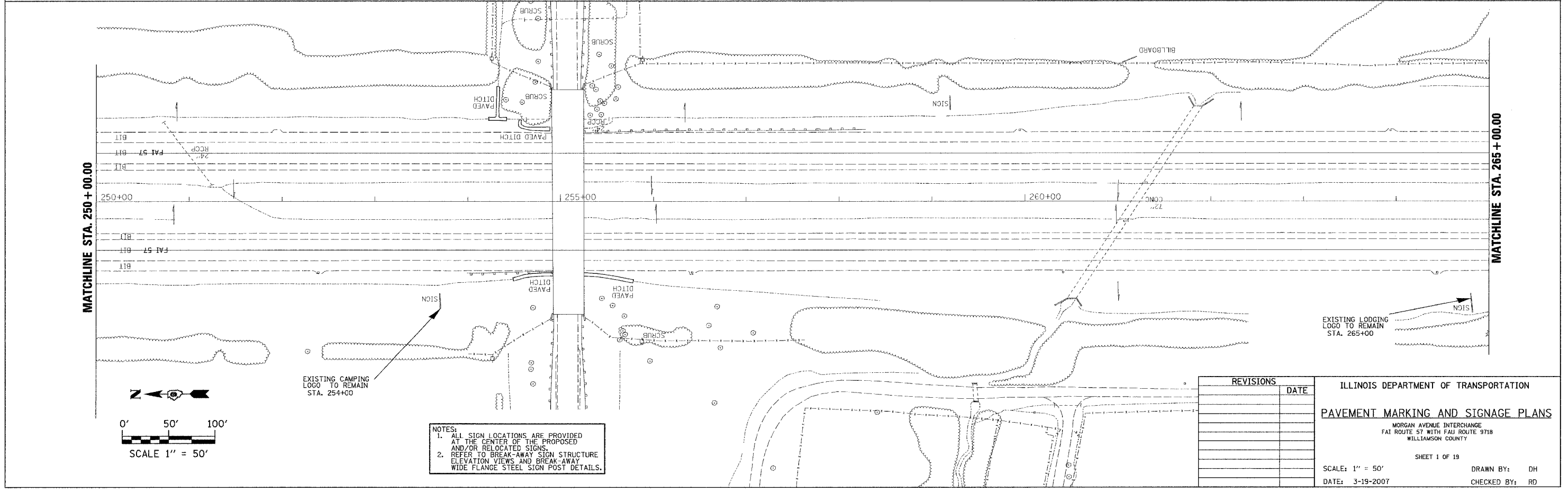
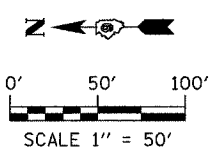

NOTES:
 1. ALL SIGN LOCATIONS ARE PROVIDED AT THE CENTER OF THE PROPOSED AND/OR RELOCATED SIGNS.
 2. REFER TO BREAK-AWAY SIGN STRUCTURE ELEVATION VIEWS AND BREAK-AWAY WIDE FLANGE STEEL SIGN POST DETAILS.

REVISIONS	DATE

ILLINOIS DEPARTMENT OF TRANSPORTATION
PAVEMENT MARKING AND SIGNAGE PLANS
 MORGAN AVENUE INTERCHANGE
 FAI ROUTE 57 WITH FAU ROUTE 9718
 WILLIAMSON COUNTY
 SHEET 1 OF 19
 SCALE: 1" = 50'
 DATE: 3-19-2007
 DRAWN BY: DH
 CHECKED BY: RD

EXISTING CAMPING LOGO TO REMAIN
 STA. 254+00

EXISTING LODGING LOGO TO REMAIN
 STA. 265+00