

F.A.I. RTE.	SECTION	COUNTY	TOTAL SHEETS	SHEET NO.
57	0X1-6-2HNBK	WILLIAMSON	272	90
STA. 386+00		TO STA. 416+00		
FED. ROAD DIST. NO. 9		ILLINOIS FED. AID PROJECT		

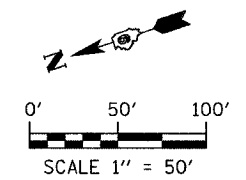

NOTES:
 1. ALL SIGN LOCATIONS ARE PROVIDED AT THE CENTER OF THE PROPOSED AND/OR RELOCATED SIGNS.
 2. REFER TO BREAK-AWAY SIGN STRUCTURE ELEVATION VIEWS AND BREAK-AWAY WIDE FLANGE STEEL SIGN POST DETAILS.

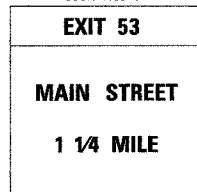
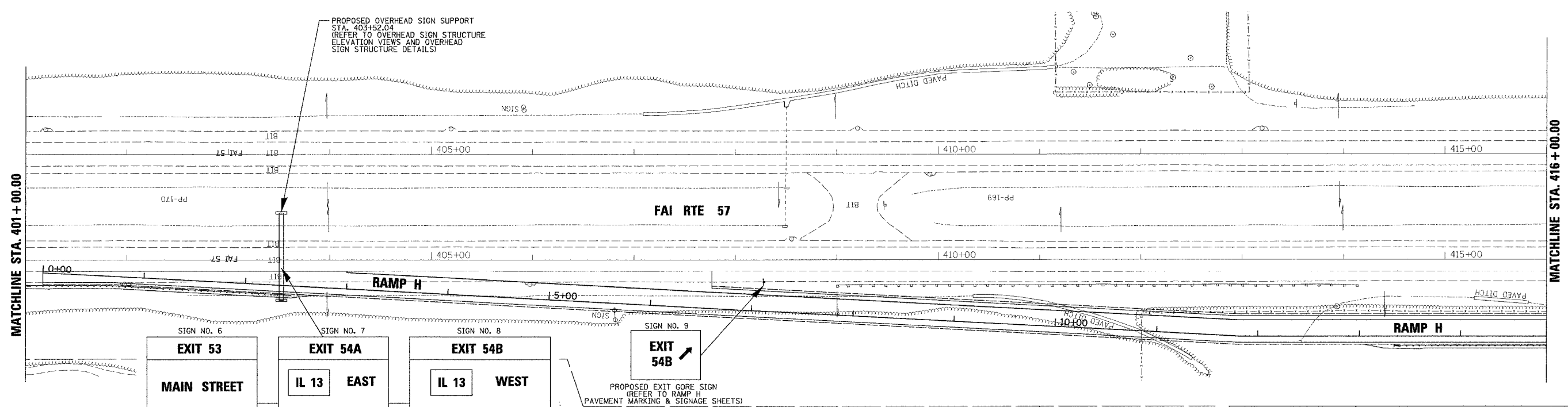
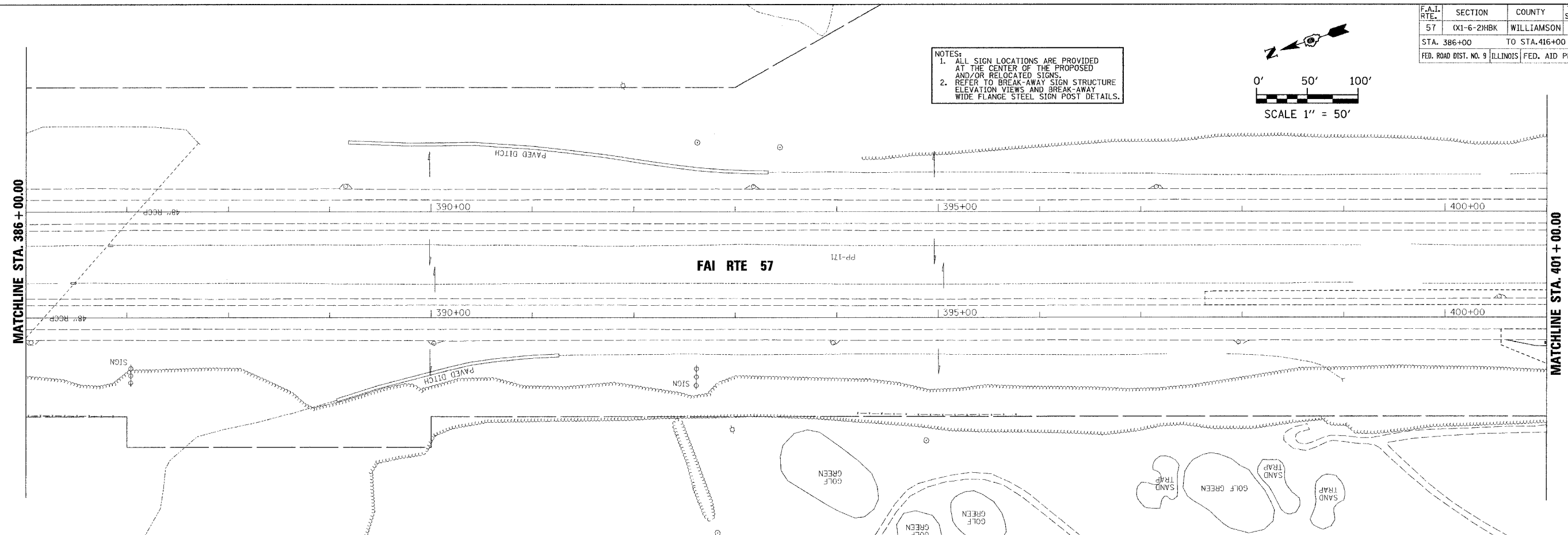

PROPOSED GUIDE SIGN (E1-2) 16.5'x7.5' & EXIT PLAQUE (E1-5) 16.5'x2.5' STA. 403+52.04 (REFER TO OVERHEAD SIGN STRUCTURE DETAILS FOR LOCATION OF SIGN ON OVERHEAD SIGN SUPPORT)

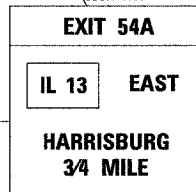

PROPOSED GUIDE SIGN (E1-2) 14'x10.5' & EXIT PLAQUE (E1-5) 14'x2.5' STA. 403+52.04 (REFER TO OVERHEAD SIGN STRUCTURE DETAILS FOR LOCATION OF SIGN ON OVERHEAD SIGN SUPPORT)

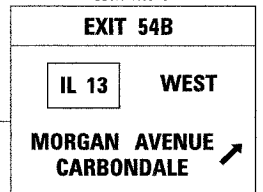

PROPOSED GUIDE SIGN (E1-2) 24.5'x10.5' & EXIT PLAQUE (E1-5) 24.5'x2.5' STA. 403+52.04 (REFER TO OVERHEAD SIGN STRUCTURE DETAILS FOR LOCATION OF SIGN ON OVERHEAD SIGN SUPPORT)



PROPOSED EXIT GORE SIGN (REFER TO RAMP H PAVEMENT MARKING & SIGNAGE SHEETS)

NOTES:
 1. ALL SIGN LOCATIONS ARE PROVIDED AT THE CENTER OF THE PROPOSED AND/OR RELOCATED SIGNS.
 2. REFER TO BREAK-AWAY SIGN STRUCTURE ELEVATION VIEWS AND BREAK-AWAY WIDE FLANGE STEEL SIGN POST DETAILS.

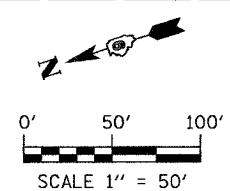

REVISIONS	DATE

ILLINOIS DEPARTMENT OF TRANSPORTATION
PAVEMENT MARKING AND SIGNAGE PLANS
 MORGAN AVENUE INTERCHANGE
 FAI ROUTE 57 WITH FAU ROUTE 9718
 WILLIAMSON COUNTY
 SHEET 6 OF 19
 SCALE: 1" = 50'
 DATE: 3-19-2007
 DRAWN BY: DH
 CHECKED BY: RD

PLOT DATE = 3/19/2007
 FILE NAME = P:\0486800\0486800.dgn
 PLOT SCALE = 1/8" = 1'-0"
 USER NAME = dbrunner