

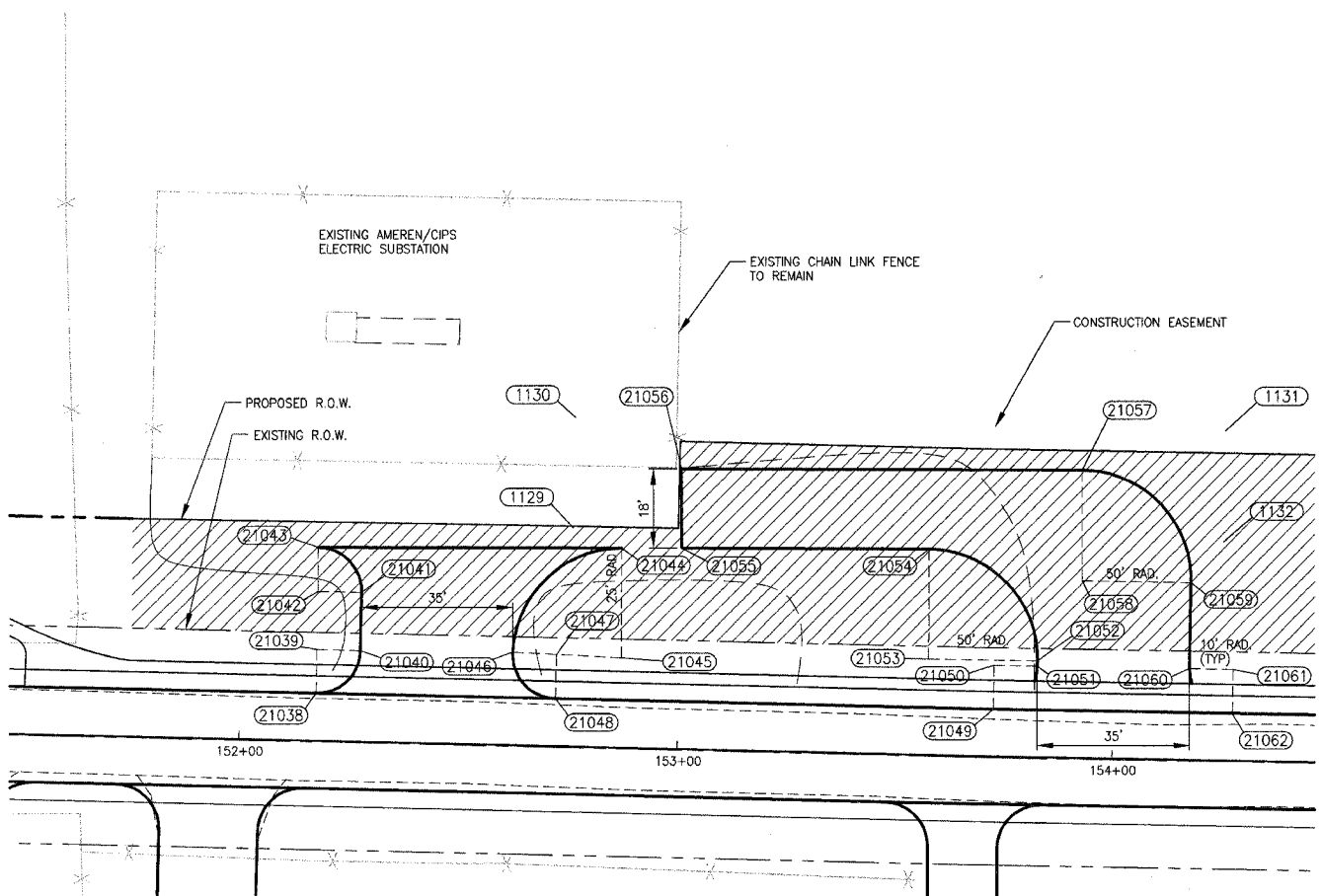

SCALE: 1" = 20'



COORDINATE POINTS					
NODE	NORTHING	EASTING	STATION	OFFSET	ELEVATION
1129	347345.2793	825000.6484	152+75.79	50.00 L	---
1130	347370.2732	825001.2003	152+75.79	75.00 L	---
1131	347367.2987	825150.7336	154+25.79	75.00 L	---
1132	347342.3020	825150.3273	154+25.79	50.00 L	---
21038	347307.5764	824941.5118	152+17.5036	11.0000 L	563.62
21039	347317.5740	824941.7325	152+17.5036	21.0000 L	---
21040	347317.3532	824951.7301	152+27.5036	21.0000 L	565.08
21041	347330.6953	824952.0247	152+27.5036	34.3453 L	566.32
21042	347330.9160	824942.0271	152+17.5036	34.3453 L	---
21043	347340.9160	824942.0495	152+17.5036	44.3453 L	567.80
21044	347340.7601	825011.7655	152+87.0077	45.7264 L	568.90
21045	347315.7601	825011.7096	152+87.0077	20.7314 L	---
21046	347317.0423	824986.7425	152+62.5143	21.4621 L	565.71
21047	347316.3598	824996.7191	152+72.5036	21.0000 L	---
21048	347306.3623	824996.4984	152+72.5036	11.0000 L	564.35
21049	347304.1610	825097.2005	153+73.2939	11.0000 L	563.89
21050	347314.1596	825097.3630	153+73.2939	21.0000 L	---
21051	347315.9672	825107.3617	153+83.2939	21.0001 L	565.34
21052	347315.1858	825107.3811	153+83.2939	22.1989 L	565.45
21053	347315.6021	825082.3844	153+58.1648	22.1335 L	---
21054	347340.6020	825082.4404	153+57.6688	47.1286 L	569.10
21055	347340.7292	825025.5540	153+00.7935	46.0000 L	569.30
21056	347358.7292	825025.5943	153+00.4364	63.9965 L	569.00
21057	347358.5331	825117.7563	153+92.9435	65.6887 L	568.00
21058	347333.5232	825117.8603	153+83.2939	40.6912 L	---
21059	347333.1169	825142.6770	154+18.2939	40.6912 L	566.03
21060	347313.4284	825142.3570	154+18.2939	21.0001 L	564.16
21061	347313.2658	825152.3557	154+28.2939	21.0000 L	---
21062	347303.2671	825152.1932	154+28.2939	11.0000 L	562.67

DETAIL OF ENTRANCE TO AMEREN/C.I.P.S. SUBSTATION

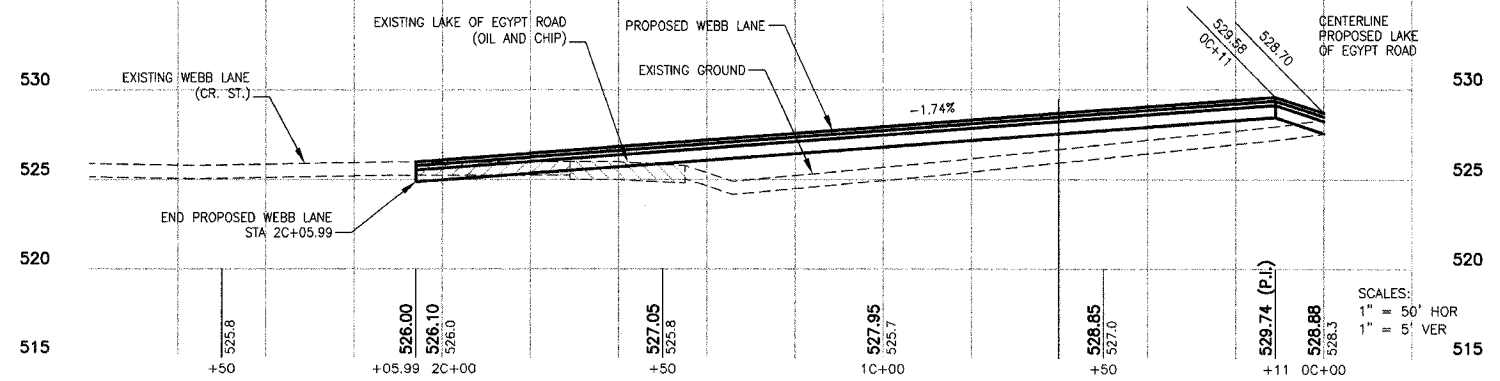
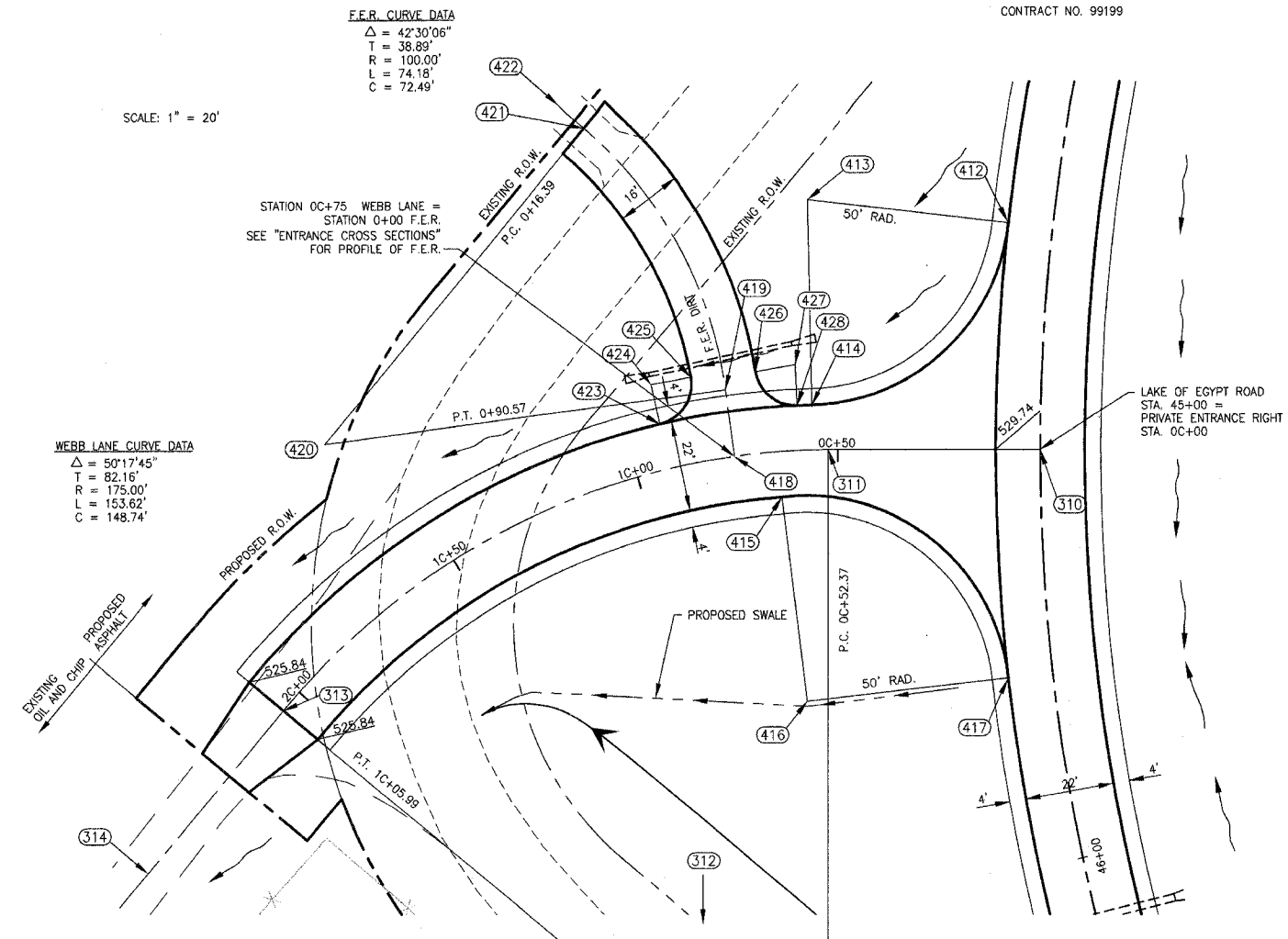

COORDINATE POINTS				
POINT NO.	DESCRIPTION	NORTHING	EASTING	ELEVATION
310	STA. DC+00 (DRIVE)	347497.35	814436.65	528.70
311	P.C.	347463.97	814396.29	528.80
312	CENTER POINT	347329.11	814507.82	---
313	P.T.	347329.46	814332.82	526.00
314	P.O.L.	347277.11	814332.72	---
412	END RADIUS	347934.93	814395.38	530.91
413	CENTER POINT	347507.65	814353.48	---
414	END RADIUS	347469.82	814386.18	528.70
415	END RADIUS	347447.97	814394.72	528.48
416	CENTER POINT	347413.68	814431.20	---
417	END RADIUS	347449.73	814465.86	528.97
418	STA. 0+00 (F.E.R.)	347447.96	814379.37	528.40
419	P.C.	347459.09	814367.34	528.33
420	CENTER POINT	347385.69	814299.43	---
421	P.T.	347485.69	814299.91	528.20
422	P.O.L.	347485.73	814291.59	---
423	END RADIUS	347442.30	814360.22	528.01
424	CENTER POINT	347448.38	814352.29	---
425	END RADIUS	347456.03	814358.73	528.20
426	END RADIUS	347497.28	814370.19	528.20
427	CENTER POINT	347474.83	814376.84	---
428	END RADIUS	347467.40	814383.43	528.64

INTERSECTION DETAILS LAKE OF EGYPT ROAD AND WEBB LANE

(LAKE OF EGYPT ROAD STA. 45+00 = PRIVATE ENTRANCE RIGHT STA. 0C+00)

STATE OF ILLINOIS PROFESSIONAL DESIGN FIRM LICENSE NO. 184-000872

© 2007 ALL RIGHTS RESERVED

**CLARIDA & ZIEGLER
ENGINEERING CO.**

308 South Court St., P.O. Box 937
Marion, Illinois 62959
Phone - (618)993-6411, Fax - (618)993-6750

PRIVATE DRIVE DETAILS
LAKE OF EGYPT ROAD
WILLIAMSON COUNTY, ILLINOIS

Date 02/15/02 DR. By T.W. CK'D By H.G.C.
Scale 1" = 20' Job No. 00044 Sheet No. 43 of 86