

ROUTE	SECTION	COUNTY	TOTAL SHEETS	SHEET NUMBER
TR-131	03-01176-00-BR	UNION	2	12A
JOB. NO. C-99-542-04		PROJECT NO. BROS-0181 (039)		
MORGAN SCHOOL ROAD		CONTRACT NO. 99214		

LEGEND

□	- POWER POLE
□ TP	- TELEPHONE PEDESTAL
⊕	- FIRE HYDRANT
WM ○	- WATER METER
— 6" W	- 6" PVC WATER MAIN
MB	- MAIL BOX
—	- SIGN
CMP	- CORRUGATED METAL PIPE CULVERT
FL	- FLOW LINE
TW	- TOP OF WALL
TD	- TOP OF BRIDGE DECK
— X —	- FENCE
---	- EXISTING RIGHT-OF-WAY
---	- PROPOSED RIGHT-OF-WAY
---	- EXISTING CONTOUR
---	- PROPOSED CONTOUR

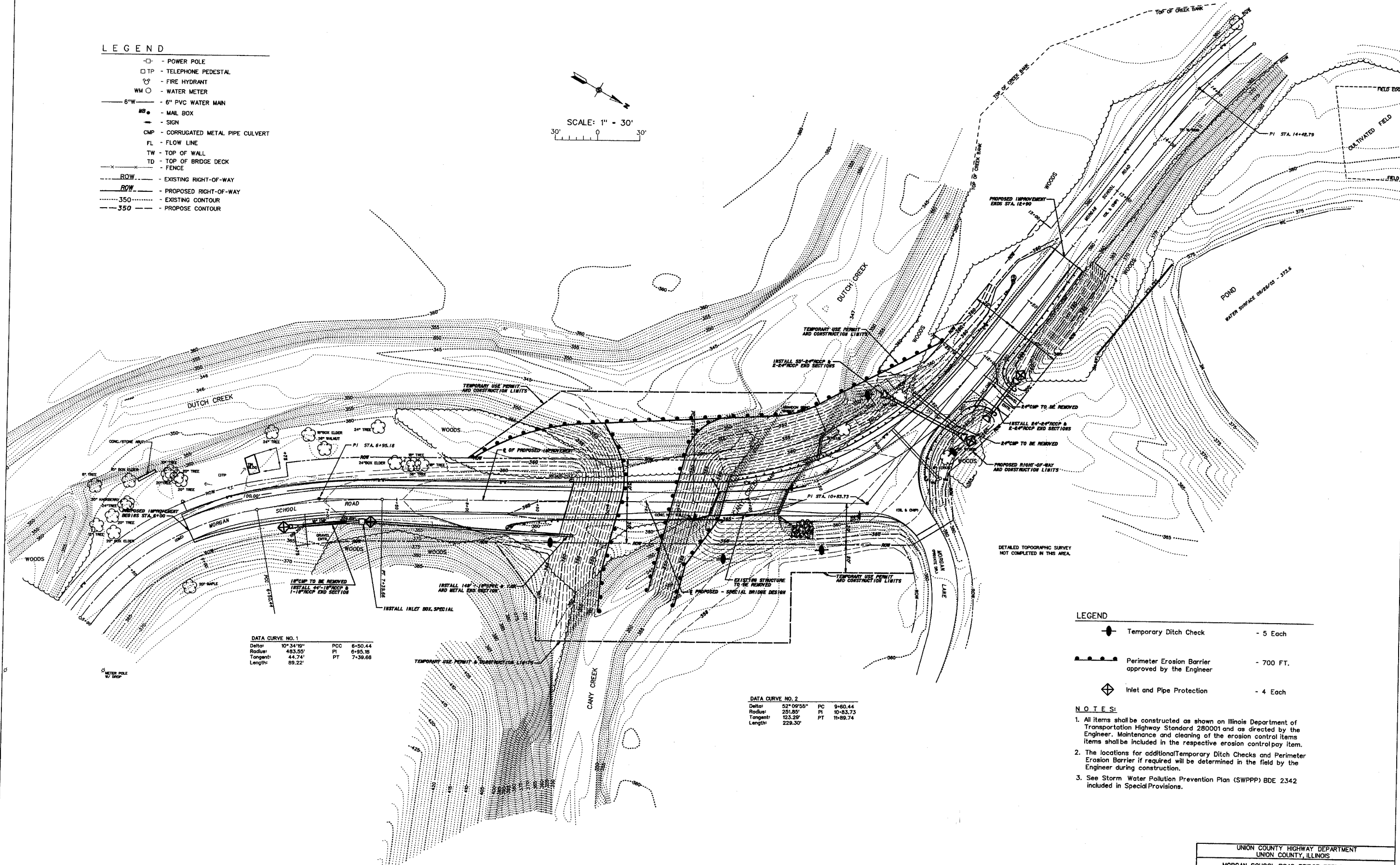
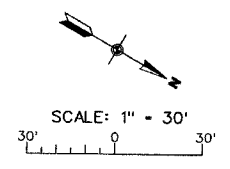

DATA CURVE NO. 1

Delta:	10° 34' 19"	PCC	6+50.44
Radius:	483.55'	PI	6+95.18
Tangent:	44.74'	PT	7+39.66
Length:	89.22'		

DATA CURVE NO. 2

Delta:	52° 09' 55"	PC	9+60.44
Radius:	251.85'	PI	10+83.73
Tangent:	123.29'	PT	11+89.74
Length:	229.30'		

LEGEND

⊕	Temporary Ditch Check	- 5 Each
— X —	Perimeter Erosion Barrier approved by the Engineer	- 700 FT.
⊕	Inlet and Pipe Protection	- 4 Each

- NOTES:**
- All items shall be constructed as shown on Illinois Department of Transportation Highway Standard 280001 and as directed by the Engineer. Maintenance and cleaning of the erosion control items shall be included in the respective erosion control pay item.
 - The locations for additional Temporary Ditch Checks and Perimeter Erosion Barrier if required will be determined in the field by the Engineer during construction.
 - See Storm Water Pollution Prevention Plan (SWPPP) BDE 2342 included in Special Provisions.

UNION COUNTY HIGHWAY DEPARTMENT
UNION COUNTY, ILLINOIS
MORGAN SCHOOL ROAD BRIDGE REPLACEMENT
STORM WATER POLLUTION PREVENTION PLAN