

F.A.S. ROUTE	SECTION	COUNTY	TOTAL SHEETS	SHEET NO.
1879	06-00095-00-RS	HAMILTON	2	1
FED. ROAD DIST. NO. 9 ILLINOIS		CONTRACT # 99281		

STATE OF ILLINOIS
DEPARTMENT OF TRANSPORTATION

**PLANS FOR PROPOSED
FEDERAL-AID SECONDARY SECTION
PAVEMENT PRESERVATION PROGRAM**

INDEX OF SHEETS

SHEET #	DESCRIPTION
1.	COVER SHEET
2.	TYPICAL CROSS SECTION; NOTES & QUANTITIES

INDEX OF STANDARDS

STD #	DESCRIPTION
000001-04	STANDARD SYMBOLS, ABBREVIATIONS & PATTERNS
701006-02	OFF-RD OPERATIONS, 2L, 2W, 4.5m (15') TO 600mm (24") FROM PAVEMENT EDGE
701301-02	LANE CLOSURE, 2L, 2W, SHORT TIME OPERATION
001306-01	LANE CLOSURE, 2L, 2W, SLOW MOVING OPERATIONS, DAY ONLY FOR SPEEDS ≥ 45 MPH
701311-02	LANE CLOSURE, 2L, 2W, MOVING DAY ONLY OPERATIONS
702001-06	TRAFFIC CONTROL DEVICES
780001-01	TYPICAL PAVEMENT MARKINGS

ROUTE NO. FAS 1879 (CH 7)
SECTION 06-00095-00-RS
PROJECT RS-1879(116)
JOB NO. C-99-555-06
HAMILTON COUNTY

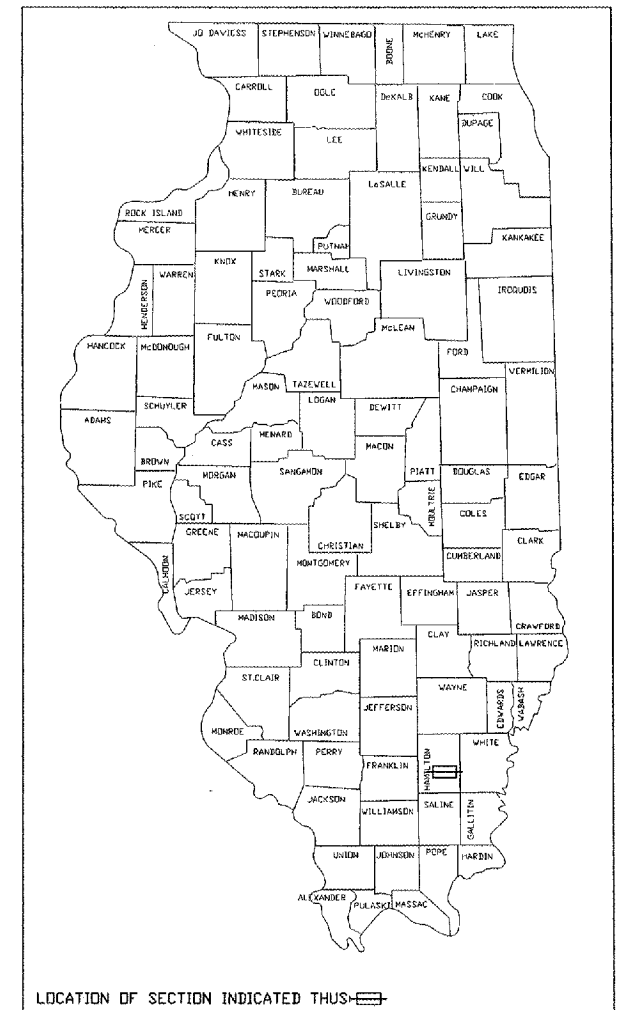

SECTION 06-00095-00-RS

IMPROVEMENT BEGINS
STATION 1+11

BRIDGE OMISSION
STA. 80+09.9 - STA 80+90.1

IMPROVEMENT ENDS
STA. 163+25

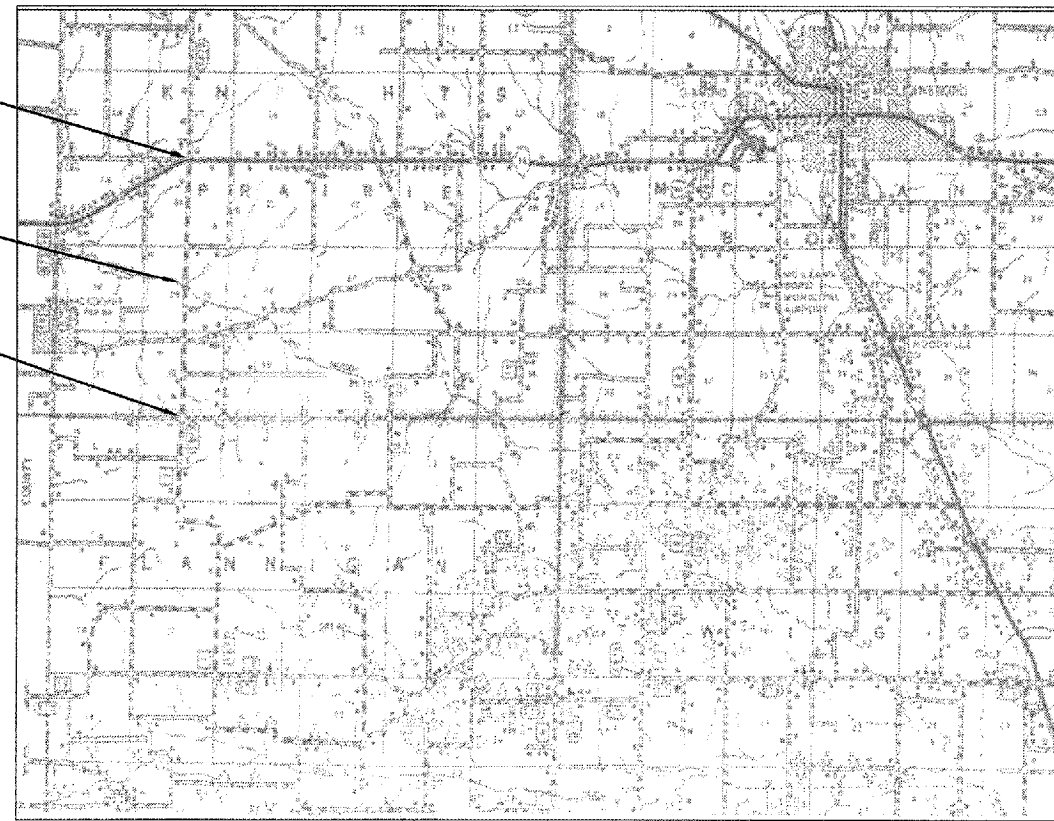

LAYOUT

APPROXIMATE SCALE: 1/2" = 1 MILE

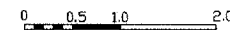

SUMMARY OF QUANTITIES

QUANTITY	UNIT	ITEM	CODE NO.
36,250	SQ YD	MICRO-SURFACING SINGLE PASS	X4480100
7,500	PDUM	CRACK FILLING	45100200
1	L SUM	MOBILIZATION	67100100
1	L SUM	TRAFFIC CONTROL AND PROTECTION STD 701306	70100460
40,877	FOOT	PAINT PAVEMENT MARKING - LINE 4'	78001110 *
10	FOOT	PAINT PAVEMENT MARKING - LINE 24'	78001180 *

J.U.L.I.E.
JOINT UTILITY LOCATION INFORMATION FOR EXCAVATION
1-800-892-0123



AGENCY RESPONSIBLE FOR LETTING	
APPROVED	3-13-07 <i>Kenn D. Diller</i> COUNTY ENGINEER
PASSED	3/19/07 <i>Dennis W. Hillebrum</i> DISTRICT 9 ENGINEER OF LOCAL ROADS & STREETS
RELEASING FOR BID, BASED ON LIMITED REVIEW	3-20-07 <i>Mary C. Lammie</i> MARY C. LAMMIE, PE DEPUTY DIRECTOR OF HIGHWAY REGION FIVE ENGINEER

CONTRACT NO. 99281
DESIGN CLASS: MAJOR COLLECTOR
CURRENT A.D.T. = 320
DESIGN SPEED = 50 MPH

TOTAL LENGTH OF IMPROVEMENTS: 16,214.00 FEET 3.071 MILES
OMISSION (STA 80+09.9 to STA 80+90.1) : 80.20 FEET 0.015 MILES
NET LENGTH OF IMPROVEMENTS: 16,133.80 FEET 3.056 MILES



EXPIRES 11/30/2007

THE ACCEPTANCE OF THIS PROJECT IS
BASED ON THE MINIMUM DESIGN CRITERIA FOR
A FEDERAL-AID L.A.P.P. TYPE IMPROVEMENT
ON THE COUNTY HIGHWAY SYSTEM.
Dennis W. Hillebrum
DISTRICT 9 ENGINEER OF LOCAL ROADS & STREETS

F.A.S. ROUTE	SECTION	COUNTY	TOTAL SHEETS	SHEET NO.
1879	06-00095-00-RS	HAMILTON	2	2
FED. ROAD DIST. NO. 9 ILLINOIS				

CONTRACT # 99281

TYPICAL CROSS SECTION OF EXISTING ROAD

STA 1+11 TO STA 163+25

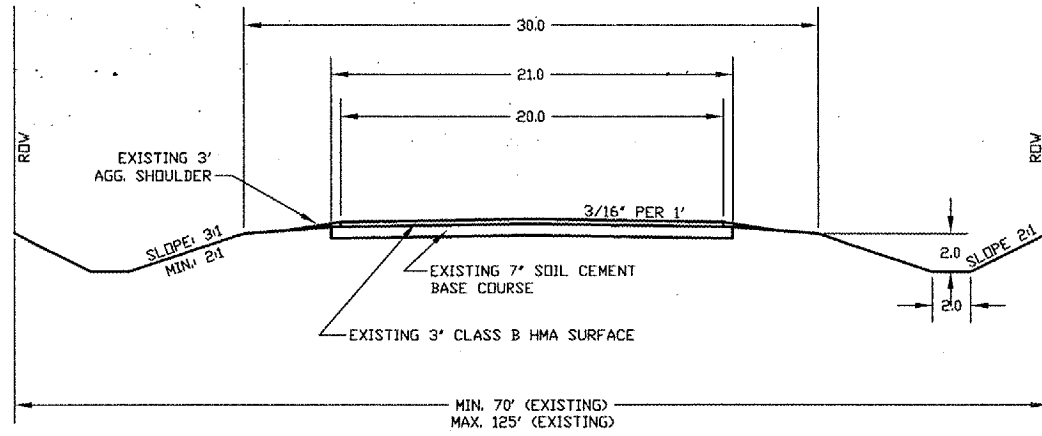

GENERAL NOTES:

This Section consists of Micro-Surfacing, Single Pass, Type II, 11 kg/sq m (20 lb/sq yd) beginning at the south edge of State Route 14 and continuing south for 3.071 miles, omitting the Bridge Structure at Station 80+40. All in accordance with the Plans, Special Provisions and Standard Specifications.

The Contractor shall devise and submit a joint plan that meets the approval of the Engineer. Crack sealing shall be completed at least three days prior to the micro-surfacing. The fiber-asphalt filler shall be applied only when the joints and cracks are dry and free of dirt, vegetation, debris and loose filler. All joints and cracks to be filled shall be blown clean with an air compressor equipped with a lance using compressed air. The cleaning operations shall be kept close to the filling operations to prevent debris being carried back into the joints and cracks before filling.

The existing surface is Bituminous Plant Mix (Class B) HMA laid in 1984.

SCHEDULE OF NO PASSING ZONES

STATION TO	STATION	LOCATION	LENGTH - FT
112+70	131+10	RT.	1840
122+20	139+50	LT.	1730
151+25	160+60	RT.	935
TOTAL			4505

SCHEDULE OF DOUBLE NO PASSING ZONES

STATION TO	STATION	LENGTH - FT
122+20	131+10	890

STRAIGHT LINE DIAGRAM

STA 1+00 TO STA 163+25
SCALE: 1" = 400'

