

T.R.	SECTION	COUNTY	TOTAL SHEETS	SHEET NO.
239A	04-08125-00-BR	HAMILTON	12	3
FED. ROAD DIST. NO. 9 ILLINOIS		LAKEY CREEK		
PROJECT # BR05-0651381		CONTRACT # 99288		

323 W. 3RD ST.
P.O. BOX 160
MT. CARMEL, IL
62863
PHONE: (618)-262-8651
FAX: (618)-263-3327

406 W. STATE ST.
SUITE
PRINCETON, IN
47670
PHONE: (312)-386-7611
FAX: (312)-385-2812

PROFESSIONAL
DESIGN FIRM
LAND SURVEY &
PROFESSIONAL
ENGINEERING
CORPORATION
184-000887
(62-032435)(35-002769)

AARON M. MEFFORD
NAME
Aaron M. Mefford
SIGNATURE
DATE
3-28-07
11-30-07
EXPIRES

McLEANSBORO TOWNSHIP
OVER LAKEY CREEK
HAMILTON COUNTY, ILLINOIS

SHEET TITLE:
CROSS-SECTIONS
SCALE: 1" = 5'
BY: AMM
DATE: 9/9/07
REV:
3 OF 12 SHEETS
SHEET NO.
3

C = 4.0
F = 121.0

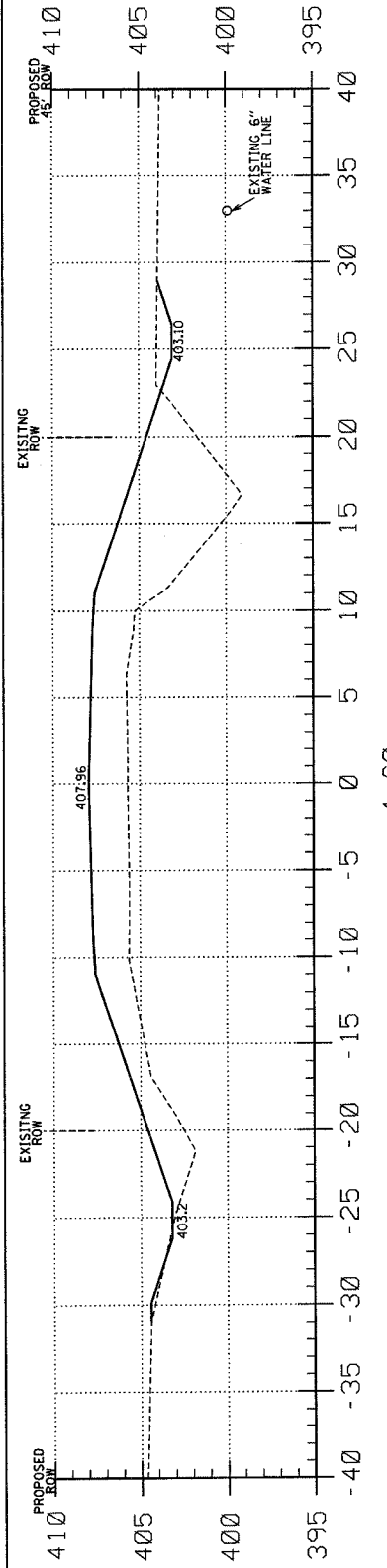

C = 4.2
F = 86.5

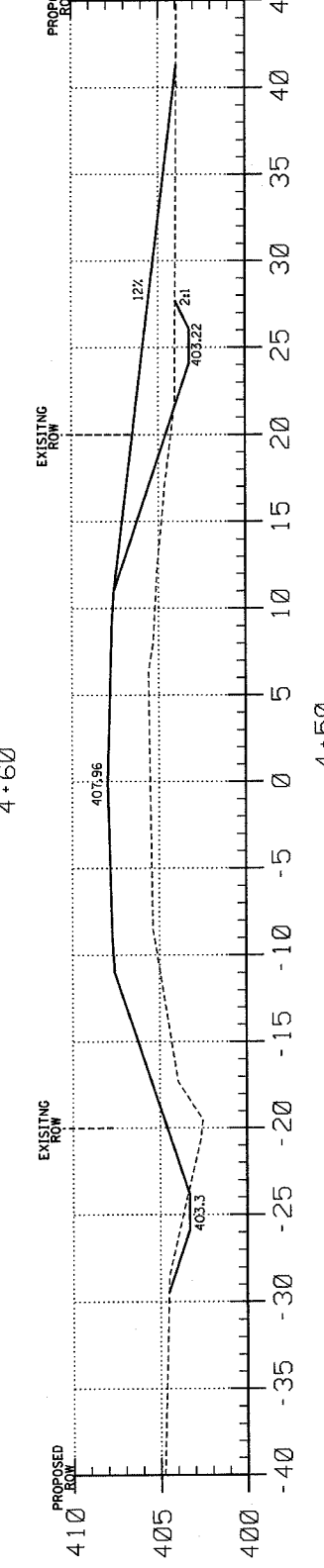

C = 6.7
F = 91.6

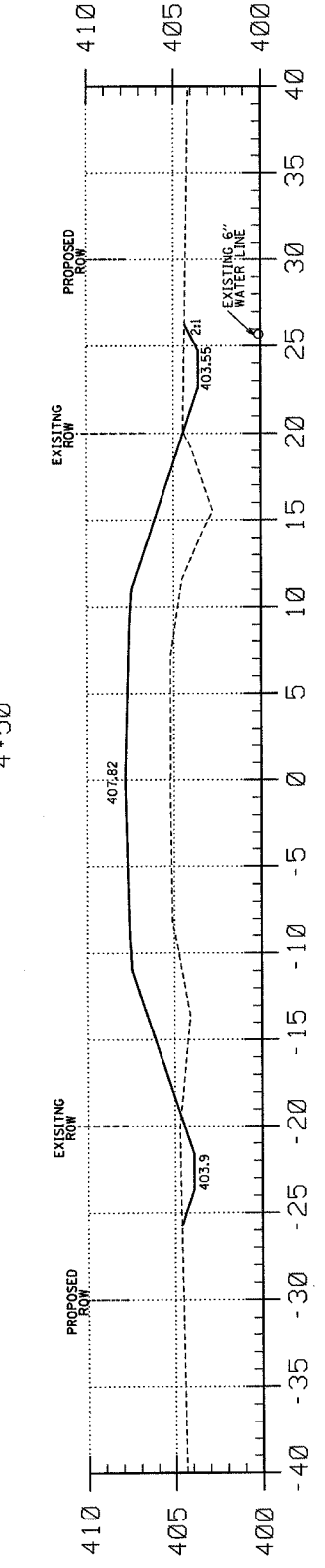

C = 5.5
F = 30.0

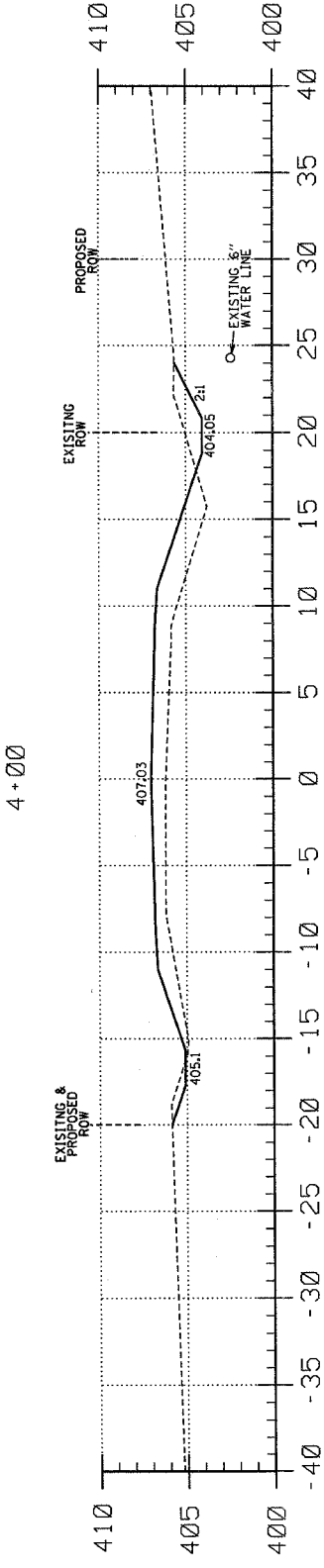

C = 7.1
F = 8.7

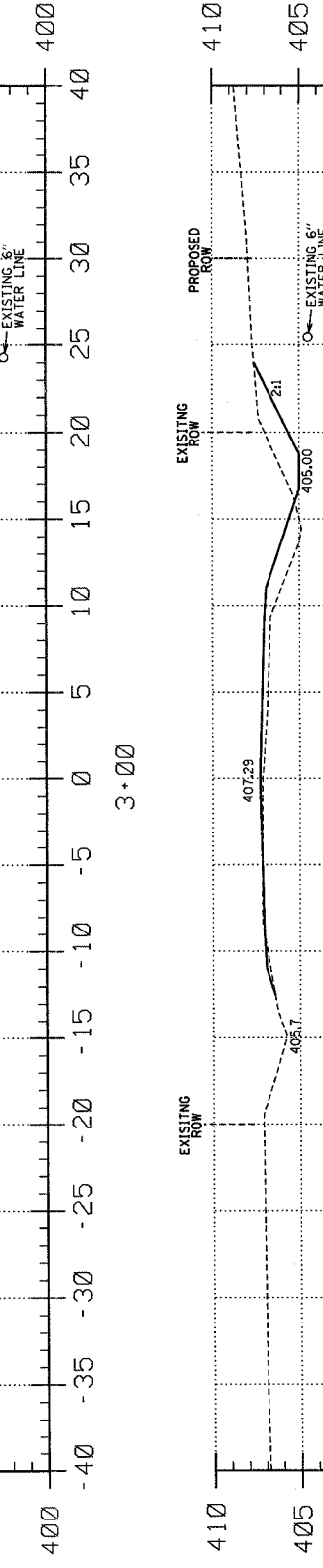

C = 7.1
F = 8.7

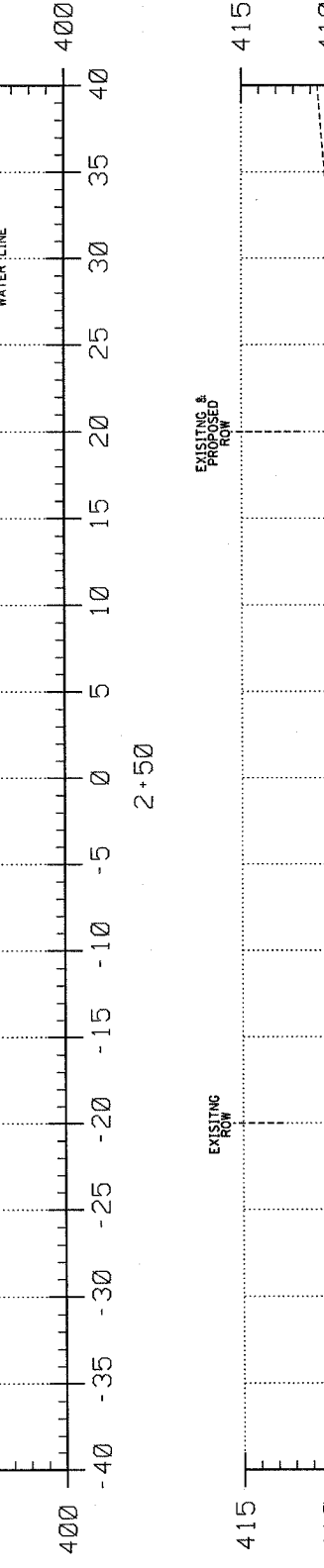

C = 7.1
F = 8.7

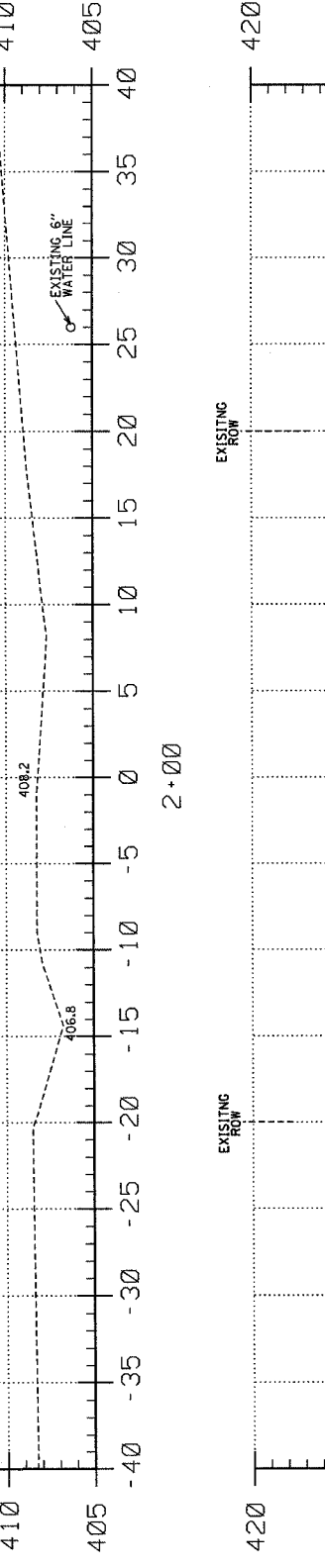

EARTHWORK SCHEDULE

LOCATION	EARTH EXCAVATION	CHANNEL EXCAVATION	ESTIMATED UNSUITABLE MATERIAL	SUITABLE MATERIAL ADJUSTED FOR SHRINKAGE	EMBANKMENT	EARTHWORK BALANCE WASTE (+) OR SHORTAGE (-)
	CUBIC YARD	CUBIC YARD	CUBIC YARD	CUBIC YARD	CUBIC YARD	CUBIC YARD
STA 0+00 TO 4+64.2	54.5	0.0	0.0	40.9	473.2	-432.3
STA 4+64.2 TO 5+35.7	0.0	437.0	218.5	163.9	0.0	+163.9
STA 5+35.7 TO 10+00	170.0	0.0	0.0	127.5	732.8	-605.3
2 PRIVATE ENTRANCES	0.0	0.0	0.0	0.0	47.3	-47.3
TOTAL	224.5	437.0	218.5	332.3	1253.3	-821.0