

**KEYMAP**

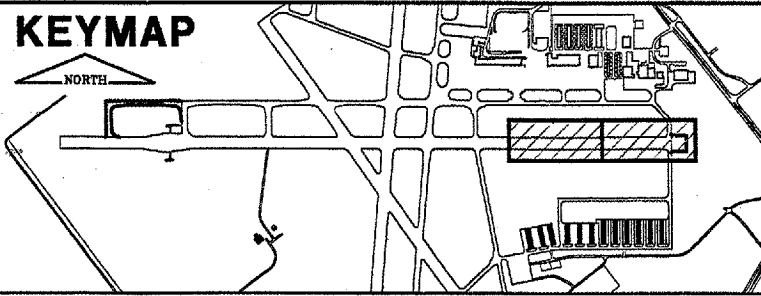

**CA003**

K:\Springfield\0503503\Draw\Sheets  
 FILE: PROPIMP05.dwg  
 UPDATE BY: Allan Draughan  
 PLOT DATE: 5/2/2007 5:55 PM  
 Capital\_Base  
 Base\_ExistTopo\_TxyB  
 tbinfo  
 BASE\_PROPGE0  
 KEY

**REVISIONS**

NUMBER	BY	DATE

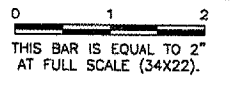

**LEGEND**

- FUTURE PAVEMENT
- NEW PAVEMENT
- EXISTING PAVEMENT
- NEW 4" BITUMINOUS SURFACE COURSE (401), 14" BITUMINOUS BASE COURSE (201), 4" CRUSHED AGGREGATE BASE COURSE (209), 8" LIME TREATED SUBGRADE (155) - CONTRACTOR'S OPTION
- NEW 1 1/2" BITUMINOUS SURFACE COURSE (401), 2 1/2" BITUMINOUS BASE COURSE (201), 4" CRUSHED AGGREGATE BASE COURSE (209)

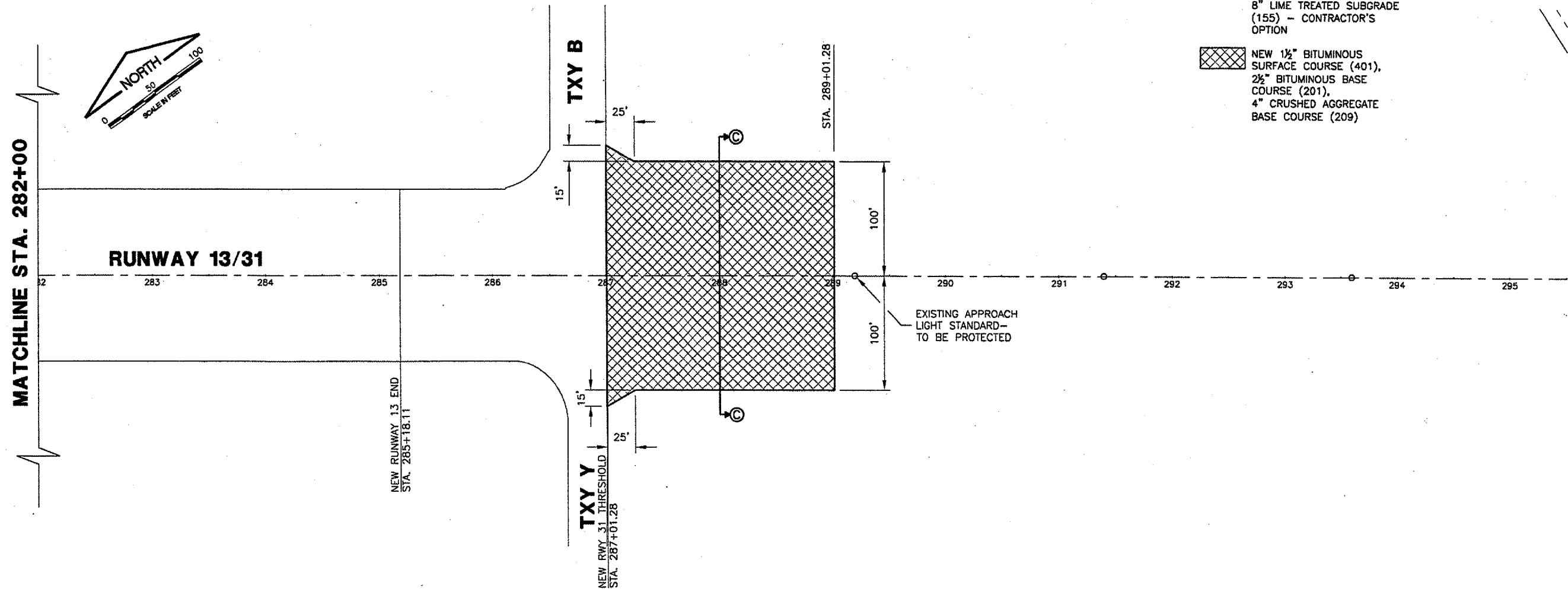

**SPRINGFIELD AIRPORT AUTHORITY  
 ABRAHAM LINCOLN CAPITAL AIRPORT  
 SPRINGFIELD, ILLINOIS**

**CONSTRUCT RUNWAY 13/31 RSA IMPROVEMENTS  
 PROPOSED IMPROVEMENTS 3**

© Copyright CMT, Inc.  
**CMT**  
 CRAWFORD, MURPHY & TILLY, INC.  
 CONSULTING ENGINEERS  
 License No. 184-000873

DESIGN BY:	RLV
DRAWN BY:	DPA
CHECKED BY:	RLV
APPROVED BY:	RLV
DATE:	04/24/07
JOB No:	05035-03

IL PROJ. NO. SPI-3488  
 AIP PROJ. NO. 3-17-0096-42