



HANSON PROFESSIONAL SERVICES INC.

815 Commerce Drive Suite 200
Oak Brook, Illinois 60523
Telephone: 630.990.3800
Fax: 630.990.3801



CITY OF DIXON, ILLINOIS

Post Office Box 386
Dixon, Illinois 61021
Telephone: 815.288.1485

DIXON MUNICIPAL AIRPORT
CHARLES R. WALGREEN FIELD

REPAIR AND OVERLAY
PORTIONS OF RUNWAY 12-30

AIP PROJECT NO. 3-17-0036-B10
IDA PROJECT NO. C73-3686

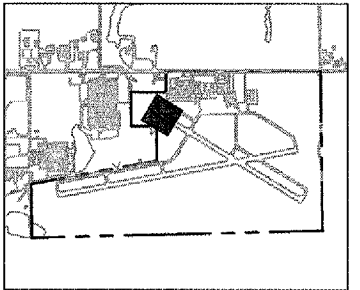

No.	Drawing Issue	Description	Date	By

Date
APRIL 20, 2007

Sheet Title

**STAKING PLAN
RUNWAY 12-30
STA 199+83 THRU
STA 203+00**

843-0688013
Project Number
LDH 10/31/06
Layout By Date
LDH 10/31/06
Designed By Date
RMH 04/20/07
Reviewed By Date
LDH
Drawn By Sheet No.

ALIGNMENT DATA

RUNWAY/ TAXIWAY	DESCRIPTION	STATION	STATE PLANE COORDINATES	
			NORTHING	EASTING
12-30	BEGINNING OF ALIGNMENT 200	199+49.1634	1883652.51	2492125.00
	END OF ALIGNMENT 200	228+43.9420	1882166.82	2494609.44
A	BEGINNING OF ALIGNMENT 300	323+40	1883084.44	2492640.65
	END OF ALIGNMENT 300	325+62.9043	1883276.89	2492753.13
D	BEGINNING OF ALIGNMENT 500	500+00	1883618.10	2492182.53
	END OF ALIGNMENT 500	501+50	1883746.25	2492260.50
E	BEGINNING OF ALIGNMENT 800	800+00	1882195.87	2494560.86
	END OF ALIGNMENT 800	801+50	1882324.61	2494657.85

NOTES:

- ALIGNMENTS ARE BASED ON STATE PLANE COORDINATE (ILLINOIS-WEST). SEE ALIGNMENT DATA TABLE, THIS SHEET.
- FOR ADDITIONAL GRADING INFORMATION, SEE PLAN AND PROFILE SHEETS AND CROSS SECTIONS.
- CONTRACTOR IS REQUIRED TO FIELD VERIFY EXISTING UTILITY LOCATIONS.
- CONTRACTOR WILL BE PROVIDED WITH CONTROL POINTS AND BASELINES IN ACCORDANCE WITH SPECIAL PROVISIONS.
- PROPOSED PAVEMENT EDGES TO MATCH EXISTING LOCATIONS.
- STAKING POINTS AT CROSS SECTIONS UNLESS NOTED OTHERWISE.
- FOR SEEDING INFORMATION, SEE LANDSCAPING PLAN.
- FOR PAVEMENT MARKING INFORMATION, SEE MARKING PLANS.

LEGEND

- PROPOSED GRADING LIMITS
- - - EXISTING SWALE
- - - EXISTING STORM SEWER
- - - EXISTING ELECTRICAL CABLE
- ⊙ EXISTING STORM SEWER MANHOLE
- PROP. EL. OFFSET
- EXIST. EL.

EARTHWORK QUANTITIES

DESCRIPTION AND PAY ITEM	QUANTITY
TOPSOIL (FROM OFF SITE) ITEM AR905520	2,475 C.Y.

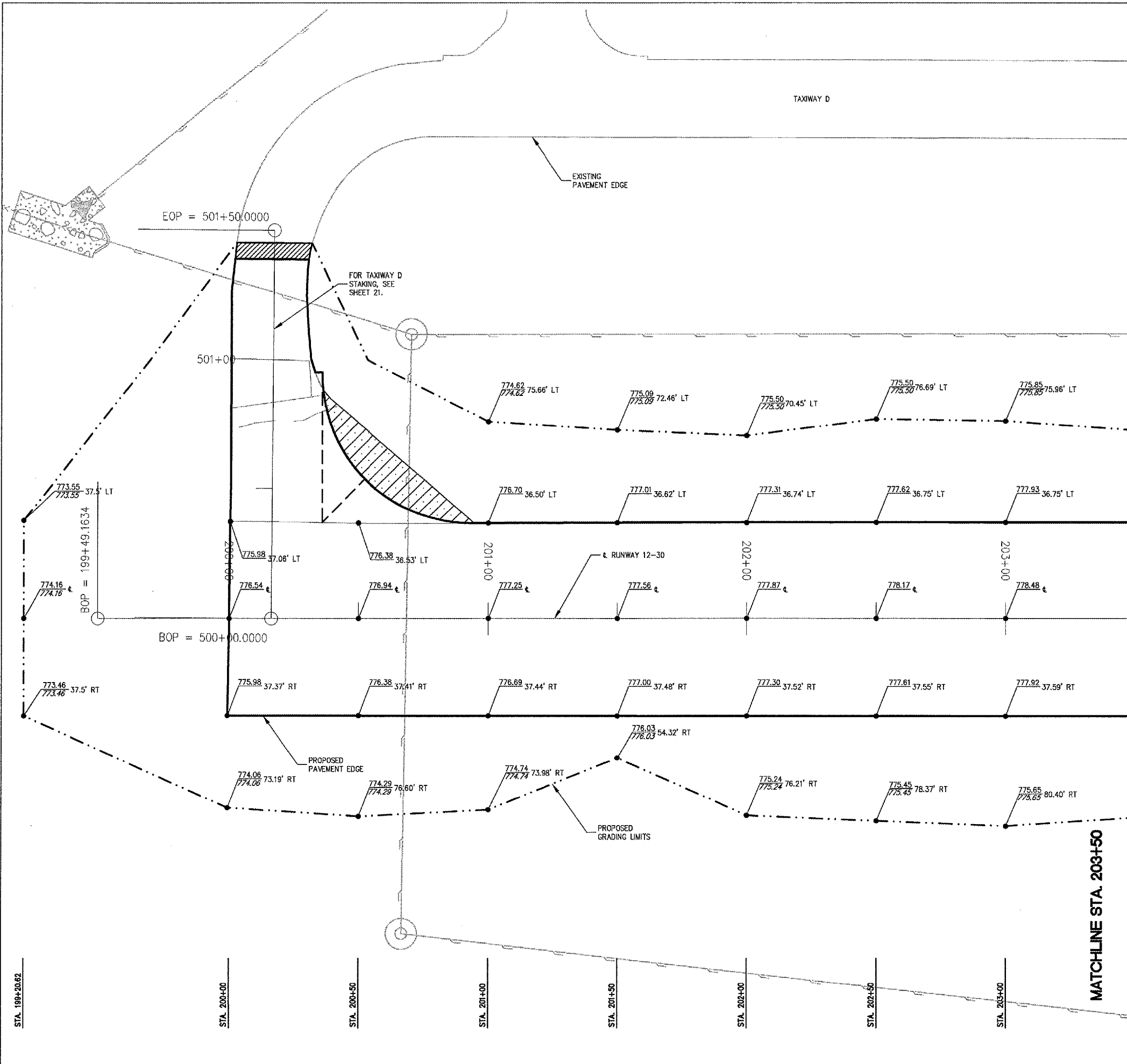
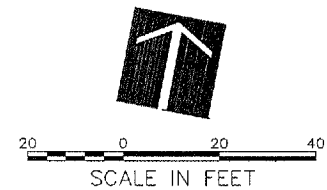

A:\06\0051\0084\3\068013\DRAWINGS\16-STAKING PLAN 200.DWG MAY 14, 2007 2:19PM LDH

STA. 199+20.62

STA. 200+00

STA. 200+50

STA. 201+00

STA. 201+50

STA. 202+00

STA. 202+50

STA. 203+00

MATCHLINE STA. 203+50