

☉ CURVE DATA:
 I = 90D 00' 00"
 D = 28D 38' 52.44"
 T = 200.00'
 L = 314.16'
 R = 200.00'
 E = 82.84'
 P.C. = 184+05.50
 P.I. = 186+05.50
 P.T. = 187+19.66

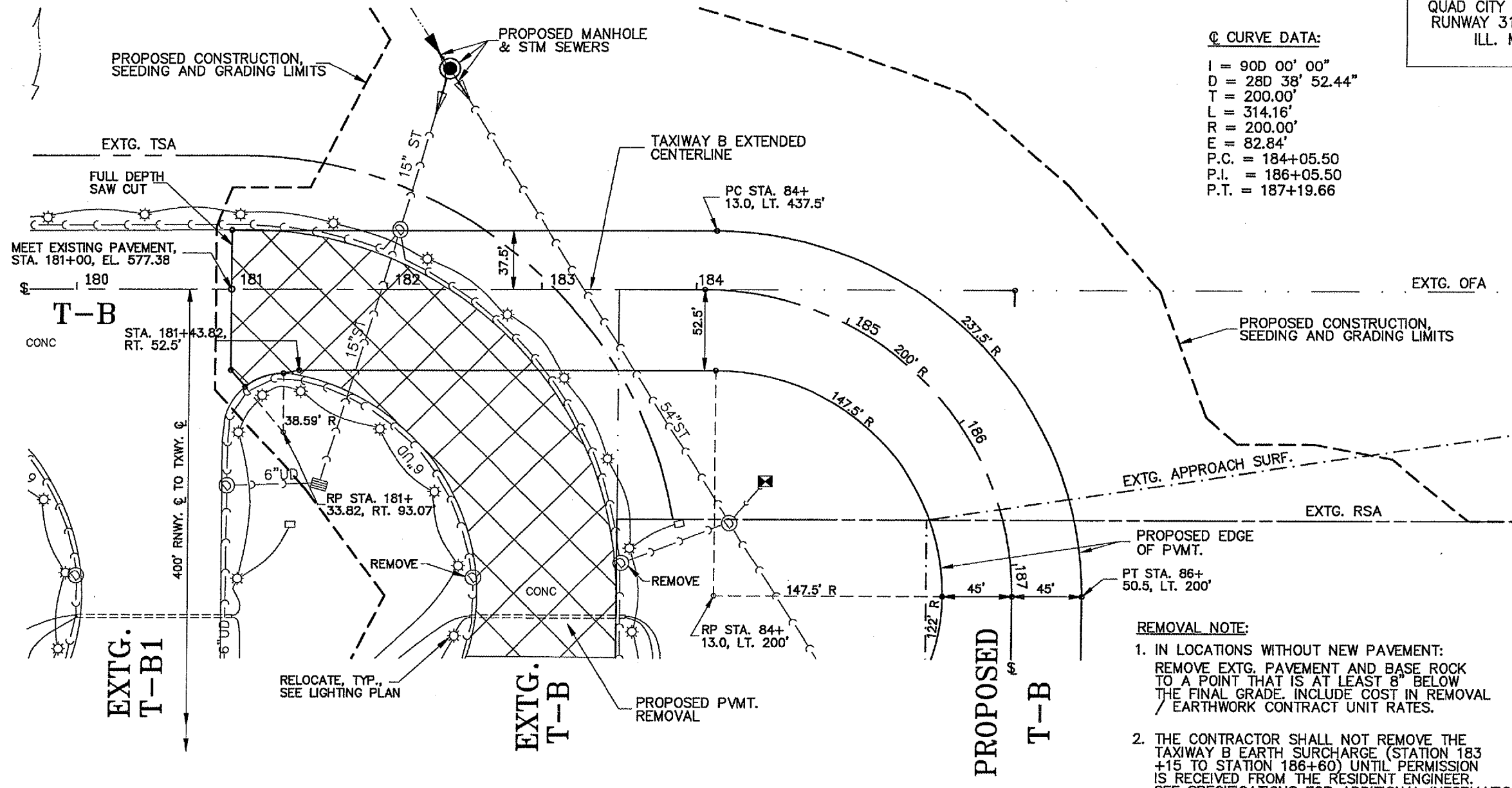

- LEGEND:**
- EDGE LIGHT
 - GUIDANCE SIGN
 - ELECTRICAL CABLE
 - STORM SEWER, TILE, OR UNDERDRAIN
 - INLET
 - OUTLET
 - STORM MANHOLE
 - SANITARY MANHOLE
 - DRAINAGE DITCH
 - CONDUIT OR DUCT BANK
 - PROPOSED PAVEMENT MILLING
 - PROPOSED PAVEMENT REMOVAL

- REMOVAL NOTE:**
1. IN LOCATIONS WITHOUT NEW PAVEMENT:
 REMOVE EXTG. PAVEMENT AND BASE ROCK TO A POINT THAT IS AT LEAST 8" BELOW THE FINAL GRADE. INCLUDE COST IN REMOVAL / EARTHWORK CONTRACT UNIT RATES.
 2. THE CONTRACTOR SHALL NOT REMOVE THE TAXIWAY B EARTH SURCHARGE (STATION 183+15 TO STATION 186+60) UNTIL PERMISSION IS RECEIVED FROM THE RESIDENT ENGINEER. SEE SPECIFICATIONS FOR ADDITIONAL INFORMATION.

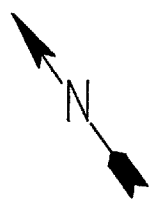
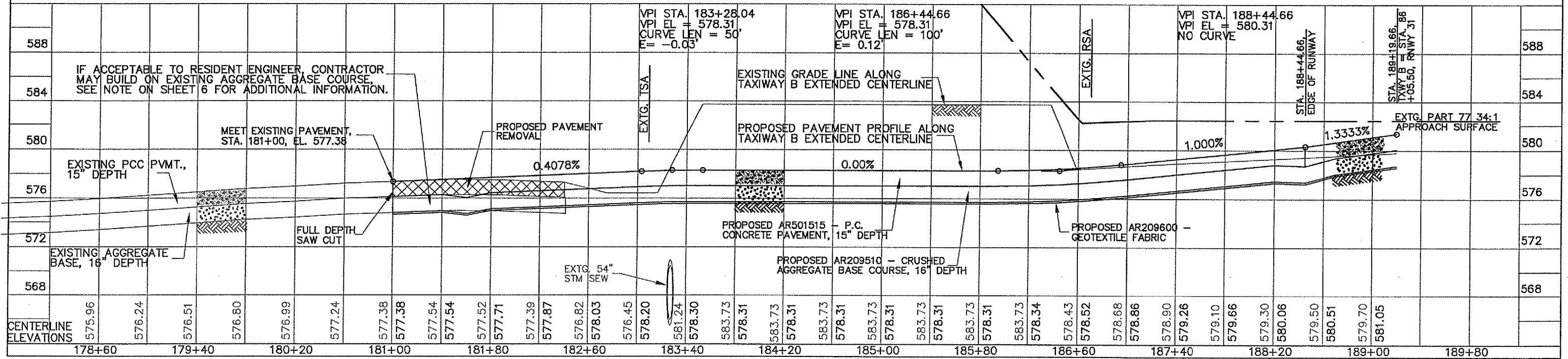
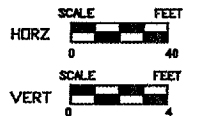

TAXIWAY B PLAN & PROFILE, STA 180+00 TO STA 189+80 9/58

G:\Airports\A061024 R31 EXTN. PVMT\PP.DWG, 5/11/2007 10:54:23 AM, jeffm