

TAXIWAY B, STA. 181+00 LEFT TO TAXIWAY K, STA. 388+10.82 RIGHT UNDERDRAIN CENTERLINE PROFILE

QUAD CITY INTERNATIONAL AIRPORT  
RUNWAY 31 EXTENSION - PAVING  
ILL. ML-3689, QU005  
SHEET 18 OF 58

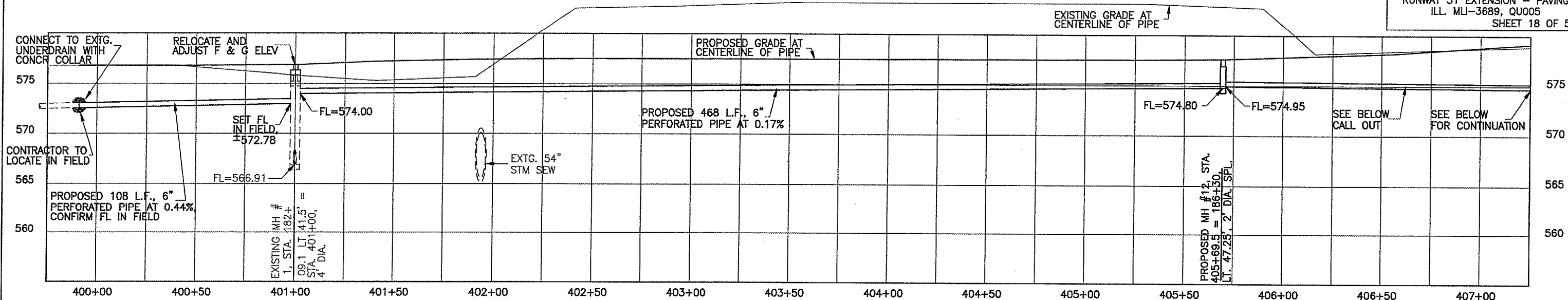

TAXIWAY B, STA. 181+00 LEFT TO TAXIWAY K, STA. 388+10.82 RIGHT UNDERDRAIN CENTERLINE PROFILE (CONTINUED)

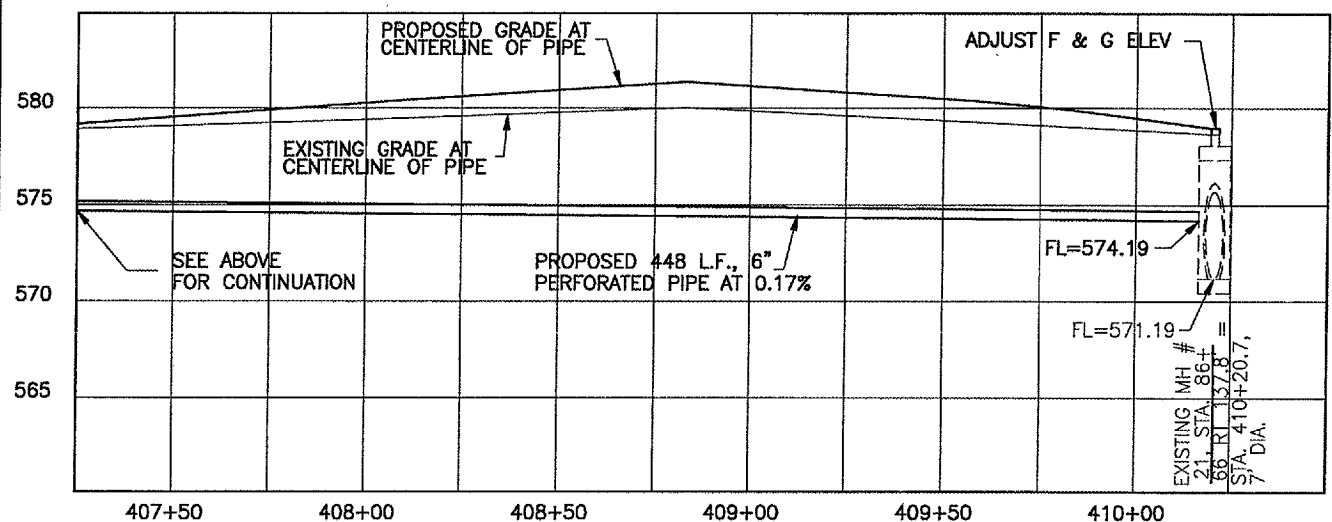

TAXIWAY B, STA. 181+09 TO 184+97.5 RIGHT UNDERDRAIN CENTERLINE PROFILE

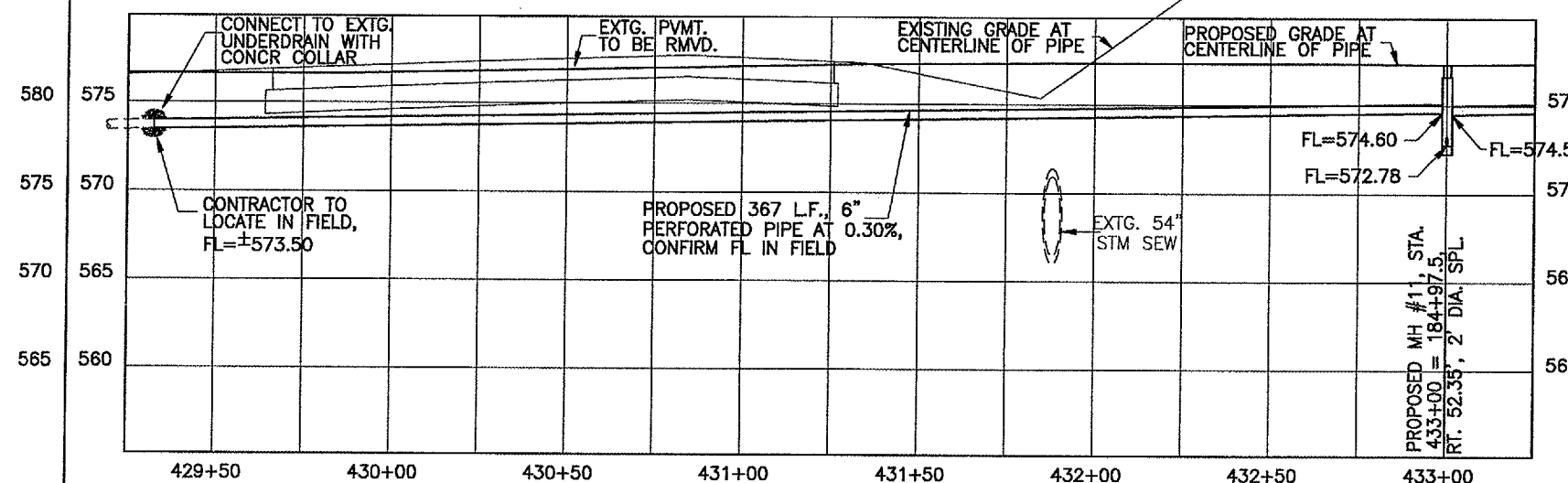

RUNWAY 31, STA. 81+30 LEFT TO TAXIWAY B, 185+03.6 RIGHT UNDERDRAIN CENTERLINE PROFILE

