

LEGEND

EXISTING PAVEMENT

PROPOSED PAVEMENT

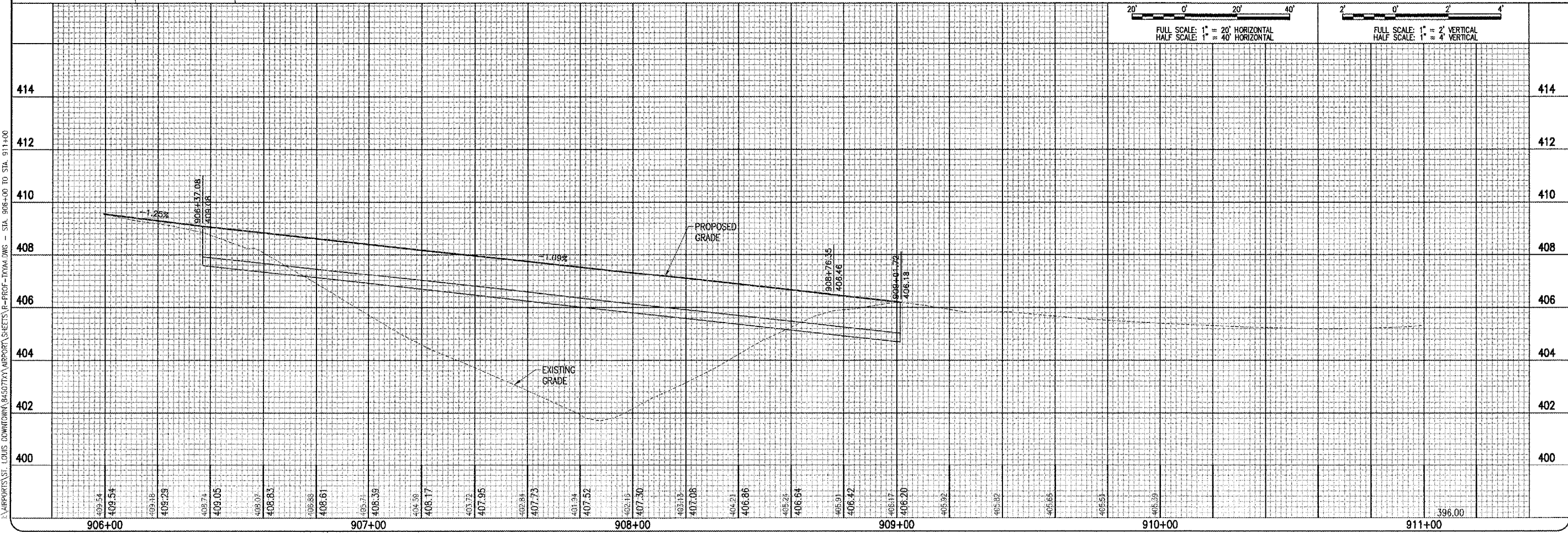
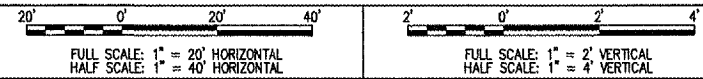
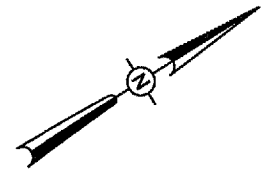

APR 18, 2007 1:25 PM BAK I:\AIRPORTS\ST. LOUIS DOWNTOWN\84507TX\AIRPORT\SHEETS\A-PROF-TX1A4.DWG - STA. 906+00 TO STA. 911+00

DATE	REVISION	BY

SAINT LOUIS DOWNTOWN AIRPORT
 A Division of BLS State Development Agency
 A.I.P. PROJ.: 3-17-039-B17

BBK Project No. 84507TX.D 0800	JAC	1/23/07
Drawn R-PROF-TX1A4.DWG	JEO	1/23/07
Scale H. 1"=20' V. 1"=2'	CAH	01/26/07
Date 1/23/07		

HANSON
 Hanson Professional Services Inc.
 4227 Earth City Expressway, Suite 130
 St. Louis, MO 63045-1308
 Offices Nationwide

CONSTRUCT TAXIWAY "A4"
 PROPOSED TAXIWAY "A4"
 PLAN AND PROFILE
 STA. 906+00 TO STA. 911+00