

WH006



Whiteside County **AIRPORT**
JOSEPH H. BITTORF FIELD

Whiteside County Airport

Sterling / Rock Falls, Illinois

Whiteside County Airport

AIP: 3-17-0098-XX
SQI-3694

Recable Airfield

**FINAL
SUBMITTAL**

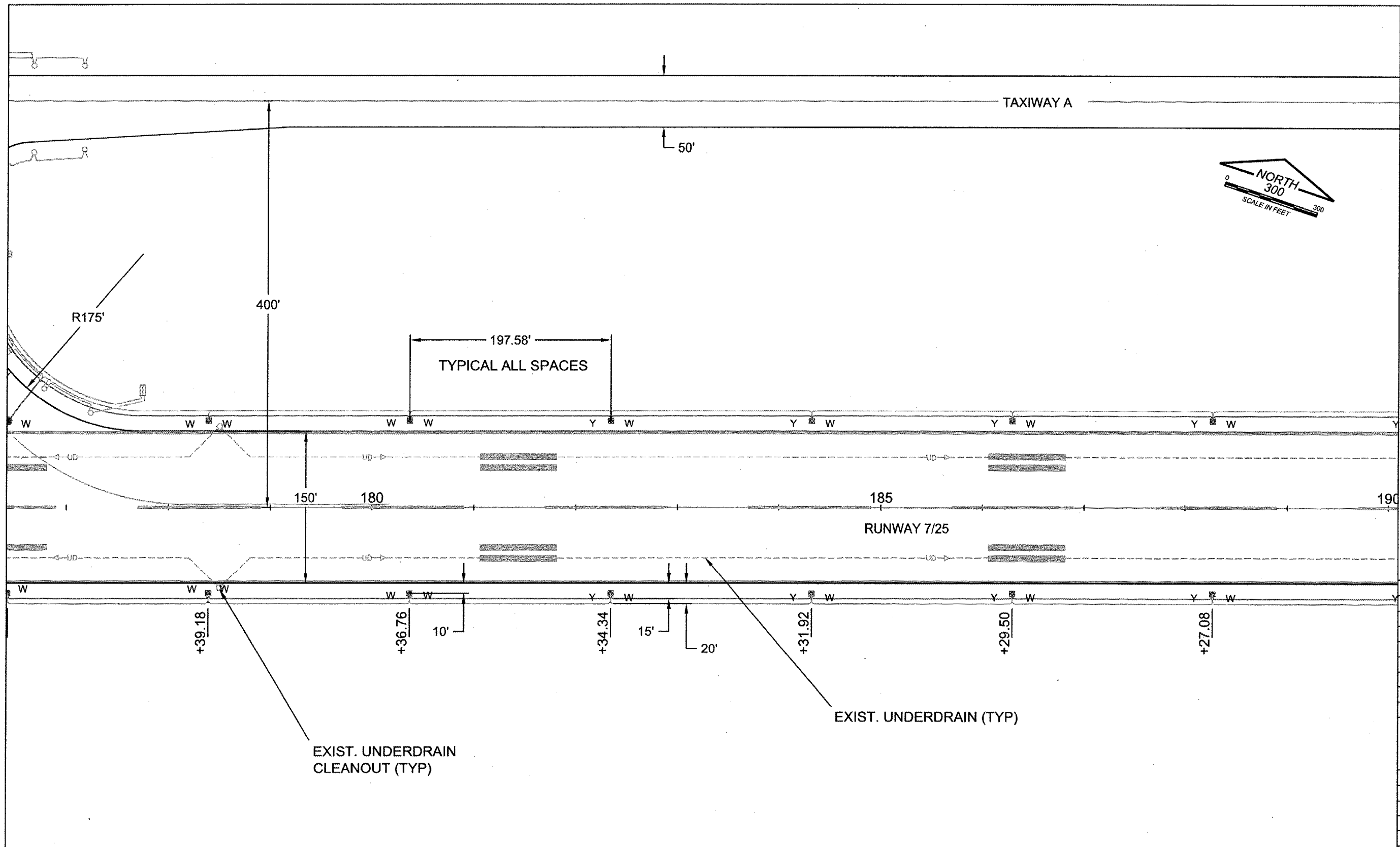

Revisions

No.	Date	Description

0 1
THIS BAR IS EQUAL TO 1" AT FULL SCALE (17 X 11).

DESIGN BY: CMT-RFD
DRAWN BY: CMT-RFD
CHECKED BY: CMT-RFD
APPROVED BY: JGP
DATE: 4.20.2007
JOB No: 06292-03-00

**ELECTRICAL
PLAN 4
RUNWAY 7/25
(ERP4)**

**ELECTRICAL PLAN 4
RUNWAY 7/25**

16
SHEET 16 OF 25 SHEETS

LEGEND

- NEW 1/C 5KV CABLE IN UNIT DUCT
- EXIST. 1/C 5KV CABLE
- ⊙ NEW ELECTRICAL MANHOLE
- HH3 NEW ELECTRICAL HANDHOLE
- ▬ NEW DUCT (NO. OF WAYS SHOWN)
- ▬ EXIST. DUCT (NO. OF WAYS SHOWN)
- W Y REFURBISH BASE MOUNTED LIGHT (TYPICAL OF ALL RWY 7/25 LIGHTS ONLY) (LENS COLOR SHOWN; Y YELLOW; W WHITE; G GREEN; R RED)