

TREE REMOVAL		
STA.	OFFSET	SIZE
150+94 LT	27'	16"

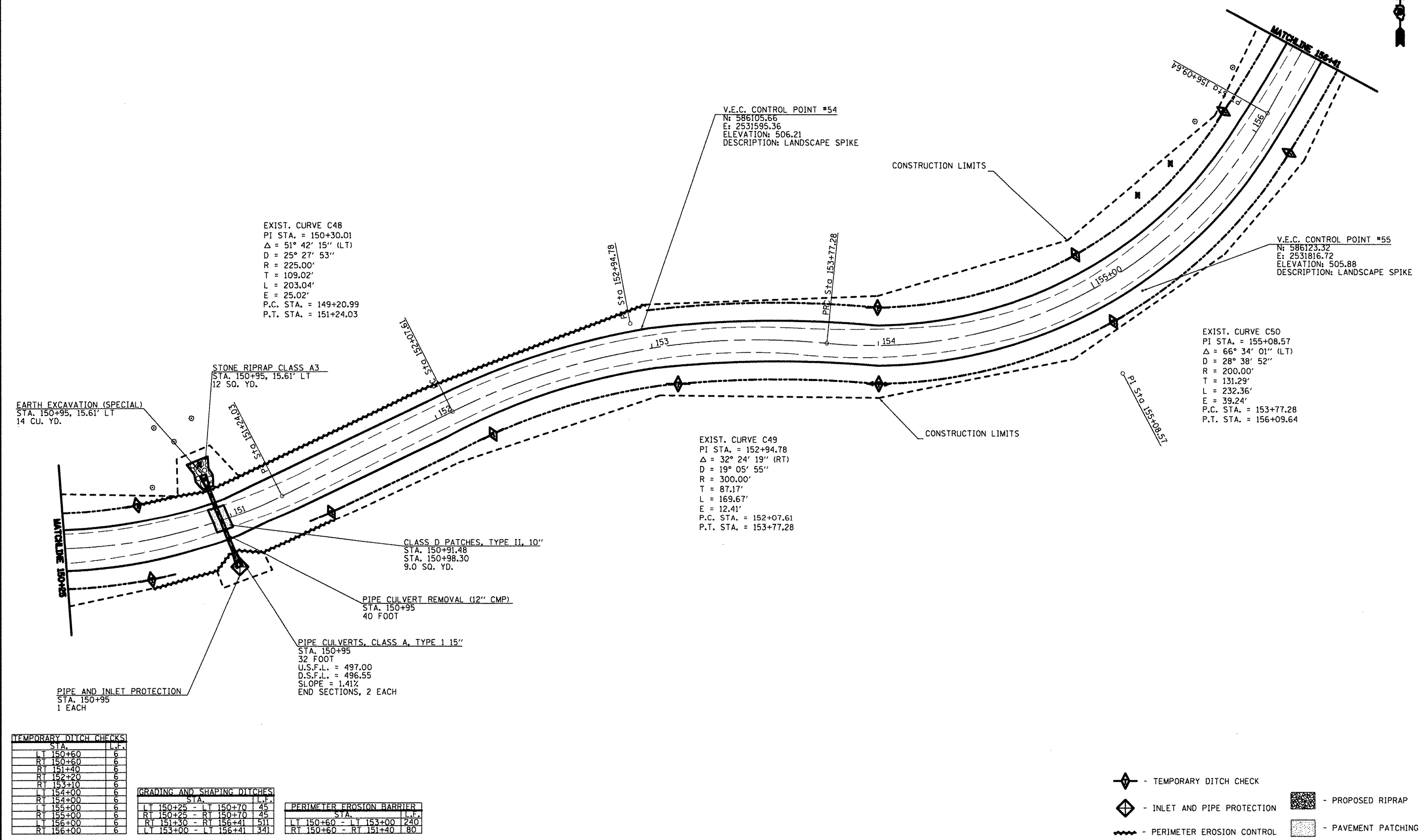

EXIST. CURVE C48  
 PI STA. = 150+30.01  
 $\Delta = 51^\circ 42' 15''$  (LT)  
 $D = 25^\circ 27' 53''$   
 $R = 225.00'$   
 $T = 109.02'$   
 $L = 203.04'$   
 $E = 25.02'$   
 P.C. STA. = 149+20.99  
 P.T. STA. = 151+24.03

EXIST. CURVE C50  
 PI STA. = 155+08.57  
 $\Delta = 66^\circ 34' 01''$  (LT)  
 $D = 28^\circ 38' 52''$   
 $R = 200.00'$   
 $T = 131.29'$   
 $L = 232.36'$   
 $E = 39.24'$   
 P.C. STA. = 153+77.28  
 P.T. STA. = 156+09.64

EXIST. CURVE C49  
 PI STA. = 152+94.78  
 $\Delta = 32^\circ 24' 19''$  (RT)  
 $D = 19^\circ 05' 55''$   
 $R = 300.00'$   
 $T = 87.17'$   
 $L = 169.67'$   
 $E = 12.41'$   
 P.C. STA. = 152+07.61  
 P.T. STA. = 153+77.28

EARTH EXCAVATION (SPECIAL)  
 STA. 150+95, 15.61' LT  
 14 CU. YD.

STONE RIPRAP CLASS A3  
 STA. 150+95, 15.61' LT  
 12 SQ. YD.

CLASS D PATCHES, TYPE II, 10"  
 STA. 150+91.48  
 STA. 150+98.30  
 9.0 SQ. YD.

PIPE CULVERT REMOVAL (12" CMP)  
 STA. 150+95  
 40 FOOT

PIPE CULVERTS, CLASS A, TYPE 1 15"  
 STA. 150+95  
 32 FOOT  
 U.S.F.L. = 497.00  
 D.S.F.L. = 496.55  
 SLOPE = 1.41%  
 END SECTIONS, 2 EACH

PIPE AND INLET PROTECTION  
 STA. 150+95  
 1 EACH

TEMPORARY DITCH CHECKS	
STA.	L.F.
LT 150+60	6
RT 150+60	6
RT 151+40	6
RT 152+20	6
RT 153+10	6
LT 154+00	6
RT 154+00	6
LT 155+00	6
RT 155+00	6
LT 156+00	6
RT 156+00	6

GRADING AND SHAPING DITCHES	
STA.	L.F.
LT 150+25 - LT 150+70	45
RT 150+25 - RT 150+70	45
LT 151+30 - RT 156+41	511
LT 153+00 - LT 156+41	341

PERIMETER EROSION BARRIER	
STA.	L.F.
LT 150+60 - LT 153+00	240
RT 150+60 - RT 151+40	80

- TEMPORARY DITCH CHECK
- INLET AND PIPE PROTECTION
- PERIMETER EROSION CONTROL
- PROPOSED RIPRAP
- PAVEMENT PATCHING

FILE NAME =	USER NAME = #USER#	DESIGNED - R.A.D.	REVISED -
*FILE*		DRAWN - J.T.T.	REVISED -
	PLOT SCALE = #SCALE#	CHECKED - R.A.D.	REVISED -
	PLOT DATE = #DATE#	DATE - 4/4/12	REVISED -

STATE OF ILLINOIS  
 DEPARTMENT OF TRANSPORTATION

WASHINGTON COUNTY CONSERVATION AREA MAIN ALIGNMENT	
SCALE: 1" = 20'	SHEET NO. 42 OF 112 SHEETS
STA. 150+25 TO STA. 156+41	

F.A. RTL.	SECTION	COUNTY	TOTAL SHEETS	SHEET NO.
		WASHINGTON	112	42
CONTRACT NO. 46223				
ILLINOIS FED. AID PROJECT				

JOB NO. 250-081-W VASCORCELLES ENGINEERING CORP. DESIGN FIRM REGISTRATION NUMBER 184-002017