

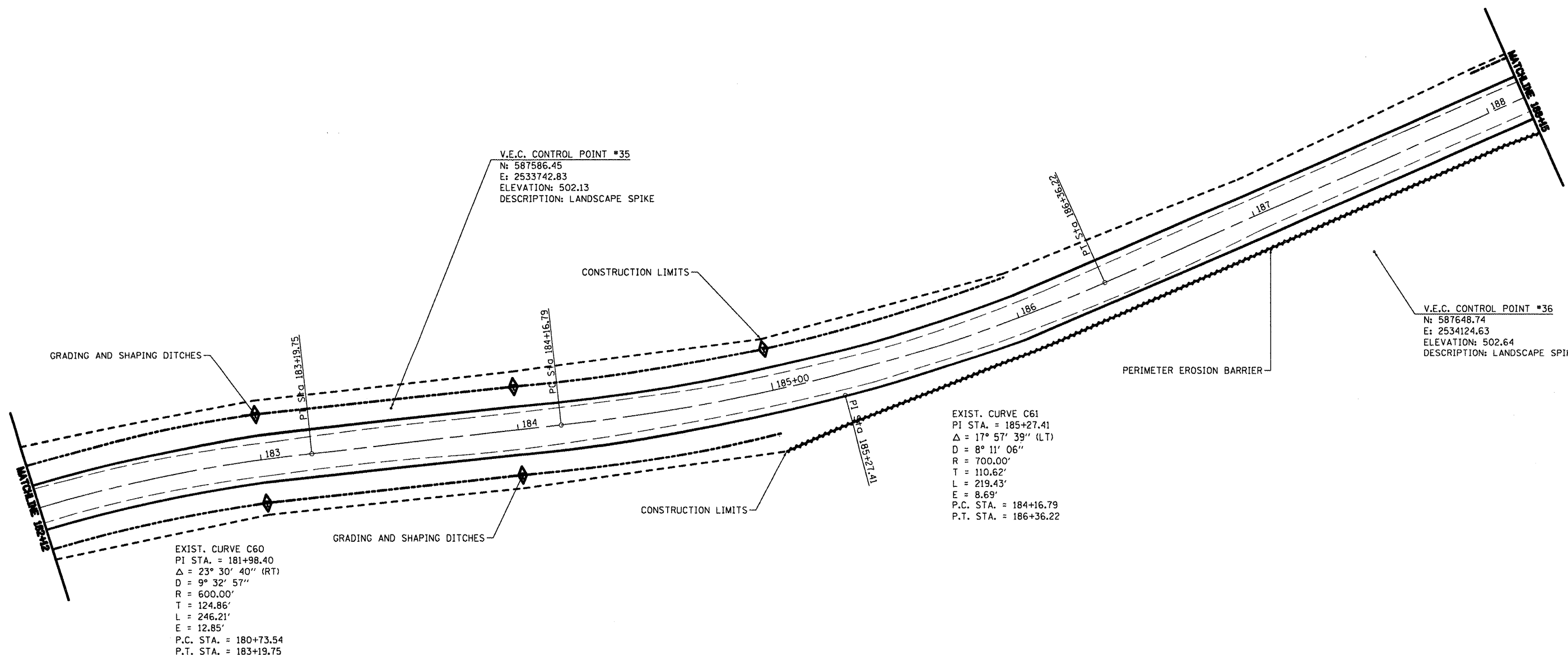

TEMPORARY DITCH CHECKS	
STA.	L.F.
LT 183+00	6
RT 183+00	6
LT 184+00	6
RT 184+00	6
LT 185+00	6

GRADING AND SHAPING DITCHES	
STA.	L.F.
LT 182+12 - LT 186+00	388
RT 182+12 - RT 185+00	288
LT 188+00 - LT 188+15	15

PERIMETER EROSION BARRIER	
STA.	L.F.
RT 185+00 - RT 188+15	315



V.E.C. CONTROL POINT #35
 N: 587586.45
 E: 2533742.83
 ELEVATION: 502.13
 DESCRIPTION: LANDSCAPE SPIKE

V.E.C. CONTROL POINT #36
 N: 587648.74
 E: 2534124.63
 ELEVATION: 502.64
 DESCRIPTION: LANDSCAPE SPIKE

EXIST. CURVE C61
 PI STA. = 185+27.41
 $\Delta = 17^\circ 57' 39''$ (LT)
 $D = 8^\circ 11' 06''$
 $R = 700.00'$
 $T = 110.62'$
 $L = 219.43'$
 $E = 8.69'$
 P.C. STA. = 184+16.79
 P.T. STA. = 186+36.22

EXIST. CURVE C60
 PI STA. = 181+98.40
 $\Delta = 23^\circ 30' 40''$ (RT)
 $D = 9^\circ 32' 57''$
 $R = 600.00'$
 $T = 124.86'$
 $L = 246.21'$
 $E = 12.85'$
 P.C. STA. = 180+73.54
 P.T. STA. = 183+19.75

- TEMPORARY DITCH CHECK
- PERIMETER EROSION CONTROL

FILE NAME =	USER NAME = #USER#	DESIGNED - R.H.D.	REVISED -	STATE OF ILLINOIS DEPARTMENT OF TRANSPORTATION	WASHINGTON COUNTY CONSERVATION AREA MAIN ALIGNMENT	SCALE: 1" = 20'	SHEET NO. 47 OF 112 SHEETS	STA. 182+12 TO STA. 188+15	SECTION	COUNTY	TOTAL SHEETS	SHEET NO.
#FILE#		DRAWN - J.T.T.	REVISED -			WASHINGTON	112	47				
PLOT SCALE = #SCALE#		CHECKED - R.H.D.	REVISED -			CONTRACT NO. 46223						
PLOT DATE = #DATE#		DATE - 4/4/12	REVISED -			ILLINOIS FED. AID PROJECT						

JOB NO. 250-063-R VASCONCELLES ENGINEERING CORP. DESIGN FIRM REGISTRATION NUMBER 184-002407