

TREE REMOVAL		
STA.	OFFSET	SIZE
514+31 LT	9"	15"

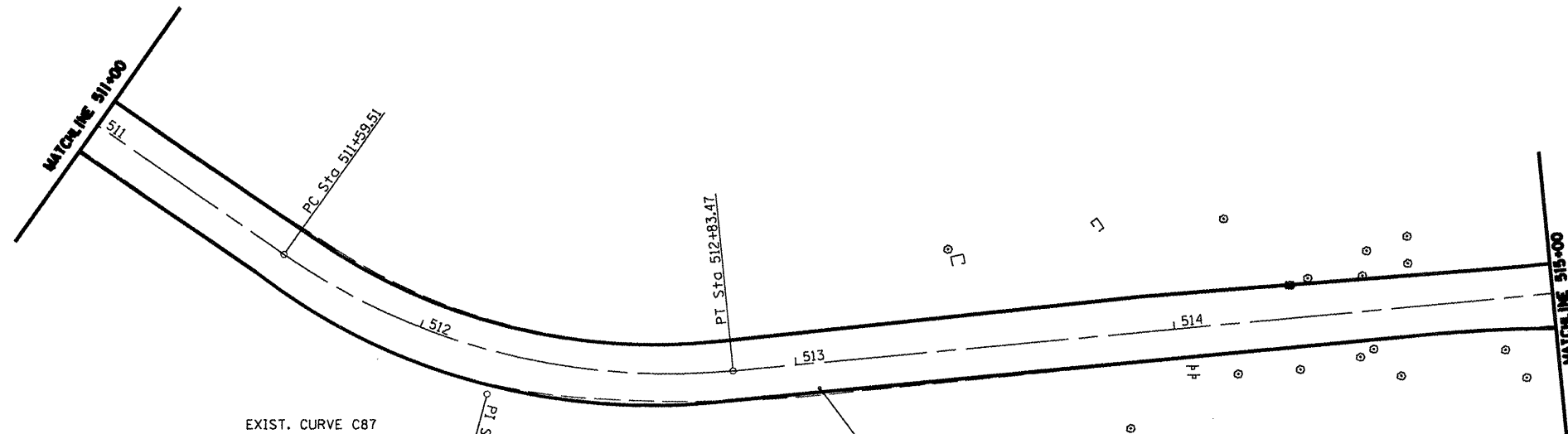

EXIST. CURVE C87
 PI STA. = 512+24.22
 $\Delta = 40^\circ 35' 06''$ (LT)
 $D = 32^\circ 44' 26''$
 $R = 175.00'$
 $T = 64.71'$
 $L = 123.96'$
 $E = 11.58'$
 P.C. STA. = 511+59.51
 P.T. STA. = 512+83.47

V.E.C. CONTROL POINT #64
 N: 588947.34
 E: 2530182.81
 ELEVATION: 507.32
 DESCRIPTION: LANDSCAPE SPIKE

FILE NAME =	USER NAME = *USER*	DESIGNED - R.J.D.	REVISED -
#FILE#		DRAWN - J.T.T.	REVISED -
	PLOT SCALE = #SCALE#	CHECKED - R.J.D.	REVISED -
	PLOT DATE = #DATE#	DATE - 4/4/12	REVISED -

STATE OF ILLINOIS
 DEPARTMENT OF TRANSPORTATION

WASHINGTON COUNTY CONSERVATION AREA
 BOAT RAMP ALIGNMENT 1

SCALE: 1" = 20' SHEET NO. 69 OF 112 SHEETS STA. 511+00 TO STA. 515+00

P.A. RTE.	SECTION	COUNTY	TOTAL SHEETS	SHEET NO.
		WASHINGTON	112	69
			CONTRACT NO. 46223	
ILLINOIS FED. AID PROJECT				

JOB NO. 250-061-W VASCONCELLES ENGINEERING COMP. DESIGN FIRM REGISTRATION NUMBER 184-000707