

BENCHMARK "A" NORTHWEST CORNER OF CONCRETE HEADWALL LOCATED AT STA. 99+56
ASSUMED ELEV = 786.41

BASELINE COORDINATES

STA. 200+00
N = 1,651,152.19
E = 2,309,703.54

STA. 206+85.21
N = 1,651,837.40
E = 2,309,703.54



PROPOSED BRICK SIDEWALK
TIMBER SIDEWALK

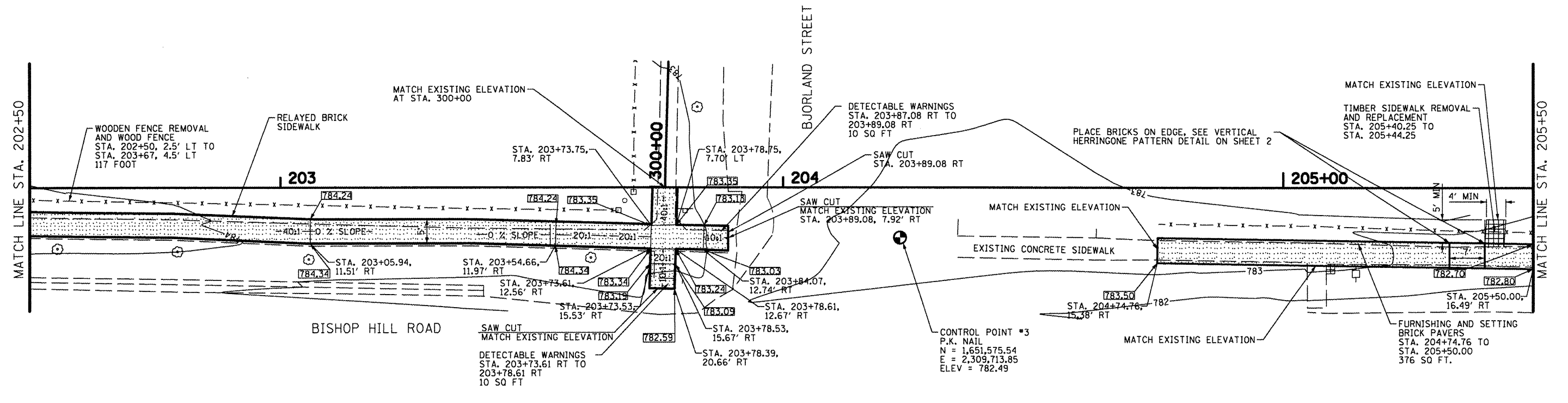
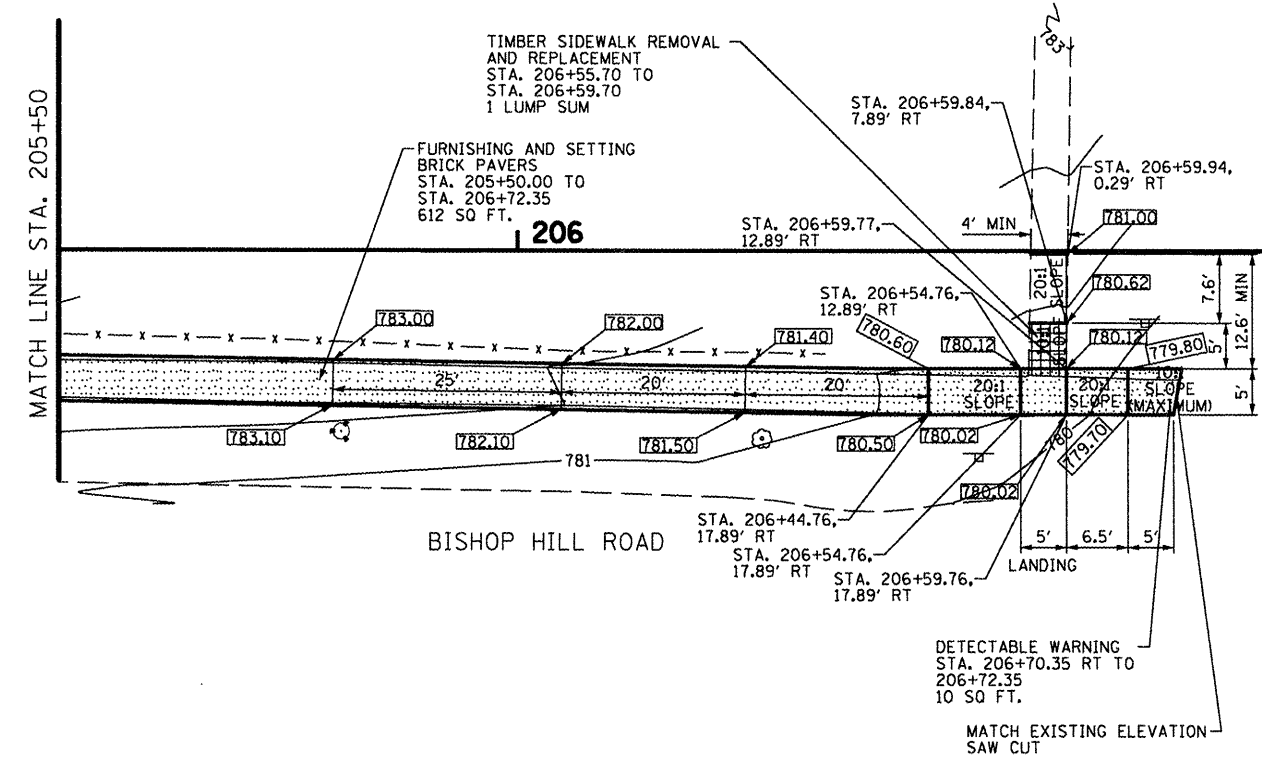

FILE NAME =	USER NAME = #USER#	DESIGNED - R.H.D.	REVISED -
#FILE#		DRAWN - S.D.J.	REVISED -
	PLOT SCALE = #SCALE#	CHECKED - R.H.D.	REVISED -
	PLOT DATE = #DATE#	DATE - 3/28/12	REVISED -

STATE OF ILLINOIS
DEPARTMENT OF TRANSPORTATION

PLAN SHEET STA. 202+50 - 205+50 & 300+00 - 301+50
BISHOP HILL STATE HISTORIC SITE
SCALE: 1" = 10' SHEET NO. 8 OF 9 SHEETS STA. 202+50 TO STA. 206+50

SECTION	COUNTY	TOTAL SHEETS	SHEET NO.
VARIOUS	HENRY	9	8
CONTRACT NO. 46224		ILLINOIS P.B. AND PROJECT	

JOB NO. 200-081-U VASCONEVELLES ENGINEERING CORP. DESIGN FIRM REGISTRATION NUMBER 184-002107