

06-15-12 LETTING ITEM 194

**INDEX OF SHEETS**

SHEET NO.	SHEET TITLE
1	COVER SHEET
2	TYPICAL SECTIONS, STANDARDS AND GENERAL NOTES
3	SUMMARY & SCHEDULE OF QUANTITIES
4	DEMOLITION PLAN
5	PLAN SHEET STA. 100+00 - 104+50
6	PLAN SHEET STA. 104+50 - 107+25
7	PLAN SHEET STA. 200+00 - 202+50 & 500+00 - 501+50
8	PLAN SHEET STA. 202+50 - 206+72.35 & 300+00 - 301+50
9	DETAILS

**LEGEND**

- EXISTING FENCE
- EXISTING WATER VALVE
- ⊕ EXISTING FIRE HYDRANT
- ⊙ EXISTING YARD HYDRANT
- EXISTING WATER FOUNTAIN
- † EXISTING SIGN
- ⌢ EXISTING FLAG POLE
- EXISTING CATCH BASIN
- ⊙ EXISTING DECIDUOUS TREE
- ⊙ EXISTING CONIFEROUS TREE
- EXISTING BUSH
- EXISTING SPOT LIGHT

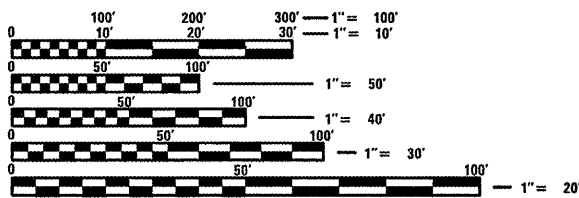

FULL SIZE PLANS HAVE BEEN PREPARED USING STANDARD ENGINEERING SCALES. REDUCED SIZED PLANS WILL NOT CONFORM TO STANDARD SCALES. IN MAKING MEASUREMENTS ON REDUCED PLANS, THE ABOVE SCALES MAY BE USED.

J.U.L.I.E.  
JOINT UTILITY LOCATION INFORMATION FOR EXCAVATION  
1-800-892-0123  
OR 811

PROJECT ENGINEER  
PROJECT MANAGER

CONTRACT NO. 46224

STATE OF ILLINOIS  
DEPARTMENT OF TRANSPORTATION

DIVISION OF HIGHWAYS

**PROPOSED  
HIGHWAY PLANS**

IDOT/HPA STATEWIDE  
BISHOP HILL STATE HIST SITE  
SIDEWALK AND ENTRANCE IMPROVEMENTS  
HENRY COUNTY

C-30-048-12

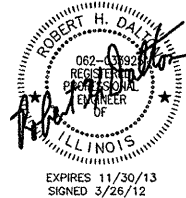
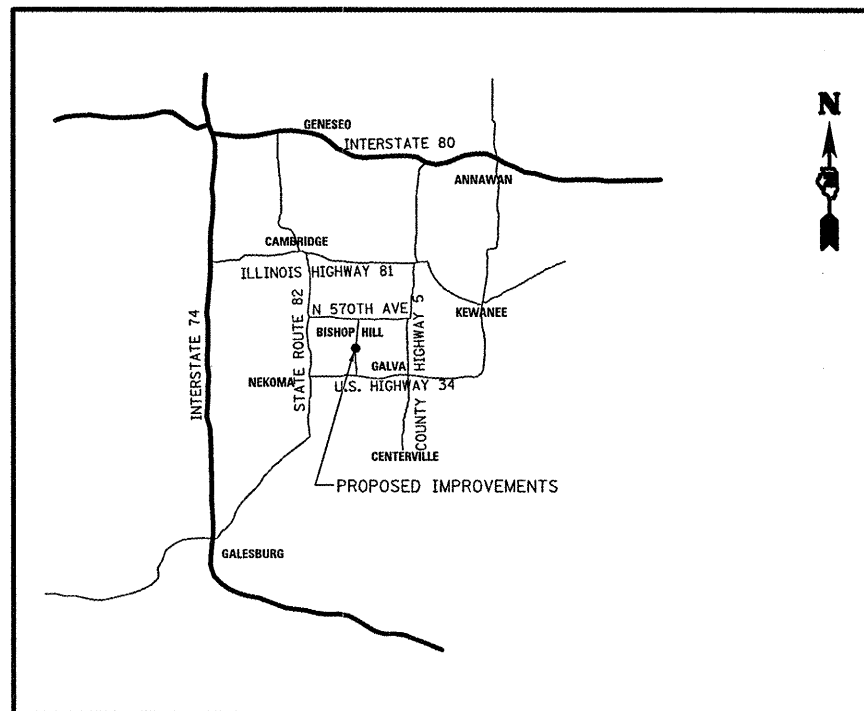

F.A. RTE.	SECTION	COUNTY	TOTAL SHEETS	SHEET NO.
	VARIOUS	HENRY	9	1
		ILLINOIS	CONTRACT NO. 46224	

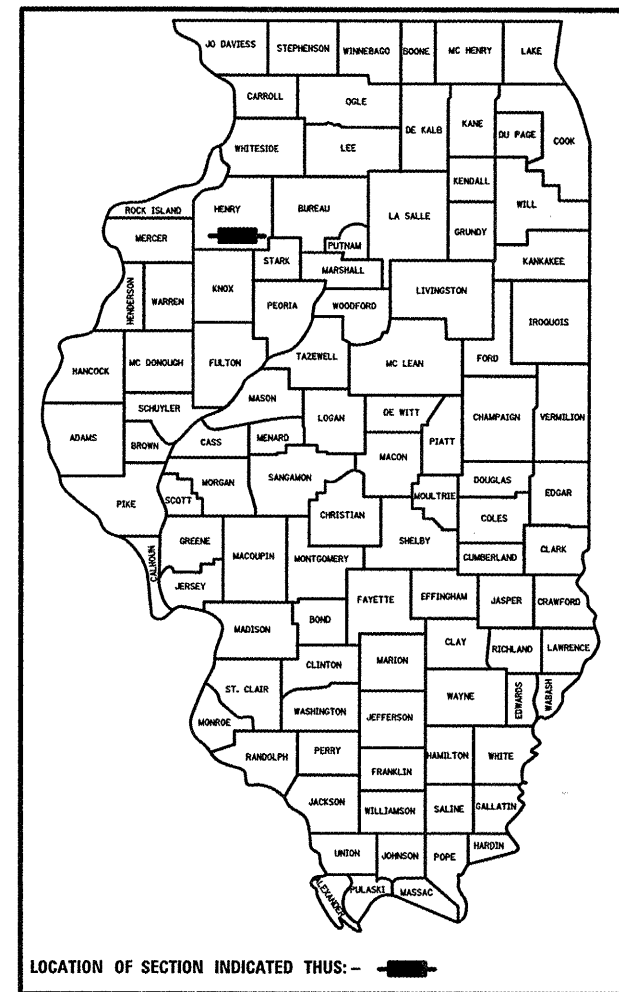

STATE OF ILLINOIS  
DEPARTMENT OF TRANSPORTATION  
DIVISION OF HIGHWAYS

SUBMITTED May 8 2012  
William R. Frey Jr.  
DEPUTY DIRECTOR OF HIGHWAYS, REGION ENGINEER

May 11 2012  
[Signature]  
ENGINEER OF DESIGN AND ENVIRONMENT

May 11 2012  
William R. Frey Jr.  
DIRECTOR OF HIGHWAYS, CHIEF ENGINEER

PRINTED BY THE AUTHORITY  
OF THE STATE OF ILLINOIS

JOB NO. 250-064-11 VASCONCELLES ENGINEERING CORP. DESIGN FIRM REGISTRATION NUMBER 184-002107

**TYPICAL SECTIONS**

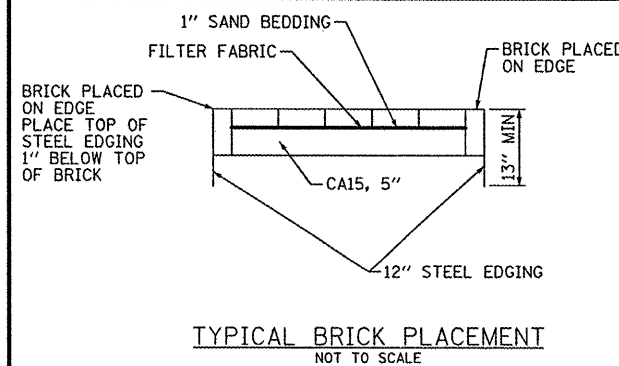
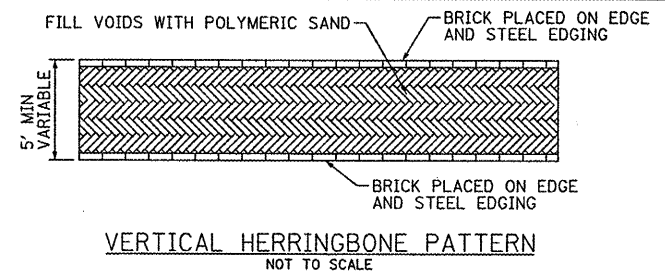
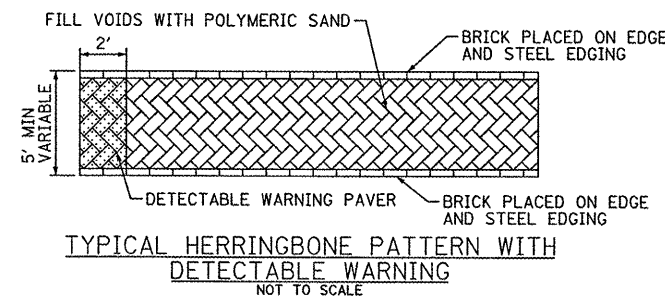
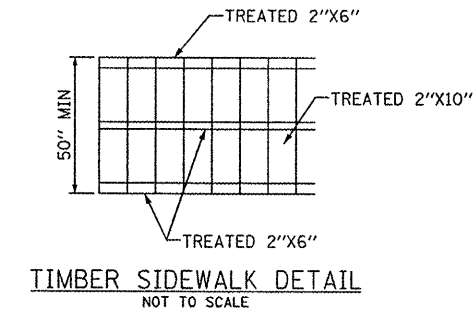
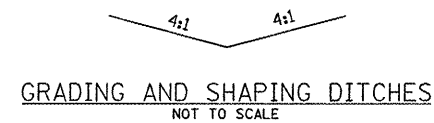
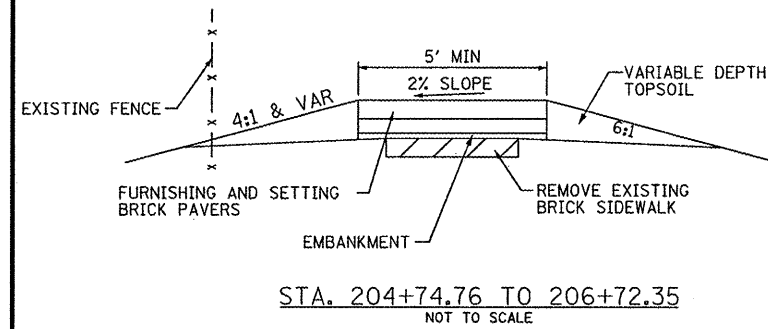
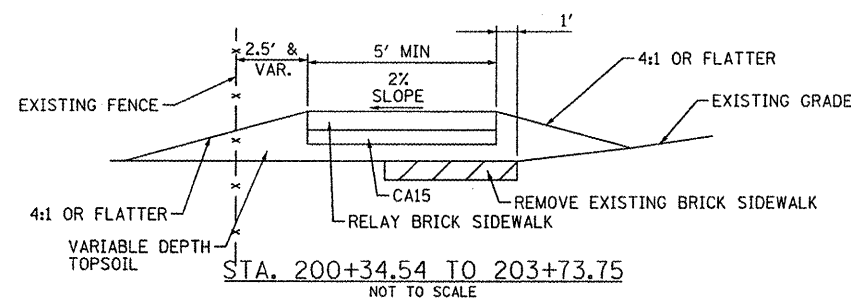

**LIST OF STANDARDS**

- 280001-06 TEMPORARY EROSION CONTROL SYSTEM
- 424001-06 CURB RAMPS FOR SIDEWALK
- 542301-03 PRECAST REINFORCED CONCRETE FLARED END SECTION
- 602301-03 INLET TYPE A
- 602401-03 MANHOLE - TYPE A
- 602601-02 PRECAST REINFORCED CONCRETE FLAT SLAB TOP
- 602701-02 MANHOLE STEPS
- 604036-02 GRATE TYPE 8
- 701001-02 OFF-RD OPERATIONS, 2L, 2W, MORE THAN 15' (4.5 m) AWAY
- 701006-03 OFF-RD OPERATIONS, 2L, 2W, 15' (4.5 m) TO 24' (600 m) FROM PAVEMENT EDGE
- 701301-04 LANE CLOSURE, 2L, 2W, SHORT TIME OPERATIONS
- 701501-04 URBAN LANE CLOSURE, 2L, 2W, UNDIVIDED
- 701901-02 TRAFFIC CONTROL DEVICES

**GENERAL NOTES**

- 1) ALL ELEVATIONS ARE REFERENCED TO ELEVATIONS ESTABLISHED BY VASCONCELLES ENGINEERING CORP.
- 2) WHERE SECTION OR SUBSECTION MONUMENTS ARE ENCOUNTERED, THE ENGINEER SHALL BE NOTIFIED BEFORE SUCH MONUMENTS ARE REMOVED. THE CONTRACTOR SHALL PROTECT AND CAREFULLY PRESERVE ALL PROPERTY MARKERS AND MONUMENTS UNTIL THE OWNER AND AUTHORIZED SURVEYOR OR AGENT HAS WITNESSED OR OTHERWISE REFERENCED THEIR LOCATION. IF THE ENGINEER DECIDES TO HAVE THE CONTRACTOR RESET THE MONUMENT, THIS WORK WILL BE PAID FOR IN ACCORDANCE WITH ARTICLE 109.04.
- 3) THE CONTRACTOR SHALL CONTACT J.U.L.I.E. PRIOR TO ANY EXCAVATION TO HAVE ALL PUBLIC AND PRIVATE UTILITIES LOCATED.
- 4) THE CONTRACTOR SHALL BE RESPONSIBLE FOR PROTECTING UTILITY PROPERTY FROM CONSTRUCTION OPERATIONS AS OUTLINED IN ARTICLE 107.26 OF THE STANDARD SPECIFICATIONS. THE J.U.L.I.E. NUMBER IS (800) 892-0123. A MINIMUM OF 48 HOURS ADVANCE NOTICE IS REQUIRED. SEE SPECIAL PROVISIONS FOR STATUS OF UTILITIES, WITH UTILITY COMPANIES LISTED.
- 5) ANY REFERENCE TO THE STANDARDS THROUGHOUT THE PLANS SHALL BE INTERPRETED TO BE THE LATEST STANDARDS OF THE DEPARTMENT AS INCLUDED IN THE PLANS.
- 6) ALL DETAILS IN THE PLANS SHALL GOVERN CONSTRUCTION OF THIS PROJECT, AND IN CASE OF CONFLICT WITH ANY STANDARD DRAWINGS INCLUDED, THE SAID DETAILS SHALL TAKE PRECEDENCE AND GOVERN.
- 7) THE STATIONS AND OFFSETS NOTED ON THE PLANS FOR THE BRICK SIDEWALK AT THE PARK AND THE VILLAGE CHURCH ARE PROVIDED TO ASSIST IN THE PLACEMENT OF THE BRICKS. IT IS ANTICIPATED THAT THE BRICKS SHOULD REMAIN WHOLE AS MUCH AS POSSIBLE, NOT CUT, AND THEREFORE ALL STATIONS AND OFFSETS MAY NOT BE MET. THE STATIONS AND OFFSETS THAT ARE ADJACENT TO THE ROADS SHOULD BE FOLLOWED AS MUCH AS POSSIBLE DURING CONSTRUCTION TO PROVIDE FOR A UNIFORM PLACEMENT OF THE BRICK.

FILE NAME = #FILEL*	USER NAME = #USER*	DESIGNED - R.H.D.	REVISED -
		DRAWN - S.D.K.	REVISED -
		CHECKED - R.H.D.	REVISED -
		DATE - 3/26/11	REVISED -

**STATE OF ILLINOIS  
DEPARTMENT OF TRANSPORTATION**

**TYPICAL SECTIONS, STANDARDS AND GENERAL NOTES  
BISHOP HILL STATE HISTORIC SITE**

SCALE: SHEET NO. 2 OF 9 SHEETS STA. TO STA.

F.A. RTE.	SECTION	COUNTY	TOTAL SHEETS	SHEET NO.
	VARIOUS	HENRY	9	2
CONTRACT NO. 46224				
ILLINOIS FED. AID PROJECT				

**VISITOR CENTER**

STATION(S)	TRENCH BACKFILL	GRADING & SHAP DITCH	TEMP DITCH CHECKS	INLET & PIPE PROTECT	STONE RIPRAP CL 3	SUB GRAN MAT B 4	PROTECTIVE COAT	PCC DRIVEWAY PAVT 7	DETECTABLE WARNINGS	PAVEMENT REMOVAL	PIPE CULVERT REMOVAL	PRC FLAR END SEC 12	STORM SEWERS, CLASS A, TYPE 1 12"	MAN TA 4 DIA T&G	INLETS TA T&G	FURNISHING AND SETTING BRICK PAVERS	SIGN REMOVAL	MINOR SIGN COMPLETE	STEEL EDGING	SUMP PUMP LINE CONN	
	CY YD	FOOT			SQ YD	SQ YD	SQ YD	SQ YD	SQ FT	SQ YD	FOOT	EACH	LIN. FT.	EACH	EACH	SQ FT	EACH	EACH	FOOT	EACH	
99+57.66 LT TO 100+52.66 LT		95																			
99+60 LT			10																		
100+00 LT			10																		
100+94.50 LT TO 101+02.50 LT					3																
101+02.50 LT																					
101+06.50 LT TO 102+68.50 LT													236								
102+29.36 LT TO 102+96.63 LT						353	353	353		882											
102+37.27 LT TO 102+86.14 LT											52										
102+42.75 LT TO 102+86.49 LT	15																				
102+92.00 LT				1																	
102+92.00 LT TO 104+50.00 LT														1							
102+93.00, 35.00' LT													158								
103+5.90, 43.03' LT																	1				
104+50.00 LT TO 105+08.00 LT													58								
105+08 LT				1											1						1
105+08.00 LT TO 106+62.41 LT																					
106+05.86 LT TO 106+61.27 LT						322	322	322		874			154								
106+18.09 LT TO 106+57.39 LT	13.4																				
106+49.68 LT TO 106+56.45 LT									8							15				12	
106+60.00, 32.00' LT																					
106+62.67 LT				1											1					1	
ENTIRE AREA																					
<b>TOTAL - VISITOR CENTER</b>	<b>28.4</b>	<b>95</b>	<b>20</b>	<b>3</b>	<b>3</b>	<b>675</b>	<b>675</b>	<b>675</b>	<b>8</b>	<b>1756</b>	<b>52</b>	<b>1</b>	<b>606</b>	<b>2</b>	<b>1</b>	<b>15</b>	<b>1</b>	<b>2</b>	<b>12</b>	<b>1</b>	

EAST SIDE OF VILLAGE PARK & VILLAGE CHURCH							
STATION(S)	DETECTABLE WARNINGS	FUR & SET BRICK PAVERS	REM & RELAY BRICK SDWLK	TIMBER SDWLK REM REPL	WOODEN FENCE REMOV	WOOD FENCE	STEEL EDGING
	SQ FT	SQ FT	SQ FT	LSUM	FOOT	FOOT	FOOT
200+10.67 TO 200+12.67	10						
200+10.67 TO 202+50.00			1009				484
200+10.67 TO 203+89.08							
200+33.87, 5.3' LT							
200+35.52, 3.8' LT							
200+36.00 TO 202+10.00					174	174	
200+36.38, 1.9' LT							
202+15.00 TO 202+50.00					35	35	
202+50.00 TO 203+67.00					117	117	
202+50.00 TO 203+89.08 RT			642				283
203+67.23, 4.7' RT							
203+68.48, 2.7' RT							
203+70.25, 1.0' RT							
203+73.61 RT TO 203+78.61 RT	10						4
203+73.61 LT TO 203+78.61 LT							21
203+87.08 RT TO 203+89.08	10						4
204+74.76 TO 205+50.00		371	292				146
205+40.25 TO 205+44.25				(24 SQ FT)			
205+50.00 TO 206+72.35		609	511				241
206+55.70 RT TO 206+59.70 RT				(54 SQ FT)			
206+70.35 RT TO 206+72.35 RT	10						4
ENTIRE AREA							
<b>TOTAL - EAST SIDE</b>	<b>40</b>	<b>980</b>	<b>2454</b>	<b>1</b>	<b>326</b>	<b>326</b>	<b>1187</b>

MOBILIZATION	
LOCATION	QUANTITY (LSUM)
ENTIRE PROJECT	1 LSUM
<b>TOTAL =</b>	<b>1 LSUM</b>

100%  
STATE  
0044

SUMMARY OF QUANTITIES			
CODE *	PAY ITEM	UNITS	TOTAL
20800150	TRENCH BACKFILL	CU YD	28.4
21400100*	GRADING AND SHAPING DITCHES	FOOT	95
28000305	TEMPORARY DITCH CHECKS	FOOT	20
28000500	INLET AND PIPE PROTECTION	EACH	3
28100105	STONE RIPRAP, CLASS A3	SQ YD	3
31101200	SUBBASE GRANULAR MATERIAL, TYPE B 4"	SQ YD	675
42001300	PROTECTIVE COAT	SQ YD	675
42300300	PORTLAND CEMENT CONCRETE DRIVEWAY PAVEMENT, 7 INCH	SQ YD	675
42400800*	DETECTABLE WARNINGS	SQ FT	48
44000100	PAVEMENT REMOVAL	SQ YD	1756
50105220	PIPE CULVERT REMOVAL	FOOT	52
54213657	PRECAST REINFORCED CONCRETE FLARED END SECTIONS 12"	EACH	1
550A0050	STORM SEWERS, CLASS A, TYPE 1 12"	FOOT	606
60219000	MANHOLES, TYPE A, 4'-DIAMETER, TYPE 8 GRATE	EACH	2
60236200	INLETS, TYPE A, TYPE 8 GRATE	EACH	1
67100100	MOBILIZATION	L SUM	1
70102620	TRAFFIC CONTROL AND PROTECTION STANDARD 701601	L SUM	1
X0300266*	WOODEN FENCE REMOVAL	FOOT	326
X0540000*	BRICK PAVERS	SQ FT	995
X0325204*	TIMBER SIDEWALK REMOVAL AND REPLACEMENT	L SUM	1
X2240300	SIGN REMOVAL	EACH	1
K1005582*	STEEL EDGING	FOOT	1199
XX000882*	WOOD FENCE	FOOT	326
XX001877	SUMP PUMP LINE CONNECTION	EACH	1
X2020410	EARTH EXCAVATION (SPECIAL)	CU YD	10
XX004018*	REMOVE AND RELAY BRICK SIDEWALK	SQ FT	2454
XX005644*	MINOR SIGN COMPLETE	EACH	2

FILE NAME =	USER NAME = #USER#	DESIGNED - R.H.D.	REVISED -	STATE OF ILLINOIS DEPARTMENT OF TRANSPORTATION
#FILE#		DRAWN - S.D.K.	REVISED -	
	PLOT SCALE = #SCALE#	CHECKED - R.H.D.	REVISED -	
	PLOT DATE = #DATE#	DATE - 3/26/12	REVISED -	

SCHEDULE/SUMMARY OF QUANTITIES		
BISHOP HILL STATE HISTORIC SITE		
SCALE: 1" = 20'	SHEET NO. 3 OF 9 SHEETS	STA. 100+00 TO STA. 104+50



F.A. RTE.	SECTION	COUNTY	TOTAL SHEETS	SHEET NO.
	VARIOUS	HENRY	9	3
			CONTRACT NO. 46224	
ILLINOIS FED. AID PROJECT				

JOB NO. 250-061-J VASCONCELLES ENGINEERING CORP. DESIGN FIRM REGISTRATION NUMBER 184-002107

CONTROL POINT #5  
P.K. NAIL  
N: 1,651,406.17  
E: 2,309,158.71  
ELEV = 773.66

CONTROL POINT #6  
P.K. NAIL  
N: 1,651,189.34  
E: 2,309,152.63  
ELEV = 780.29



-  REMOVE AND RELAY BRICK SIDEWALK
-  FURNISHING AND SETTING BRICK PAVERS
-  PAVEMENT REMOVAL

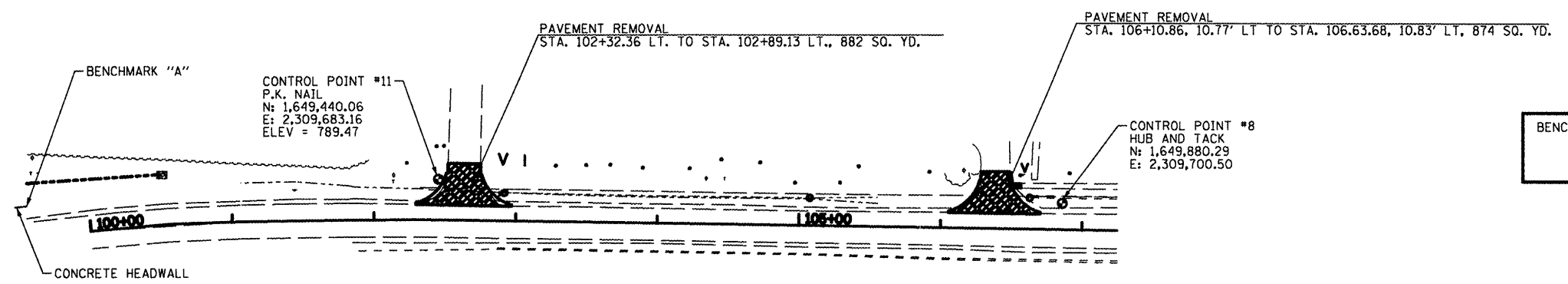
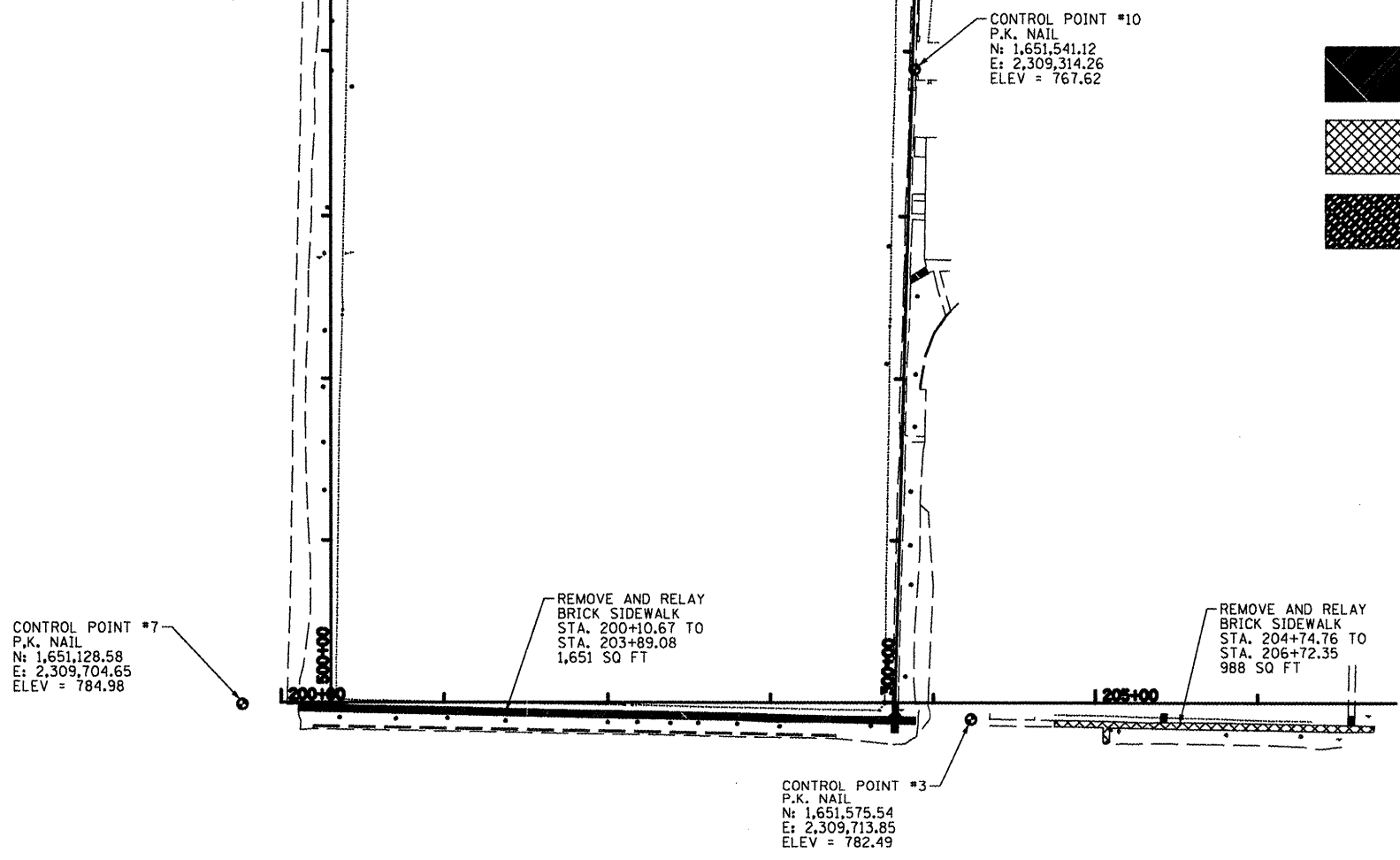

BENCHMARK "A" NORTHWEST CORNER OF CONCRETE HEADWALL LOCATED AT STA. 99+56  
ASSUMED ELEV = 786.41

FILE NAME =	USER NAME = #USER#	DESIGNED - R.H.D.	REVISED -	STATE OF ILLINOIS DEPARTMENT OF TRANSPORTATION	DEMOLITION PLAN BISHOP HILL STATE HISTORIC SITE			SECTION VARIOUS	COUNTY HENRY	TOTAL SHEETS 9	SHEET NO. 4
#FILE#	PLOT SCALE = #SCALE#	DRAWN - S.D.K.	REVISED -		SCALE: 1" = 50'	SHEET NO. 4 OF 9 SHEETS	STA. TO STA.				
	PLOT DATE = #DATE#	CHECKED - R.H.D.	REVISED -								
		DATE - 3/28/12	REVISED -								
ILLINOIS P.B. AND PROJECT											

JOB NO. 250-081-U VASCONCELLES ENGINEERING CORP. DESIGN FIRM REGISTRATION NUMBER 184-002107

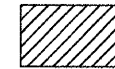

PAVEMENT REMOVAL

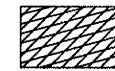

AGGREGATE SHOULDER REMOVAL

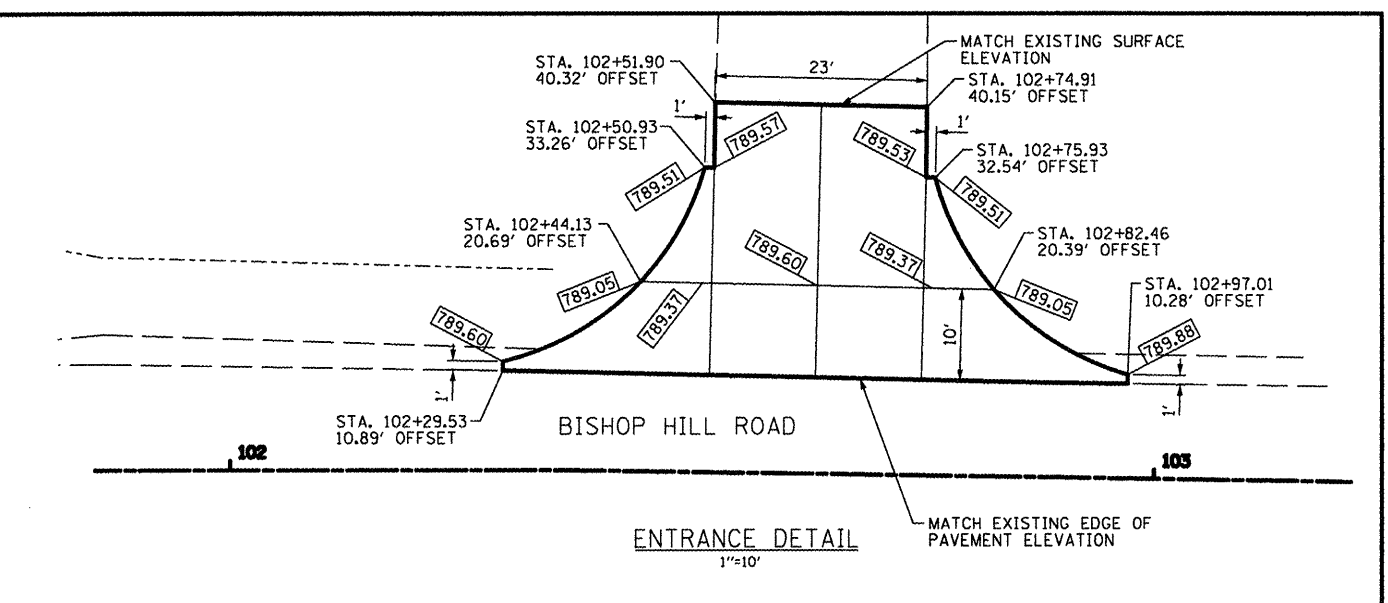
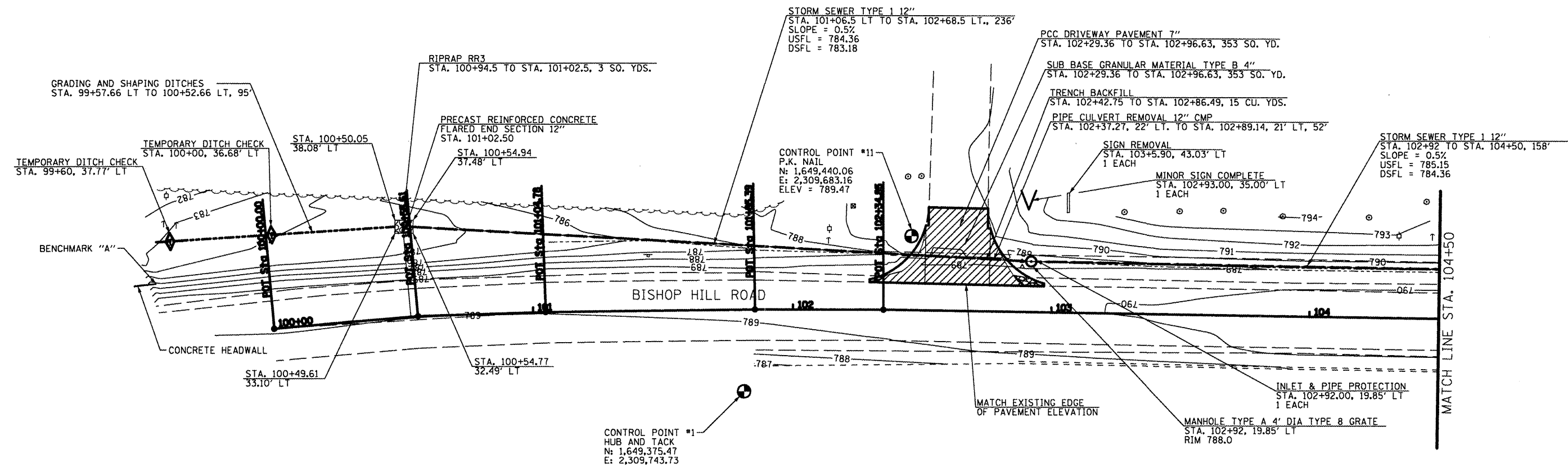

BASELINE COORDINATES

STA. 100+00	N: 1,649,194.53	E: 2,309,719.68
STA. 100+55.61	N: 1,649,249.92	E: 2,309,714.75
STA. 101+04.78	N: 1,649,299.06	E: 2,309,713.13
STA. 101+85.39	N: 1,649,379.67	E: 2,309,712.03
STA. 102+34.85	N: 1,649,429.13	E: 2,309,712.00
STA. 104+00.00	N: 1,649,594.26	E: 2,309,714.52

BENCHMARK "A" NORTHWEST CORNER OF CONCRETE HEADWALL LOCATED AT STA. 99+56  
ASSUMED ELEV = 786.41

FILE NAME =	USER NAME = #USER#	DESIGNED - R.H.D.	REVISED -
#FILE#		DRAWN - S.D.K.	REVISED -
	PLOT SCALE = #SCALE#	CHECKED - R.H.D.	REVISED -
	PLOT DATE = #DATE#	DATE - 2/26/12	REVISED -

STATE OF ILLINOIS  
DEPARTMENT OF TRANSPORTATION

PLAN SHEET VISITOR CENTER STA. 100+00 - 104+50  
BISHOP HILL STATE HISTORIC SITE  
SCALE: 1" = 20' SHEET NO. 5 OF 9 SHEETS STA. 100+00 TO STA. 104+50

SECTION	COUNTY	TOTAL SHEETS	SHEET NO.
VARIOUS	HENRY	9	5
CONTRACT NO. 46224		ILLINOIS FED. AID PROJECT	

JOB NO. 250-063-U VASCONCELLES ENGINEERING CORP. DESIGN FIRM REGISTRATION NUMBER 184-002107

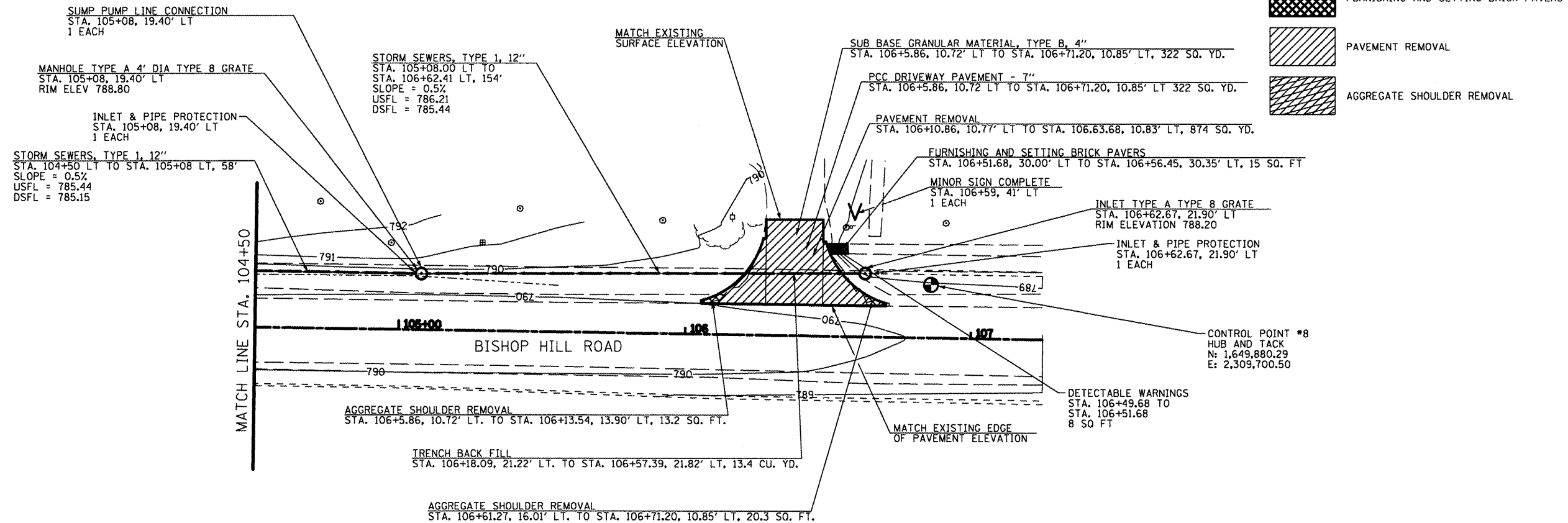

**BASELINE COORDINATES**

STA. 105+00  
 N: 1,649,694.25  
 E: 2,309,716.04  
 STA. 107+00  
 N: 1,649,894.22  
 E: 2,309,719.09

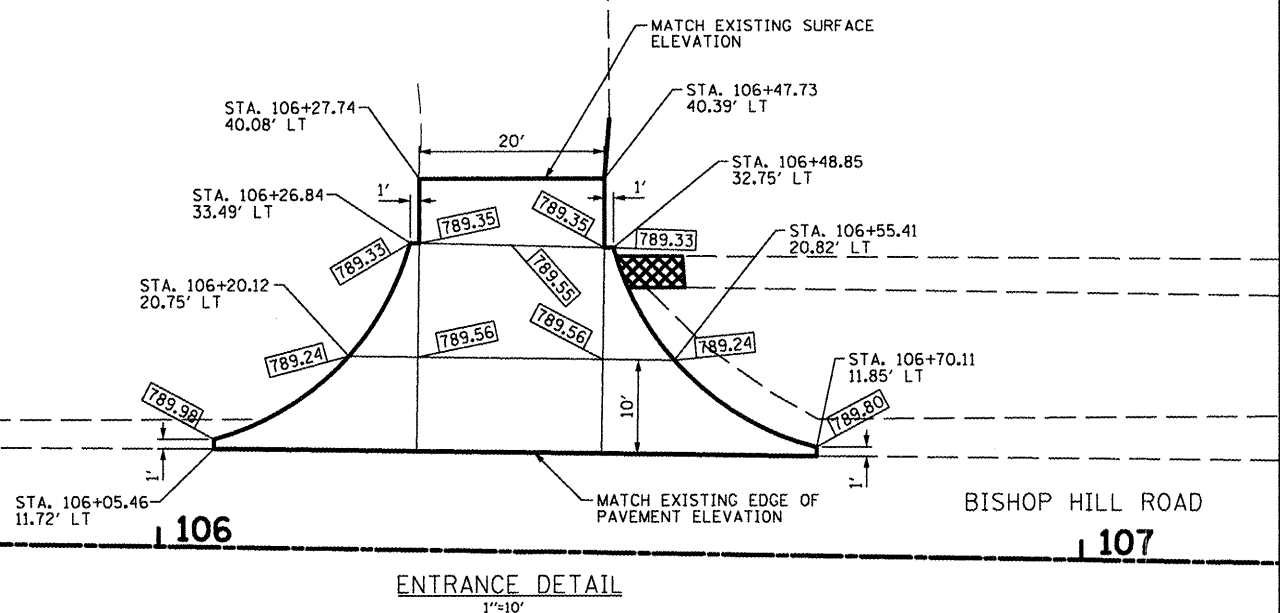

BENCHMARK "A" NORTHWEST CORNER OF CONCRETE HEADWALL LOCATED AT STA. 99+56  
 ASSUMED ELEV = 786.41

FILE NAME =	USER NAME = #USER#	DESIGNED - R.H.D.	REVISED -
#FILE#		DRAWN - S.D.J.	REVISED -
	PLOT SCALE = #SCALE#	CHECKED - R.H.D.	REVISED -
	PLOT DATE = #DATE#	DATE - 3/28/12	REVISED -

STATE OF ILLINOIS  
 DEPARTMENT OF TRANSPORTATION

PLAN SHEET VISITOR CENTER STA. 104 + 50 - 107 + 25  
 BISHOP HILL STATE HISTORIC SITE  
 SCALE: 1" = 20' SHEET NO. 6 OF 9 SHEETS STA. 104+50 TO STA. 107+25

DATE	SECTION	COUNTY	TOTAL SHEETS	SHEET NO.
	VARIOUS	HENRY	9	6
			CONTRACT NO. 46224	
ILLINOIS PBL. AND PROJECT				

JOB NO. 260-081-J VASCORCELLES ENGINEERING CORP. DESIGN FIRM REGISTRATION NUMBER 184-00207

BENCHMARK "A" NORTHWEST CORNER OF CONCRETE HEADWALL LOCATED AT STA. 99+56  
 ASSUMED ELEV = 786.41

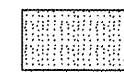

 PROPOSED BRICK SIDEWALK

**BASELINE COORDINATES**

STA. 200+00  
 N: 1,651,152.19  
 E: 2,309,703.54

STA. 202+00  
 N: 1,651,352.19  
 E: 2,309,703.54

STA. 500+00  
 N: 1,651,182.86  
 E: 2,309,703.54

STA. 501+00  
 N: 1,651,182.86  
 E: 2,309,603.54

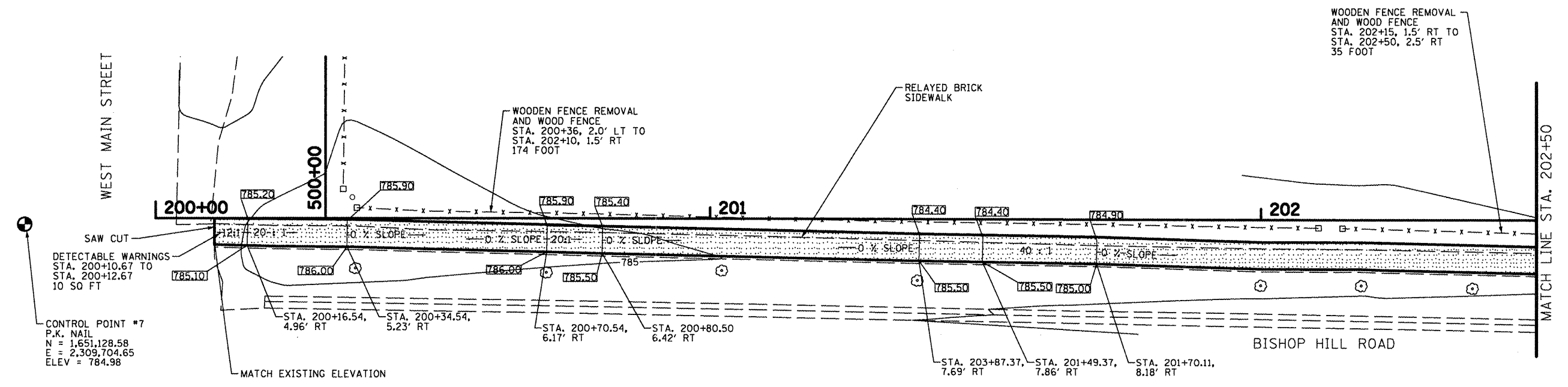

FILE NAME =  
 #FILE#

USER NAME = #USER#  
 PLOT SCALE = #SCALE#  
 PLOT DATE = #DATE#

DESIGNED - R.H.D.	REVISED -
DRAWN - S.D.K.	REVISED -
CHECKED - R.H.D.	REVISED -
DATE - 3/28/12	REVISED -

**STATE OF ILLINOIS  
 DEPARTMENT OF TRANSPORTATION**

**PLAN SHEET VILLAGE SQUARE STA. 200+00-202+50 & 500+00-501+50  
 BISHOP HILL STATE HISTORIC SITE**

SCALE: 1" = 30'    SHEET NO. 7 OF 9 SHEETS    STA. 200+00 TO STA. 203+00

SECTION	COUNTY	TOTAL SHEETS	SHEET NO.
VARIOUS	HENRY	9	7
CONTRACT NO. 46224		ILLINOIS FED. AID PROJECT	

JOB NO. 260-08-U VASCORCELLES ENGINEERING CORP. DESIGN FIRM REGISTRATION NUMBER J4-F-000107

BENCHMARK "A" NORTHWEST CORNER OF CONCRETE HEADWALL LOCATED AT STA. 99+56  
ASSUMED ELEV = 786.41



PROPOSED BRICK SIDEWALK  
TIMBER SIDEWALK

**BASELINE COORDINATES**

STA. 200+00  
N = 1,651,152.19  
E = 2,309,703.54  
  
STA. 206+85.21  
N = 1,651,837.40  
E = 2,309,703.54

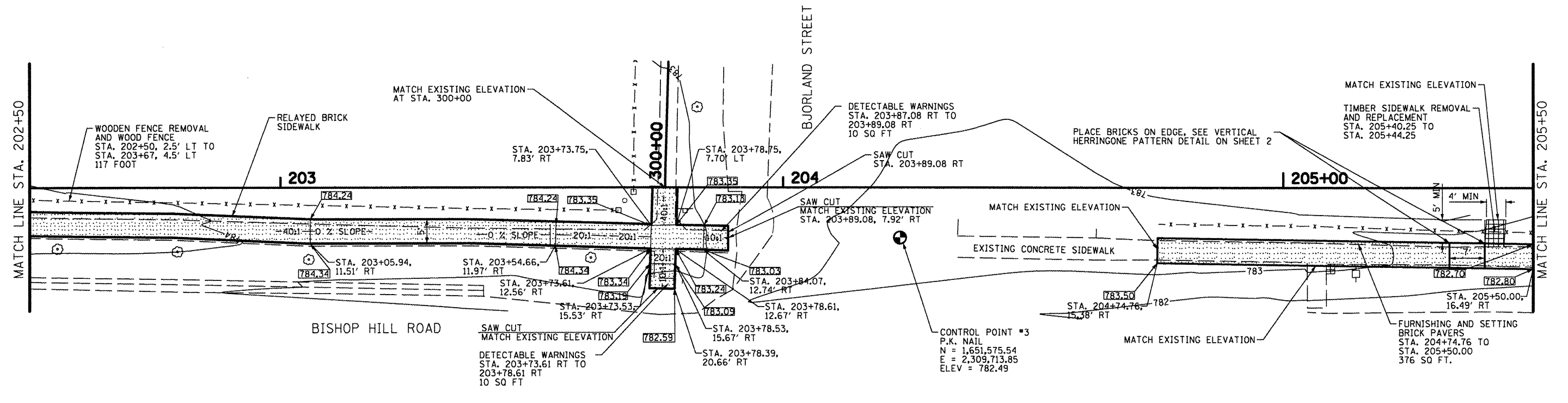
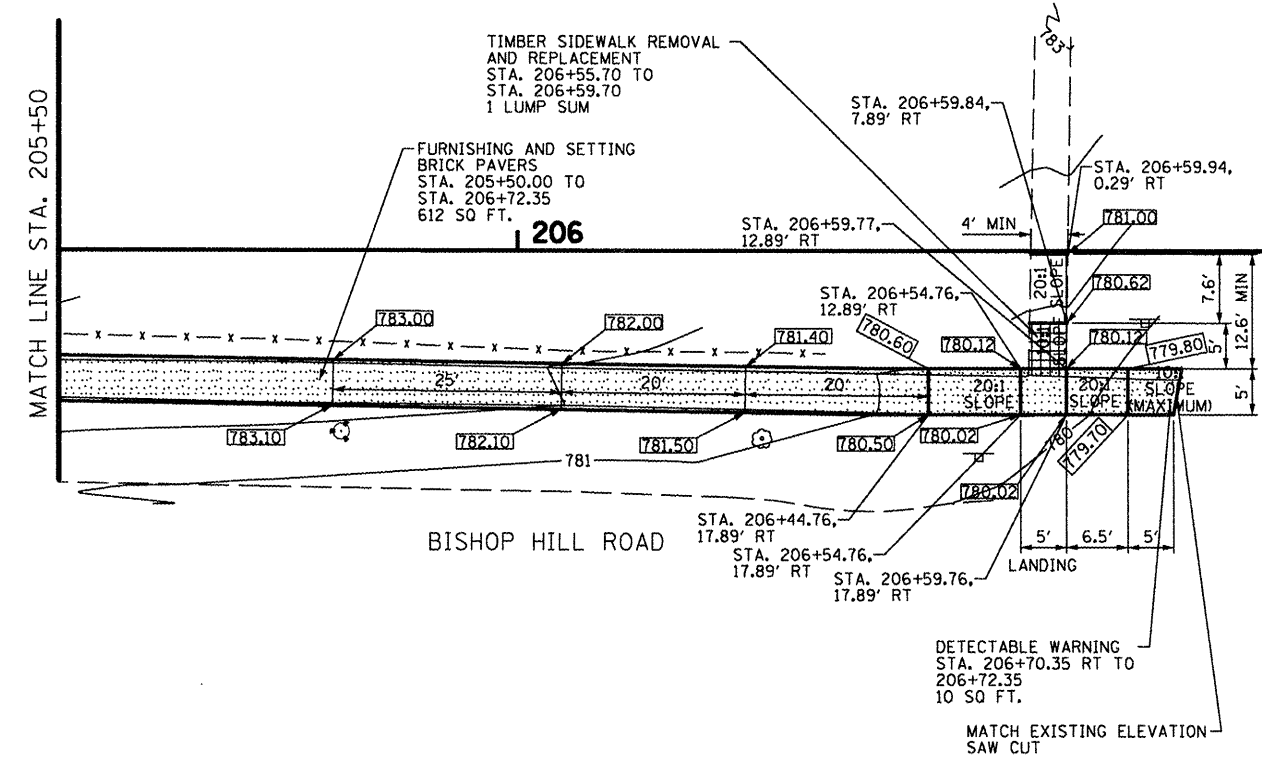

FILE NAME =	USER NAME = #USER#	DESIGNED - R.H.D.	REVISED -
#FILE#		DRAWN - S.D.J.	REVISED -
	PLOT SCALE = #SCALE#	CHECKED - R.H.D.	REVISED -
	PLOT DATE = #DATE#	DATE - 3/28/12	REVISED -

**STATE OF ILLINOIS  
DEPARTMENT OF TRANSPORTATION**

**PLAN SHEET STA. 202+50 - 205+50 & 300+00 - 301+50  
BISHOP HILL STATE HISTORIC SITE**

SCALE: 1" = 10' SHEET NO. 8 OF 9 SHEETS STA. 202+50 TO STA. 206+50

SECTION	COUNTY	TOTAL SHEETS	SHEET NO.
VARIOUS	HENRY	9	8
CONTRACT NO. 46224		ILLINOIS P.B. AND PROJECT	

JOB NO. 200-081-U VASCONCELLES ENGINEERING CORP. DESIGN FIRM REGISTRATION NUMBER 184-002107



ALL EXISTING HINGES, GATE CLOSERS, AND HARDWARE SHALL BE CAREFULLY REMOVED AND PROVIDED TO THE SITE MANAGER. REPLACEMENT OF THESE ITEMS SHALL MATCH THE EXISTING CONFIGURATION AND BE MANUFACTURED WITH A MATERIAL COMPATIBLE WITH THE TREATED WOOD.

NOTE: LUMBER SIZES ON THIS SHEET ARE ACTUAL SIZES UNLESS NOTED DIFFERENTLY.

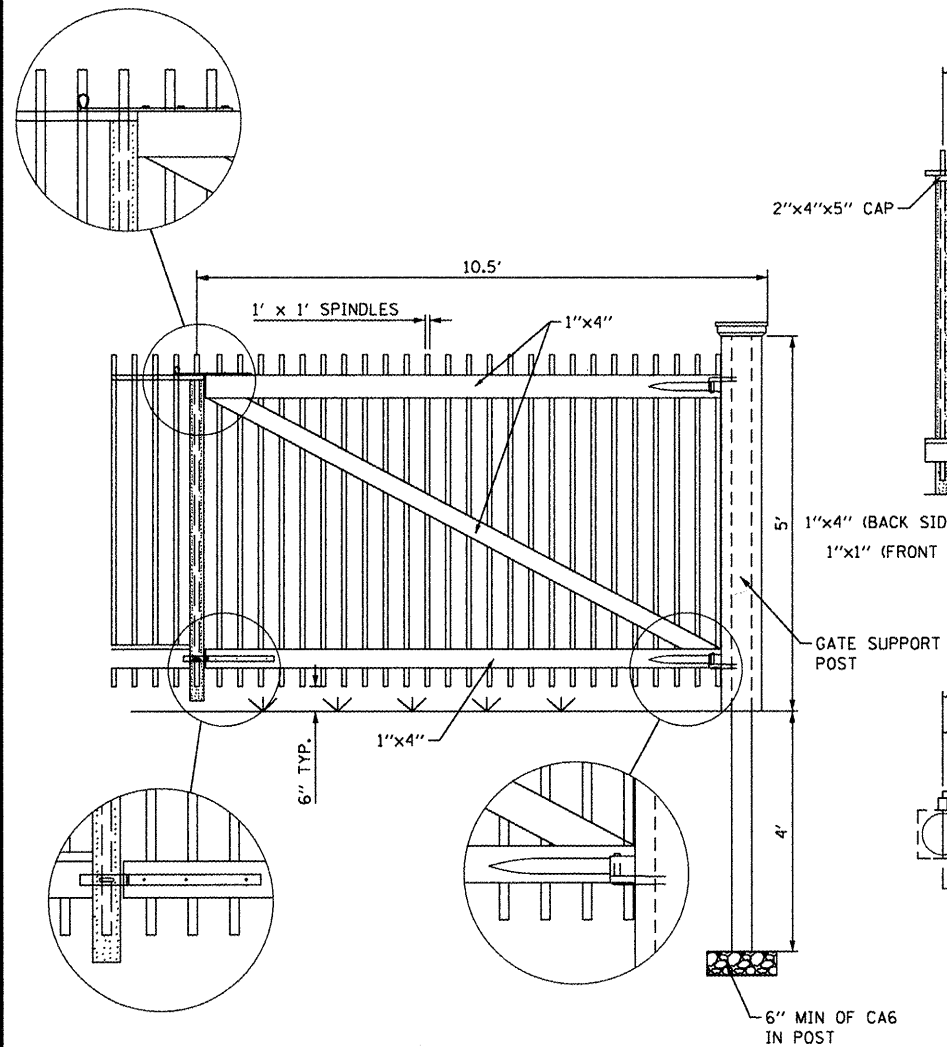

TYPICAL GATE SECTION  
NOT TO SCALE

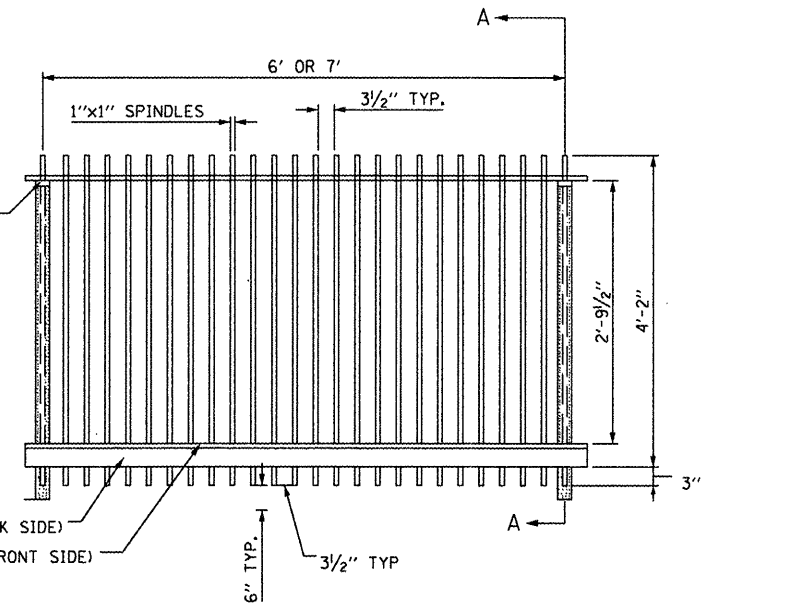

TYPICAL FENCE PANEL SECTION  
NOT TO SCALE

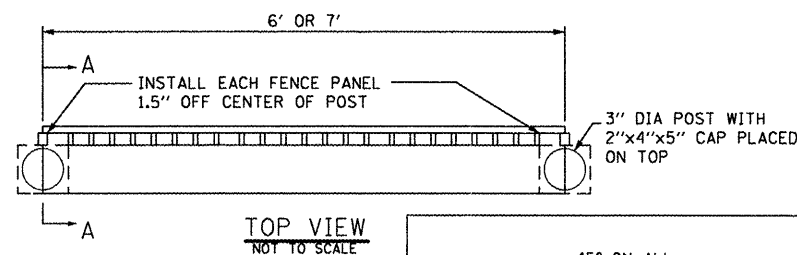

TOP VIEW  
NOT TO SCALE

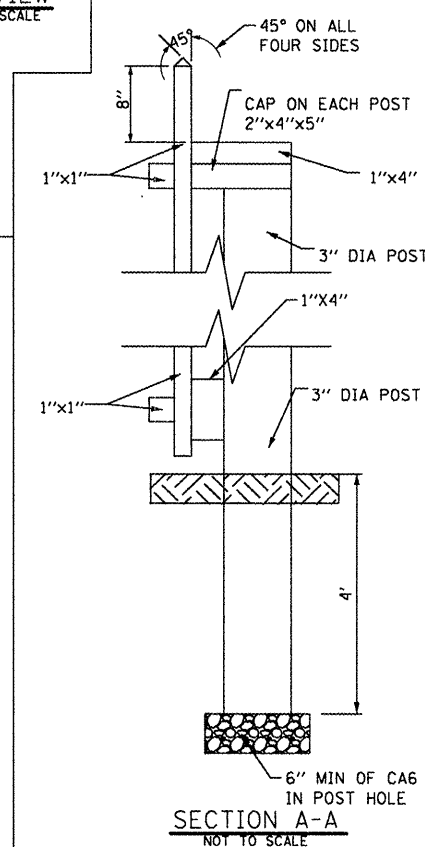

SECTION A-A  
NOT TO SCALE

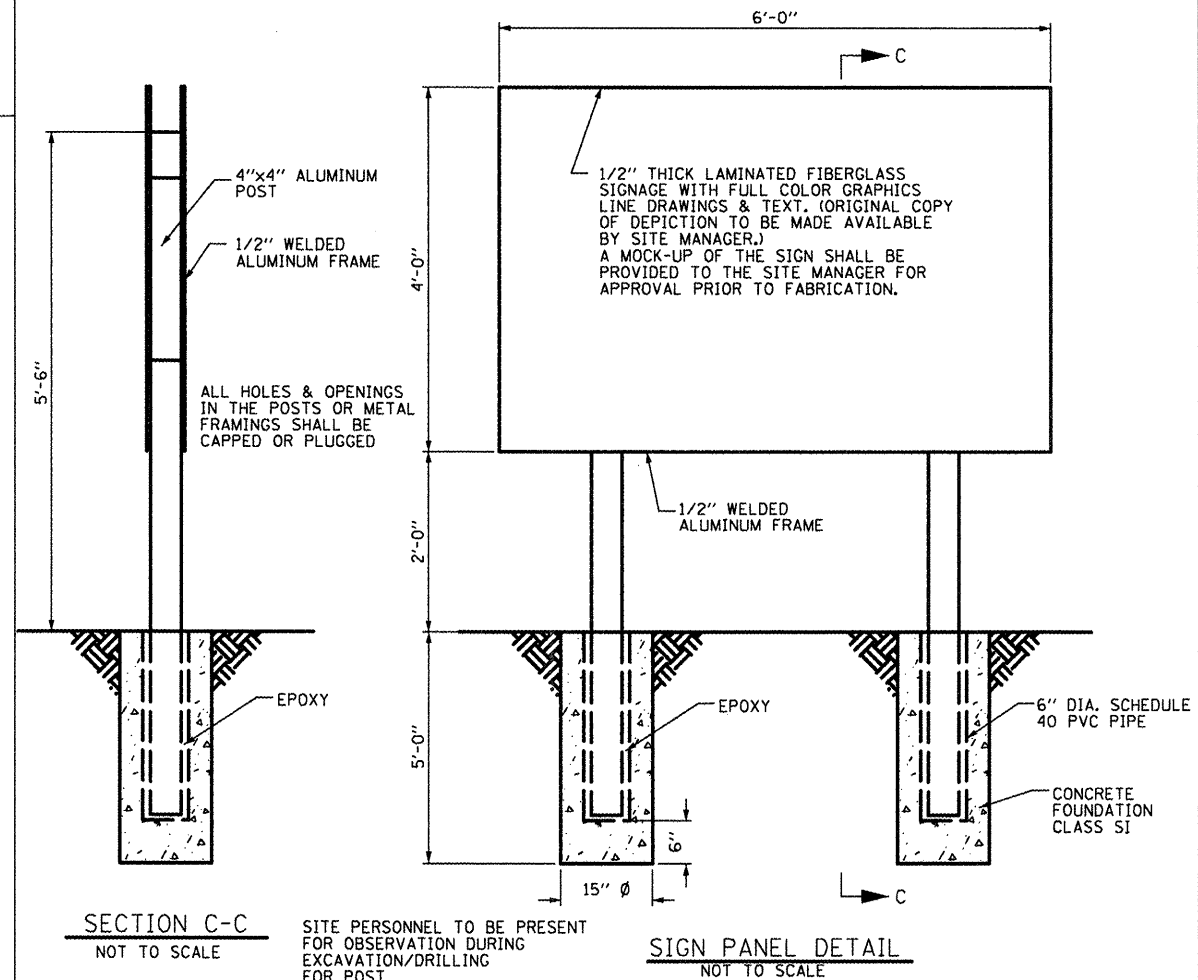
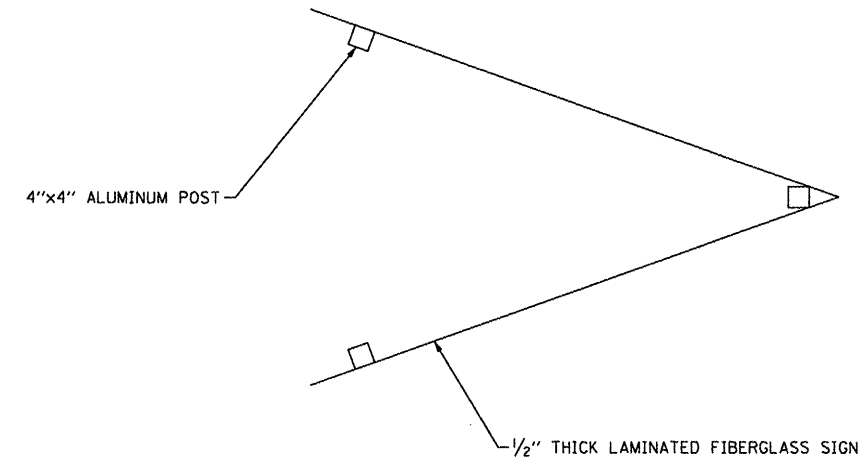

SECTION C-C  
NOT TO SCALE

SIGN PANEL DETAIL  
NOT TO SCALE

SITE PERSONNEL TO BE PRESENT FOR OBSERVATION DURING EXCAVATION/DRILLING FOR POST

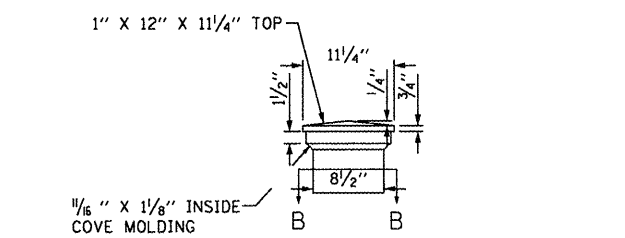

TYPICAL GATE & ACCESS LOCATION POST CAP  
NOT TO SCALE

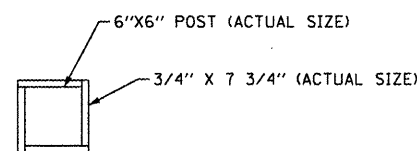

SECTION B-B  
NOT TO SCALE

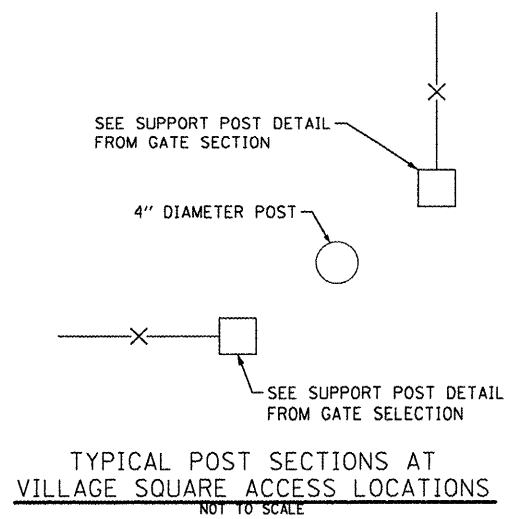

TYPICAL POST SECTIONS AT VILLAGE SQUARE ACCESS LOCATIONS  
NOT TO SCALE

FILE NAME =	USER NAME = #USER#	DESIGNED - R.H.D.	REVISED -
#FILE#		DRAWN - S.J.L.	REVISED -
	PLOT SCALE = #SCALE#	CHECKED -	REVISED -
	PLOT DATE = #DATE#	DATE - 3/26/12	REVISED -

STATE OF ILLINOIS  
DEPARTMENT OF TRANSPORTATION

DETAILS		SCALE:	TO STA.
BISHOP HILL STATE HISTORIC SITE		SHEET NO. 9 OF 9 SHEETS	STA. TO STA.

SECTION	COUNTY	TOTAL SHEETS	SHEET NO.
VARIOUS	HENRY	9	9
CONTRACT NO. 46224		JOB NO. 200-083-J VASCONECLES ENGINEERING CORP. DESIGN FIRM REGISTRATION NUMBER 184-002107	