

SHEET NO.	SHEET TITLE
1	COVER SHEET
2	SUMMARY/SCHEDULE OF QUANTITIES
3	PROPOSED OVERALL LAYOUT
4-6	PROPOSED LAYOUT DAY USE LOOP
7	PROPOSED LAYOUT CAMPGROUND TRAIL/LINCOLN LEAGUE LANE
8	PROPOSED LAYOUT HISTORICAL VILLAGE
9	PROPOSED LAYOUT CAMPGROUND/VISITOR CENTER

LEGEND

- PROPOSED PARKING LOT
- - - - - EXISTING FENCE
- ⊥ EXISTING LIGHT POLE
- ⊥ EXISTING WARNING SIGN
- EXISTING POWER POLE
- ⊕ EXISTING HANDHOLE
- ⊕ EXISTING DOUBLE HANDHOLE
- EXISTING GUY WIRE
- ⊥ EXISTING SIGN
- △ EXISTING FLARED END SECTION
- EXISTING MANHOLE
- EXISTING CATCH BASIN
- EXISTING INLET
- ⊙ EXISTING DECIDUOUS TREE

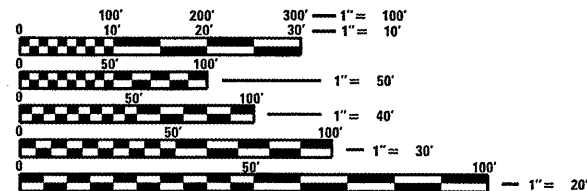

FULL SIZE PLANS HAVE BEEN PREPARED USING STANDARD ENGINEERING SCALES. REDUCED SIZED PLANS WILL NOT CONFORM TO STANDARD SCALES. IN MAKING MEASUREMENTS ON REDUCED PLANS, THE ABOVE SCALES MAY BE USED.

J.U.L.I.E.
 JOINT UTILITY LOCATION INFORMATION FOR EXCAVATION
 1-800-892-0123
 OR 811

PROJECT ENGINEER – ROBERT H. DALTON
 PROJECT MANAGER – ROBERT H. DALTON

CONTRACT NO. 46234

STATE OF ILLINOIS
 DEPARTMENT OF TRANSPORTATION

DIVISION OF HIGHWAYS

**PROPOSED
 HIGHWAY PLANS**

IDOT
 PARK ROADS
 LINCOLN'S NEW SALEM
 MENARD COUNTY
 C-30-050-12

PROJECT LOCATION

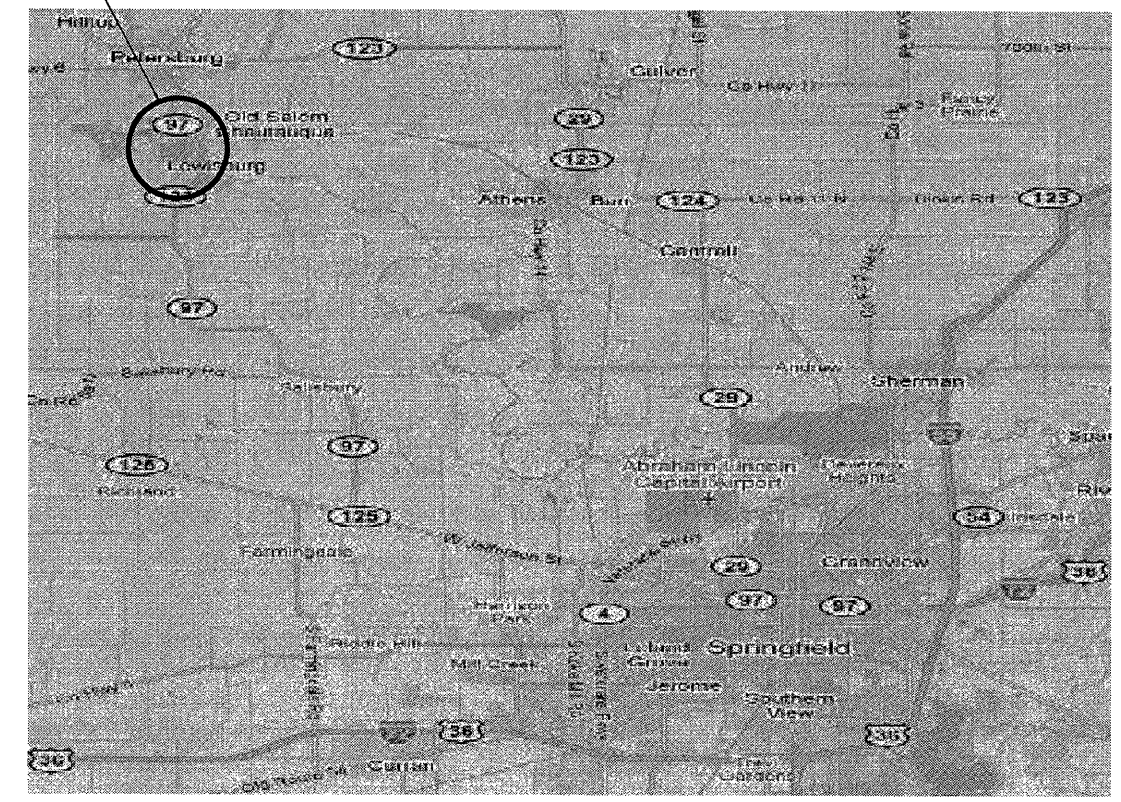

MAP NOT TO SCALE

GROSS LENGTH = x.xx FT. = x.xxx MILE
 NET LENGTH = x.xx FT. = x.xxx MILE

F.A. RTE.	SECTION	COUNTY	TOTAL SHEETS	SHEET NO.
	LINCOLN'S NEW SALEM	MENARD	9	1
		ILLINOIS	CONTRACT NO. 46234	

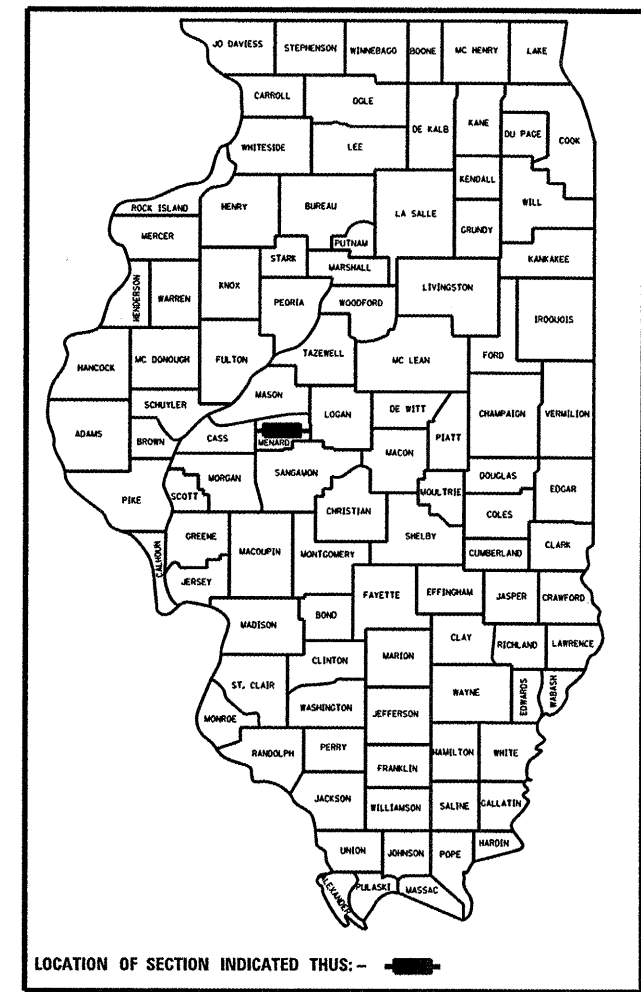

LOCATION OF SECTION INDICATED THUS: —

STATE OF ILLINOIS
 DEPARTMENT OF TRANSPORTATION
 DIVISION OF HIGHWAYS

SUBMITTED May 8 2012
William R. Frey
 DEPUTY DIRECTOR OF HIGHWAYS, REGIONAL ENGINEER

May 11 2012
[Signature]
 acting ENGINEER OF DESIGN AND ENVIRONMENT

May 11 2012
William R. Frey
 acting DIRECTOR OF HIGHWAYS, CHIEF ENGINEER

ROBERT H. DALTON
 REGISTERED PROFESSIONAL ENGINEER
 STATE OF ILLINOIS
 EXPIRES 11/30/13
 SIGNED 4/4/12

**PRINTED BY THE AUTHORITY
 OF THE STATE OF ILLINOIS**

JOB NO. 250-061-V VASCONCELLES ENGINEERING CORP. DESIGN FIRM REGISTRATION NUMBER 184-002107

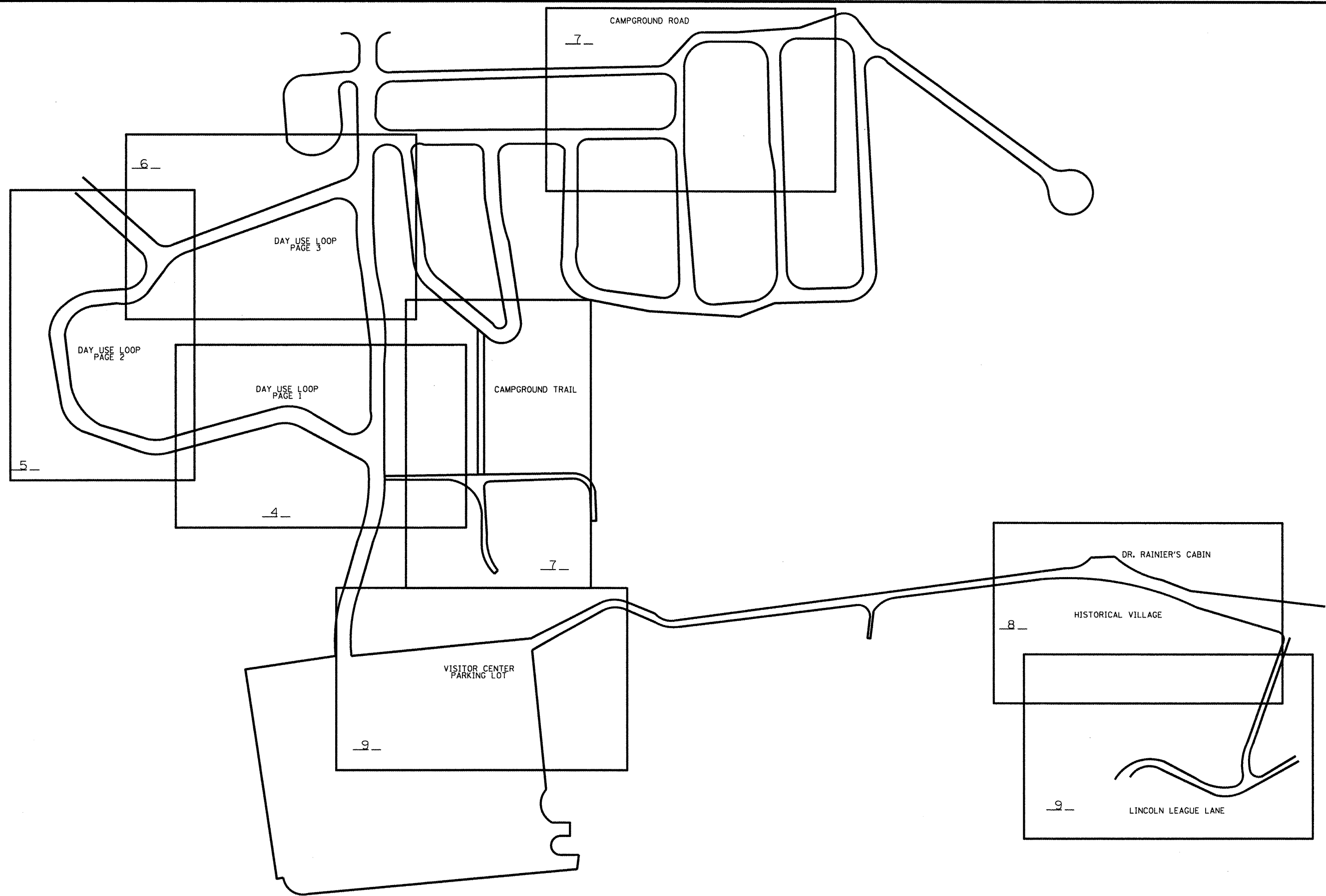

FILE NAME =	USER NAME = #USER#	DESIGNED - R.M.D.	REVISED -
#FILE#		DRAWN - J.T.T.	REVISED -
	PLOT SCALE = #SCALE#	CHECKED - R.M.D.	REVISED -
	PLOT DATE = #DATE#	DATE - 4/4/2012	REVISED -

**STATE OF ILLINOIS
DEPARTMENT OF TRANSPORTATION**

**LINCOLN'S NEW SALEM
SHEET LAYOUT**

SCALE: 1"=200' SHEET NO. 3 OF 9 SHEETS STA. VARIES TO STA.

SECTION	COUNTY	TOTAL SHEETS	SHEET NO.
	LINCOLN'S NEW SALEM	9	3
CONTRACT NO. 46234		ILLINOIS FED. AID PROJECT	

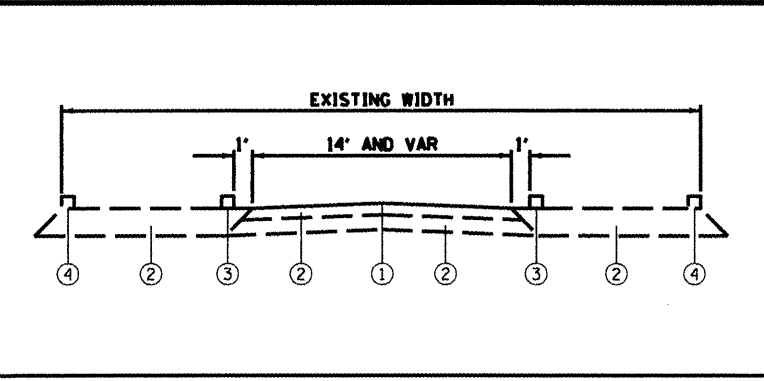
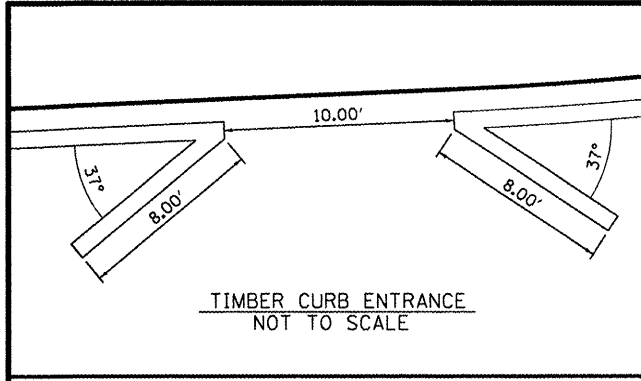

1	A-2 BITUMINOUS SURFACE TREATMENT
2	EXISTING AGGREGATE BASE WITH BITUMINOUS SURFACE TREATMENT
3	PROPOSED TIMBER CURB
4	EXISTING TIMBER CURB - TO BE REMOVED

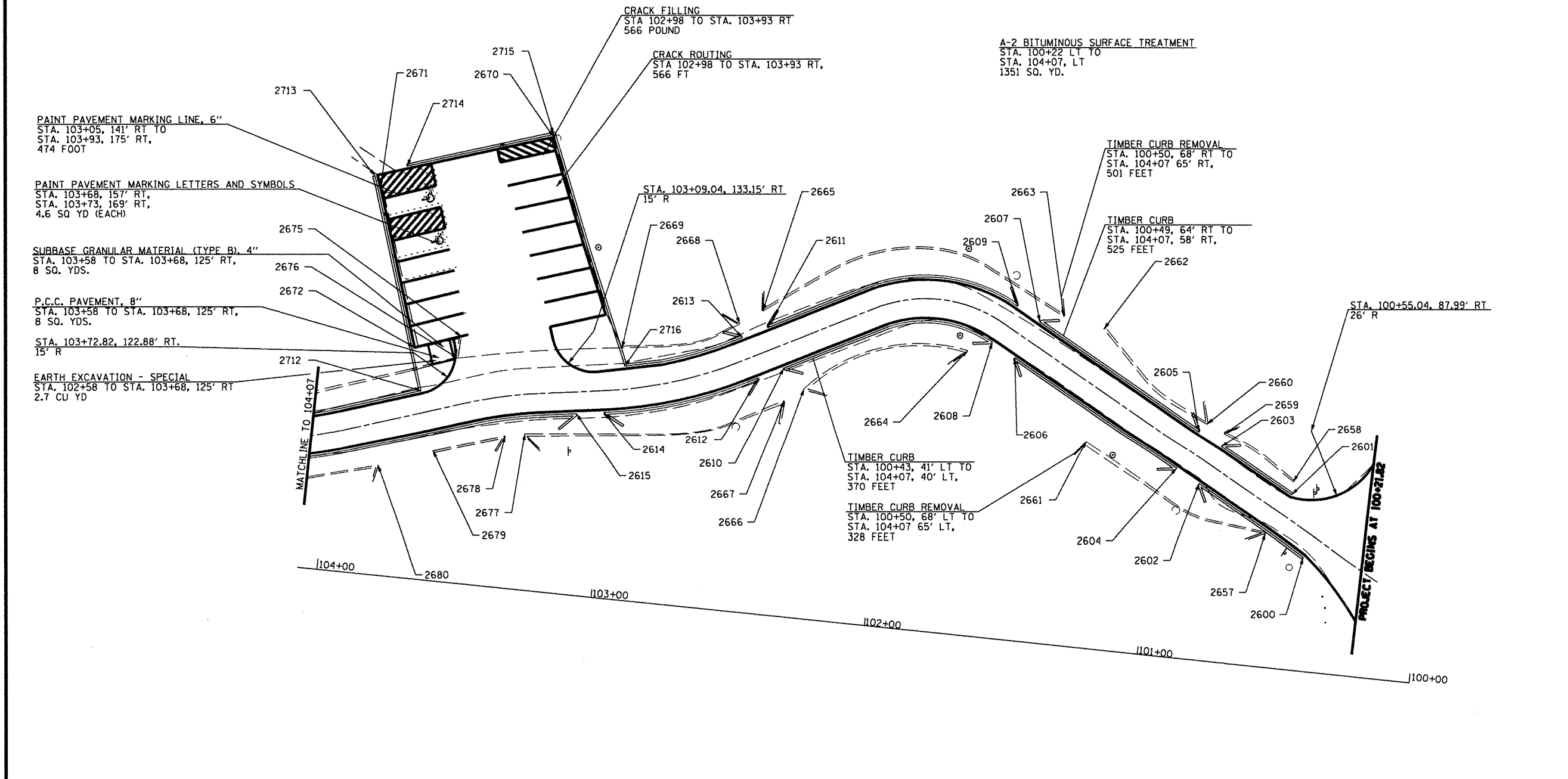

Point	Stationing	offset
2717	100+21.46	41.45
2600	100+43.12	63.30
2658	100+49.58	104.21
2601	100+49.62	63.83
2657	100+57.72	120.24
2659	100+76.45	110.84
2603	100+77.11	68.66
2660	100+83.25	84.06
2602	100+83.73	78.45
2604	100+92.49	83.28
2605	100+85.87	103.41
2662	101+24.26	105.23
2661	101+26.44	78.94
2663	101+39.33	92.07
2607	101+47.80	108.24
2606	101+55.55	117.42
2609	101+56.56	90.89
2608	101+64.30	122.24
2666	102+30.76	84.64
2667	102+37.63	84.68
2610	102+38.87	105.07
2611	102+46.27	86.25
2612	102+47.74	100.44
2665	102+48.69	142.14
2613	102+55.13	67.86
2668	102+56.59	84.68
2664	101+72.96	166.84
2716	102+96.46	66.39
2669	102+98.16	90.39
2614	103+02.22	36.73
2615	103+12.11	52.68
2677	103+29.85	67.68
2715	103+30.96	36.35
2670	103+30.82	82.26
2678	103+36.90	69.88
2675	103+56.46	60.47
2676	103+56.89	59.69
2679	103+62.34	84.27
2674	103+71.49	39.73
2673	103+71.49	47.05
2672	103+72.93	55.51
2680	103+81.68	71.63
2714	103+82.48	53.33
2671	103+91.32	57.12
2713	103+93.79	68.40

BASELINE STARTING STATION COORDINATES:
N: 5357.271 , E: 5004.675

FILE NAME =	USER NAME = #USER#	DESIGNED - R.M.D.	REVISED -
#FILE#		DRAWN - J.T.T.	REVISED -
	PLOT SCALE = #SCALE#	CHECKED -	REVISED -
	PLOT DATE = #DATE#	DATE - 4/4/2012	REVISED -

STATE OF ILLINOIS
DEPARTMENT OF TRANSPORTATION

LINCOLN'S NEW SALEM
DAY USE LOOP

SCALE: 1" = 20'
SHEET NO. 4 OF 9 SHEETS
STA. 100+00 TO STA. 104+07

F.A. RTE.	SECTION	COUNTY	TOTAL SHEETS	SHEET NO.
	LINCOLN'S NEW SALEM	MEHARD	9	4
			CONTRACT NO. 46234	
ILLINOIS P.O.D. AND PROJECT				

JOB NO. 250-061-VASCONCELLES ENGINEERING CORP. DESIGN FIRM REGISTRATION NUMBER 184-002107

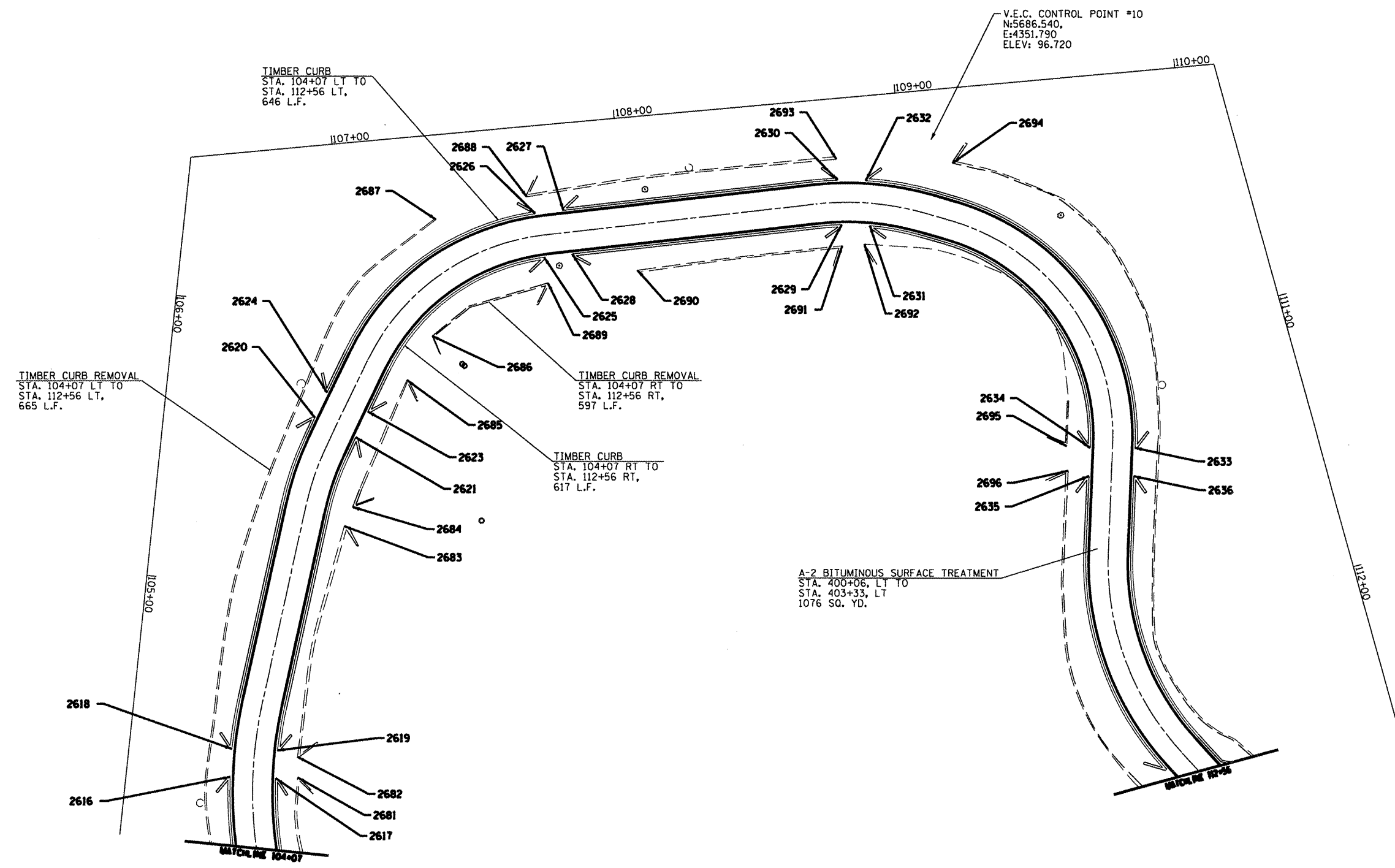

BASELINE TURN AT 106+49.85 LOCATED AT:
N: 5424.599 , E: 4358.326

BASELINE TURN AT 110+13.94 LOCATED AT:
N: 5787.281 , E: 4322.843

DAY USE LOOP

FILE NAME =	USER NAME = #USER#	DESIGNED - R.M.D.	REVISED -
#FILE#		DRAWN - J.T.T.	REVISED -
	PLOT SCALE = #SCALE#	CHECKED - R.M.D.	REVISED -
	PLOT DATE = #DATE#	DATE - 4/4/2012	REVISED -

STATE OF ILLINOIS
DEPARTMENT OF TRANSPORTATION

LINCOLN'S NEW SALEM
DAY USE LOOP

SCALE: 1" = 20' SHEET NO. 5 OF 9 SHEETS STA. 104+07 TO STA. 112+56

F.A. RTE.	SECTION	COUNTY	TOTAL SHEETS	SHEET NO.
	LINCOLN'S NEW SALEM	MENARD	9	5
CONTRACT NO. 46234			ILLINOIS FED. AID PROJECT	

JOB NO. 250-061-Y VASCONECLES ENGINEERING CORP. DESIGN FIRM REGISTRATION NUMBER 184-002107

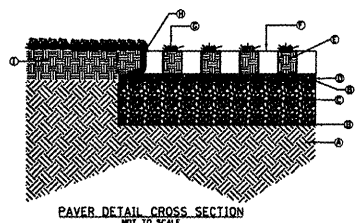
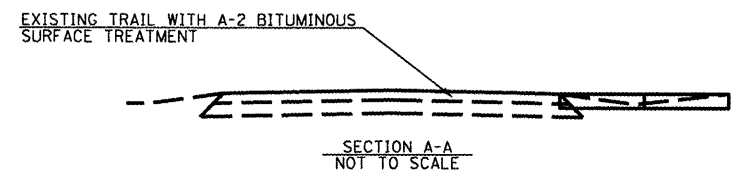

- ④ COMPACTED SUBGRADE
- ⑤ GEOTEXTILE
- ⑥ AGGREGATE BASE, 4" (CA11)
- ⑦ BEDDING SAND, 1" (FA 1 OR 2)
- ⑧ AGGREGATE IN OPENINGS (CA11)
- ⑨ OPEN CELL PAVER BLOCKS (CONCRETE)
- ⑩ GRASS SEED FOR TOP SOIL
- ⑪ EDGE RESTRAINT
- ⑫ COMPACTED SOIL AT PERIMETER

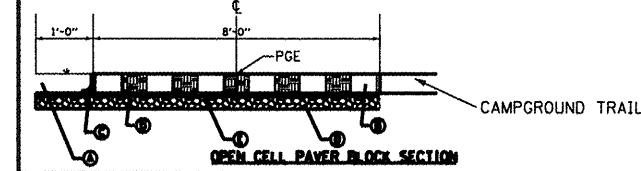

- ④ PROPOSED TOPSOIL FURNISH AND PLACE, VARIABLE DEPTH
- ⑤ OPEN CELL PAVER BLOCKS (CONCRETE)
- ⑥ PAVER BLOCK EDGE RESTRAINT
- ⑦ AGGREGATE (CA11), 6"
- ⑧ BEDDING SAND (FA 1 OR 2), 1"

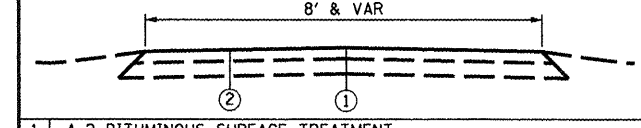

- 1 A-2 BITUMINOUS SURFACE TREATMENT
- 2 EXISTING AGGREGATE BASE WITH BITUMINOUS SURFACE TREATMENT

EARTH EXCAVATION - SPECIAL
STA. 400+16.8 LT TO STA 400+39 RT
1 CU YD

PAVER BLOCKS, SPECIAL
STA. 400+16.8 LT TO STA. 400+39 RT
256 SQ FT

V.E.C. CONTROL POINT #3
N: 5665.590
E: 5158.580
ELEV: 91.130

A-2 BITUMINOUS SURFACE TREATMENT
STA. 400+06, LT TO
STA. 403+33, LT
307 SQ. YD.

EXISTING 24" PIPE CULVERT



BASELINE STARTS AT STA. 400+00:
N: 5674.833, E: 5170.455
BASELINE ENDS AT STA. 403+43:
N: 5332.053, E: 5170.455

CAMPGROUND TRAIL

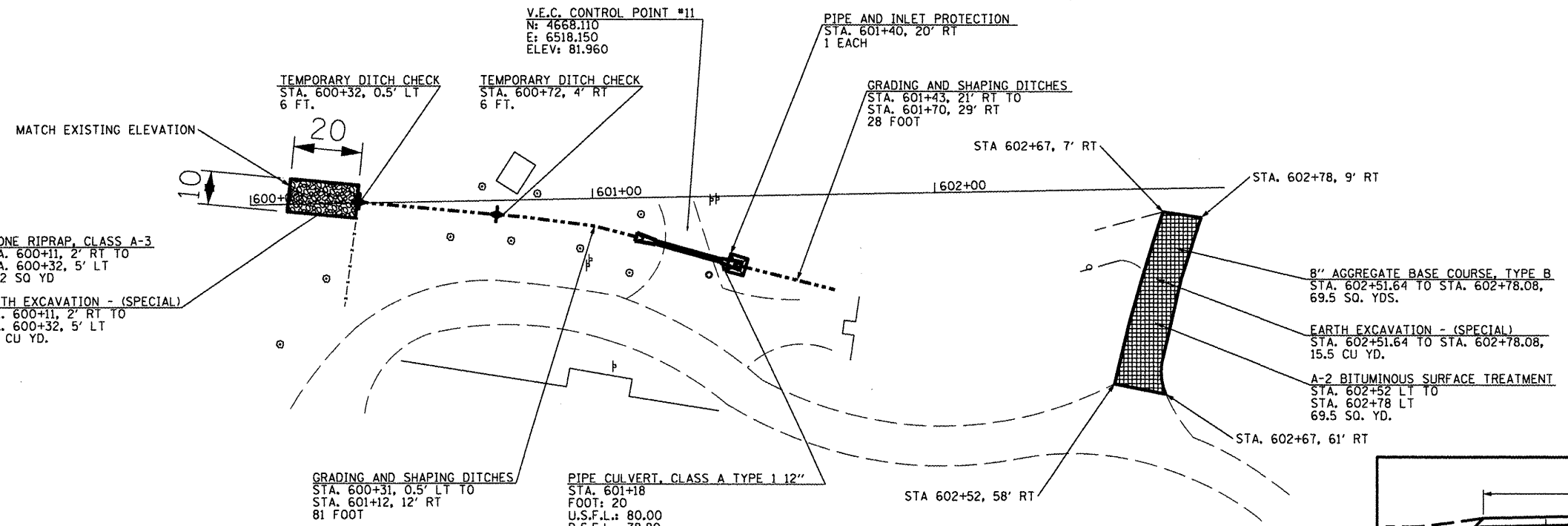

BASELINE STARTS AT STA. 600+00:
N: 4681.572, E: 6675.674
BASELINE ENDS AT STA. 602+85:
N: 4676.030, E: 6390.557

LINCOLN LEAGUE LANE

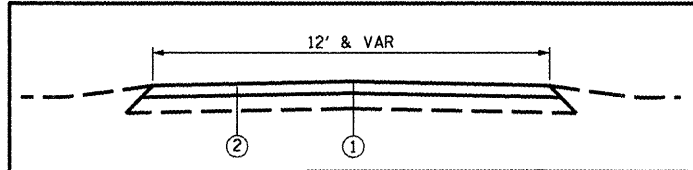

- 1 A-2 BITUMINOUS SURFACE TREATMENT
- 2 6" AGGREGATE BASE COURSE, TYPE B

FILE NAME =
#FILE#

USER NAME = #USER#

PLOT SCALE = #SCALE#

PLOT DATE = #DATE#

DESIGNED - R.M.D.

DRAWN - J.T.T.

CHECKED - R.M.D.

DATE - 4/4/2012

REVISED -

REVISED -

REVISED -

REVISED -

STATE OF ILLINOIS
DEPARTMENT OF TRANSPORTATION

LINCOLN'S NEW SALEM
CAMPGROUND TRAIL / LINCOLN LEAGUE LANE

SCALE: 1" = 20'

SHEET NO. 7 OF 9 SHEETS STATIONING VARIES

SECTION	COUNTY	TOTAL SHEETS	SHEET NO.
LINCOLN'S NEW SALEM	MEHARD	9	7
CONTRACT NO. 46234			
ILLINOIS FED. AID PROJECT			

JOB NO. 250-061-VASCONCELLES ENGINEERING CORP. DESIGN FIRM REGISTRATION NUMBER 184-002107



V.E.C. CONTROL POINT #8
 N: 5072.050
 E: 6355.130
 ELEV: 94.850

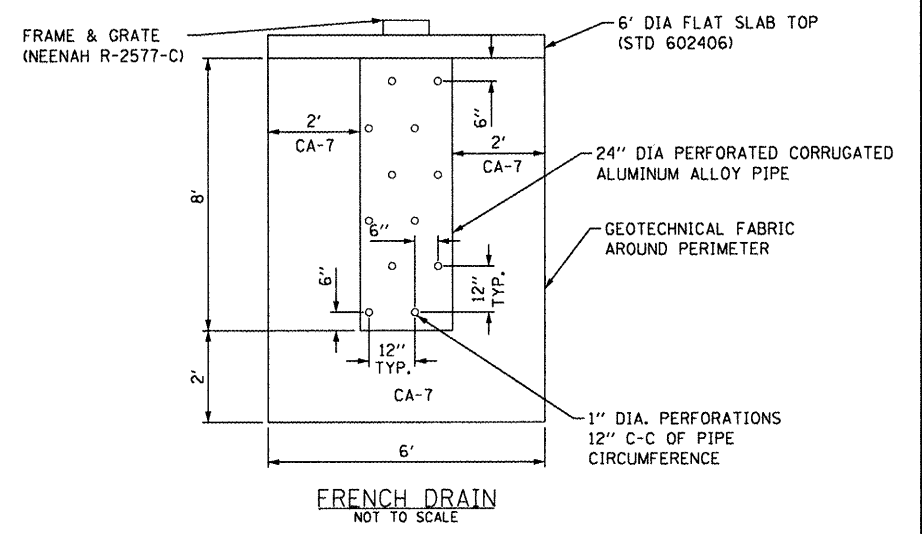
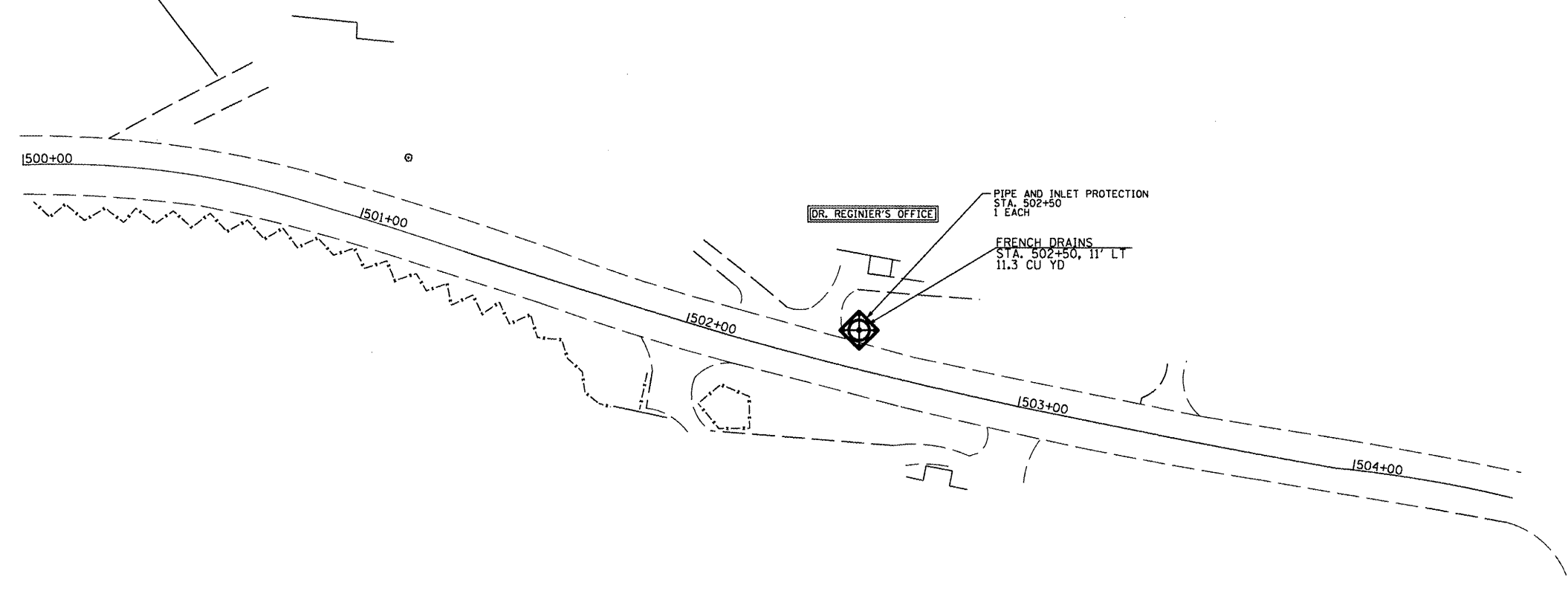

HISTORICAL VILLAGE

FILE NAME =	USER NAME = #USER#	DESIGNED - R.A.D.	REVISED -	STATE OF ILLINOIS DEPARTMENT OF TRANSPORTATION	LINCOLN'S NEW SALEM HISTORICAL VILLAGE	SCALE: 1" = 20'	SHEET NO. 8 OF 9 SHEETS	STA. 500+00 TO STA. 504+50	DATE	SECTION	COUNTY	TOTAL SHEETS	SHEET NO.
#FILE#	PLOT SCALE = #SCALE#	DRAWN - J.T.T.	REVISED -						4/4/2012	LINCOLN'S NEW SALEM	MENARD	9	8
	PLOT DATE = #DATE#	CHECKED - R.A.D.	REVISED -										
		DATE	REVISED -										
										CONTRACT NO. 46234		ILLINOIS FED. AID PROJECT	

JOB NO. 200-061-Y VASCONCELLES ENGINEERING CORP. DESIGN FIRM REGISTRATION NUMBER 184-002107

CAMPGROUND

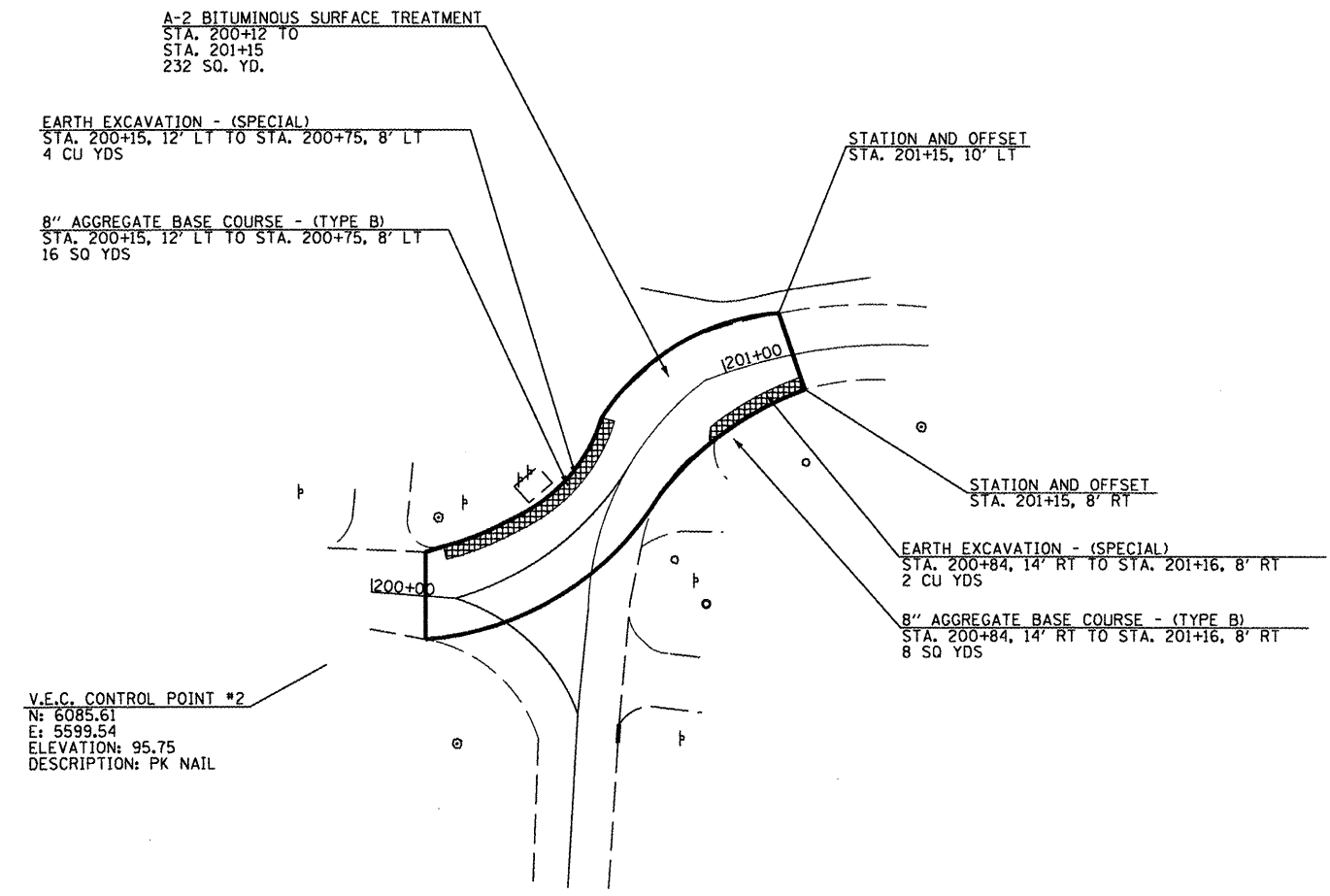

V.E.C. CONTROL POINT #2
 N: 6085.61
 E: 5599.54
 ELEVATION: 95.75
 DESCRIPTION: PK NAIL

STATION AND OFFSET
 STA. 201+15, 10' LT

STATION AND OFFSET
 STA. 201+15, 8' RT

EARTH EXCAVATION - (SPECIAL)
 STA. 200+84, 14' RT TO STA. 201+16, 8' RT
 2 CU YDS

8\"/>

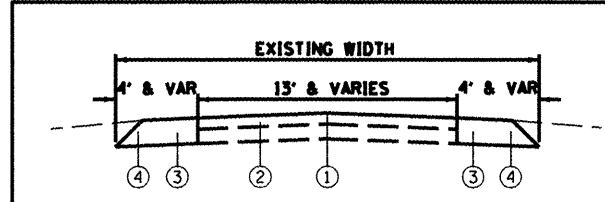

1	A-2 BITUMINOUS SURFACE TREATMENT
2	EXISTING AGGREGATE BASE W/ BIT. SURFACE TREATMENT
3	REMOVE DEGRADED MATERIAL; EARTH EXCAVATION - (SPECIAL)
4	8\"/>

- EARTH EXCAVATION - (SPECIAL)

- PAVEMENT REMOVAL

VISITOR CENTER

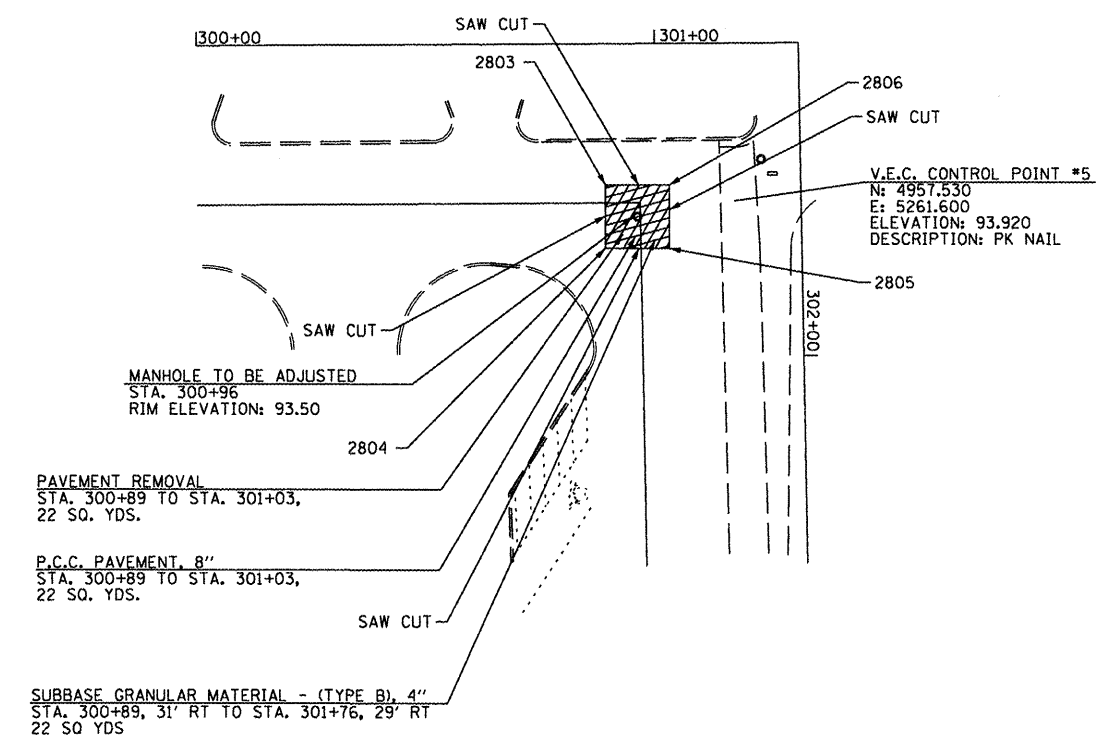

V.E.C. CONTROL POINT #5
 N: 4957.530
 E: 5261.600
 ELEVATION: 93.920
 DESCRIPTION: PK NAIL

2803	300+89.06	31.01
2806	301+62.15	28.56
2804	301+75.91	42.80
2805	301+76.15	28.80

FILE NAME =	USER NAME = #USER#	DESIGNED - R.J.D.	REVISED -
#FILE#		DRAWN - J.T.T.	REVISED -
	PLOT SCALE = #SCALE#	CHECKED - R.J.D.	REVISED -
	PLOT DATE = #DATE#	DATE - 4/4/2012	REVISED -

STATE OF ILLINOIS
 DEPARTMENT OF TRANSPORTATION

LINCOLN'S NEW SALEM
 CAMPGROUND + VISITOR CENTER
 SCALE: 1" = 20'
 SHEET NO. 9 OF 9 SHEETS STATIONING VARIES

F.A. RTE.	SECTION	COUNTY	TOTAL SHEETS	SHEET NO.
	LINCOLN'S NEW SALEM	MENARD	9	9
CONTRACT NO. 46234			ILLINOIS FED. AID PROJECT	

JOB NO. 250-061-VASCONCELLES ENGINEERING CORP. DESIGN FIRM REGISTRATION NUMBER 184-002707