

NOTES:

- TRANSITION FROM B-6.24 TO B-6.12 OR B-6.18 OVER 10'. PAID FOR AS "COMBINATION CONCRETE CURB & GUTTER, TYPE B-6.24".
- FOR STATIONS, OFFSETS, RADII, DIMENSIONS, AND TAPERS IN THE INTERSECTION OF THE ALGONQUIN BYPASS AND HUNTINGTON DRIVE, SEE SHEET NO. 331.
- ALL DRIVEWAY RADII SHALL BE 15' UNLESS OTHERWISE NOTED.

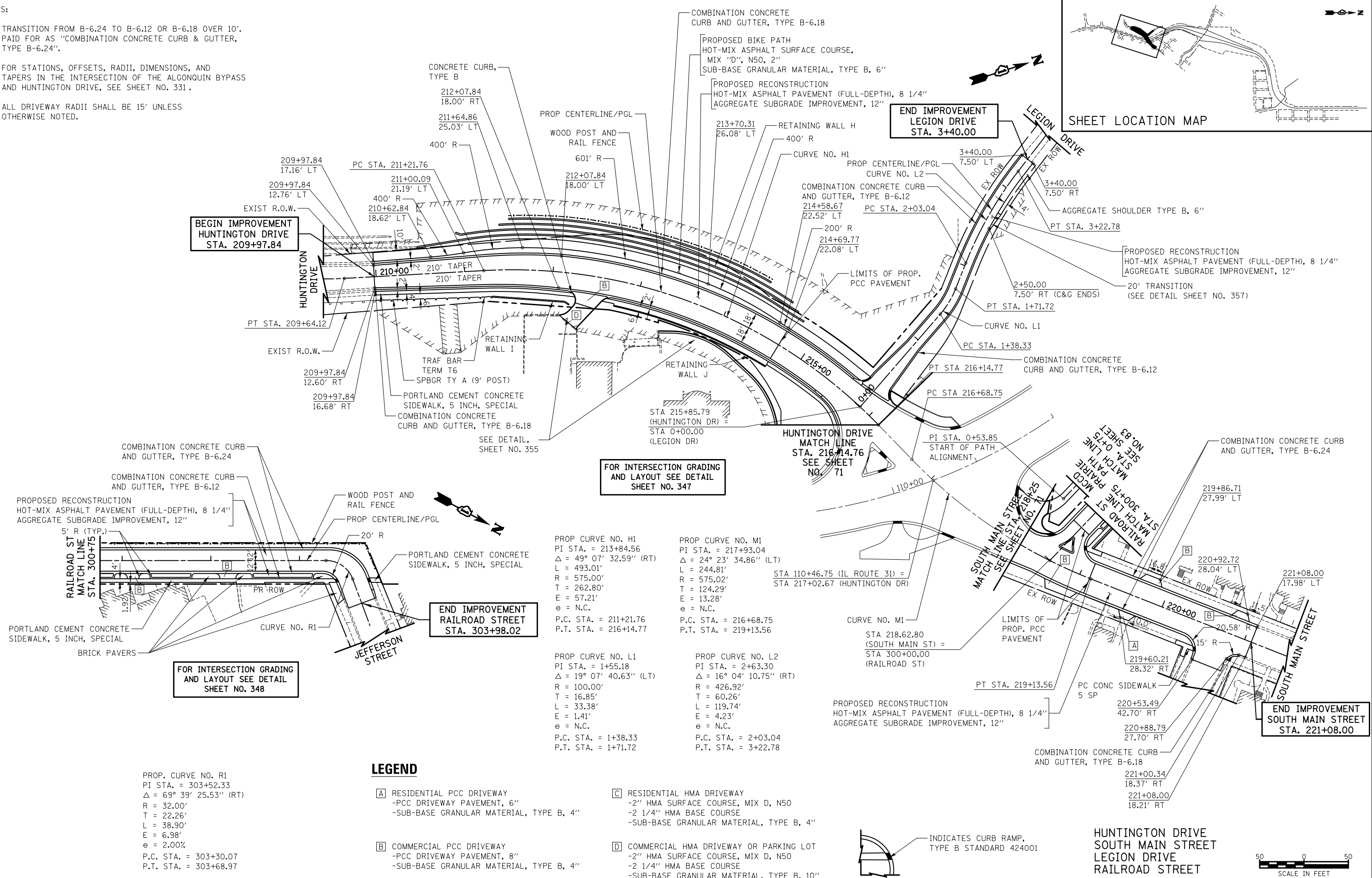
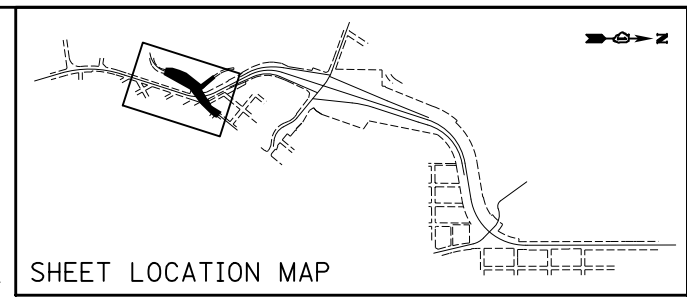

PROP. CURVE NO. R1  
 PI STA. = 303+52.33  
 $\Delta = 69^\circ 39' 25.53''$  (RT)  
 R = 32.00'  
 T = 22.26'  
 L = 38.90'  
 E = 6.98'  
 e = 2.00%  
 P.C. STA. = 303+30.07  
 P.T. STA. = 303+68.97

**LEGEND**

- [A] RESIDENTIAL PCC DRIVEWAY  
 -PCC DRIVEWAY PAVEMENT, 6"  
 -SUB-BASE GRANULAR MATERIAL, TYPE B, 4"
- [B] COMMERCIAL PCC DRIVEWAY  
 -PCC DRIVEWAY PAVEMENT, 8"  
 -SUB-BASE GRANULAR MATERIAL, TYPE B, 4"
- [C] RESIDENTIAL HMA DRIVEWAY  
 -2" HMA SURFACE COURSE, MIX D, N50  
 -2 1/4" HMA BASE COURSE  
 -SUB-BASE GRANULAR MATERIAL, TYPE B, 4"
- [D] COMMERCIAL HMA DRIVEWAY OR PARKING LOT  
 -2" HMA SURFACE COURSE, MIX D, N50  
 -2 1/4" HMA BASE COURSE  
 -SUB-BASE GRANULAR MATERIAL, TYPE B, 10"

PROP CURVE NO. H1  
 PI STA. = 213+84.56  
 $\Delta = 49^\circ 07' 32.59''$  (RT)  
 L = 493.01'  
 R = 575.00'  
 T = 262.80'  
 E = 57.21'  
 e = N.C.  
 P.C. STA. = 211+21.76  
 P.T. STA. = 216+14.77

PROP CURVE NO. M1  
 PI STA. = 217+93.04  
 $\Delta = 24^\circ 23' 34.86''$  (LT)  
 L = 244.81'  
 R = 575.02'  
 T = 124.29'  
 E = 13.28'  
 e = N.C.  
 P.C. STA. = 216+68.75  
 P.T. STA. = 219+13.56

PROP CURVE NO. L1  
 PI STA. = 1+55.18  
 $\Delta = 19^\circ 07' 40.63''$  (LT)  
 R = 100.00'  
 T = 16.85'  
 L = 33.38'  
 E = 1.41'  
 e = N.C.  
 P.C. STA. = 1+38.33  
 P.T. STA. = 1+71.72

PROP CURVE NO. L2  
 PI STA. = 2+63.30  
 $\Delta = 16^\circ 04' 10.75''$  (RT)  
 R = 426.92'  
 T = 60.26'  
 L = 119.74'  
 E = 4.23'  
 e = N.C.  
 P.C. STA. = 2+03.04  
 P.T. STA. = 3+22.78

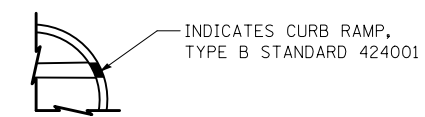

HUNTINGTON DRIVE  
 SOUTH MAIN STREET  
 LEGION DRIVE  
 RAILROAD STREET



FILE NAME = ... \D160F72-sht-pln-09.dgn	USER NAME = ctb	DESIGNED - CTB	REVISED -
		DRAWN - ARA	REVISED -
	PLOT SCALE = 100.0000' / in.	CHECKED - GAB	REVISED -
	PLOT DATE = 5/2/2012	DATE - 5/3/2012	REVISED -

STATE OF ILLINOIS  
 DEPARTMENT OF TRANSPORTATION

PLAN	
SCALE: 1" = 50'	SHEET NO. 10 OF 15 SHEETS
STA. 209+97.84 TO STA. 221+08.00	

O.R. RTE.	SECTION	COUNTY	TOTAL SHEETS	SHEET NO.
0003	18A-2	MCHENRY	825	78
CONTRACT NO. 60F72				
FED. ROAD DIST. NO. 1 ILLINOIS FED. AID PROJECT				