

- RAMP A**
- 82 STA. 158+75.00, 51.6' RT
CB TA 4 DIA T24F&G
RIM = 842.21
INV = 838.21 (N)
INV = 838.21 (S)
INV = 838.71 (4" W)
 - 83 STA. 158+75.00, 83.5' RT
PRC FLAR END SEC 12
INV = 835.75 (NW)
 - 85 STA. 156+50.00, 57.5' RT
CB TA 4 DIA T24F&G
RIM = 836.70
INV = 832.35 (NW)
INV = 832.35 (SE)
INV = 833.20 (4" W)
 - 86 STA. 156+50.00, 86.0' RT
PRC FLAR END SEC 12
INV = 832.18 (NW)
 - 88 STA. 154+00.00, 67.0' RT
CB TA 4 DIA T24F&G
RIM = 829.00
INV = 825.00 (NW)
INV = 825.00 (SE)
INV = 825.50 (4" W)
 - 89 STA. 154+00.00, 95.0' RT
PRC FLAR END SEC 12
INV = 824.40 (NW)
- RAMP A**
- 82 22'-STORM SEW CL A 1, 12" @ 11.18%
TBF=0.0 CU YD
 - 84 19'-STORM SEW CL A 1, 12" @ 0.89%
TBF=0.0 CU YD
 - 88 18'-STORM SEW CL A 1, 12" @ 3.33%
TBF=0.0 CU YD
 - U41 24'-PIPE UNDERDRAIN, 4" SP
 - 18'-PIPE UNDERDRAIN, 4"
 - U43 54'-PIPE UNDERDRAIN, 4"
 - U45 47'-PIPE UNDERDRAIN, 4"

- EXISTING STRUCTURES**
- 600 STA. 160+75.00, 117.4' RT
EXISTING MANHOLE
RIM = 840.20
 - 601 STA. 159+58.00, 118.4' RT
EXISTING END SECTION
INV = 832.90
 - 602 STA. 159+50.00, 92.4' RT
EXISTING END SECTION
INV = 835.00
 - 604 STA. 159+52.00, 132.5' LT
EXISTING END SECTION
INV = 834.00

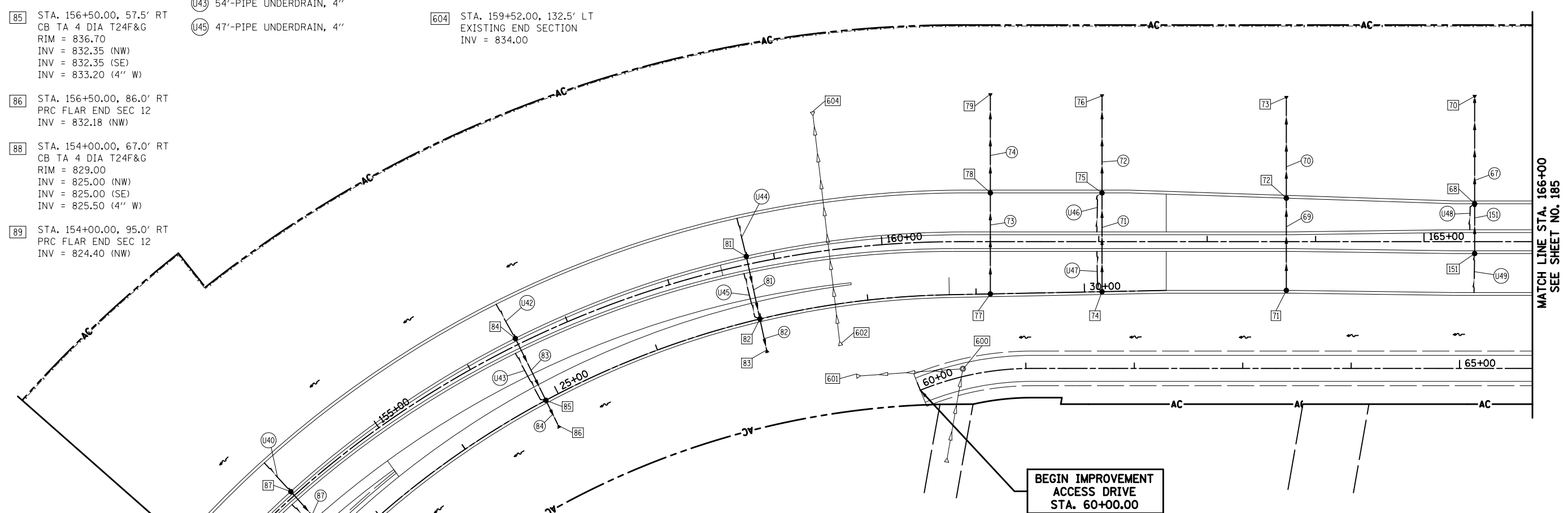

MATCH LINE STA. 153+00 SEE SHEET NO. 183

RAMP A STA. 21+50 SEE SHEET NO. 183

MATCH LINE STA. 166+00 SEE SHEET NO. 185

- | | | | | | |
|--|---|---|---|---|---|
| <p>IL RTE. 31 MAINLINE</p> <ul style="list-style-type: none"> 68 STA. 165+46.70, 35.0' LT
CB TA 4 DIA T24F&G
RIM = 856.13
INV = 851.21 (N)
INV = 851.21 (S)
INV = 852.63 (4" SW) 70 STA. 165+46.70, 134.5' LT
PRC FLAR END SEC 12
INV = 832.60 (S) 71 STA. 163+73.00, 45.0' RT
CB TC T24F&G
RIM = 852.35
INV = 849.18 (N) 72 STA. 163+73.00, 40.2' LT
CB TA 4 DIA T24F&G
RIM = 852.47
INV = 848.75 (N)
INV = 848.75 (S) | <p>IL RTE. 31 MAINLINE</p> <ul style="list-style-type: none"> 73 STA. 163+73.00, 134.5' LT
PRC FLAR END SEC 12
INV = 833.30 (S) 74 STA. 162+03.00, 46.2' RT
CB TC T24F&G
RIM = 848.92
INV = 844.92 (N)
INV = 845.42 (4" NW) 75 STA. 162+03.00, 45.0' LT
CB TA 4 DIA T24F&G
RIM = 849.70
INV = 843.70 (N)
INV = 843.70 (S)
INV = 846.20 (4" SW) 76 STA. 162+03.00, 136.0' LT
PRC FLAR END SEC 12
INV = 834.00 (S) | <p>IL RTE. 31 MAINLINE</p> <ul style="list-style-type: none"> 77 STA. 161+00.00, 48.2' RT
CB TC T24F&G
RIM = 846.60
INV = 842.72 (N) 78 STA. 161+00.00, 45.0' LT
CB TA 4 DIA T24F&G
RIM = 848.44
INV = 842.26 (N)
INV = 842.26 (S) 79 STA. 161+00.00, 137.0' LT
PRC FLAR END SEC 12
INV = 834.40 (S) 81 STA. 158+75.00, 7.6' LT
CB TC T24F&G
RIM = 843.17
INV = 839.17 (S)
INV = 839.67 (4" N) | <p>IL RTE. 31 MAINLINE</p> <ul style="list-style-type: none"> 84 STA. 156+50.00, 6.3' LT
CB TC T24F&G
RIM = 838.64
INV = 834.64 (SE)
INV = 835.14 (4" NW) 87 STA. 154+00.00, 4.9' LT
CB TC T24F&G
RIM = 831.02
INV = 826.14 (SE)
INV = 827.64 (4" NW) 151 STA. 165+46.70, 11.0' RT
CB TC T24F&G
RIM = 856.60
INV = 851.43 (N)
INV = 853.10 (4" S) | <p>IL RTE. 31 MAINLINE</p> <ul style="list-style-type: none"> 67 91'-STORM SEW CL A 2, 12" @ 20.45%
TBF=0.0 CU YD 69 86'-STORM SEW CL A 1, 12" @ 0.50%
TBF=11.4 CU YD 70 85'-STORM SEW CL A 2, 12" @ 18.18%
TBF=0.0 CU YD 71 92'-STORM SEW CL A 1, 12" @ 1.33%
TBF=19.8 CU YD 72 81'-STORM SEW CL A 2, 12" @ 11.98%
TBF=0.0 CU YD 73 92'-STORM SEW CL A 1, 12" @ 0.49%
TBF=20.2 CU YD 74 82'-STORM SEW CL A 2, 12" @ 9.59%
TBF=0.0 CU YD 81 58'-STORM SEW CL A 1, 12" @ 1.66%
TBF=7.7 CU YD 83 62'-STORM SEW CL A 1, 12" @ 3.69%
TBF=8.2 CU YD 87 70'-STORM SEW CL A 1, 12" @ 1.63%
TBF=10.6 CU YD 151 44'-STORM SEW CL A 2, 12" @ 0.50%
TBF=11.3 CU YD | <p>IL RTE. 31 MAINLINE</p> <ul style="list-style-type: none"> U40 36'-PIPE UNDERDRAIN, 4" U42 37'-PIPE UNDERDRAIN, 4" U44 37'-PIPE UNDERDRAIN, 4" U46 39'-PIPE UNDERDRAIN, 4" U47 40'-PIPE UNDERDRAIN, 4" U48 27'-PIPE UNDERDRAIN, 4" U49 36'-PIPE UNDERDRAIN, 4" |
|--|---|---|---|---|---|

- NOTES:**
- CURB STRUCTURE RIM ELEVATIONS ARE LOCATED AT THE EDGE OF PAVEMENT
 - LOCATION CALL-OFFS AND INVERT ELEVATIONS FOR END SECTIONS ARE AT THE FLARED END OF THE STRUCTURE

**ILLINOIS ROUTE 31
RAMP A**



FILE NAME = ...\\D160F72-sht-drp1n-08.dgn	USER NAME = ctb	DESIGNED - DTE	REVISED -	STATE OF ILLINOIS DEPARTMENT OF TRANSPORTATION	DRAINAGE AND UTILITIES PLAN	O.R. RTE. 0003	SECTION 18A-2	COUNTY MCHENRY	TOTAL SHEETS 825	SHEET NO. 184		
PLOT SCALE = 100.0000' / in.	CHECKED - GAB	REVISIED -	REVISIED -			SCALE: 1" = 50'	SHEET NO. 8 OF 15 SHEETS	STA. 153+00	TO STA. 166+00	CONTRACT NO. 60F72		
PLOT DATE = 5/2/2012	DATE - 5/3/2012	REVISIED -	REVISIED -			FED. ROAD DIST. NO. 1 ILLINOIS FED. AID PROJECT						