

LEGEND

- ◀ ONE-WAY CRYSTAL RAISED REFLECTIVE PAVEMENT MARKER
- ◀ ONE-WAY AMBER RAISED REFLECTIVE PAVEMENT MARKER
- ◆ TWO-WAY AMBER RAISED REFLECTIVE PAVEMENT MARKER

**BEGIN IMPROVEMENT
EDGEWOOD DRIVE
STA. 8+20.30**

**BEGIN IMPROVEMENT
ILLINOIS ROUTE 31
STA. 87+35.00**

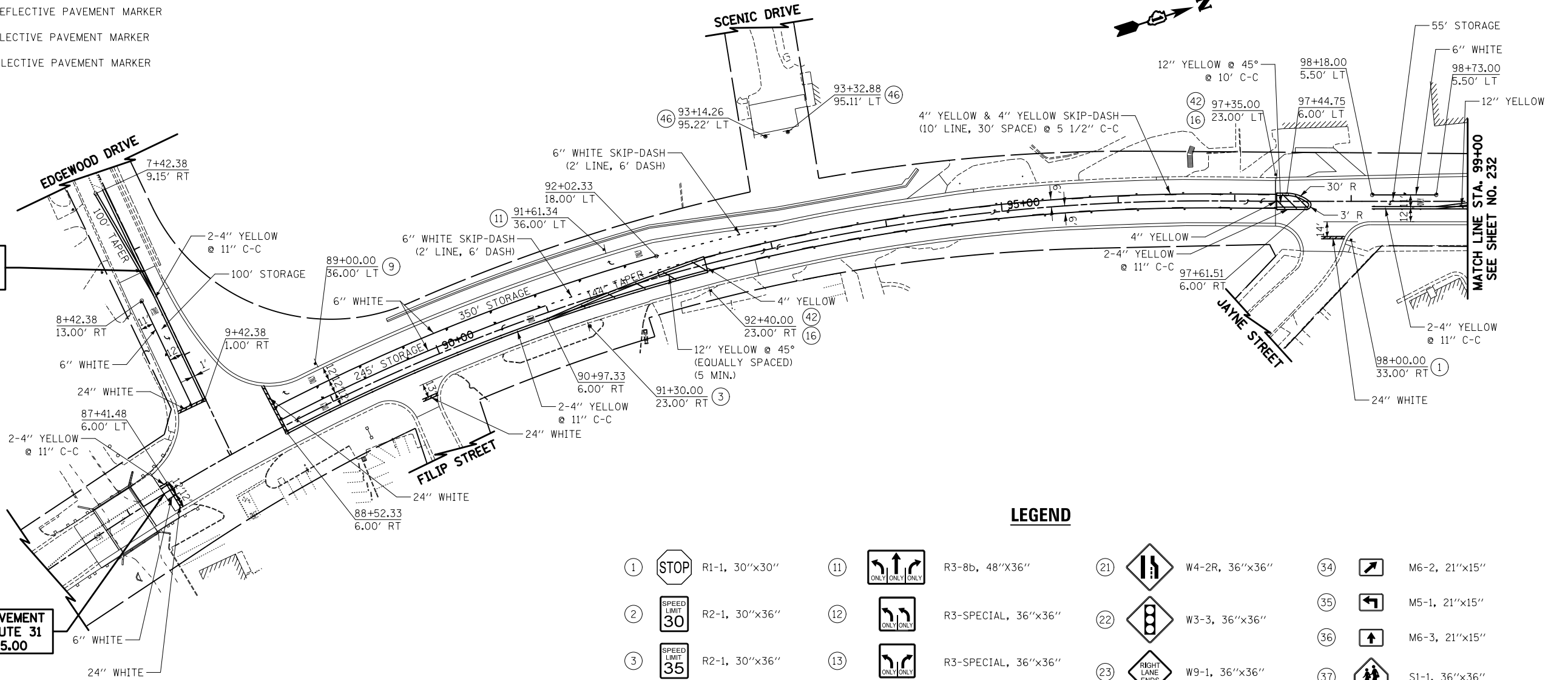

LEGEND

- | | | | | | | | | | | | |
|----|--|----------------|-----|--|---------------------|----|--|------------------|----|--|---|
| 1 | | R1-1, 30"x30" | 11 | | R3-8b, 48"x36" | 21 | | W4-2R, 36"x36" | 34 | | M6-2, 21"x15" |
| 2 | | R2-1, 30"x36" | 12 | | R3-SPECIAL, 36"x36" | 22 | | W3-3, 36"x36" | 35 | | M5-1, 21"x15" |
| 3 | | R2-1, 30"x36" | 13 | | R3-SPECIAL, 36"x36" | 23 | | W9-1, 36"x36" | 36 | | M6-3, 21"x15" |
| 4 | | R2-1, 30"x36" | 14 | | R3-SPECIAL, 48"x36" | 24 | | W13-3, 24"x30" | 37 | | S1-1, 36"x36" |
| 5 | | R2-1, 30"x36" | 15 | | R3-SPECIAL, 60"x30" | 25 | | M1-I100, 24"x24" | 38 | | R3-33, 78"x36" |
| 6 | | R5-1, 36"x36" | 16 | | R3-9b, 24"x36" | 26 | | M1-I100, 24"x24" | 39 | | M1-6, 24"x24" |
| 7 | | R3-1, 24"x24" | 17 | | R4-7, 24"x30" | 27 | | M2-1, 30"x15" | 40 | | R10-20aP, 24"x18" |
| 8 | | R3-2, 24"x24" | 18 | | W1-2R, 36"x36" | 28 | | M3-1, 24"x12" | 41 | | W18-SPECIAL, 18"x18" |
| 9 | | R3-5R, 30"x36" | 19 | | W1-5, 36"x36" | 29 | | M3-3, 24"x12" | 42 | | R3-9cP, 30"x12" |
| 10 | | R3-5L, 24"x30" | 20 | | W4-3, 36"x36" | 30 | | M3-2, 24"x12" | 43 | | R3-5bP, 30"x12" |
| | | | 20A | | R3-SPECIAL, 36"x36" | 31 | | M3-4, 24"x12" | 44 | | W16-5P, 24"x12" |
| | | | | | | 32 | | M6-1, 21"x15" | 45 | | W17-I100, VARIES x 9" (4" UPPER CASE/3" LOWER CASE) |
| | | | | | | 33 | | M6-1, 21"x15" | 46 | | OM4-3, 18"x18" |

NOTE:
 -ALL PERMANENT PAVEMENT MARKINGS ON HMA SURFACES SHALL BE THERMOPLASTIC
 -ALL PERMANENT PAVEMENT MARKINGS ON CONCRETE SURFACES SHALL BE POLYUREA, TYPE 1
 -ALL PERMANENT PAVEMENT MARKINGS ON MCCD TRAIL AND PARKING LOTS SHALL BE PAINT

**ILLINOIS ROUTE 31
EDGEWOOD DRIVE**



FILE NAME = ... \D160F72-sht-pmk-01.dgn	USER NAME = akw	DESIGNED - CTB	REVISED -
		DRAWN - CTB	REVISED -
		CHECKED - GAB	REVISED -
		DATE - 5/3/2012	REVISED -

**STATE OF ILLINOIS
DEPARTMENT OF TRANSPORTATION**

PAVEMENT MARKING PLAN

SCALE: 1" = 50' SHEET NO. 1 OF 14 SHEETS STA. 87+35 TO STA. 99+00

O.R. RTE. 0003	SECTION 18A-2	COUNTY MCHENRY	TOTAL SHEETS 825	SHEET NO. 231
CONTRACT NO. 60F72				
FED. ROAD DIST. NO. 1 ILLINOIS FED. AID PROJECT				