

TRAFFIC SIGNAL NOTES

1. INSTALL A NEW CONTROLLER AND TYPE IV CABINET ON THE EXISTING TYPE "D" FOUNDATION. THE FOUNDATION SHALL BE MODIFIED TO ACCOMMODATE INSTALLATION OF THE UNINTERRUPTIBLE POWER SUPPLY.
2. EXISTING INTERSECTION CONDUITS USED IN THE PERMANENT SIGNAL INSTALLATION SHALL BE RODDED AND CLEANED PRIOR TO INSTALLATION OF NEW SIGNAL CABLES.
3. REPLACEMENT OF THE EXISTING CONFIRMATION BEACONS WITH NEW L.E.D. CONFIRMATION BEACONS SHALL BE INCLUDED IN THE PAY ITEM "UNINTERRUPTABLE POWER SUPPLY, SPECIAL".

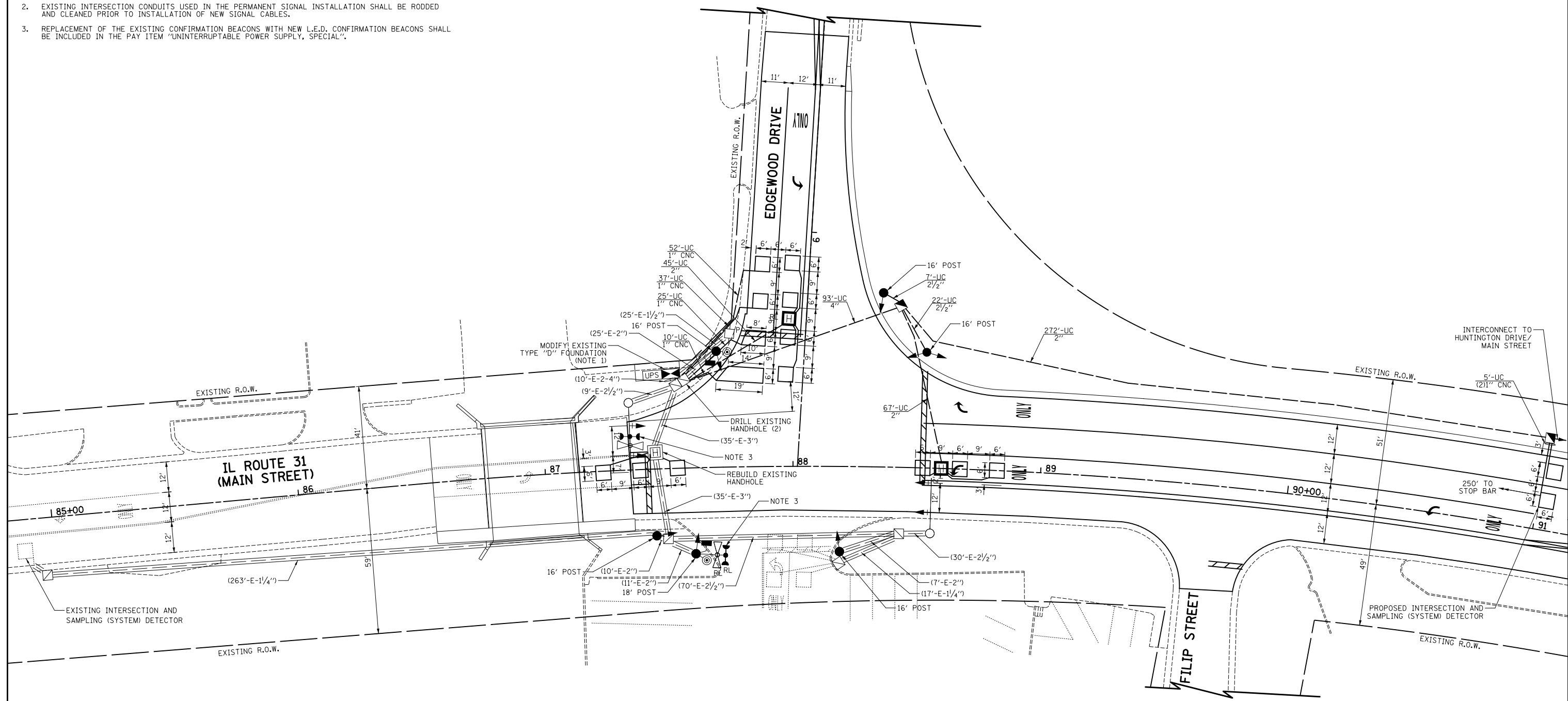

NOTE:
THE TRAFFIC SIGNAL CONTROLLER EQUIPMENT FOR THIS PROJECT SHALL BE "ECONOLITE" TO MATCH THE EXISTING ADJACENT SYSTEM.

FILE NAME = ...\\D160F72-sht-ts-03.dgn	USER NAME = akw	DESIGNED - BRD	REVISED -
		DRAWN - OJT	REVISED -
		CHECKED - JJE	REVISED -
		DATE - 5/3/2012	REVISED -

**STATE OF ILLINOIS
DEPARTMENT OF TRANSPORTATION**

**TRAFFIC SIGNAL MODIFICATION PLAN
IL ROUTE 31 (MAIN ST.) AT EDGEWOOD DRIVE**

SCALE: 1"=20' SHEET NO. 1 OF 1 SHEETS STA. TO STA.

O.R. RTE.	SECTION	COUNTY	TOTAL SHEETS	SHEET NO.
0003	18A-2	MCHENRY	825	265
CONTRACT NO. 60F72				
FED. ROAD DIST. NO. 1 ILLINOIS FED. AID PROJECT				