

I:\2154\cad\sheet\Roadway\20-Structures & Walls\02-SN 056-008\0560081-60F72-12-APS_r_v2.dgn
 10:52:52 AM 5/21/2012

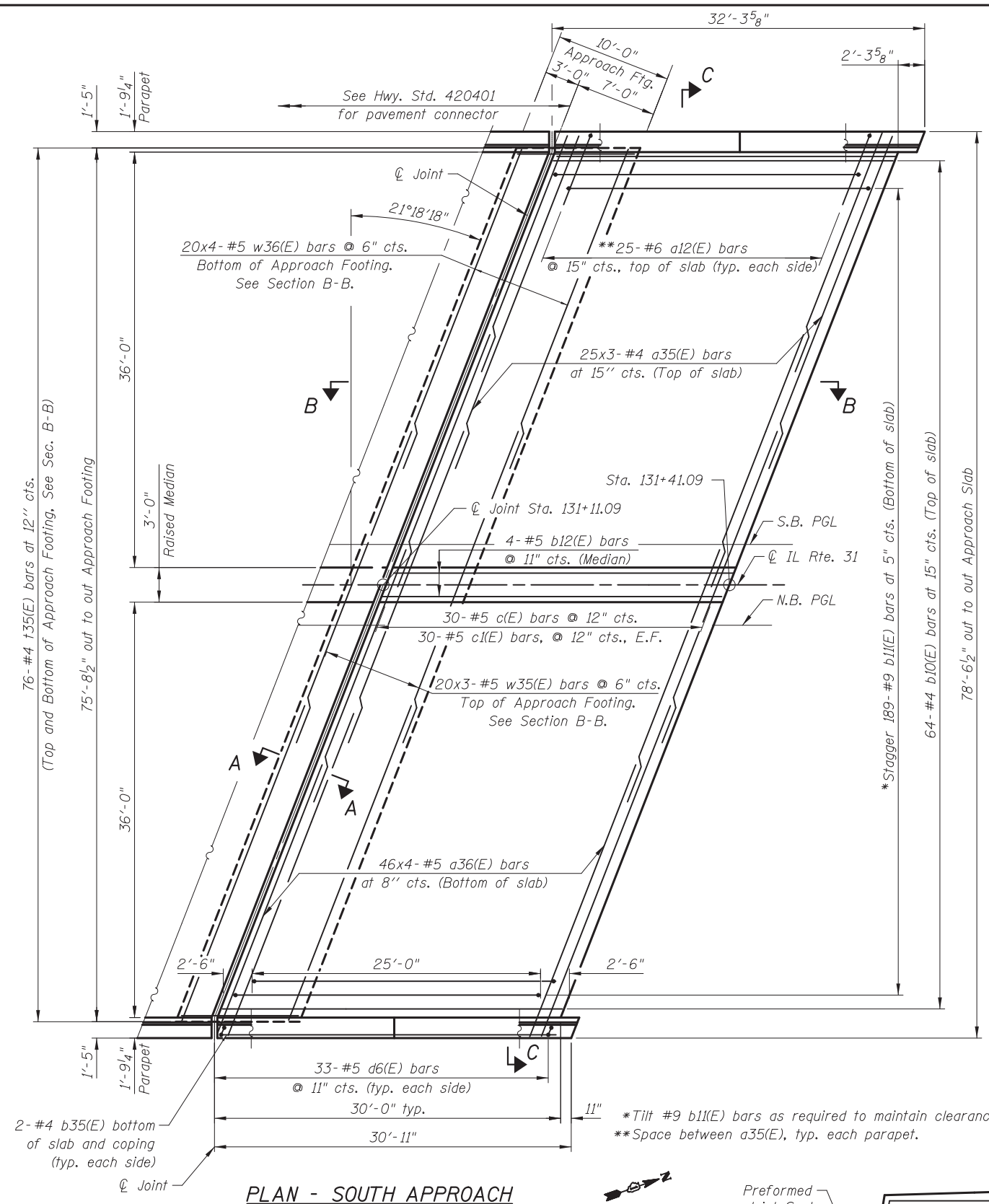

PLAN - SOUTH APPROACH

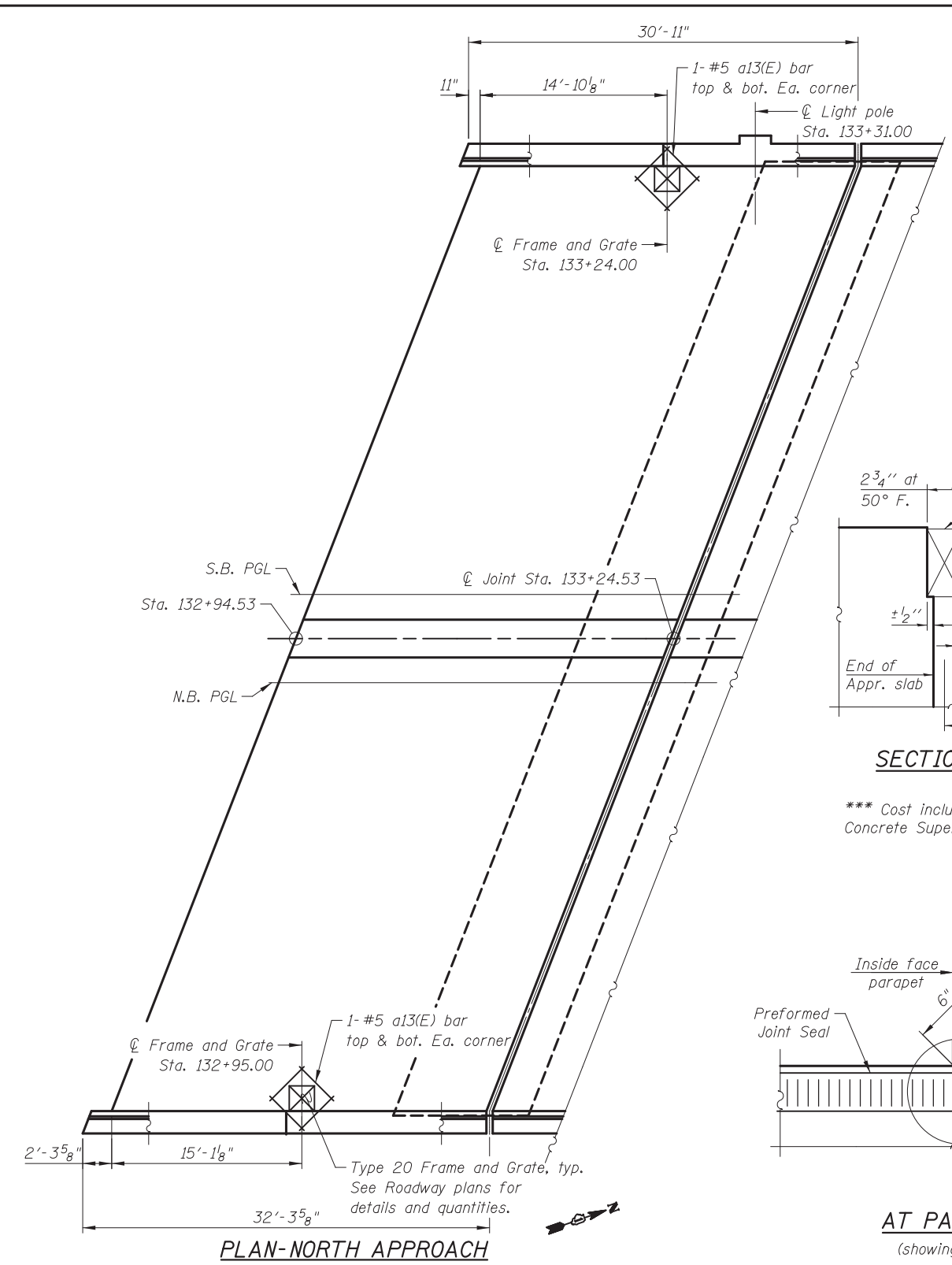

PLAN-NORTH APPROACH

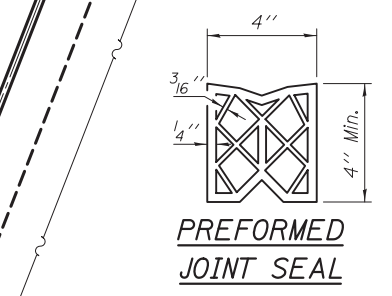

PREFORMED JOINT SEAL

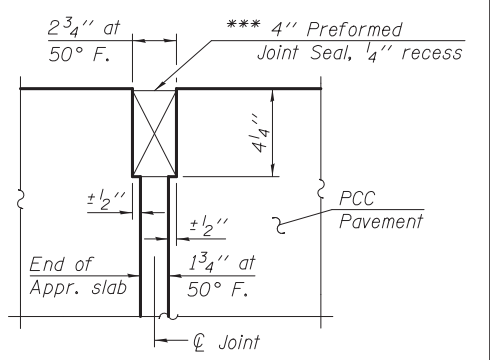

SECTION A-A

*** Cost included with Concrete Superstructures

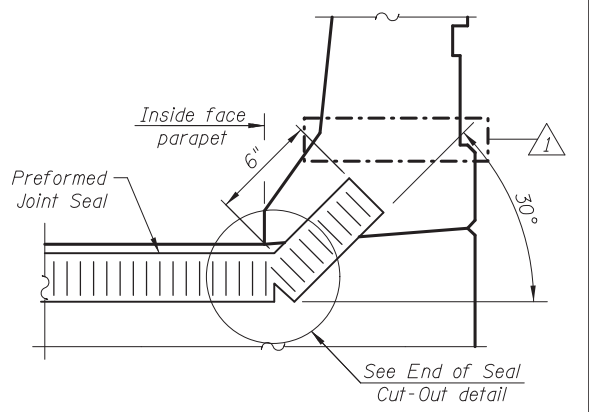

AT PARAPET (showing seal)

MINIMUM BAR LAP
 (Approach Slab)
 #4 bar = 2'-7"
 #5 bar = 3'-3"

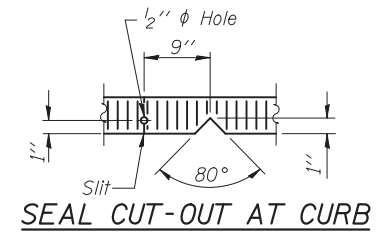

SEAL CUT-OUT AT CURB

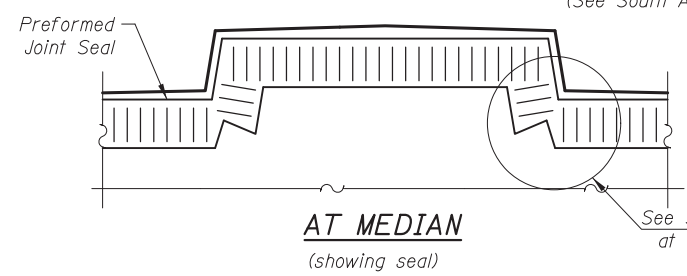

AT MEDIAN (showing seal)

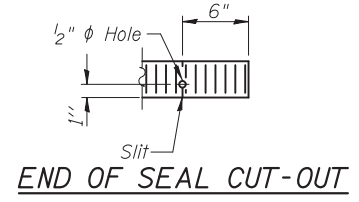

END OF SEAL CUT-OUT

Notes:
 See sheet SB13 for Sections B-B and C-C.
 See sheet SB13 for Bill of Material, Schedule of Reinforcement, and Bar Diagrams.
 a35(E), a36(E), c(E) and c1(E) bar spacings measured along ϕ of roadway.
 Order a35(E), a36(E), b10(E) and b11(E) bars full length, cut in field to fit drainage structures.