

**PLAN**

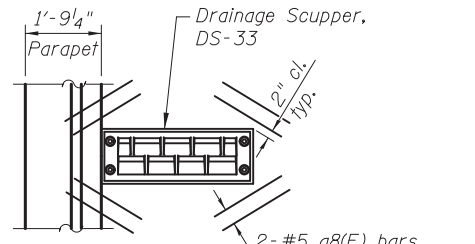

**DETAIL "A"**

\*Order a75(E) bars full length. Cut to fit skew and use remainder of bars in opposite end.

**MINIMUM BAR LAP**  
(Deck)  
#5 bar = 3'-3"

**Notes:**  
See Sheet SD9 for Bill of Materials, Bar Diagrams and Reinforcement Schedule.  
Bars indicated thus 12 x 2-#5 etc. indicates 12 lines of bars with 2 lengths per line.  
See sheet SD8 for Section A-A.  
See sheet SD8 for Section Thru Parapet and for parapet reinforcement.  
See sheet SD16 for Drainage Scupper DS-33 details.

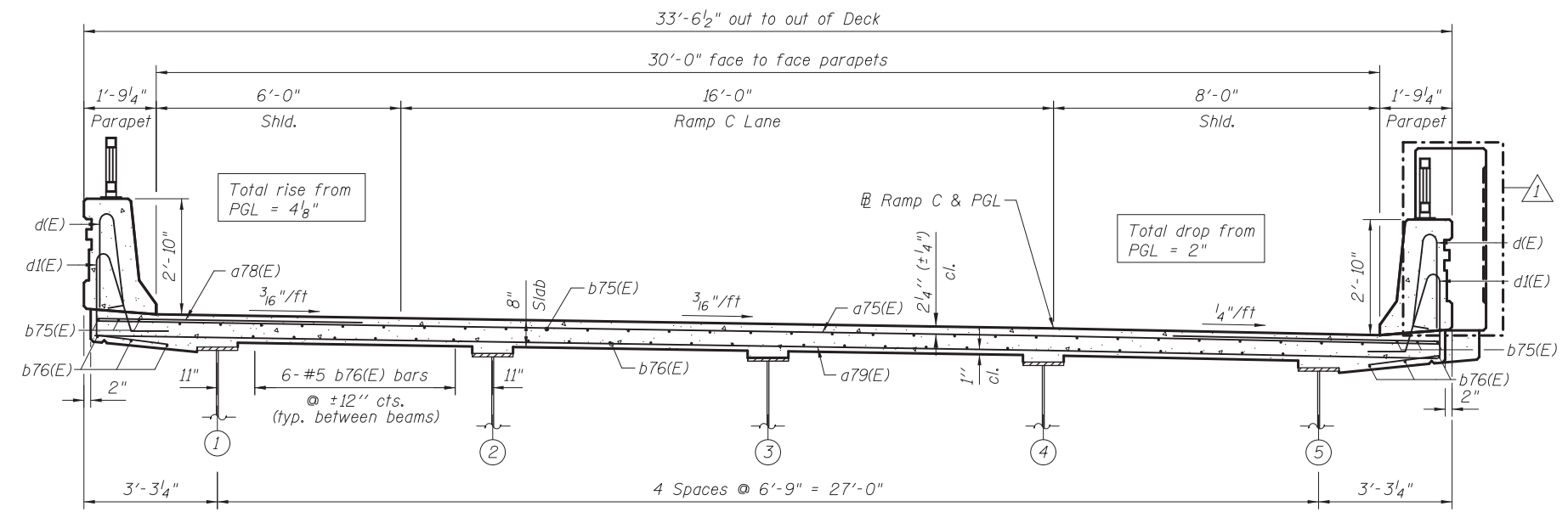

**CROSS SECTION**  
(Looking South)

5/21/2012 11:46:12 AM I:\2154\cad\sheet\Roadway\20-Structures & Walls\05-SN\_056-0080\0560080-60F72-07-SS\_rev2.dgn

**CIVILTECH**  
450 E Devon Ave, Suite 300  
Itasca, Illinois 60143  
Tel: 630.773.3900 Fax: 630.773.3975  
www.civiltechinc.com

DRAWN	- M. LANGE	REVISED	- 5/3/12 K.L.B.
DESIGNED	- D. ATKINS	REVISED	-
CHECKED	- G. HATLESTAD	REVISED	-
DATE	- 5/3/2012	REVISED	-

**STATE OF ILLINOIS**  
**DEPARTMENT OF TRANSPORTATION**

**SUPERSTRUCTURE**  
**SB ENTR. RAMP (RAMP C) OVER CRYSTAL CREEK**  
**STRUCTURE NO. 056-0080**

O.R. RTE.	SECTION	COUNTY	TOTAL SHEETS	SHEET NO.
0003	18A-2	MCHENRY	825	561
CONTRACT NO. 60F72				
ILLINOIS FED. AID PROJECT				

SHEET NO. SD7 OF SD30 SHEETS