

Bench Mark: Control Point CP43, Mag. Hill set, SB IL Rte. 31 Bypass Entrance Ramp (Ramp C), Sta. 10+30.54, Offset 94.55' Rt., Elev. 820.0

Existing Structure: None

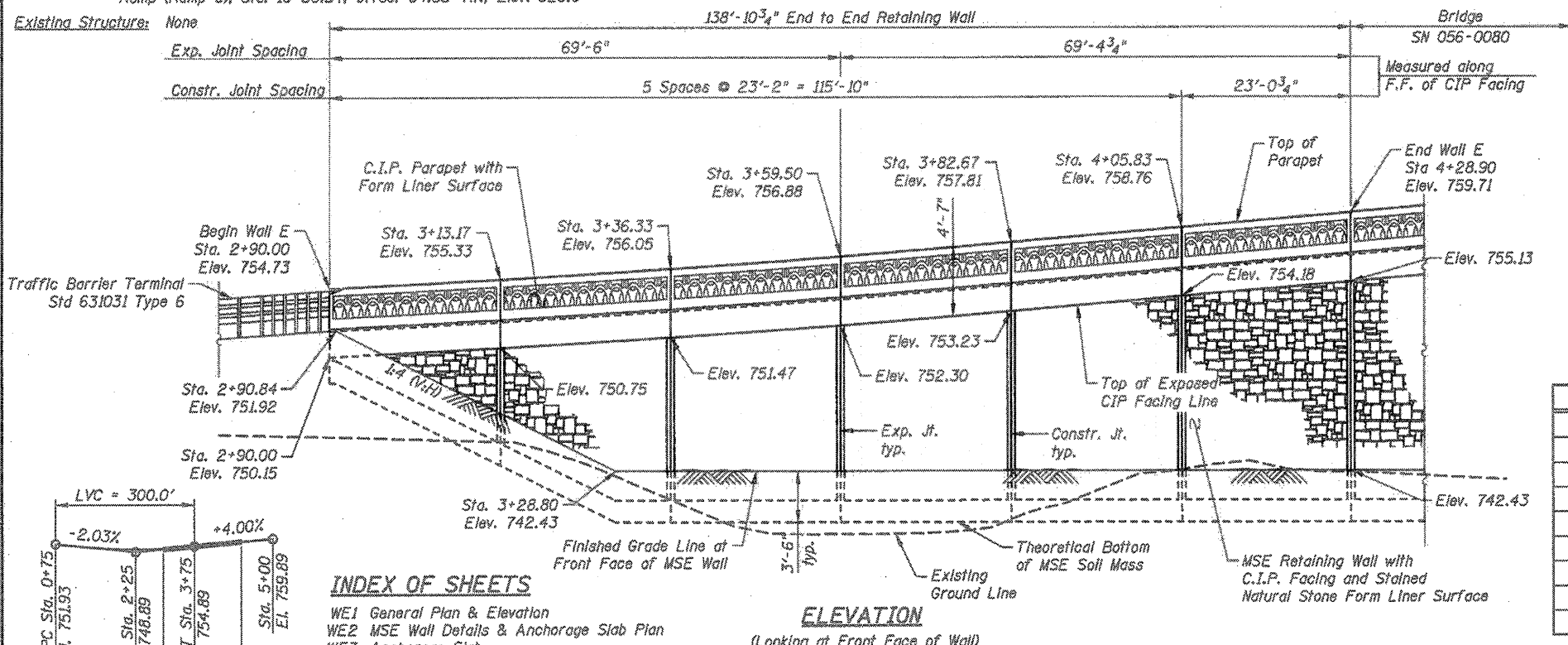

**INDEX OF SHEETS**

- WE1 General Plan & Elevation
- WE2 MSE Wall Details & Anchorage Slab Plan
- WE3 Anchorage Slab
- WE4 Anchorage Slab Details
- WE5 Architectural Details
- WE6 Boring Logs I
- WE7 Boring Logs II

**ELEVATION**

(Looking at Front Face of Wall)

- Settlement Platforms
- Sta. 3+25, 4-ft. Right
- Sta. 4+00, 4-ft. Right

Settlement Platforms shall be erected in accordance with Article 204.06 except that the platforms shall be placed at the bottom of the MSE soil mass. Cost shall be included in the cost of Mechanically Stabilized Earth Retaining Wall.

**GENERAL NOTES**

1. Reinforcement bars designated (E) shall be epoxy coated.
2. Neither the MSE wall cast-in-place concrete facing, anchorage slab & parapet, nor roadway pavement shall be constructed until after the roadway embankment and reinforced select fill have been in place for 4 months, after which time less than 1 inch of the total anticipated settlement of 6 1/2 inches is assumed to remain, without the prior approval of the Engineer. The settlement period may be shortened at the discretion of the Engineer if the monitoring data indicates a lesser than predicted settlement.

**APPROVED**  
For Structural Adequacy Only  
*Gregory J. Hatlestad*  
Engineer of Bridges & Structures

**TOTAL BILL OF MATERIAL**

ITEM	UNIT	TOTAL
Structure Excavation	Cu. Yd.	107
Concrete Superstructure	Cu. Yd.	84.0
Form Liner Textured Surface	Sq. Ft.	1,414
Protective Coat	Sq. Yd.	188
Reinforcement Bars, Epoxy Coated	Pound	11,150
Geocomposite Wall Drain	Sq. Yd.	18
Mechanically Stabilized Earth Retaining Walls	Sq. Ft.	1,686
Staining Concrete Structures	Sq. Yd.	157
Form Liner Textured Surface, Special	Sq. Ft.	200

CIVILTECH ENGINEERING, INC.  
GREGORY J. HATLESTAD, S.E.



*Gregory J. Hatlestad*  
GREGORY J. HATLESTAD, S.E.  
# 081-002562  
EXP 11/30/12  
DATE 3/15/12

**DESIGN SPECIFICATIONS**  
2002 AASHTO Standard Specification for Highway Bridges, 17th Ed.

**DESIGN STRESSES**  
FIELD UNITS

f'c = 3,500 psi  
fy = 60,000 psi (Reinforcement)

**PROPOSED PROFILE**  
SB ENTR. RAMP C

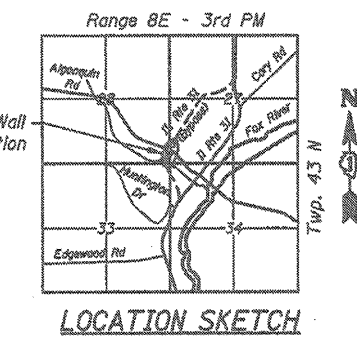
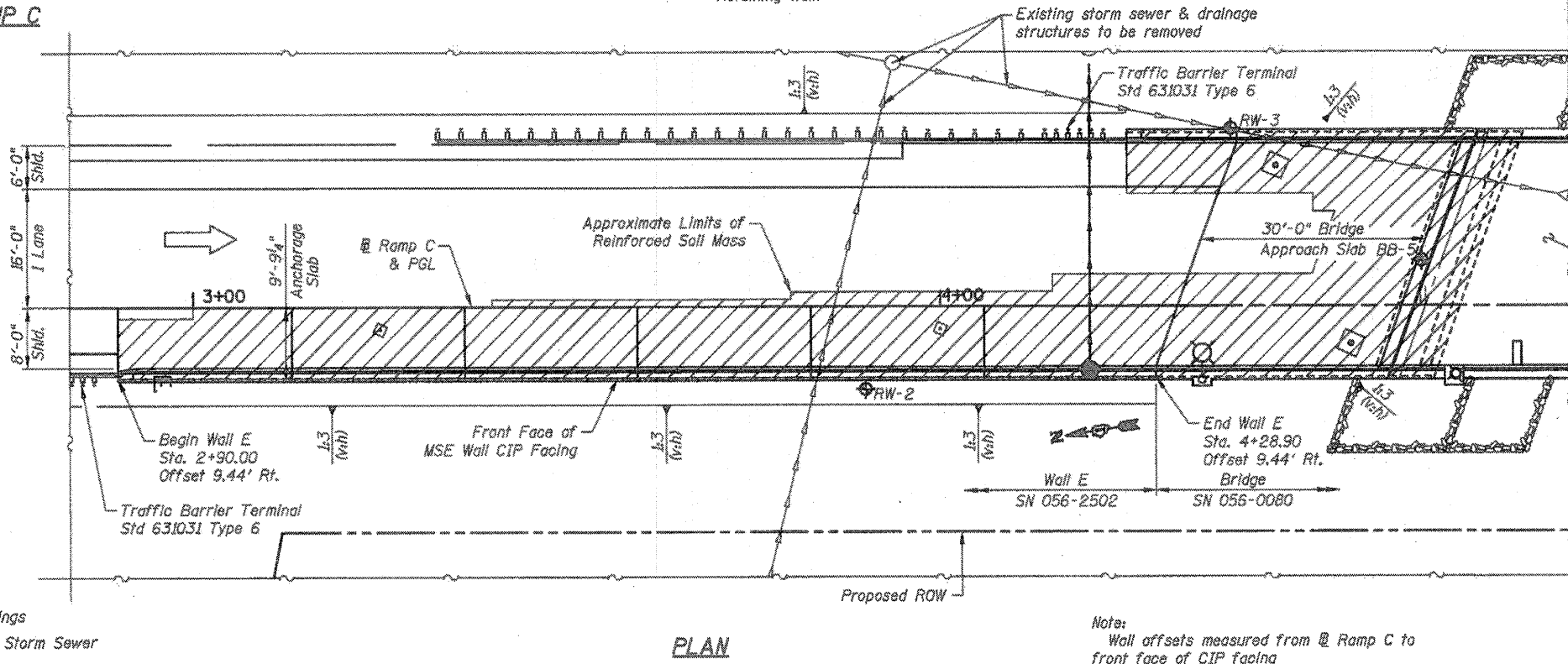
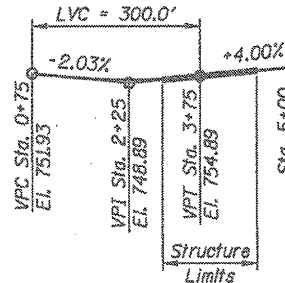

**GENERAL PLAN & ELEVATION**  
WALL E; F.A.P. 339 SB ENTR. RAMP C  
SECTION 18A-2, McHENRY COUNTY  
STA. 2+90 TO STA. 4+28.90  
STRUCTURE NO. 056-2502

- LEGEND**
- ◆ Soil Borings
  - Existing Storm Sewer

Note: Wall offsets measured from @ Ramp C to front face of CIP facing

3/15/2012 3:02:23 PM J:\25\Roadway\Roadway\20-Structures & Retain\10-Reg E\0562502-0072-QI-01.dgn

**CIVILTECH**  
450 E Devon Ave, Suite 300  
Itasca, Illinois 60143  
Tel: 830.773.3900 Fax: 830.773.3975  
www.civiltechinc.com

DRAWN - C. BRABAND  
DESIGNED - D. ATKINS  
CHECKED - G. HATLESTAD  
DATE - 3/23/2012

**STATE OF ILLINOIS**  
**DEPARTMENT OF TRANSPORTATION**

**GENERAL PLAN & ELEVATION**  
**WALL E; RAMP C**  
**STRUCTURE NO. 056-2502**  
SHEET NO. WE1 OF WE7 SHEETS

D.R. RTE.	SECTION	COUNTY	TOTAL SHEETS	SHEET NO.
0003	18A-2	MCHEMRY	825	613

CONTRACT NO. 60F72  
ILLINOIS FED. AID PROJECT