

FINL	SURVEYED	BY	DATE
SURVEY	PLOTTED		
NOTE BOOK	TEMPLATE		
NO.	AREAS CHECKED		

ORIGINAL	SURVEYED	BY	DATE
SURVEY	PLOTTED		
NOTE BOOK	TEMPLATE		
NO.	AREAS CHECKED		

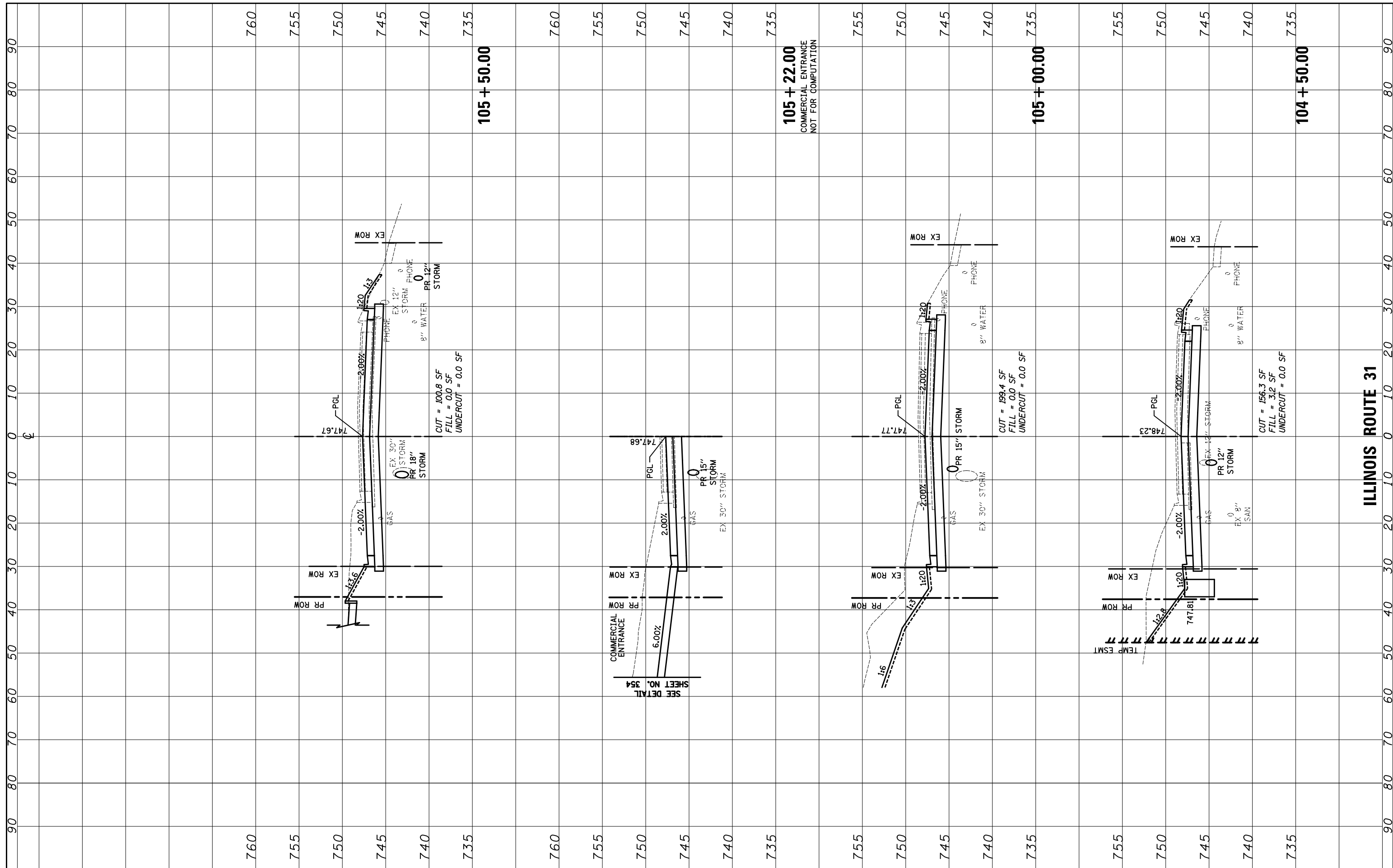

FILE NAME = ...\\D160F72-sht-xxsh-t-01.Bypass_South.dgn

USER NAME = akw	DESIGNED - PML	REVISED -
PLOT SCALE = 20.0000' / in.	DRAWN - PML	REVISED -
PLOT DATE = 5/2/2012	CHECKED - GAB	REVISED -
	DATE - 5/3/2012	REVISED -

**STATE OF ILLINOIS
DEPARTMENT OF TRANSPORTATION**

CROSS SECTIONS

SCALE: 10'H: 5'V SHEET NO. 12 OF 64 SHEETS STA. 104+50.00 TO STA. 105+50.00

O.R. RTE.	SECTION	COUNTY	TOTAL SHEETS	SHEET NO.
0003	18A-2	MCHENRY	825	691
CONTRACT NO. 60F72				
FED. ROAD DIST. NO. 1 ILLINOIS FED. AID PROJECT				

ILLINOIS ROUTE 31