

FINAL SURVEY NO.	SURVEYED PLOTTED	BY	DATE
NOTE BOOK NO.	TEMPLATE AREAS CHECKED		

ORIGINAL SURVEY NO.	SURVEYED PLOTTED	BY	DATE
NOTE BOOK NO.	TEMPLATE AREAS CHECKED		

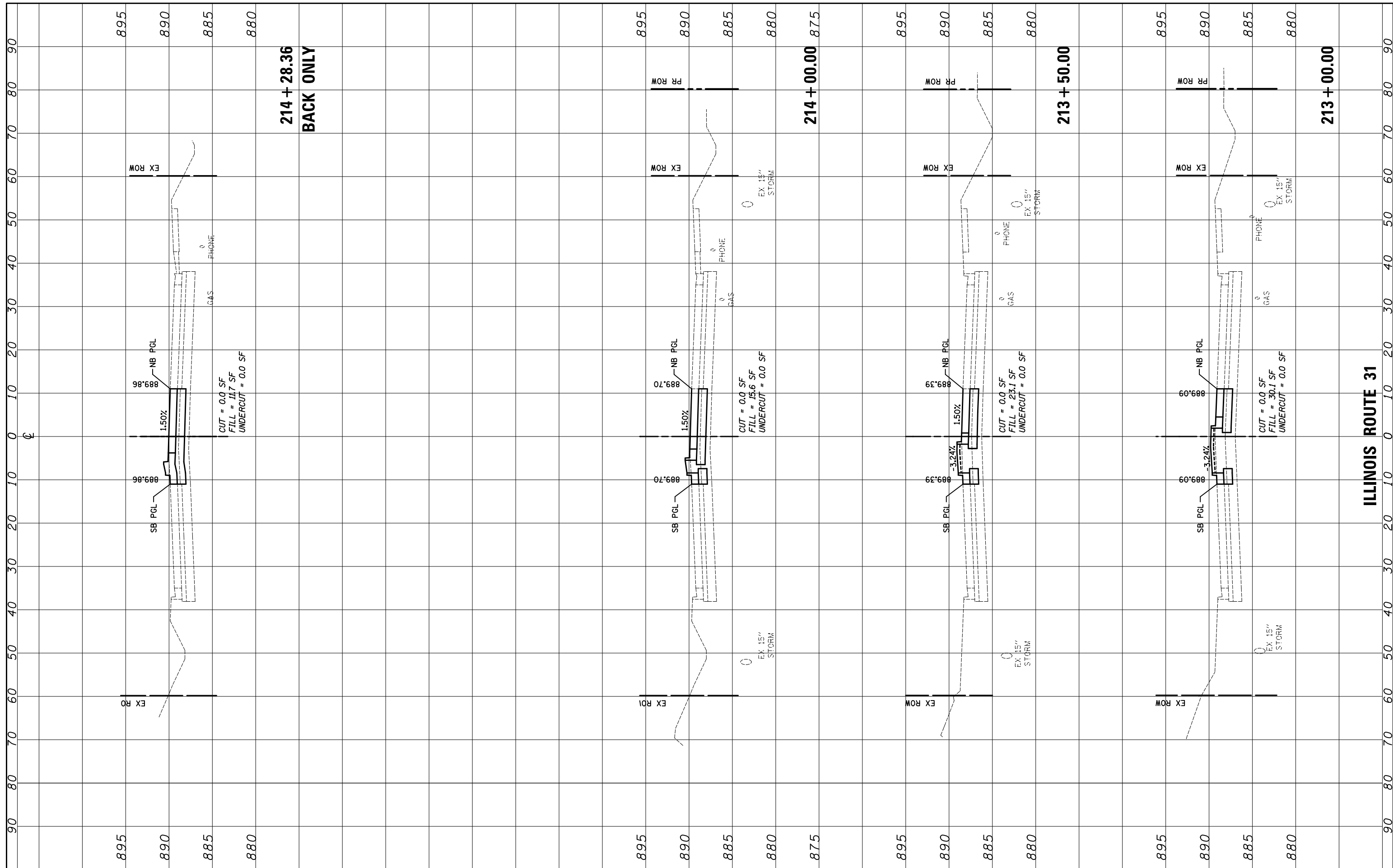

FILE NAME = ...\\D160F72-sht-xssht-03.Bypass-Nor.th.dgn

USER NAME = akw
 DESIGNED - PML
 DRAWN - PML
 CHECKED - GAB
 DATE - 5/3/2012

REVISED -
 REVISED -
 REVISED -
 REVISED -

**STATE OF ILLINOIS
 DEPARTMENT OF TRANSPORTATION**

CROSS SECTIONS

SCALE: 10'H: 5'V SHEET NO. 64 OF 64 SHEETS STA. 213+00.00 TO STA. 214+29.00

O.R. RTE.	SECTION	COUNTY	TOTAL SHEETS	SHEET NO.
0003	18A-2	MCHENRY	825	743
CONTRACT NO. 60F72				
FED. ROAD DIST. NO. 1 ILLINOIS FED. AID PROJECT				

ILLINOIS ROUTE 31