

SECTION A-A

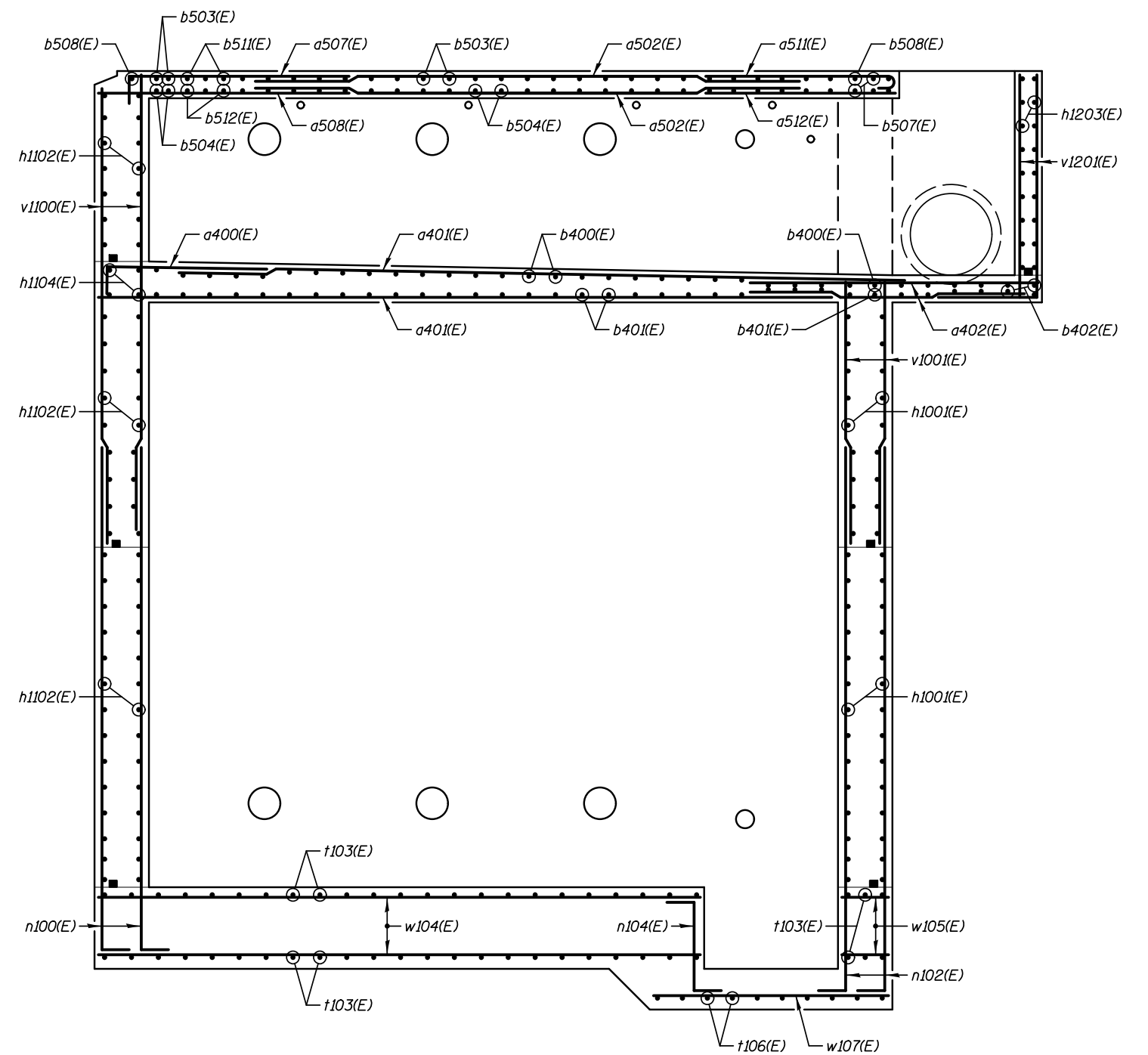

SECTION B-B

KNIGHT
Engineers & Architects

DESIGNED - WPM	REVISIONS
CHECKED - TB	REVISIONS
DRAWN - TB	REVISIONS
CHECKED - WPM	REVISIONS
SCALE - NONE	
DATE - 3/22/2012	

**STATE OF ILLINOIS
DEPARTMENT OF TRANSPORTATION**

**REINFORCEMENT DETAILS - SECTIONS
PUMP STATION 47**

SHEET NO. SA-19 OF 34 SHEETS

F.A.P. RTE.	SECTION	COUNTY	TOTAL SHEETS	SHEET NO.
338/IL 59	2011-035-I	DUPAGE	181	94
CONTRACT NO. 60P41				
ILLINOIS FED. AID PROJECT				