

1 DRY WELL SECTION ELEVATION LOOKING NORTH
SCALE: 1/4" = 1'-0"

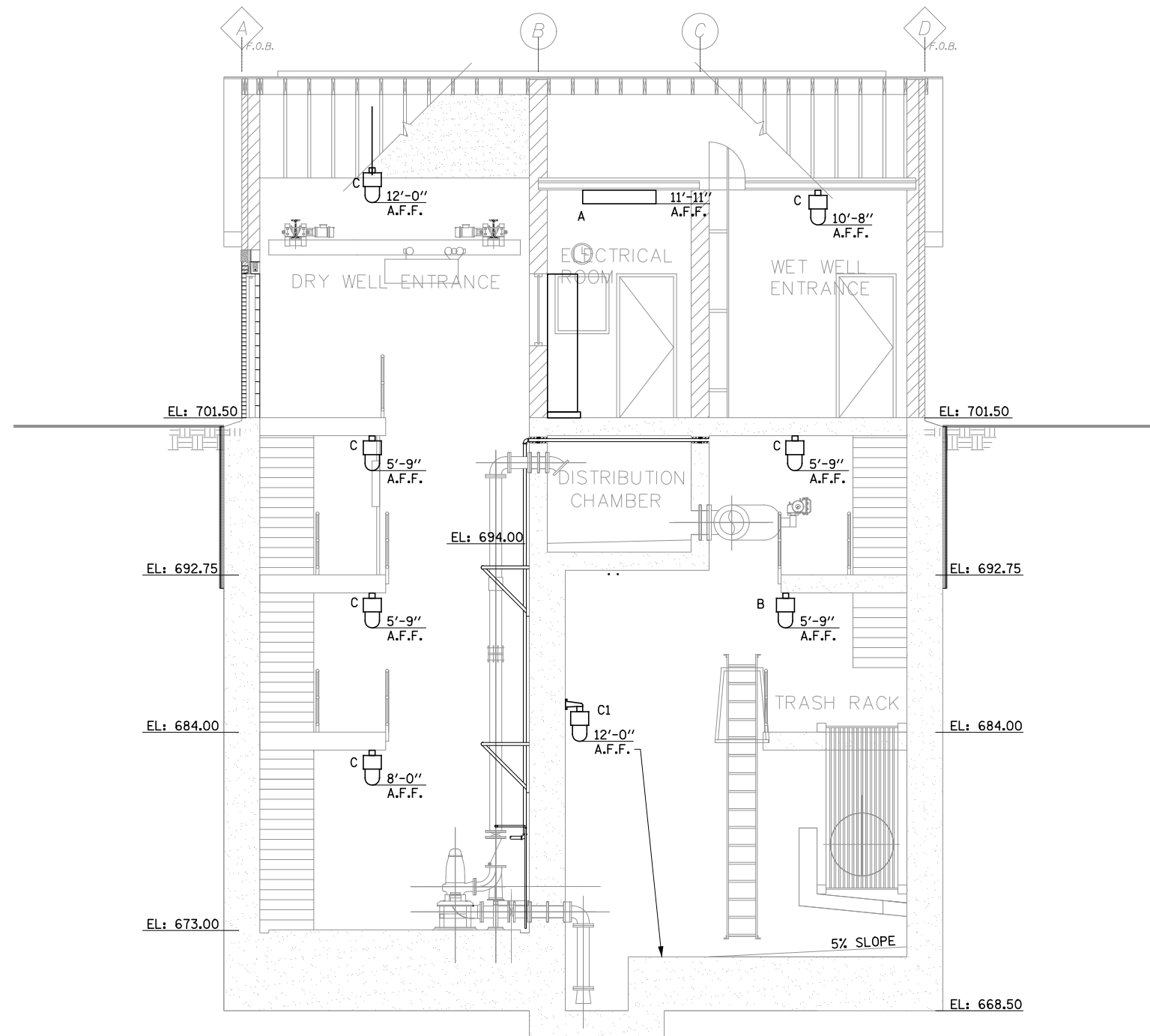

2 PUMP STATION SECTION ELEVATION LOOKING WEST
SCALE: 1/4" = 1'-0"

- NOTES:**
- FOR DETAILS OF CONDUIT AND CABLE RUNS FROM MCC LP-47 TO LIGHT FIXTURES, SEE SHEETS E7 AND E7A.
 - SEE SHT. E11 FOR LIGHTING PANEL SCHEDULE AND LIGHTING FIXTURE SCHEDULE.
 - ELECTRICAL INSTALLATION AND EQUIPMENT WITHIN ENTIRE WET AND DRY WELL AREA SHALL BE PER N.E.C. CLASS 1 DIV. 2.

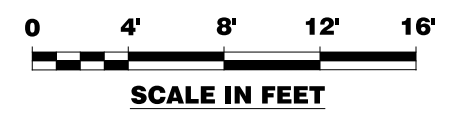

E7B

KNIGHT Engineers & Architects	USER NAME = *USER*	DESIGNED - MCP	REVISED -	STATE OF ILLINOIS DEPARTMENT OF TRANSPORTATION	PUMP STATION NO. 47 LIGHTING ELEVATION PLANS			F.A.P. RTE.	SECTION	COUNTY	TOTAL SHEETS	SHEET NO.
	PLOT SCALE = *SCALE*	DRAWN - MLB	REVISED -					338/IL 59	2011-035-I	DUPAGE	181	169
PLOT DATE = *DATE*	CHECKED - MCP	REVISED -	REVISED -				CONTRACT NO. 60P41		ILLINOIS FED. AID PROJECT			
	DATE 03-22-2012	REVISED -	REVISED -	SCALE:	SHEET NO.	OF SHEETS	STA.	TO STA.				