

NOTE:

SEE ILLINOIS ROUTE 59 SHEETS
FOR ALIGNMENT & TIE DATA

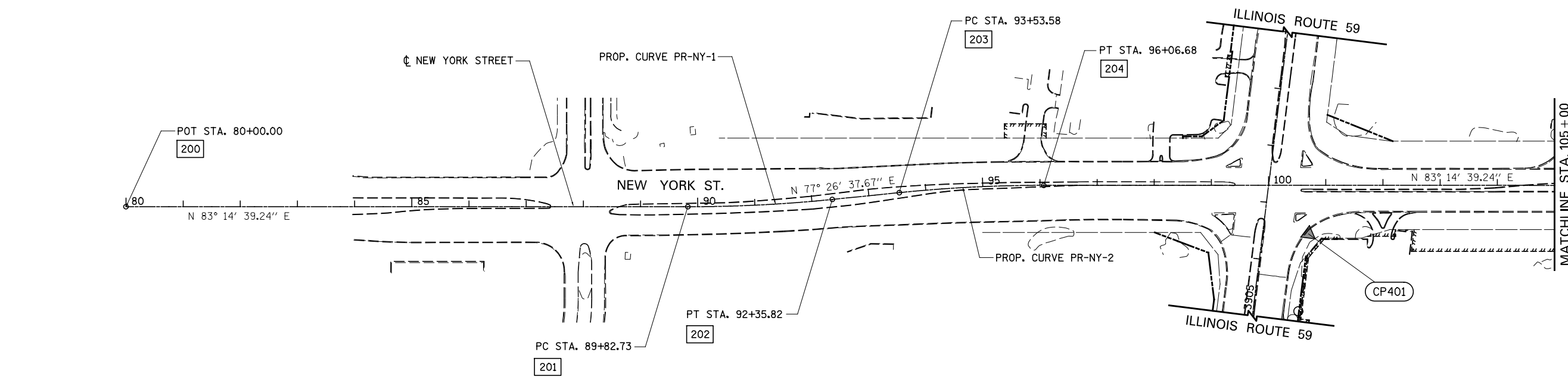

PROP. CURVE PR-NY-1
 PI STA. = 91+09.39
 $\Delta = 5^\circ 48' 02''$ (LT)
 $D = 2^\circ 17' 31''$
 $R = 2,500.00'$
 $T = 126.65'$
 $L = 253.09'$
 $E = 3.21'$
 P.C. STA. = 89+82.73
 P.T. STA. = 92+35.82

PROP. CURVE PR-NY-2
 PI STA. = 94+80.24
 $\Delta = 5^\circ 48' 02''$ (RT)
 $D = 2^\circ 17' 31''$
 $R = 2,500.00'$
 $T = 126.65'$
 $L = 253.09'$
 $E = 3.21'$
 P.C. STA. = 93+53.58
 P.T. STA. = 96+06.68

ALIGNMENT DATA

200	N 855853.79	E 17081.85
201	N 855969.40	E 18057.75
202	N 856011.83	E 18307.15
203	N 856037.43	E 18422.10
204	N 856079.87	E 18671.50
205	N 856361.41	E 21048.20

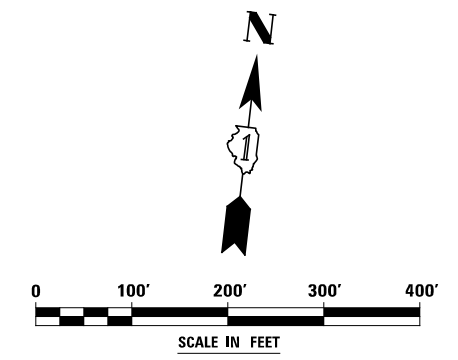
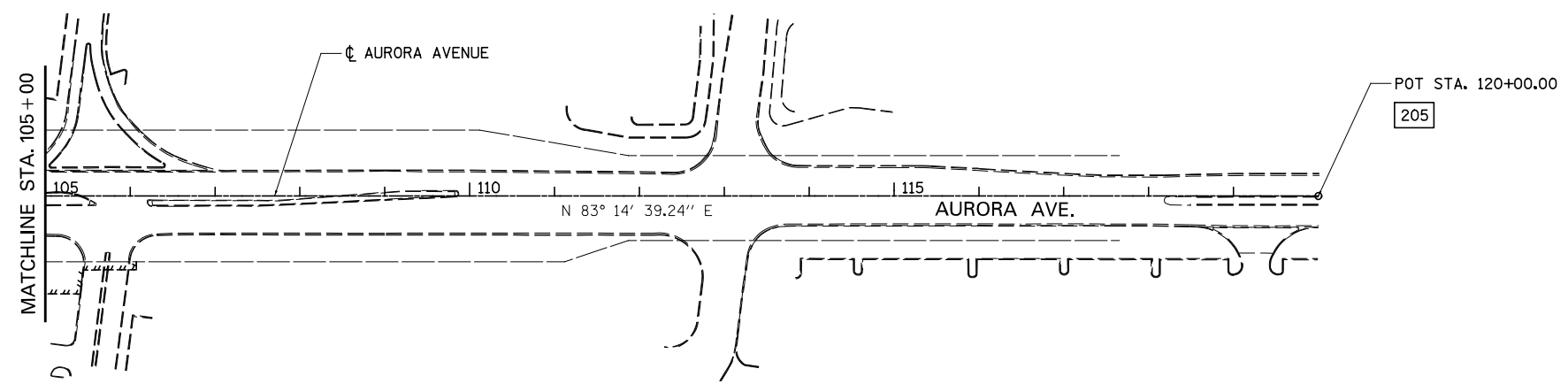

FILE NAME =	USER NAME = *USER*	DESIGNED <i>CEO</i>	REVISED	STATE OF ILLINOIS DEPARTMENT OF TRANSPORTATION	ALIGNMENT, TIES, AND BENCHMARKS	F.A.P. RTE.	SECTION	COUNTY	TOTAL SHEETS	SHEET NO.	
*FILE#		DRAWN <i>KES</i>	REVISED -			338	2011-037-DTR	DUPAGE	138	13	
PLOT SCALE = *SCALE*		CHECKED <i>PJO</i>	REVISED -			CONTRACT NO. 60P43					
PLOT DATE = *DATE*		DATE <i>03-22-2012</i>	REVISED -			ILLINOIS FED. AID PROJECT					
					SCALE: AS SHOWN	SHEET NO. 5 OF 14 SHEETS	STA. 80+00	TO STA. 120+00			