

THE TRAFFIC SIGNAL CONTROL EQUIPMENT FOR THIS SIGNAL SHALL BE "ECONOLITE" TO MATCH THE EXISTING ADJACENT SYSTEM.

LEFT ON GREEN ARROW ONLY
R10-5
24"x30"

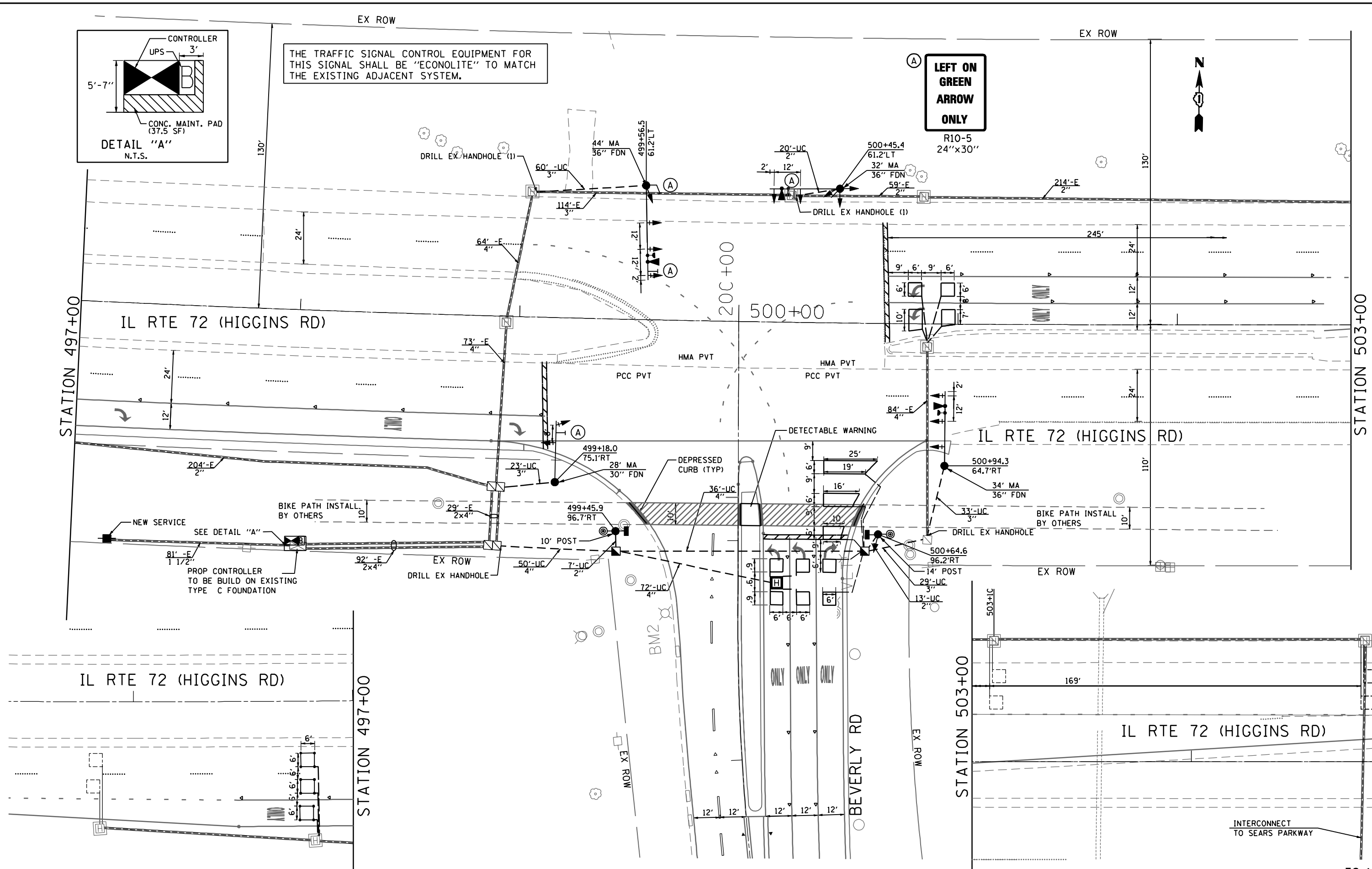

FILE NAME : p:\2009\me09066-var-var-ph1\cadd\1038-IL72-Beverly\Shvs\DI68P90-sht-03TS11-Beverly.dgn
 USER : JLN
 MILLENNIA PROFESSIONAL SERVICES

200 22ND Street, Suite 216, Lombard, IL 60148
 630.705.0110 voice, 630.839.2566 fax
 www.mps-ill.com
MILLENNIA PROFESSIONAL SERVICES

DESIGNED -	CJD	REVISED -	
DRAWN -	CJD	REVISED -	
CHECKED -	TVN	REVISED -	
DATE -	4/5/2012	REVISED -	

STATE OF ILLINOIS
DEPARTMENT OF TRANSPORTATION

IL ROUTE 72 AT BEVERLY ROAD
TRAFFIC SIGNAL INSTALLATION PLAN

SCALE: 1"=20' SHEET NO. 1 OF 1 SHEETS STA. TO STA.

F.A.P. RTE.	SECTION	COUNTY	TOTAL SHEETS	SHEET NO.
341	2011-071-N	COOK/KANE	56	27
CONTRACT NO. 60P90				

TS-11

FED. ROAD DIST. NO. 1 ILLINOIS FED. AID PROJECT