

THERMOPLASTIC PAVEMENT MARKING
 A: CROSSWALK LINES (PEDESTRIAN) 2 @ 6" SOLID WHITE (TYP.)
 B: 6' LONGITUDINAL BARS (SCHOOL) 12" SOLID WHITE @ 2' INTERVALS (TYP.)

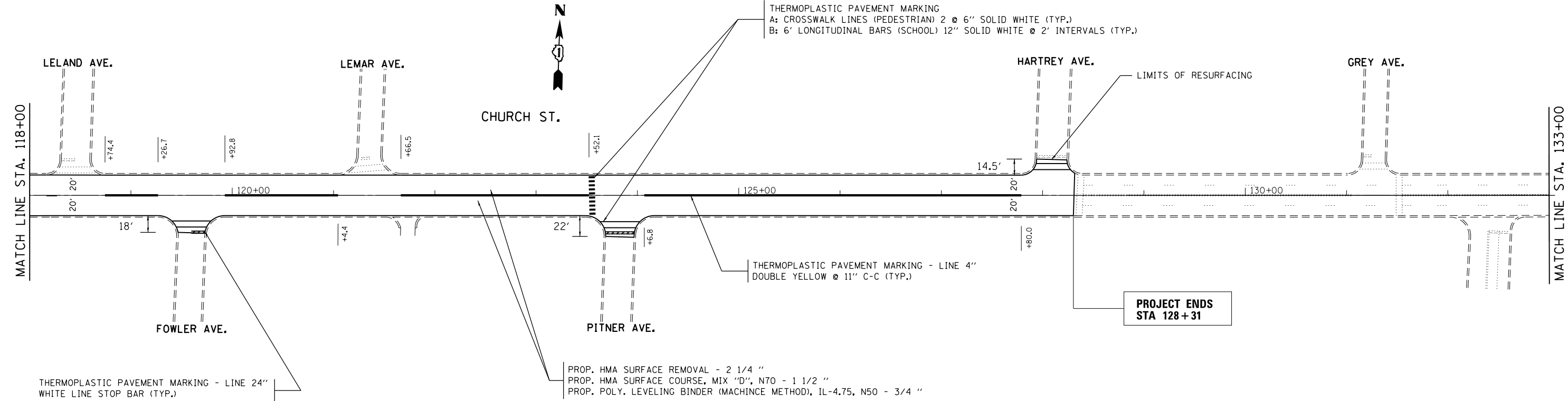

PROP. HMA SURFACE REMOVAL - 2 1/4 "
 PROP. HMA SURFACE COURSE, MIX "D", N70 - 1 1/2 "
 PROP. POLY. LEVELING BINDER (MACHINE METHOD), IL-4.75, N50 - 3/4 "

THERMOPLASTIC PAVEMENT MARKING - LINE 24"
 WHITE LINE STOP BAR (TYP.)

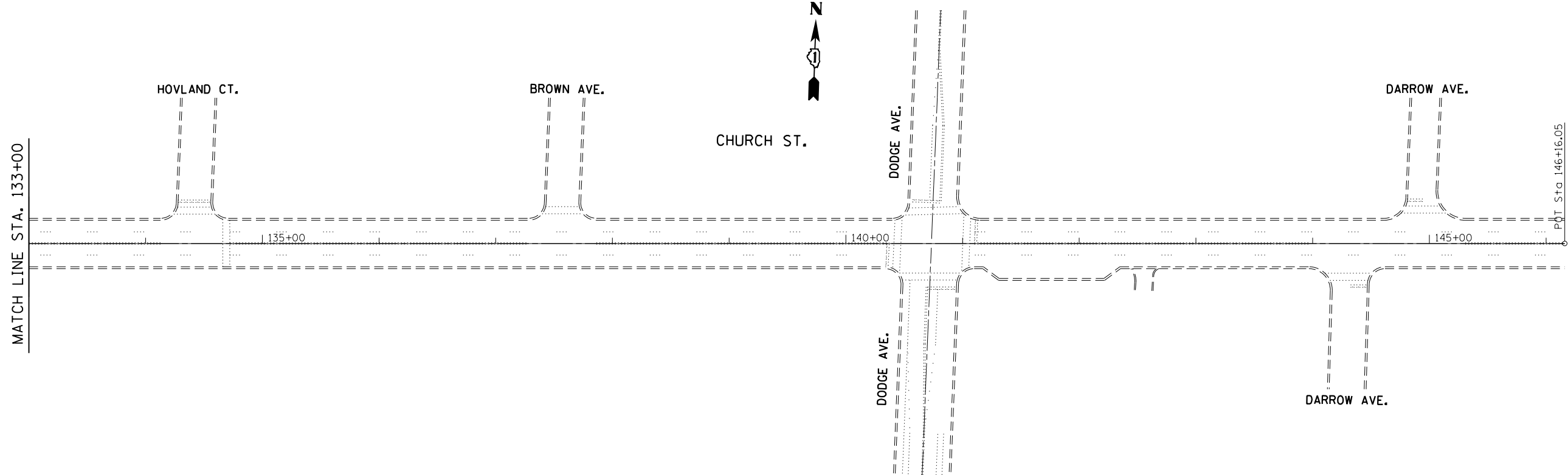

FILE NAME =	USER NAME = rodriguezma	DESIGNED -	REVISED -
ei:\pwork\pwidot\rodriguezma\d0293791\127312-sht-plan.dgn		DRAWN -	REVISED -
	PLOT SCALE = 100.0000' / in.	CHECKED -	REVISED -
	PLOT DATE = 4/5/2012	DATE -	REVISED -

**STATE OF ILLINOIS
 DEPARTMENT OF TRANSPORTATION**

**CHURCH ST. (GROSS POINT RD. TO DODGE AVE.)
 ROADWAY AND PAVEMENT MARKING PLAN**

SCALE: SHEET NO. OF SHEETS STA. TO STA.

F.A.U. RTE.	SECTION	COUNTY	TOTAL SHEETS	SHEET NO.
1313	(99B&0808)RS-1	COOK	30	12
CONTRACT NO. 60R99			ILLINOIS FED. AID PROJECT	