

DATE	
BY	
SURVEYED	
PLOTTED	
NOTE BOOK	
AREAS CHECKED	

DATE	
BY	
ORIGINAL SURVEY	
PLOTTED	
NOTE BOOK	
AREAS CHECKED	

- 1 STA 22+50, 21.1' LT
INLETS TA T24F&G
RIM = 810.68
INV = 806.68 (E)
- 2 STA 22+50, 41.9' RT
CB TA 4 DIA T24F&G
RIM = 810.68
INV = 806.38 (W)
INV = 806.28 (E)
- 3 STA 22+50, 49.5' RT
MAN TA 4 DIA T1F CL
RIM = 812.01
INV = 806.26 (W)
INV = 806.16 (N)
- ① 60' - STORM SEW CL A 1, 12" @ 0.50%
TBF = 10 CU YD
- ② 4' - STORM SEW CL A 1, 15" @ 0.50%
TBF = 1 CU YD
- ③ 246' - STORM SEW CL A 1, 15" @ 0.44%

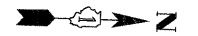

BEGIN ROADWAY IMPROVEMENTS
STA 19+71.0
(MATCH EXISTING)

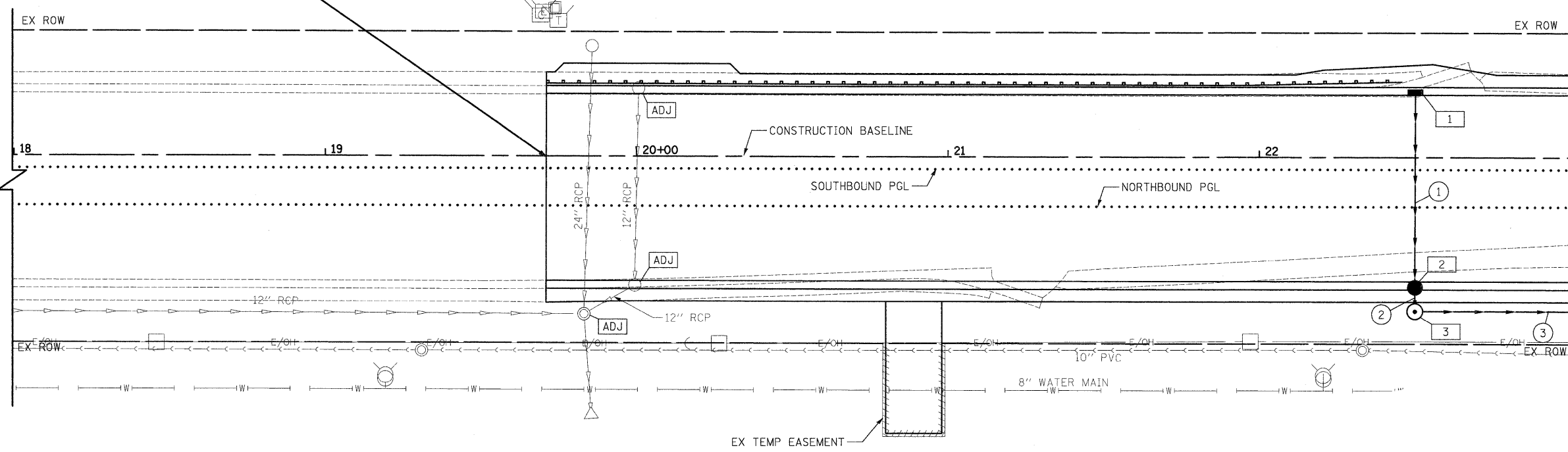

MATCH LINE STATION 23+00
SEE SHEET NO. 73

QUENTIN ROAD

BEGIN ROADWAY IMPROVEMENTS
STA 19+71.0
(MATCH EXISTING)

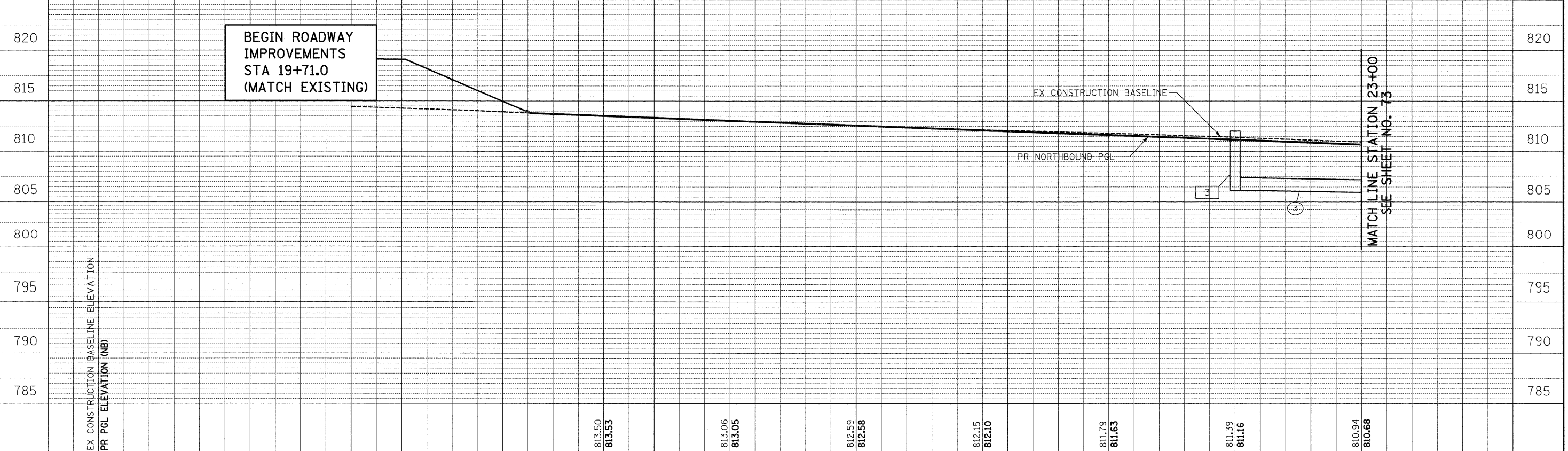

MATCH LINE STATION 23+00
SEE SHEET NO. 73