

FAU RTE.	SECTION	COUNTY	TOTAL SHEETS	SHEET NO.
2835	10-00079-00-RS	COOK	10	1
STA. 50+50		TO STA. 75+60		
FED. ROAD DIST. NO.		ILLINOIS		

# 06-15-12 LETTING ITEM 019

## INDEX OF SHEETS

SHEET NO.	TITLE
1	COVER SHEET
2	GENERAL NOTES, IDOT STANDARDS & SUMMARY OF QUANTITIES
3	TYPICAL CROSS SECTIONS
4	PAVEMENT RESURFACING PLAN, STA. 50+50 TO STA. 59+30
5	PAVEMENT RESURFACING PLAN, STA. 59+30 TO STA. 68+10
6	PAVEMENT RESURFACING PLAN, STA. 68+10 TO STA. 75+60
7	PAVEMENT STRIPING PLAN
8	DISTRICT ONE, TYPICAL PAVEMENT MARKINGS, TC-13
9	BUTT JOINT AND HMA TAPER DETAILS, BD-32, DISTRICT ONE
10	DETAILS FOR FRAMES AND LIDS ADJUSTMENT WITH MILLING, BD-8

# STATE OF ILLINOIS

## DEPARTMENT OF TRANSPORTATION

### DIVISION OF HIGHWAYS

# PLANS FOR PROPOSED FEDERAL AID HIGHWAY

VILLAGE OF HAZEL CREST  
 FAU 2835 (CALIFORNIA AVE.),  
 175<sup>th</sup> ST. TO 171<sup>st</sup> ST.  
 PAVEMENT RESURFACING  
 COOK COUNTY  
 SECTION 10-00079-00-RS  
 PROJECT No. M-9003 (856)  
 JOB No. C-91-021-12



R13E 3RD P.M.

PROJECT LOCATED IN VILLAGE OF HAZEL CREST

DESIGN DESIGNATION:  
390(28) COLLECTOR 2.51 (HMA8)

TRAFFIC DATA:  
ADT=375  
SPEED LIMIT ON CALIFORNIA AVENUE - 25 MPH

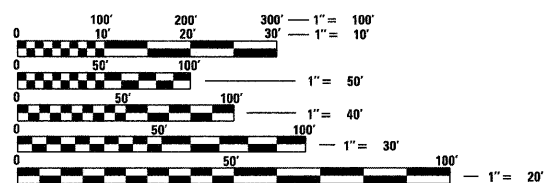

FULL SIZE PLANS HAVE BEEN PREPARED USING STANDARD ENGINEERING SCALES. REDUCED SIZED PLANS WILL NOT CONFORM TO STANDARD SCALES. IN MAKING MEASUREMENTS ON REDUCED PLANS, THE ABOVE SCALES MAY BE USED.

J.U.L.I.E.  
JOINT UTILITY LOCATION INFORMATION FOR EXCAVATION  
1-800-892-0123 OR 811

SEC 25, T36N

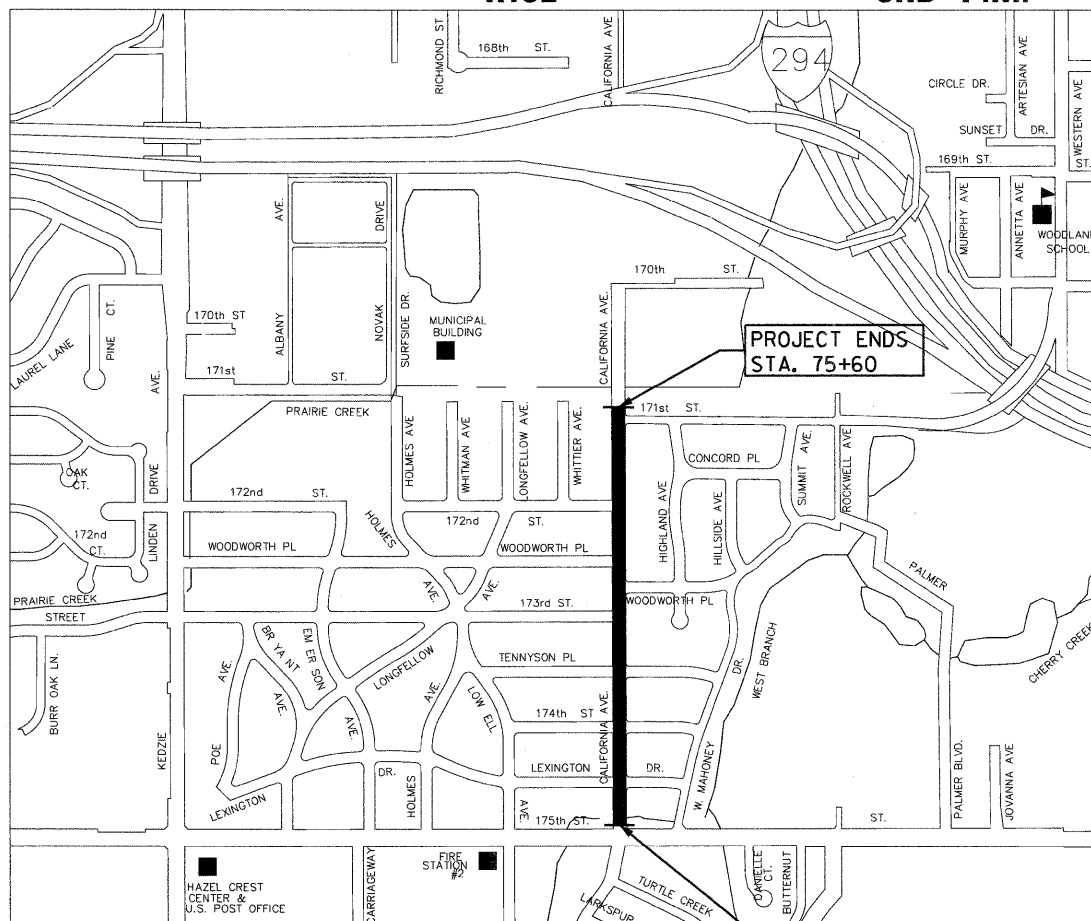

### LOCATION MAP

N.T.S.

GROSS LENGTH OF PROJECT = 2,600 FT = 0.49 MILE  
NET LENGTH OF PROJECT = 2,510 FT = 0.48 MILE



STATE OF ILLINOIS  
 DEPARTMENT OF TRANSPORTATION  
 DIVISION OF HIGHWAYS

Approved: [Signature] 2/14/2012 DATE  
 Village President, Village of Hazel Crest

Passed: MARCH 26, 2012 DATE  
[Signature]  
 District Engineer of Local Roads & Streets

Releasing for Bid Based on Limited Review: MARCH 26, 2012 DATE  
[Signature]  
 Deputy Director of Highways, Region 1 Engineer



LICENSE EXPIRATION DATE: 11/30/2013

*Chandra S. Trivedi*

PRINTED BY AUTHORITY OF THE STATE OF ILLINOIS

GLOBAL TROTTERS ENGINEERING CORP.; CHANDRA S. TRIVEDI, P.E.  
(312) 697-3580, CHICAGO, IL

PROGRAM AND OFFICE ENGINEER : CHARLES F. RIDDLE, P.E.  
(847) 705-4406, SCHALMBURG, IL

CONTRACT NO. 63701



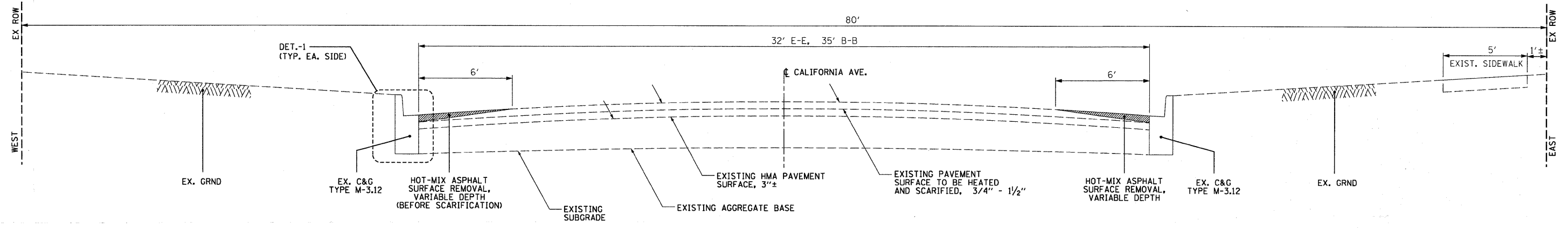

**EXISTING TYPICAL SECTION**  
STA. 50+50 TO STA. 75+50, CALIFORNIA AV.

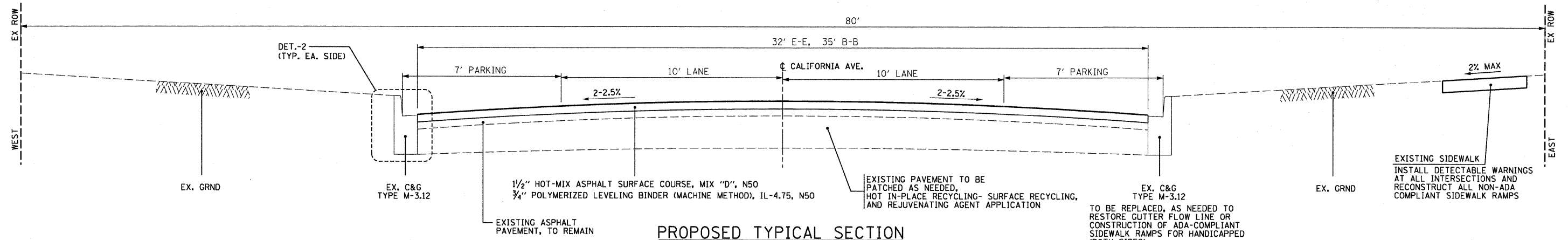

**PROPOSED TYPICAL SECTION**  
STA. 50+50 TO STA. 75+50, CALIFORNIA AV.

**HOT-MIX ASPHALT MIXTURE REQUIREMENTS**

NOTE: THE CONTRACTOR SHALL MILL PAVEMENT SURFACE BEFORE PATCHING.

MIXTURE TYPE	AIR VOIDS Ndes
<b>PAVEMENT RESURFACING</b>	
HOT-MIX ASPHALT SURFACE COURSE, MIX "D", N50 (IL-9.5mm) 1/2"	4% @ 50 GYR
POLYMERIZED LEVELING BINDER (MACHINE METHOD), IL-4.75, N50; 3/4"	3.5% @ 50 GYR
<b>PATCHING</b>	
CLASS D PATCHES, TYPE IV, 8 INCH ( HOT MIX ASPHALT BINDER COURSE IL-19.0) (IN 3 LIFTS)	4% @ 70 GYR
<b>DRIVEWAYS</b>	
HOT-MIX ASPHALT SURFACE COURSE, MIX "D", N50 (IL-9.5mm) 1/2"	4% @ 50 GYR
HOT-MIX ASPHALT SURFACE COURSE, MIX "D", N50 (IL-9.5mm) 3"	4% @ 50 GYR
HOT-MIX ASPHALT BINDER COURSE, IL-19.0, N-50; 4 1/2" (IN 2 LIFTS)	4% @ 50 GYR

**NOTES:**

- UNIT WEIGHT USED TO MEASURE ALL HOT-MIX ASPHALT SURFACE COURSE QUANTITY IS 112 LBS/SQ. YD./INCH
- THE "AC TYPE" FOR POLYMERIZED HMA MIXTURES SHALL BE "SBS/SBR PG 76-22" AND FOR NON-POLYMERIZED HMA THE "AC TYPE" SHALL BE "PG 64-22" UNLESS MODIFIED BY DISTRICT ONE SPECIAL PROVISIONS. FOR "PERCENT RAP" SEE SPECIAL PROVISIONS.

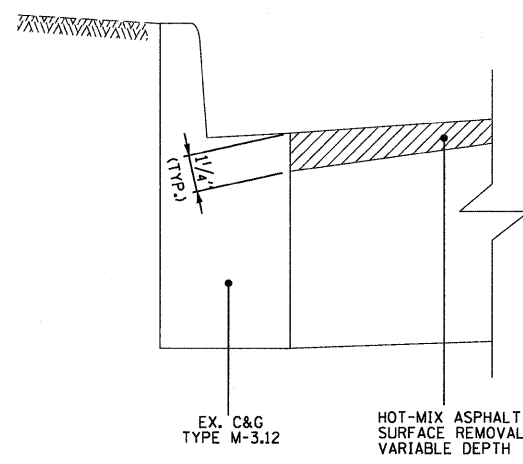

**DETAIL-1**

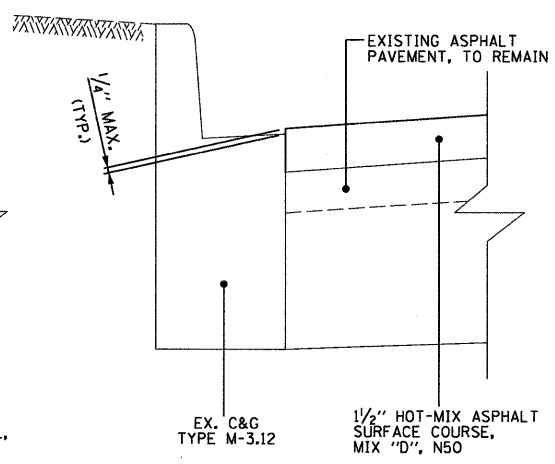

**DETAIL-2**

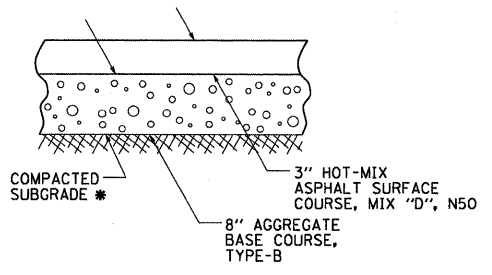

**HOT-MIX ASPHALT DRIVEWAY PAVEMENT, 3" (RESIDENTIAL)**

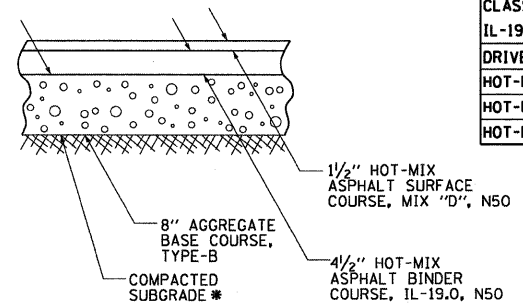

**HOT-MIX ASPHALT DRIVEWAY PAVEMENT, 6" (NON RESIDENTIAL)**

\* ANY SOFT UNSUITABLE SUBGRADE MATERIAL DISCOVERED AFTER REMOVAL OF EXISTING DRIVEWAY SHALL BE REMOVED & REPLACED WITH POROUS GRANULAR EMBANKMENT, SUBGRADE TO A DEPTH AS DIRECTED BY THE ENGINEER.



FILE NAME = P:\projects\05726\030\Sheet\03.dgn	USER NAME = boris.shkolnik	DESIGNED - CST	REVISED -	<b>STATE OF ILLINOIS DEPARTMENT OF TRANSPORTATION</b>	<b>PAVEMENT RESURFACING PLAN TYPICAL CROSS SECTIONS</b>		F.A. RTE. 2835	SECTION 10-00079-00-RS	COUNTY COOK	TOTAL SHEETS 10	SHEET NO. 3
PLOT SCALE = N.T.S.	CHECKED - CST	DATE -	REVISED -		SCALE: N.T.S.	SHEET NO. 3 OF 10 SHEETS	STA. 50+50 TO STA. 75+50	CALIFORNIA AVE.		CONTRACT NO. 63701	
PLOT DATE = 2/1/2012	DATE -	REVISED -	REVISED -				FED. ROAD DIST. NO. ILLINOIS FED. AID PROJECT				

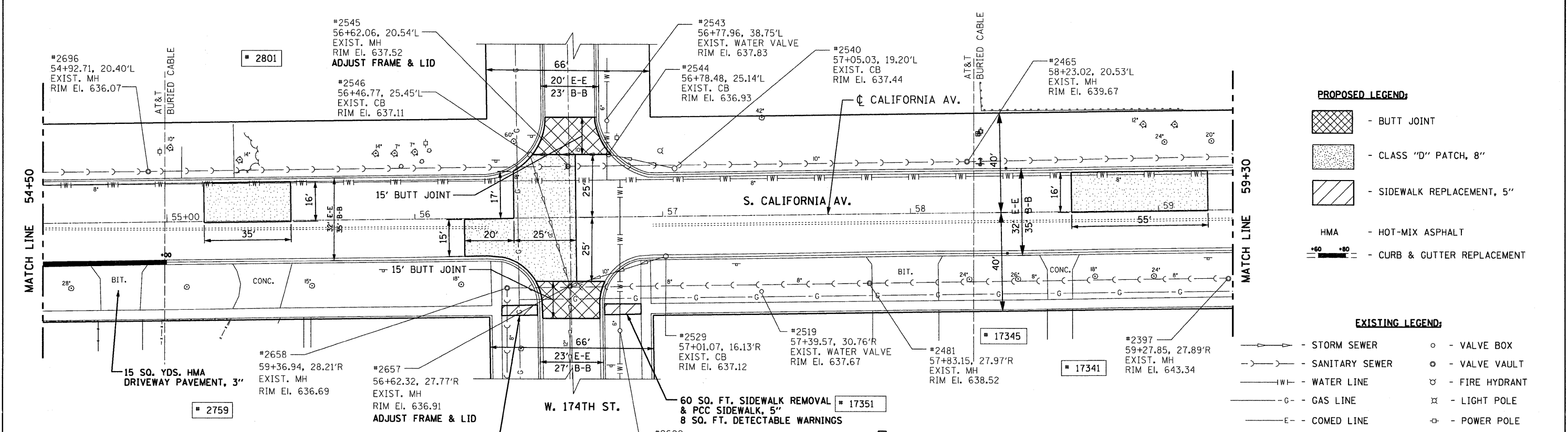
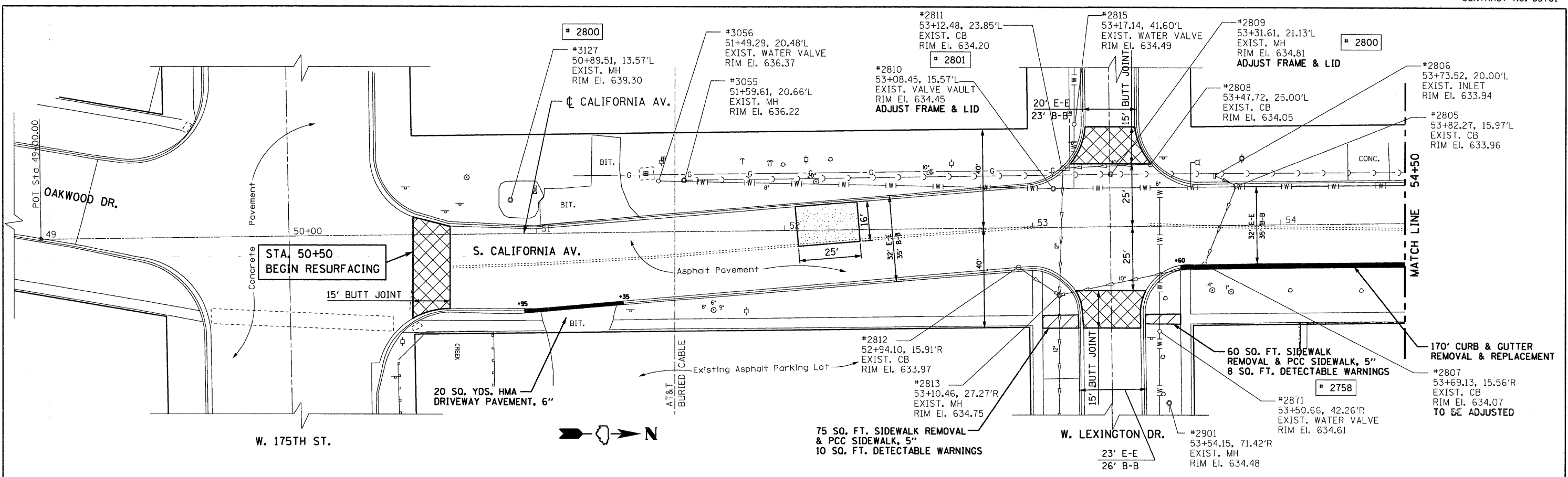

- PROPOSED LEGEND:**
- BUTT JOINT
  - CLASS "D" PATCH, 8"
  - SIDEWALK REPLACEMENT, 5"
  - HMA - HOT-MIX ASPHALT
  - CURB & GUTTER REPLACEMENT

- EXISTING LEGEND:**
- STORM SEWER
  - SANITARY SEWER
  - WATER LINE
  - GAS LINE
  - COMED LINE
  - CATCH BASIN
  - MANHOLE
  - INLET
  - TELEPHONE MANHOLE
  - VALVE BOX
  - VALVE VAULT
  - FIRE HYDRANT
  - LIGHT POLE
  - POWER POLE
  - GUY
  - ASPHALT DRIVEWAY
  - CONCRETE DRIVEWAY
  - ADDRESS

**Globetrotters**  
 Engineering Corporation  
 ENGINEERS - ARCHITECTS  
 300 S Wacker Drive  
 Chicago, Illinois 60606 U.S.A.  
 Ph 312-922-6400

FILE NAME =	USER NAME = boris.shkolnik	DESIGNED - CST	REVISED -
P:\projects\05726\030\C\Sheet\C04.dgn		DRAWN - BS	REVISED -
PLOT SCALE = 1"=20'		CHECKED - CST	REVISED -
PLOT DATE = 2/1/2012		DATE -	REVISED -

**STATE OF ILLINOIS  
 DEPARTMENT OF TRANSPORTATION**

**PAVEMENT RESURFACING PLAN**

SCALE: 1"=20'    SHEET NO. 4 OF 10 SHEETS    STA. 50+50 TO STA. 59+30

F.A. RTE.	SECTION	COUNTY	TOTAL SHEETS	SHEET NO.
2835	10-00079-00-RS	COOK	10	4
CALIFORNIA AVE.		CONTRACT NO. 63701		
FED. ROAD DIST. NO.		ILLINOIS FED. AID PROJECT		

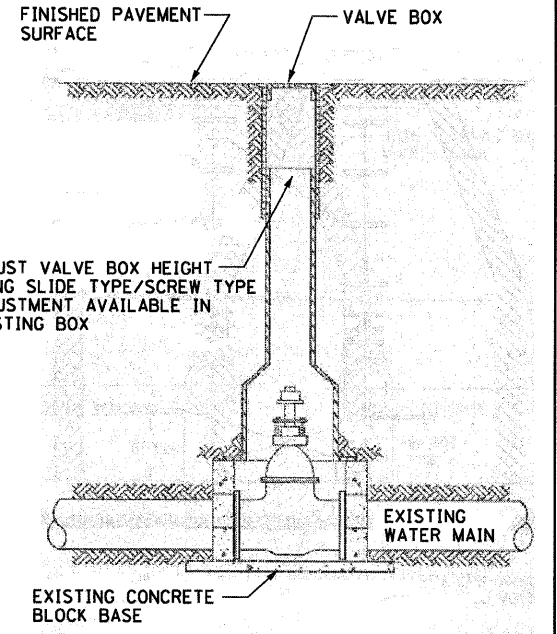
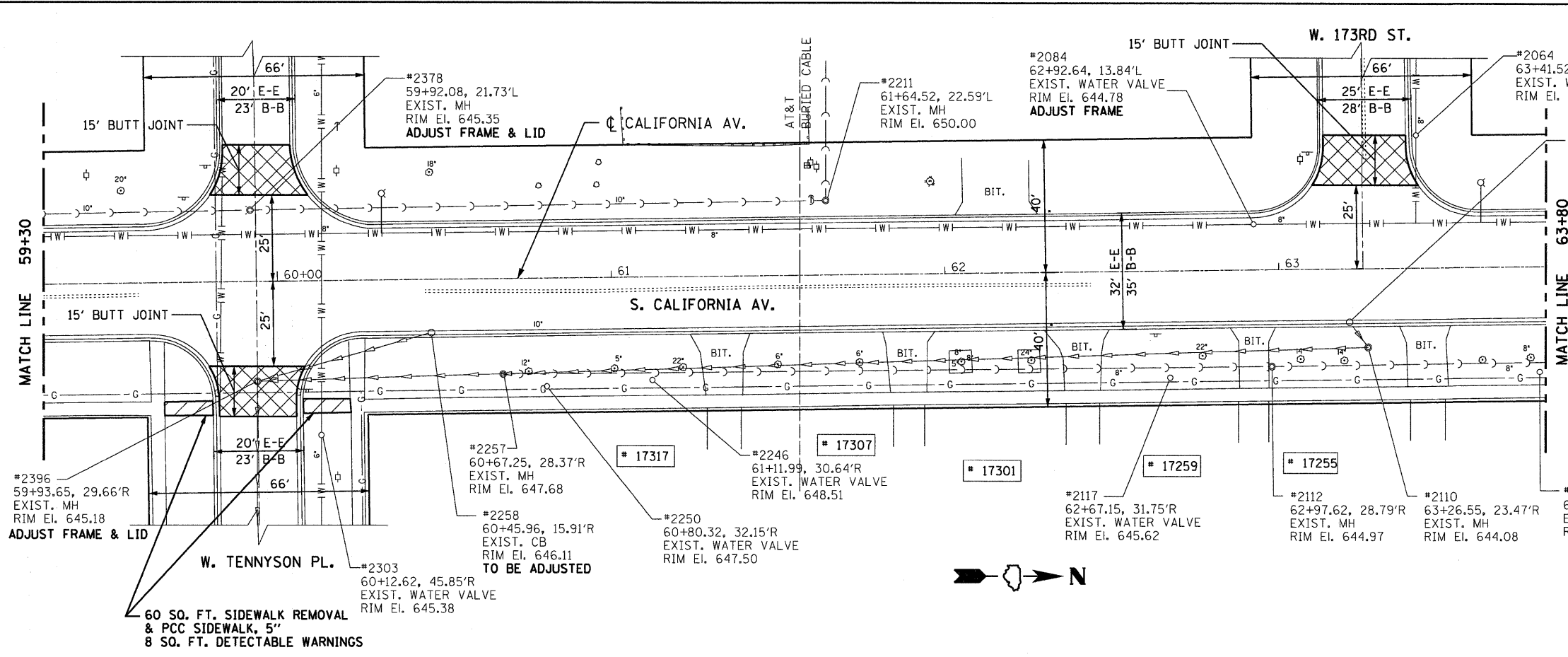

**TYPICAL VALVE BOX ADJUSTMENT**  
Scale: N.T.S.

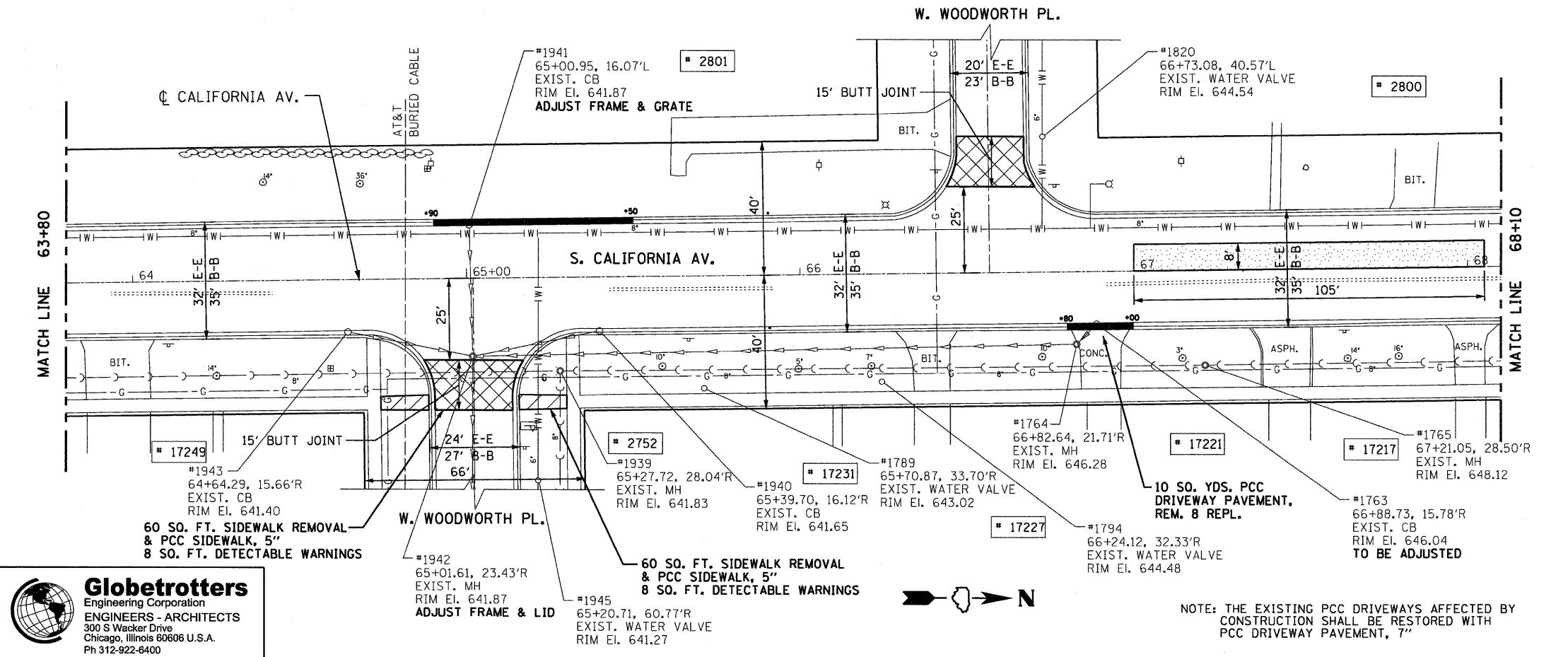

- PROPOSED LEGEND:**
- BUTT JOINT
  - CLASS "D" PATCH, 8"
  - HMA - HOT-MIX ASPHALT
  - CURB & GUTTER REPLACEMENT

- EXISTING LEGEND:**
- STORM SEWER
  - SANITARY SEWER
  - WATER LINE
  - GAS LINE
  - COMED LINE
  - CATCH BASIN
  - MANHOLE
  - INLET
  - TELEPHONE MANHOLE
  - VALVE BOX
  - VALVE VAULT
  - FIRE HYDRANT
  - LIGHT POLE
  - POWER POLE
  - GUY
  - ASPHALT DRIVEWAY
  - CONCRETE DRIVEWAY
  - ADDRESS

NOTE: THE EXISTING PCC DRIVEWAYS AFFECTED BY CONSTRUCTION SHALL BE RESTORED WITH PCC DRIVEWAY PAVEMENT, 7"

**Globetrotters**  
Engineering Corporation  
ENGINEERS - ARCHITECTS  
300 S Wacker Drive  
Chicago, Illinois 60606 U.S.A.  
Ph 312-922-6400

FILE NAME =	USER NAME = boris.shkolnik	DESIGNED - CST	REVISED -
P:\projects\05726\838\C\Sheet\C05.dgn		DRAWN - BS	REVISED -
		CHECKED - CST	REVISED -
		DATE -	REVISED -

**STATE OF ILLINOIS**  
**DEPARTMENT OF TRANSPORTATION**

**PAVEMENT RESURFACING PLAN**

SCALE: 1"=20'    SHEET NO. 5 OF 10 SHEETS    STA. 59+30 TO STA. 68+10

F.A. RTE.	SECTION	COUNTY	TOTAL SHEETS	SHEET NO.
2835	10-00079-00-RS	COOK	10	5
CALIFORNIA AVE.		CONTRACT NO. 63701		
FED. ROAD DIST. NO.		ILLINOIS FED. AID PROJECT		

P:\load\micro\Pen\Tb\Tb\doc.tbl P:\load\micro\Pen\Tb\Tb\doc.tbl P:\load\micro\Pen\Tb\Tb\doc.tbl

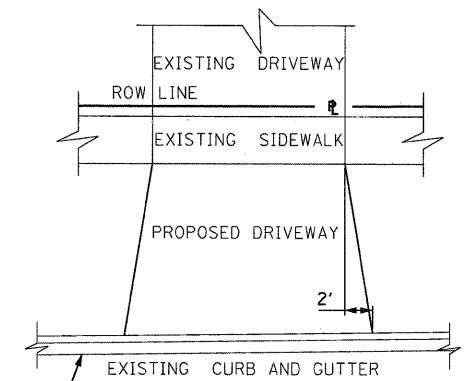
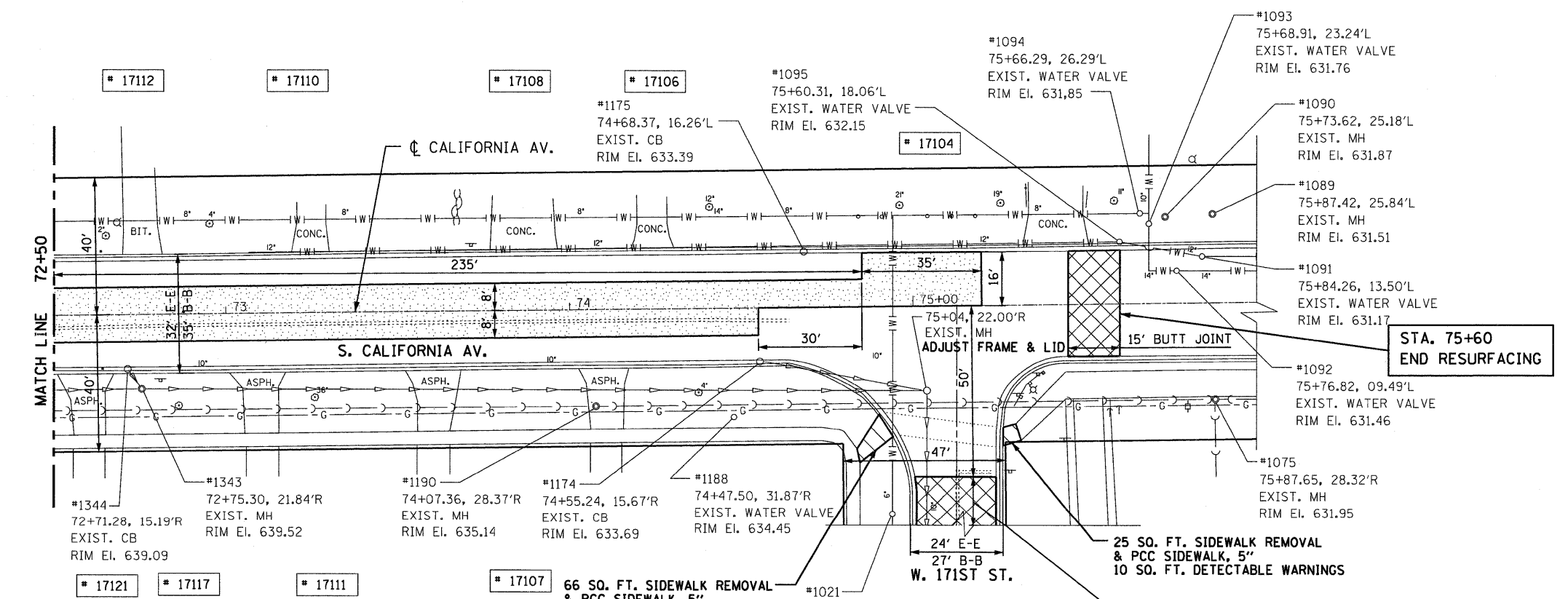
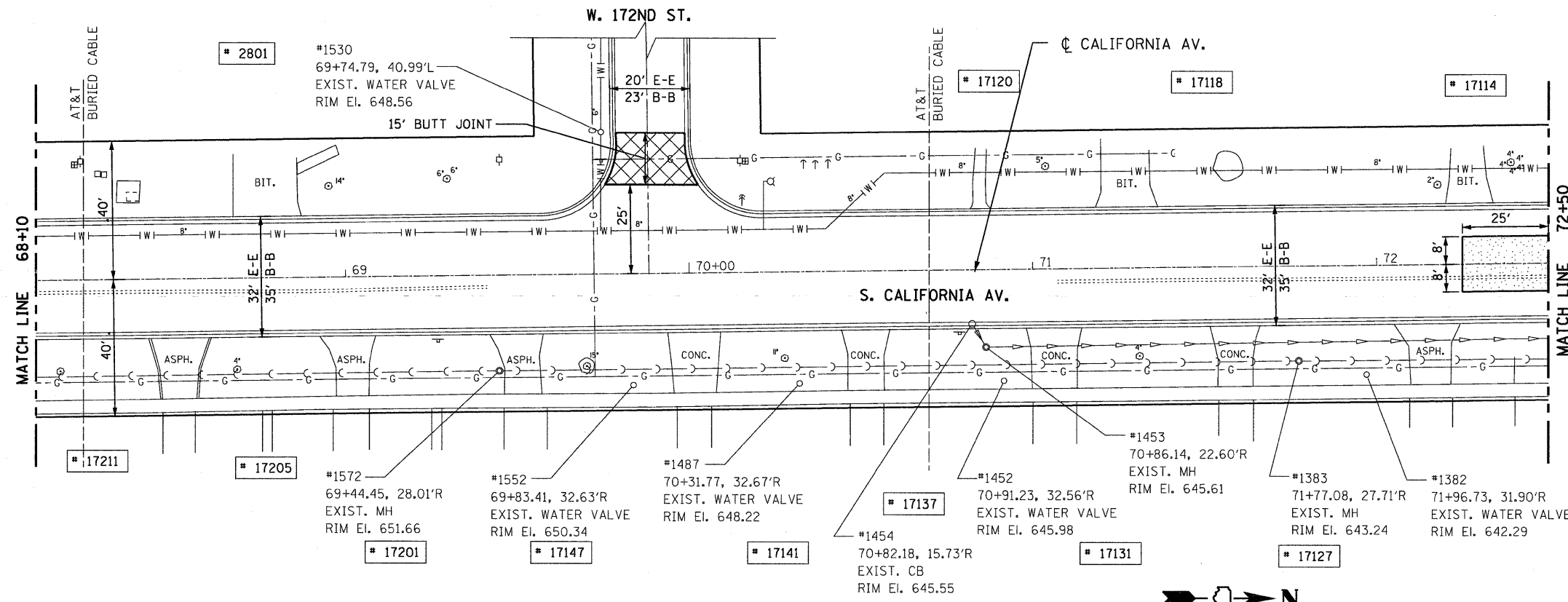

TYPICAL DRIVEWAY RECONSTRUCTION

- PROPOSED LEGEND:**
- BUTT JOINT
  - CLASS "D" PATCH, 8"
  - HMA - HOT-MIX ASPHALT
  - CURB & GUTTER REPLACEMENT

- EXISTING LEGEND:**
- STORM SEWER
  - SANITARY SEWER
  - WATER LINE
  - GAS LINE
  - COMED LINE
  - CATCH BASIN
  - MANHOLE
  - INLET
  - TELEPHONE MANHOLE
  - VALVE BOX
  - VALVE VAULT
  - FIRE HYDRANT
  - LIGHT POLE
  - POWER POLE
  - GUY
  - ASPHALT DRIVEWAY
  - CONCRETE DRIVEWAY
  - ADDRESS

**Globetrotters**  
 Engineering Corporation  
 ENGINEERS - ARCHITECTS  
 300 S Wacker Drive  
 Chicago, Illinois 60606 U.S.A.  
 Ph 312-822-6400

P:\projects\105726\030\Sheet\C06.dgn  
 P:\projects\105726\030\Sheet\C06.dgn  
 P:\projects\105726\030\Sheet\C06.dgn

FILE NAME =	USER NAME = boris.shkoInk	DESIGNED - CST	REVISED -
P:\projects\105726\030\Sheet\C06.dgn		DRAWN - BS	REVISED -
PLOT SCALE = 1"=20'		CHECKED - CST	REVISED -
PLOT DATE = 2/1/2012		DATE -	REVISED -

**STATE OF ILLINOIS**  
**DEPARTMENT OF TRANSPORTATION**

**PAVEMENT RESURFACING PLAN**

SCALE: 1"=20'    SHEET NO. 6 OF 10 SHEETS    STA. 68+10 TO STA. 75+60

F.A. RTE.	SECTION	COUNTY	TOTAL SHEETS	SHEET NO.
2835	10-00079-00-R5	COOK	10	6
CALIFORNIA AVE.		CONTRACT NO. 63701		
FED. ROAD DIST. NO.		ILLINOIS FED. AID PROJECT		

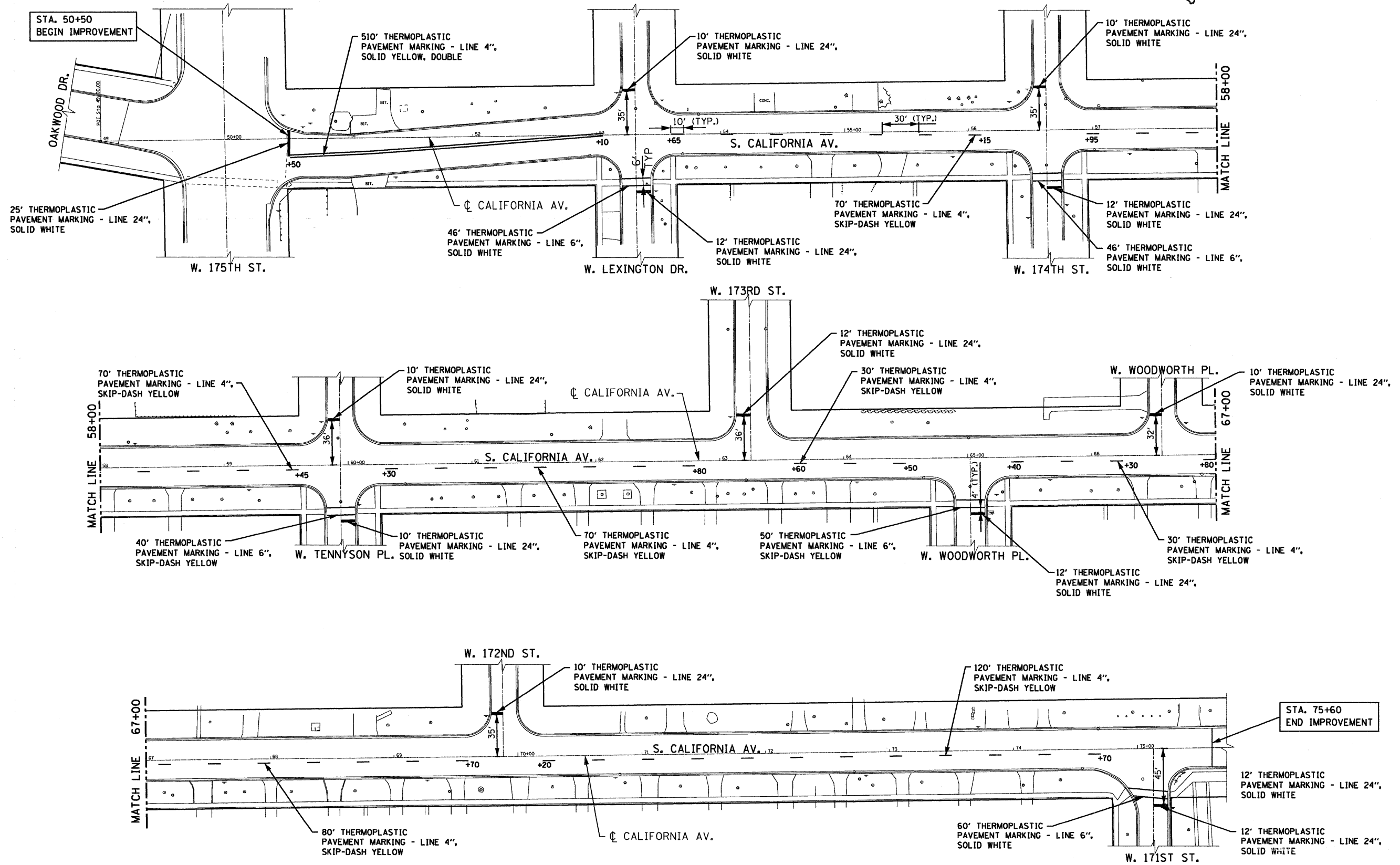
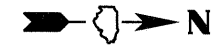

NOTE:  
SEE SHEET No. 10 FOR PAVEMENT MARKING DETAILS.

**Globetrotters**  
Engineering Corporation  
ENGINEERS - ARCHITECTS  
300 S Wacker Drive  
Chicago, Illinois 60606 U.S.A.  
Ph 312-922-8400

FILE NAME =	USER NAME = boris.shkolnik
P:\projects\05726\030\C\Sheet\C07.dgn	
PLOT SCALE = 1"=10'	
PLOT DATE = 1/26/2012	

DESIGNED - CST	REVISED -
DRAWN - BS	REVISED -
CHECKED - CST	REVISED -
DATE -	REVISED -

**STATE OF ILLINOIS**  
**DEPARTMENT OF TRANSPORTATION**

<b>PAVEMENT STRIPING PLAN</b>	
SCALE: 1"=10'	SHEET NO. 7 OF 10 SHEETS
STA. 50+50	TO STA. 75+60

F.A. RTE.	SECTION	COUNTY	TOTAL SHEETS	SHEET NO.
2835	10-00079-00-RS	COOK	10	7
CALIFORNIA AVE.		CONTRACT NO. 63701		
FED. ROAD DIST. NO. [ILLINOIS] FED. AID PROJECT				

P:\cad\micro\p1\010\drv\vw\pdf-24x36.plt.ctb

F.A.U. RTEL.	SECTION	COUNTY	TOTAL SHEETS	SHEET NO.
2835	10-00079-00-RS	COOK	10	8
STA. 50+50		TO STA. 75+60		
FED. ROAD DIST. NO.		ILLINOIS FED. AID PROJECT		

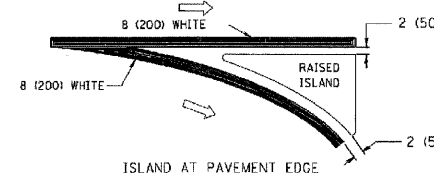
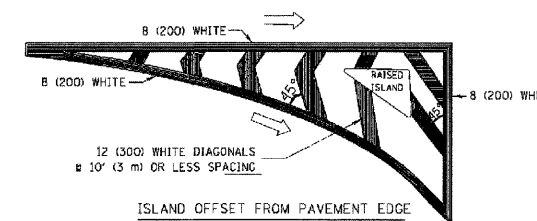
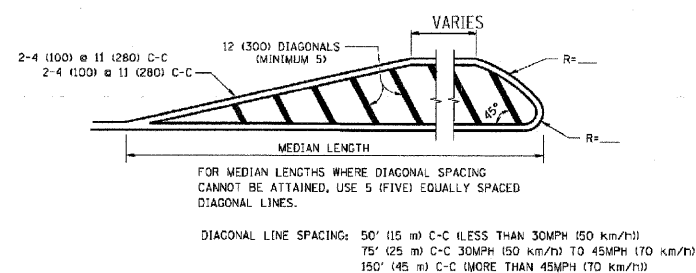
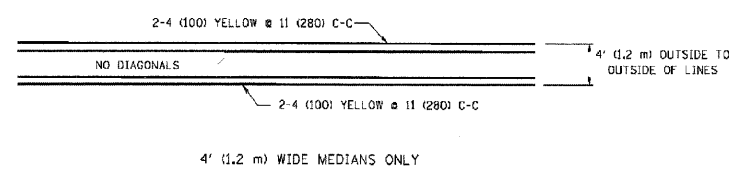
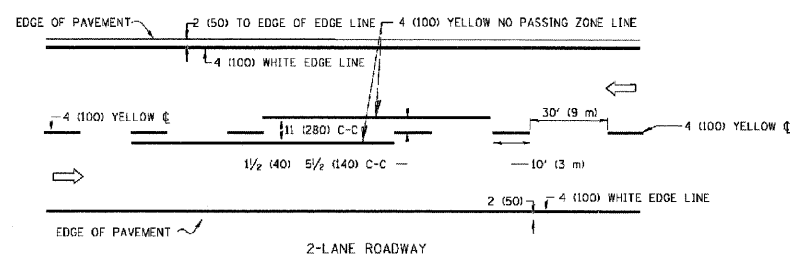

TYPICAL ISLAND MARKING

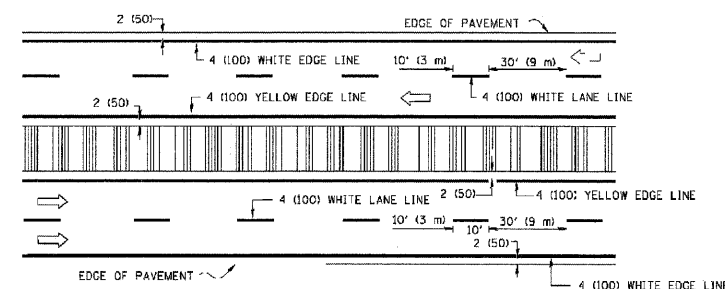
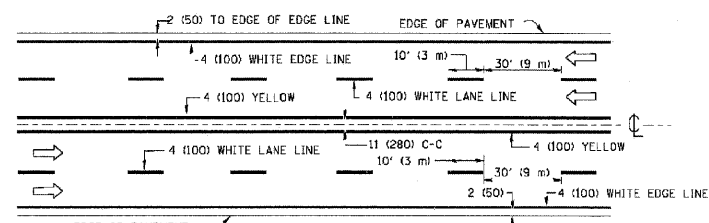

NOTE: MEDIANS WITH BARRIER CURB DO NOT REQUIRE AN EDGE LINE

TYPICAL LANE AND EDGE LINE MARKING

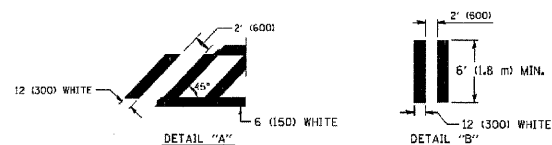
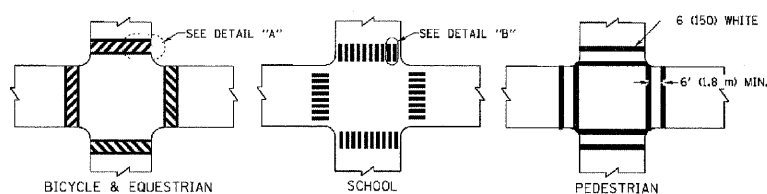

TYPICAL CROSSWALK MARKING

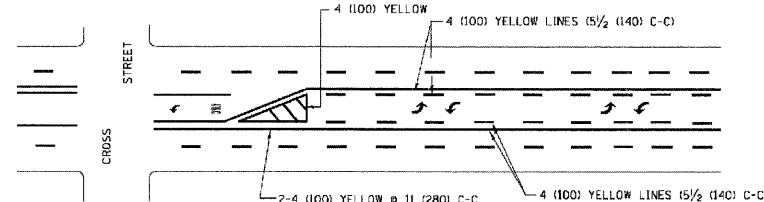

A MINIMUM OF TWO PAIRS OF TURN ARROWS SHALL BE USED, WHITE IN COLOR. ADDITIONAL PAIRS SHALL BE PLACED AT 200' (60 m) TO 300' (90 m) INTERVALS.

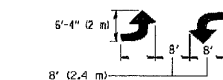

MEDIAN WITH TWO-WAY LEFT TURN LANE

TYPICAL PAINTED MEDIAN MARKING

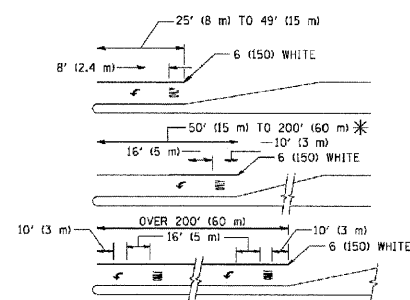

FULL SIZE LETTERS 8' (2.4 m) AND ARROWS SHALL BE USED. AREA = 15.6 SQ. FT. (1.5 m<sup>2</sup>) ONLY AREA = 20.8 SQ. FT. (1.9 m<sup>2</sup>)

\* TURN LANES IN EXCESS OF 400' (120 m) IN LENGTH MAY HAVE AN ADDITIONAL SET OF ARROW - "ONLY" INSTALLED MIDWAY BETWEEN THE OTHER TWO SETS OF ARROW - "ONLY".

TYPICAL LEFT (OR RIGHT) TURN LANE

TYPICAL TURN LANE MARKING

TYPE OF MARKING	WIDTH OF LINE	PATTERN	COLOR	SPACING / REMARKS
CENTERLINE ON 2 LANE PAVEMENT	4 (100)	SKIP-DASH	YELLOW	10' (3 m) LINE WITH 30' (9 m) SPACE
CENTERLINE ON MULTI-LANE UNDIVIDED PAVEMENT	2 @ 4 (100)	SOLID	YELLOW	11 (280) C-C
NO PASSING ZONE LINES FOR ONE DIRECTION FOR BOTH DIRECTIONS	4 (100) 2 @ 4 (100)	SOLID SOLID	YELLOW YELLOW	5/2 (140) C-C FROM SKIP-DASH CENTERLINE 11 (280) C-C OMIT SKIP-DASH CENTERLINE BETWEEN
LANE LINES	4 (100) 5 (125) ON FREEWAYS	SKIP-DASH SKIP-DASH	WHITE WHITE	10' (3 m) LINE WITH 30' (9 m) SPACE
DOTTED LINES (EXTENSIONS OF CENTER, LANE OR TURN LANE MARKINGS)	SAME AS LINE BEING EXTENDED	SKIP-DASH	SAME AS LINE BEING EXTENDED	2' (600) LINE WITH 6' (1.8 m) SPACE
EDGE LINES	4 (100)	SOLID	YELLOW-LEFT WHITE-RIGHT	OUTLINE MOUNTABLE MEDIANS IN YELLOW; EDGE LINES ARE NOT USED NEXT TO BARRIER CURB
TURN LANE MARKINGS	6 (150) LINE; FULL SIZE LETTERS & SYMBOLS (8' (2.4 m))	SOLID	WHITE	SEE TYPICAL TURN LANE MARKING DETAIL
TWO WAY LEFT TURN MARKING	2 @ 4 (100) EACH DIRECTION 8' (2.4 m) LEFT ARROW	SKIP-DASH AND SOLID IN PAIRS	YELLOW WHITE	10' (3 m) LINE WITH 30' (9 m) SPACE FOR SKIP-DASH; 5/2 (140) C-C BETWEEN SOLID LINE AND SKIP-DASH LINE SEE TYPICAL TWO-WAY LEFT TURN MARKING DETAIL
CROSSWALK LINES (PEDESTRIAN) A. DIAGONALS (BIKE & EQUESTRIAN) B. LONGITUDINAL BARS (SCHOOL)	2 @ 6 (150) 12 (300) @ 45° 12 (300) @ 90°	SOLID SOLID SOLID	WHITE WHITE WHITE	NOT LESS THAN 6' (1.8 m) APART 2' (600) APART 2' (600) APART SEE TYPICAL CROSSWALK MARKING DETAILS.
STOP LINES	24 (600)	SOLID	WHITE	PLACE 4' (1.2 m) IN ADVANCE OF AND PARALLEL TO CROSSWALK, IF PRESENT. OTHERWISE, PLACE AT DESIRED STOPPING POINT. PARALLEL TO CROSSROAD CENTERLINE, WHERE POSSIBLE.
PAINTED MEDIANS	2 @ 4 (100) WITH 12 (300) DIAGONALS @ 45° NO DIAGONALS USED FOR 4' (1.2 m) WIDE MEDIANS	SOLID	YELLOW; TWO WAY TRAFFIC WHITE; ONE WAY TRAFFIC	11 (280) C-C FOR THE DOUBLE LINE SEE TYPICAL PAINTED MEDIAN MARKING.
GORE MARKING AND CHANNELIZING LINES	8 (200) WITH 12 (300) DIAGONALS @ 45°	SOLID	WHITE	DIAGONALS: 15' (4.5 m) C-C (LESS THAN 30MPH (50 km/h)) 20' (6 m) C-C 30MPH (50 km/h) TO 45MPH (70 km/h) 30' (9 m) C-C (OVER 45MPH (70 km/h))
RAILROAD CROSSING	24 (600) TRANSVERSE LINES; "RR" IS 6' (1.8 m) LETTERS; 16 (400) LINE FOR "X"	SOLID	WHITE	SEE STATE STANDARD 78000; AREA OF: "R"=3.6 SQ. FT. (0.33 m <sup>2</sup> ) EACH "X"=54.0 SQ. FT. (5.0 m <sup>2</sup> )
SHOULDER DIAGONALS	12 (300) @ 45°	SOLID	WHITE - RIGHT YELLOW - LEFT	50' (15 m) C-C (LESS THAN 30MPH (50 km/h)) 75' (25 m) C-C (30 MPH (50 km/h) TO 45MPH (70 km/h)) 150' (45 m) C-C (OVER 45MPH (70 km/h))

FOR FURTHER DETAILS ON PAVEMENT MARKING REFER TO STANDARD SPECIFICATIONS FOR ROAD AND BRIDGE CONSTRUCTION AND STATE STANDARD 78000.

All dimensions are in inches (millimeters) unless otherwise shown.

REVISIONS	
NAME	DATE
EVERS	03-19-90
T. RAMMACHER	10-27-94
C. JUICIUS	09-09-09

ILLINOIS DEPARTMENT OF TRANSPORTATION  
DISTRICT ONE  
TYPICAL PAVEMENT MARKINGS

SCALE: NONE

DRAWN BY CADD  
CHECKED BY

TC-13



F.A.U. RITE	SECTION	COUNTY	TOTAL SHEETS	SHEET NO.
2835	10-00079-00-RS	COOK	10	9
STA. 50+50		TO STA. 75+60		
FED. ROAD DIST. NO. 1 ILLINOIS FED. AID PROJECT				

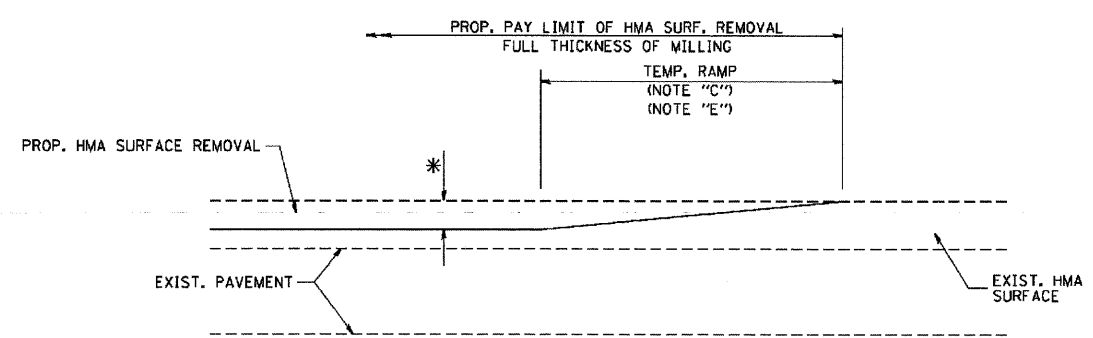

MILLED TEMPORARY RAMP  
(FOR BUTT JOINT AND HMA TAPER SEE DETAIL BELOW)

**OPTION 1**

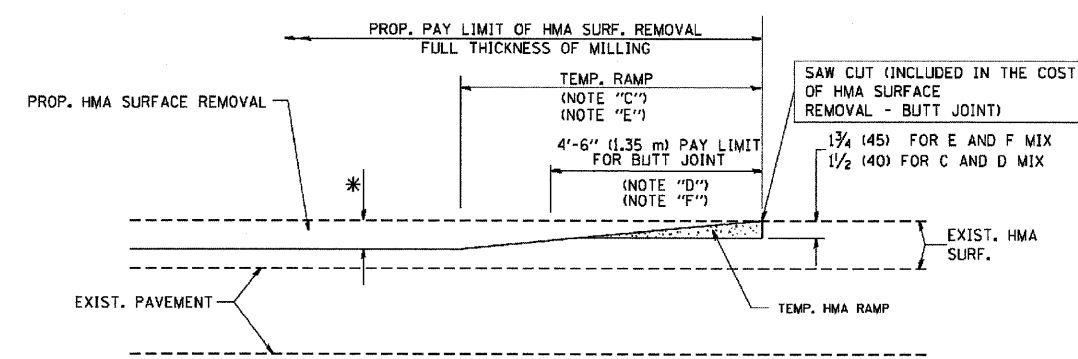

HMA CONSTRUCTED TEMPORARY RAMP  
(FOR BUTT JOINT AND HMA TAPER SEE DETAIL BELOW)

**OPTION 2**

**TYPICAL TEMPORARY RAMP**

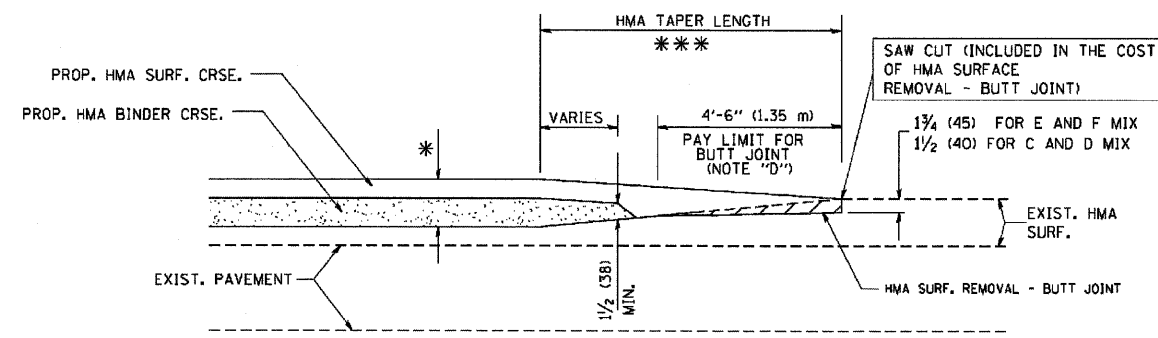

BUTT JOINT AND HMA TAPER

**TYPICAL BUTT JOINT AND HMA TAPER FOR MILLING AND RESURFACING**

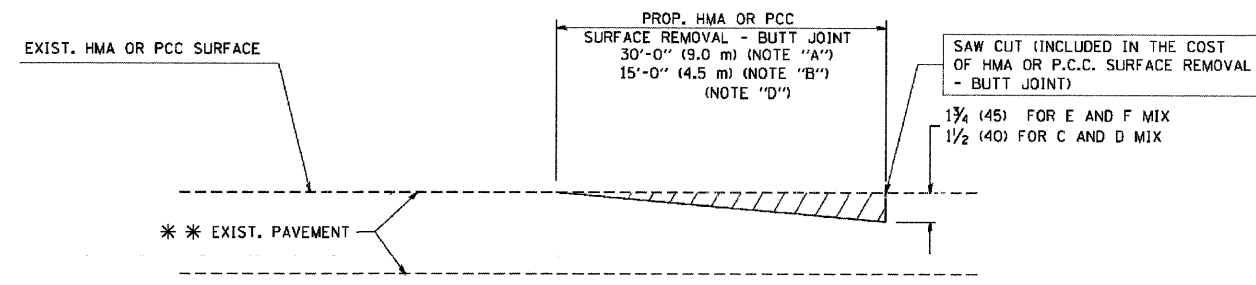

BUTT JOINT DETAIL

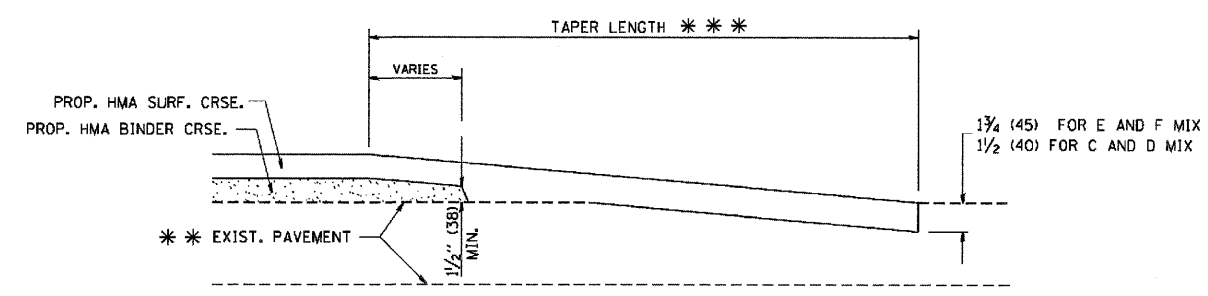

HMA TAPER DETAIL

**TYPICAL BUTT JOINT AND HMA TAPER FOR RESURFACING ONLY**

\*\*\* PC CONCRETE, HMA OR HMA RESURFACED PAVEMENT.

**NOTES**

- A: MAINLINE ROADWAYS AND MAJOR SIDE ROADS.
- B: MINOR SIDE ROADS.
- C: THE TEMP. RAMP SHALL BE CONSTRUCTED IMMEDIATELY UPON REMOVAL OF THE EXISTING HMA SURFACE.
- D: THE BUTT JOINT SHALL BE CONSTRUCTED IMMEDIATELY PRIOR TO PLACING THE PROPOSED HMA COURSES.
- E: TAPER THE TEMP. RAMP AT A RATE OF 3'-0" (900 mm) PER 1 INCH (25 mm) OF MILLING THICKNESS.
- F: INSTALLATION AND REMOVAL OF THE 4'-6" (1.35 m) TEMP. RAMP IS INCLUDED IN COST OF HMA SURFACE REMOVAL - BUTT JOINT
- G: SEE ARTICLE 406.08 AND 406.14 OF THE STANDARD SPECIFICATIONS FOR "HMA AND/OR PCC SURFACE REMOVAL, BUTT JOINT".
- \* SEE TYPICAL SECTIONS FOR MILLING THICKNESS.

\*\*\* 20'-0" (6.1 m) PER 1 (25) RESURFACING (NOTE "A")  
10'-0" (3.0 m) PER 1 (25) RESURFACING (NOTE "B")

ALL DIMENSIONS ARE IN INCHES (MILLIMETERS) UNLESS OTHERWISE SHOWN.

REVISIONS	
NAME	DATE
M. DE YONG	6-13-90
M. DE YONG	7-3-90
M. DE YONG	3-27-92
R. SHAH	09/09/94
R. SHAH	10/25/94
A. ABBAS	03/21/97
M. GOMEZ	04/06/03
R. BORO	01/01/07

ILLINOIS DEPARTMENT OF TRANSPORTATION

**BUTT JOINT AND HMA TAPER DETAILS**

SCALE: VERT. NONE  
HORIZ. NONE

DRAWN BY  
CHECKED BY

BD400-05 (V1=BD32)

**BASIS OF PAYMENT:**

THE BUTT JOINT WILL BE PAID FOR AT THE CONTRACT UNIT PRICE PER SQUARE YARD (SQUARE METER) FOR "HOT-MIX ASPHALT SURFACE REMOVAL - BUTT JOINT" OR FOR "PORTLAND CEMENT CONCRETE SURFACE REMOVAL - BUTT JOINT".

PLOT DATE = 3/5/2007  
FILE NAME = K:\Users\mhb02\dgn  
USER NAME = mhb02

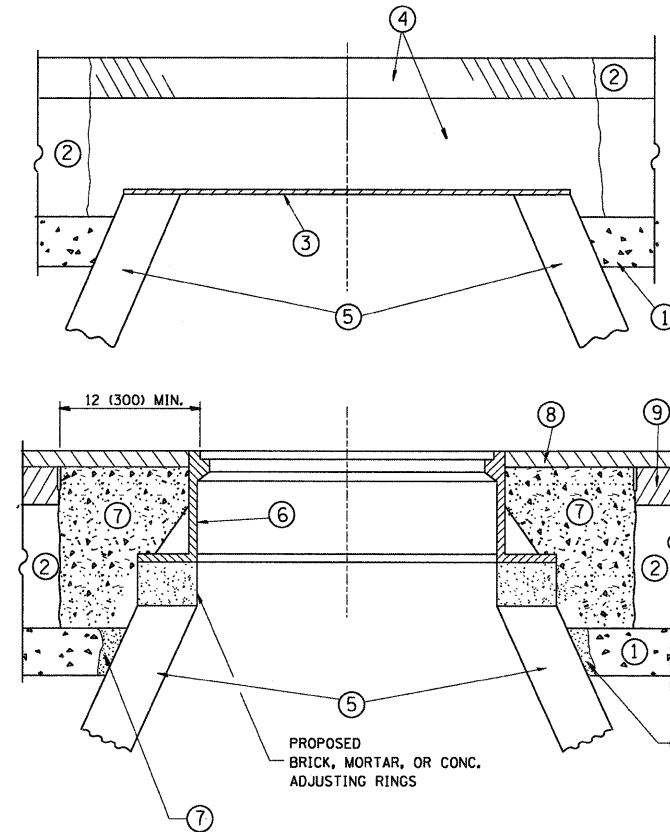

**NOTES:**

EXISTING BROKEN FRAMES AND LIDS SHALL BE REMOVED AND DISPOSED OF BY THE CONTRACTOR AND SHALL BE REPLACED AS DIRECTED BY THE ENGINEER. REPLACEMENT FRAMES AND LIDS WILL BE PAID FOR IN ACCORDANCE WITH ARTICLE 109.04 OF THE STANDARD SPECIFICATIONS UNLESS A SEPARATE PAY ITEM HAS BEEN PROVIDED.

IF THE EXISTING LIDS ARE OPEN, THE FRAME WILL BE ADJUSTED TO THE ELEVATION OF THE MILLED PAVEMENT SURFACE PRIOR TO THE MILLING OPERATION. THE FRAME WILL NOT BE REMOVED AND COVERED BY THE METAL PLATE.

CITY OF CHICAGO CASTINGS ARE THE PROPERTY OF THE CITY AND THE CONTRACTOR SHALL NOTIFY THE CITY FOR REMOVAL AND DISPOSITION OF THE CASTINGS.

THE METAL PLATE USED TO COVER THE STRUCTURE SHALL REMAIN THE PROPERTY OF THE CONTRACTOR.

WHEN STRUCTURES ARE TO BE ADJUSTED OR RECONSTRUCTED, THE LOWERING AND RAISING OF THE FRAMES AND LIDS WILL NOT BE PAID FOR SEPARATELY BUT WILL BE INCLUDED IN THE COST OF THE CORRESPONDING PAY ITEM.

**CONSTRUCTION PROCEDURES**

**STAGE 1 (BEFORE PAVEMENT MILLING)**

- A) REMOVE A MINIMUM OF 12 (300) OF THE PAVEMENT FROM AROUND THE STRUCTURE.
- B) REMOVE THE EXISTING FRAME AND LID FROM THE STRUCTURE.
- C) COVER THE STRUCTURE OPENING WITH A 36 (900) DIAMETER METAL PLATE.
- D) BACKFILL WITH CRUSHED STONE AND A MINIMUM 1 1/2 (40) THICK HMA SURFACE MIX APPROVED BY THE ENGINEER.

**STAGE 2 (AFTER PAVEMENT MILLING)**

- A) REMOVE THE HMA SURFACE MIX AND CRUSHED STONE.
- B) INSTALL THE FRAME AND LID; ADJUST THE FRAME TO ITS FINAL SURFACE ELEVATION.
- C) THE SURROUNDING SPACE SHALL BE FILLED WITH CLASS PP-1\* CONCRETE TO THE ELEVATION OF THE SURFACE OF THE EXISTING BASE COURSE OR THE BINDER COURSE.

\* UNLESS OTHERWISE SPECIFIED IN THE PLANS.

THE PROCEDURE EXPLAINED ABOVE SHALL CONFORM TO THE APPLICABLE PORTIONS OF SECTIONS 353, 406, 602, AND 603 OF THE STANDARD SPECIFICATIONS EXCEPT THAT "THE CONTRACTOR SHALL ADJUST THE STRUCTURES TO THE FINISHED PAVEMENT NO MORE THAN 5 CALENDAR DAYS PRIOR TO PLACEMENT OF THE FINAL LIFT OF SURFACE UNLESS APPROVED BY THE ENGINEER."

**LEGEND**

- ① SUB-BASE GRANULAR MATERIAL
- ② EXISTING PAVEMENT
- ③ 36 (900) DIAMETER METAL PLATE
- ④ PROPOSED CRUSHED STONE AND HMA SURFACE MIX
- ⑤ EXISTING STRUCTURE
- ⑥ FRAME AND LID (SEE NOTES)
- ⑦ CLASS PP-1\* CONCRETE
- ⑧ PROPOSED HMA SURFACE COURSE
- ⑨ PROPOSED HMA BINDER COURSE

**LOCATION OF STRUCTURES:**

THE CONTRACTOR WILL BE REQUIRED TO KEEP A RECORD OF THE LOCATIONS OF THE BURIED STRUCTURES ACCORDING TO THE STATION AND DISTANCE LEFT OR RIGHT OF THE CENTERLINE OF PAVEMENT. UPON COMPLETION OF THE WORK, THE CONTRACTOR WILL DELIVER THE RECORD TO THE ENGINEER.

**BASIS OF PAYMENT:**

REMOVING FRAMES AND LIDS ON DRAINAGE AND UTILITY STRUCTURES IN THE PAVEMENT PRIOR TO MILLING, AND ADJUSTING TO FINAL GRADE PRIOR TO PLACING THE SURFACE COURSE, WILL BE PAID FOR AT THE CONTRACT UNIT PRICE EACH FOR "FRAMES AND LIDS TO BE ADJUSTED (SPECIAL)."

THIS WORK WILL NOT BE PAID FOR WHEN DRAINAGE AND UTILITY STRUCTURES ARE SPECIFIED FOR PAYMENT AS STRUCTURE RECONSTRUCTION.

NEW FRAMES AND LIDS, WHEN SPECIFIED, WILL BE PAID FOR SEPARATELY.

**DETAILS FOR FRAMES AND LIDS ADJUSTMENT WITH MILLING**

**Globetrotters**  
Engineering Corporation  
ENGINEERS - ARCHITECTS  
300 S Wacker Drive  
Chicago, Illinois 60606 U.S.A.  
Ph 312-922-6400

FILE NAME =	USER NAME = boris.shkolnik	DESIGNED - CST	REVISED -
P:\projects\05726\030\C\Sheet\C10.dgn		DRAWN - BS	REVISED -
		CHECKED - CST	REVISED -
		DATE -	REVISED -

**STATE OF ILLINOIS  
DEPARTMENT OF TRANSPORTATION**

**DETAILS FOR  
FRAMES AND LIDS ADJUSTMENT WITH MILLING**

SCALE: NONE SHEET NO. 10 OF 10 SHEETS STA. TO STA.

F.A. RTE.	SECTION	COUNTY	TOTAL SHEETS	SHEET NO.
			10	10
BD600-03 (BD-8)			CONTRACT NO. 63701	
FED. ROAD DIST. NO. 1 ILLINOIS FED. AID PROJECT				

P:\acad\micro\pen\tbl\dot.tbl P:\acad\micro\pen\tbl\dot.tbl P:\acad\micro\pen\tbl\dot.tbl