

FOR SIDEWALK REPLACEMENT AND CURB AND GUTTER REPLACEMENT LOCATIONS SEE SHEET 11.

FOR TYPICAL PAVEMENT MARKINGS SEE SHEET 13.

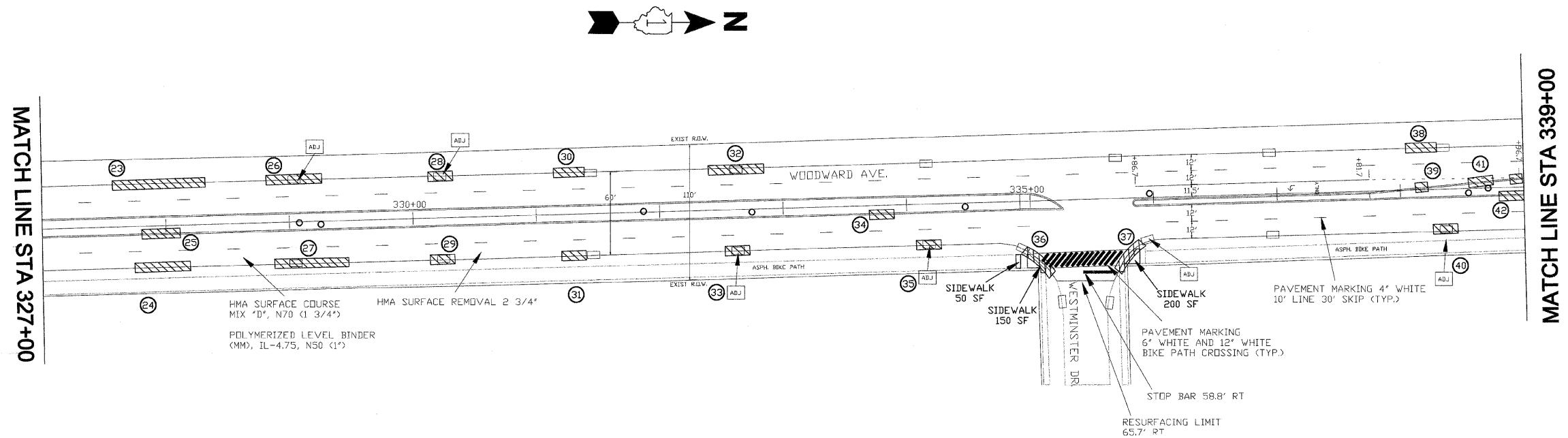

VILLAGE OF WOODRIDGE  
DEPARTMENT OF PUBLIC WORKS  
1 Plaza Drive, Woodridge IL 60517 (630) 778-0700

DESIGNED - AF  
DRAWN - AF  
CHECKED - JDS  
DATE - 1/24/2012

REVISED 3/20/2012

STATE OF ILLINOIS  
DEPARTMENT OF TRANSPORTATION

RESURFACING PLAN AND  
PAVEMENT MARKING PLAN

SCALE: 1" = 50' STA. 314+00 TO STA. 339+00

F.A.P. RTE.	SECTION	COUNTY	TOTAL SHEETS	SHEET NO.
2593	12-00069-00-RS	DUPAGE	16	7
ILLINOIS			CONTRACT NO. 63703	
			FEDERAL AID PROJECT	