

FOR SIDEWALK REPLACEMENT AND CURB AND GUTTER REPLACEMENT LOCATIONS SEE SHEET 11.

FOR TYPICAL PAVEMENT MARKINGS SEE SHEET 13.

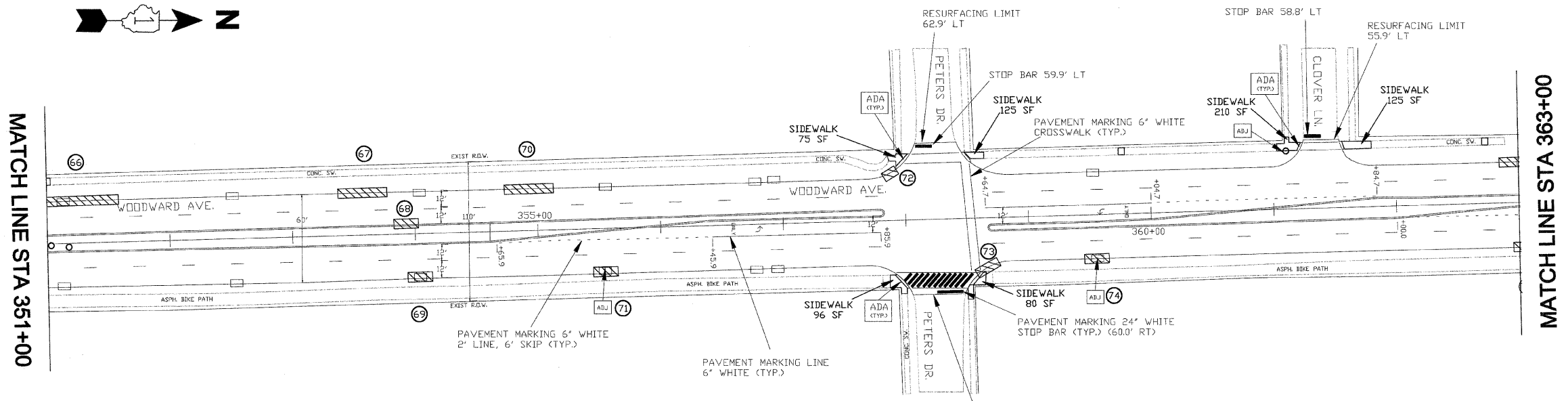

CONTRACT 63703

VILLAGE OF WOODRIDGE
DEPARTMENT OF PUBLIC WORKS
1 Plaza Drive, Woodridge IL 60517

DESIGNED - AF
DRAWN - AF
CHECKED - JDS
DATE - 1/24/2012

REVISED 3/20/2012

STATE OF ILLINOIS
DEPARTMENT OF TRANSPORTATION

RESURFACING PLAN AND
PAVEMENT MARKING PLAN

SCALE: 1" = 50' STA. 339+00 TO STA. 363+00

F.A.P. RTE.	SECTION	COUNTY	TOTAL SHEETS	SHEET NO.
2593	12-00069-00-RS	DUPAGE	16	8
ILLINOIS			CONTRACT NO. 63703 FEDERAL AID PROJECT	