

06-15-12 LETTING ITEM 144

CONTRACT 63703

HIGHWAY STANDARDS, SEE SHEET NO. 2

INDEX OF SHEETS	
SHEET #	DESCRIPTION
1	TITLE
2	GENERAL NOTES AND STANDARDS
3	SUMMARY OF QUANTITIES
4	TYPICAL CROSS SECTIONS
5	TYPICAL CROSS SECTIONS
6-9	RESURFACING AND PAVEMENT MARKING PLANS
10	WOODWARD AVENUE/BOUGHTON ROAD DETECTOR LOOP PLAN
11	SCHEDULES
12	TC 10 TRAFFIC CONTROL AND PROTECTION FOR SIDE ROADS, INTERSECTIONS, AND DRIVEWAYS (DISTRICT 1)
13	TC 13 TYPICAL PAVEMENT MARKINGS (DISTRICT 1)
14	BD 24 CURB OR CURB AND GUTTER REMOVAL AND REPLACEMENT (DISTRICT 1)
15	BD 32 BUTT JOINT AND HMA TAPER DETAILS (DISTRICT 1)
16	TS 07 DETECTOR LOOP INSTALLATION DETAILS FOR ROADWAY RESURFACING (DISTRICT 1)

PROJECT IS LOCATED IN THE VILLAGE OF WOODRIDGE

TRAFFIC INFORMATION	
CLASSIFICATION	URBAN COLLECTOR
DESIGN SPEED =	45 MPH
POSTED SPEED =	40 MPH
ADT (2010) =	14,000

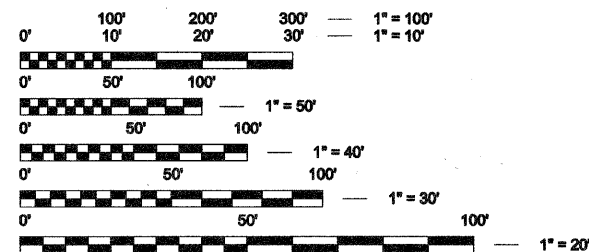

FULL SIZE PLANS HAVE BEEN PREPARED USING STANDARD ENGINEERING SCALES. REDUCED SIZED PLANS WILL NOT CONFORM TO STANDARD SCALES. IN MAKING MEASUREMENTS ON REDUCED PLANS, THE ABOVE SCALES MAY BE USED.

PLANS PREPARED BY:  
**VILLAGE OF WOODRIDGE**  
**DEPARTMENT OF PUBLIC WORKS**

J.U.L.I.E  
 JOINT UTILITY LOCATION INFORMATION FOR EXCAVATION  
 1-800-892-0123 OR 811

CONTRACT 63703

STATE OF ILLINOIS  
 DEPARTMENT OF TRANSPORTATION  
 DIVISION OF HIGHWAYS  
**PLANS FOR PROPOSED  
 FEDERAL AID HIGHWAY**  
**FAU ROUTE 2593 (WOODWARD AVENUE)  
 INTERSTATE 55 BRIDGE TO BOUGHTON ROAD  
 RESURFACING**  
**SECTION: 12-00069-00-RS**  
**PROJECT NO: M-9003(970)**  
**VILLAGE OF WOODRIDGE**  
**DUPAGE COUNTY**  
**JOB NO:C-91-267-12**

PROJECT ENDS  
 STA. 372+91

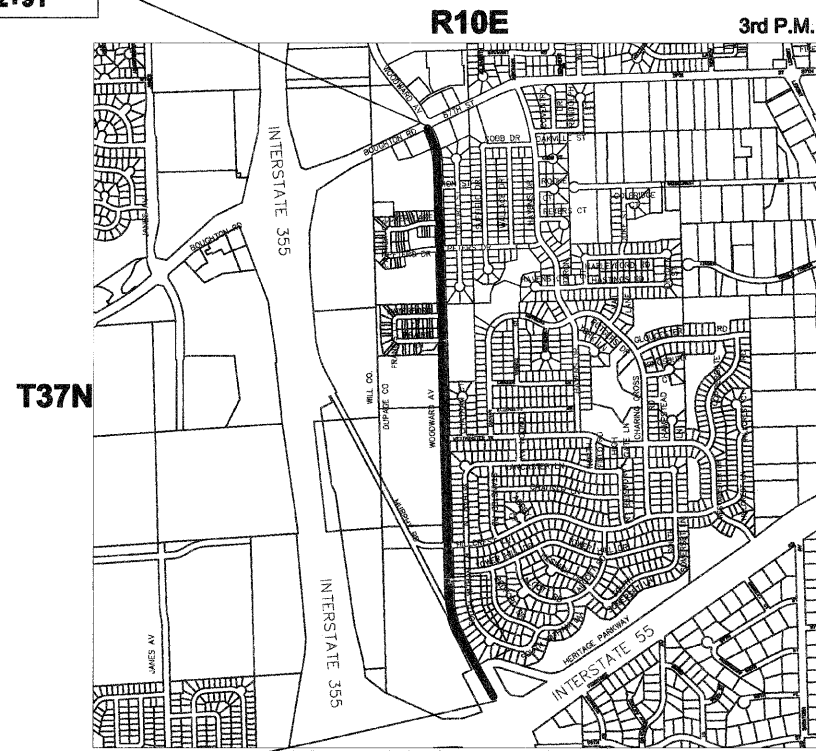

PROJECT BEGINS  
 STA. 301+00

LOCATION MAP IS NOT TO SCALE

GROSS AND NET LENGTH =  
 7,191 FEET (1.36 MI)



LOCATION OF SECTION INDICATED THUS

STATE OF ILLINOIS  
 DEPARTMENT OF TRANSPORTATION  
 DIVISION OF HIGHWAYS

Approved 03/16/12, 2012

*C. Be*  
 VILLAGE OF WOODRIDGE, DIRECTOR OF PUBLIC WORKS

Passed APRIL 2, 2012

*C. Holt*  
 DISTRICT 1 ENGINEER OF LOCAL ROADS AND STREETS

Released for Bid  
 Based on Limited  
 Review APRIL 2, 2012

*Diane M. O'Keefe*  
 DEPUTY DIRECTOR OF HIGHWAYS, REGION 1 ENGINEER



*Joshua D. Strait*  
 ILLINOIS LICENSED PROFESSIONAL ENGINEER NO. 062-060441  
 LICENSE VALID THROUGH NOVEMBER 30, 2013

PRINTED BY THE AUTHORITY  
 OF THE STATE OF ILLINOIS

COUNTY	SECTION	TOTAL SHEETS	SHEET #
DUPAGE	12-00069-00-RS	16	1

PROGRAM AND OFFICE ENGINEER: CHARLES F. RIDDLE, P.E. 847-705-4406 SCHAUMBURG, IL

# GENERAL NOTES

CONTRACT 63703

**SPECIFICATIONS, STANDARDS AND SPECIAL PROVISIONS:**  
 ALL CONSTRUCTION SHALL BE PERFORMED IN ACCORDANCE WITH THE ILLINOIS DEPARTMENT OF TRANSPORTATION "STANDARD SPECIFICATIONS FOR ROAD AND BRIDGE CONSTRUCTION", ADOPTED JANUARY 1, 2012 (HEREINAFTER REFERRED TO AS THE STANDARD SPECIFICATIONS); THE "SUPPLEMENTAL SPECIFICATIONS AND RECURRING SPECIAL PROVISIONS ", ADOPTED JANUARY 1, 2012; THE LATEST EDITION OF THE "ILLINOIS MANUAL ON UNIFORM TRAFFIC CONTROL DEVICES FOR STREETS, THE "DETAILS" ON THE PLANS AND THE "SPECIAL PROVISIONS" INCLUDED IN THE CONTRACT DOCUMENTS. ANY REFERENCE TO STANDARDS THROUGHOUT THE PLANS OR SPECIAL PROVISIONS SHALL BE INTERPRETED AS THE LATEST STANDARD OF THE ILLINOIS DEPARTMENT OF TRANSPORTATION.

**PROJECT START:**  
 ON SUNDAY, AUGUST 19, 2012 THE ROTARY CLUB OF WOODRIDGE WILL BE HOSTING ITS ANNUAL TRIATHLON WHICH WILL TAKE PLACE WITHIN THE LIMITS OF CONSTRUCTION OF THIS PROJECT. IT SHALL BE A REQUIREMENT OF THE CONTRACT THAT NO WORK BEGIN ON THIS PROJECT UNTIL MONDAY AUGUST 20, 2012 AT THE EARLIEST.

**PROJECT COORDINATION:**  
 THE CONTRACTOR SHALL NOTIFY THE VILLAGE OF WOODRIDGE AT 630-719-4753 AT LEAST 72 HOURS IN ADVANCE OF BEGINNING WORK AND SHALL COORDINATE ALL CONSTRUCTION OPERATIONS WITH THE ENGINEER. ATTENTION IS CALLED TO SECTION 701 OF THE STANDARD SPECIFICATIONS AND THE SPECIAL PROVISIONS FOR TRAFFIC CONTROL AND PROTECTION. THE STORAGE OF EQUIPMENT AND/OR MATERIALS WITHIN THE RIGHT-OF-WAY OF ANY STREET AND/OR PARK PROPERTY SHALL REQUIRE PRIOR APPROVAL OF THE ENGINEER.

**SAFETY:**  
 ALL CONSTRUCTION PERSONNEL WILL BE REQUIRED TO WEAR FLORESCENT ORANGE, FLUORESCENT YELLOW/GREEN, OR A COMBINATION OF FLORESCENT ORANGE AND FLUORESCENT GREEN/YELLOW SAFETY VESTS MEETING THE REQUIREMENTS OF THE STANDARDS INSTITUTE SPECIFICATION ANSI/ISEA 107-1999 FOR THE CONSPICUITY CLASS 2 GARMENTS AT ALL TIMES WHILE ON THE CONSTRUCTION SITE.

**TRAFFIC CONTROL AND MAINTENANCE:**  
 THE CONTRACTOR SHALL SCHEDULE HIS WORK SO THAT ONLY ONE TEMPORARY LANE CLOSURE ON ONE STREET IN ONE DIRECTION IS IMPLEMENTED AT A TIME. A LANE CLOSURE WILL ONLY BE PERMITTED DURING CONSTRUCTION OPERATIONS AND IN ACCORDANCE WITH THE APPLICABLE IDOT STANDARDS. THE CONTRACTOR SHALL FURNISH, ERECT, AND MAINTAIN ALL SIGNS, BARRICADES AND OTHER TRAFFIC CONTROL DEVICES, INCLUDING FLAGGERS, REQUIRED TO MAINTAIN TRAFFIC FLOW.

**SAW CUTTING FOR REMOVAL:**  
 THE CONTRACTOR SHALL MAKE ALL FULL DEPTH SAW CUT AT THE EDGE OF PAVEMENT ADJACENT TO THE REMOVAL OF ALL CONCRETE CURB OR COMBINATION CONCRETE CURB AND GUTTER. THE CONTRACTOR SHALL MAKE ALL FULL DEPTH SAW CUTS REQUIRED FOR THE REMOVAL OF CONCRETE CURB AND GUTTERS, SIDEWALKS, AND DRIVEWAYS AS SPECIFIED, OR AS DIRECTED BY THE ENGINEER. THE COST SHALL BE CONSIDERED INCLUDED IN THE COST FOR REMOVAL OF THE SPECIFIED ITEM IN THE CONTRACT.

**BASE COURSE CLEANING:**  
 PRIOR TO APPLYING THE HOT-MIX ASPHALT PRIME COAT, THE BASE SURFACE INCLUDING GUTTERS SHALL BE CLEANED OF LOOSE GRINDINGS, LEAVES, OF ALL DUST, DIRT, WEEDS AND OTHER FOREIGN MATERIALS. ALL CRACK FILL MATERIAL SHALL BE REMOVED IN ITS ENTIRETY ALONG THE CURB LINE. COST TO BE CONSIDERED INCLUDED IN THE COST OF THE HOT-MIX ASPHALT SURFACE WORK.

**CLEAN-UP AND DISPOSAL:**  
 THE CONTRACTOR SHALL MAINTAIN THE SITE IN A CLEAN AND ORDERLY MANNER. DEBRIS AND ANY SURPLUS MATERIAL SHALL BE REMOVED AND RESTORATION SHALL PROCEED AS THE WORK PROCEEDS. IF THE ENGINEER SO DIRECTS, THE CONTRACTOR SHALL STOP ALL OTHER WORK AND CONCENTRATE ON CLEAN-UP AND RESTORATION. DEBRIS AND SURPLUS MATERIAL SHALL BE DISPOSED OF BY THE CONTRACTOR OFF-SITE.

**CONSTRUCTION LIMITS:**  
 THE CONTRACTOR SHALL CONFINE OPERATIONS WITHIN THE CONSTRUCTION LIMITS OF THE PROJECT. ANY DAMAGE INSIDE AND OUTSIDE OF SAID CONSTRUCTION LIMITS SHALL BE REPAIRED AT THE CONTRACTOR'S EXPENSE.

**PROPERTY ACCESS:**  
 DURING CONSTRUCTION, ALL SIGNS, BARRICADES, AND TEMPORARY PAVEMENT MARKINGS SHALL CONFORM TO THE ILLINOIS MUTCD. VEHICULAR ACCESS TO LOCAL PROPERTIES WILL BE MAINTAINED AT ALL TIMES DURING CONSTRUCTION, EXCEPT WHEN CONSTRUCTION OPERATIONS OCCUR DIRECTLY ON OR IN FRONT OF DRIVEWAYS. IN THIS CASE, FLAG PERSONS WILL BE USED TO DIRECT AND CONTROL TRAFFIC.

**WATER SUPPLY/USEAGE:**  
 THE INDEPENDENT USE OF PRIVATE WATER SPIGOTS IS STRICTLY PROHIBITED. THE CONTRACTOR SHALL BE RESPONSIBLE FOR OBTAINING WATER FROM AN APPROVED SOURCE (FIRE HYDRANT). IT SHALL BE THE CONTRACTOR'S RESPONSIBILITY TO OBTAIN A WATER (HYDRANT) METER FROM THE VILLAGE OF WOODRIDGE FOR THE PURPOSES OF TRACKING WATER USAGE.

HIGHWAY STANDARDS	
STANDARD #	DESCRIPTION
000001-06	STANDARD SYMBOLS, ABBREVIATIONS AND PATTERNS
424001-06	CURB RAMPS FOR SIDEWALKS
424006	DIAGONAL CURB RAMPS
442201-03	CLASS D PATCHES
606001-04	CONCRETE CURB TYPE B AND COMBINATION CONCRETE CURB AND GUTTER
701006-03	OFF-ROAD OPERATIONS 2L, 2W, 15' TO 24' FROM PAVEMENT EDGE
701011-02	OFF-ROAD MOVING OPERATIONS, 2L, 2W, DAY ONLY
701601-07	URBAN LANE CLOSURE, MULTILANE, 1W OR 2W WITH NONTRAVERSABLE MEDIAN
701701-08	URBAN LANE CLOSURE MULTILANE INTERSECTION
701801-05	LANE CLOSURE MULTILANE 1W OR 2W CROSSWALK OR SIDEWALK CLOSURE
701901-02	TRAFFIC CONTROL DEVICES
780001-03	TYPICAL PAVEMENT MARKINGS
886001-01	DETECTOR LOOP INSTALLATIONS
886006-01	TYPICAL LAYOUTS FOR DETECTION LOOPS

**VILLAGE OF WOODRIDGE**  
 DEPARTMENT OF PUBLIC WORKS  
 1 Plaza Drive, Woodridge IL 60517 (630) 719-4753

DESIGNED - AF	REVISED 3/20/2012
DRAWN - AF	
CHECKED - JDS	
DATE - 1/24/2012	

**STATE OF ILLINOIS**  
 DEPARTMENT OF TRANSPORTATION

**GENERAL NOTES**  
 AND STANDARDS

SCALE: NONE    STA.    TO STA.

F.A.P RTE.	SECTION	COUNTY	TOTAL SHEETS	SHEET NO.
2593	12-00069-00-RS	DUPAGE	16	2
ILLINOIS			CONTRACT NO. 63703 FEDERAL AID PROJECT	

# SUMMARY OF QUANTITIES

**CONTRACT 63703**

CODE NO	ITEM	UNIT	TOTAL QUANTITY
			CONSTRUCTION CODE 0005
21101615	TOPSOIL FURNISH AND PLACE, 4"	SQ YD	500
25000110	SEEDING, CLASS 1A	ACRE	0.15
25000400	NITROGEN FERTILIZER NUTRIENT	POUND	20
25000500	PHOSPHORUS FERTILIZER NUTRIENT	POUND	20
25000600	POTASSIUM FERTILIZER NUTRIENT	POUND	20
25100630	EROSION CONTROL BLANKET	SQ YD	500
40600100	BITUMINOUS MATERIALS (PRIME COAT)	GALLON	9909
40600300	AGGREGATE (PRIME COAT)	TON	150
40600400	MIXTURE FOR CRACKS, JOINTS, AND FLANGEWAYS	TON	40
40600827	POLYMERIZED LEVELING BINDER (MACHINE METHOD), IL-4.75, N50	TON	2775
40600895	CONSTRUCTING TEST STRIP	EACH	2
40600982	HOT-MIX ASPHALT SURFACE REMOVAL - BUTT JOINT	SQ YD	593
40603340	HOT-MIX ASPHALT SURFACE COURSE, MIX "D", N70	TON	4856
42400200	PORTLAND CEMENT CONCRETE SIDEWALK 5 INCH	SQ FT	2151
42400800	DETECTABLE WARNINGS	SQ FT	224
44000160	HOT-MIX ASPHALT SURFACE REMOVAL, 2 3/4"	SQ YD	49547
44000500	COMBINATION CURB AND GUTTER REMOVAL	FOOT	2095
44000600	SIDEWALK REMOVAL	SQ FT	2151
44201705	CLASS D PATCHES, TYPE II, 5 INCH	SQ YD	100
44201709	CLASS D PATCHES, TYPE III, 5 INCH	SQ YD	310
44201711	CLASS D PATCHES, TYPE IV, 5 INCH	SQ YD	800
60255500	MANHOLES TO BE ADJUSTED	EACH	2

CODE NO	ITEM	UNIT	TOTAL QUANTITY
			CONSTRUCTION CODE 0005
60260100	INLETS TO BE ADJUSTED	EACH	20
60603800	COMBINATION CONCRETE CURB AND GUTTER, TYPE B-6.12	FOOT	242
60604400	COMBINATION CONCRETE CURB AND GUTTER, TYPE B-6.18	FOOT	250
60605000	COMBINATION CONCRETE CURB AND GUTTER, TYPE B-6.24	FOOT	1603
67100100	MOBILIZATION	L SUM	1
70102630	TRAFFIC CONTROL AND PROTECTION, STANDARD 701601	L SUM	1
70102635	TRAFFIC CONTROL AND PROTECTION, STANDARD 701701	L SUM	1
70102640	TRAFFIC CONTROL AND PROTECTION, STANDARD 701801	L SUM	1
70106800	CHANGEABLE MESSAGE SIGN	CAL MO	2
70300100	SHORT TERM PAVEMENT MARKING	FOOT	1000
70300210	TEMPORARY PAVEMENT MARKING LETTERS AND SYMBOLS	SQ FT	1440
70300220	TEMPORARY PAVEMENT MARKING - LINE 4"	FOOT	8000
70300280	TEMPORARY PAVEMENT MARKING - LINE 24"	FOOT	780
70301000	WORK ZONE PAVEMENT MARKING REMOVAL	SQ FT	500
* 78000100	THERMOPLASTIC PAVEMENT MARKING - LETTERS AND SYMBOLS	SQ FT	480
* 78000200	THERMOPLASTIC PAVEMENT MARKING - LINE 4"	FOOT	18482
* 78000400	THERMOPLASTIC PAVEMENT MARKING - LINE 6"	FOOT	3350
* 78000600	THERMOPLASTIC PAVEMENT MARKING - LINE 12"	FOOT	954
* 78000650	THERMOPLASTIC PAVEMENT MARKING - LINE 24"	FOOT	260
* 88600600	DETECTOR LOOP REPLACEMENT	FOOT	632

\* INDICATES SPECIALTY ITEM

<b>VILLAGE OF WOODRIDGE</b> DEPARTMENT OF PUBLIC WORKS 1 Plaza Drive, Woodridge IL 60517	DESIGNED - AF	REVISED 3/20/2012	<b>STATE OF ILLINOIS</b> DEPARTMENT OF TRANSPORTATION	<b>SUMMARY OF</b> <b>QUANTITIES</b>	F.A.P RTE.	SECTION	COUNTY	TOTAL SHEETS	SHEET NO.
	DRAWN - AF				2583	12-00069-00-RS	DUPAGE	18	3
	CHECKED - JDS								
	DATE - 1/24/2012			SCALE: NONE	STA.	TO STA.	ILLINOIS	FEDERAL AID PROJECT	

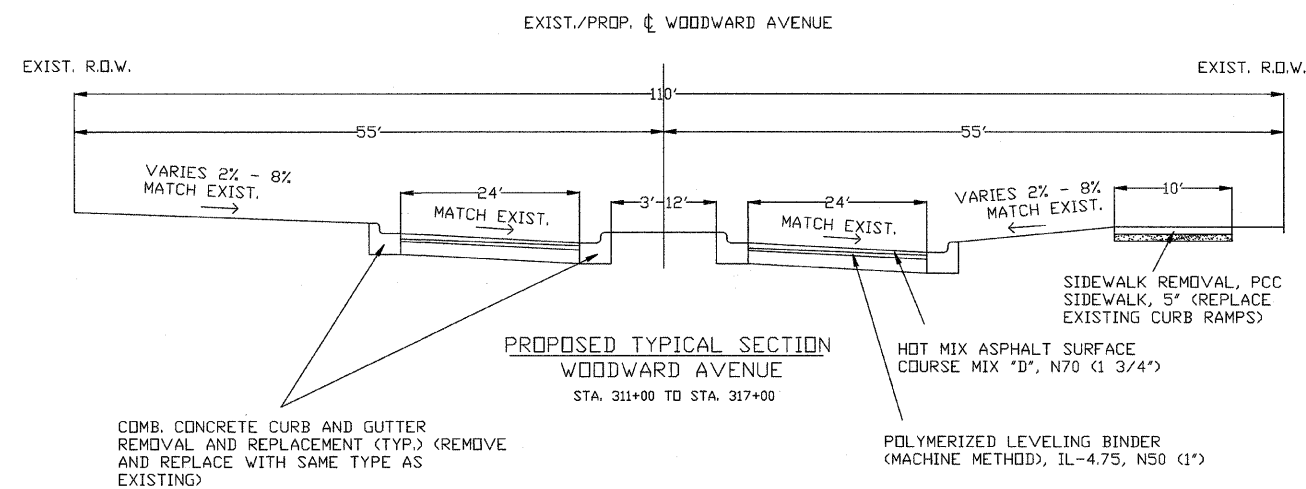
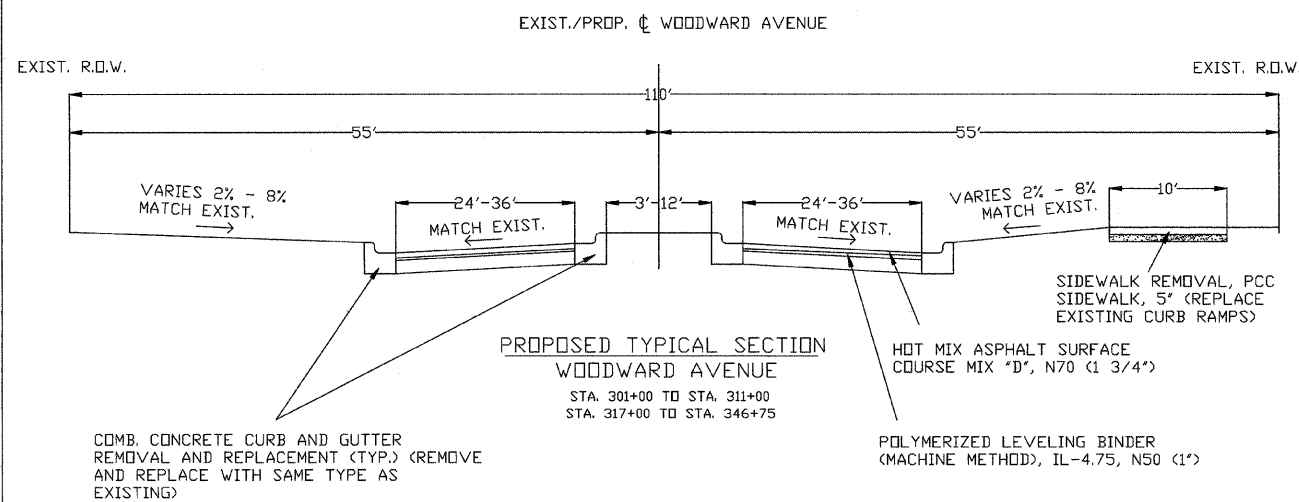
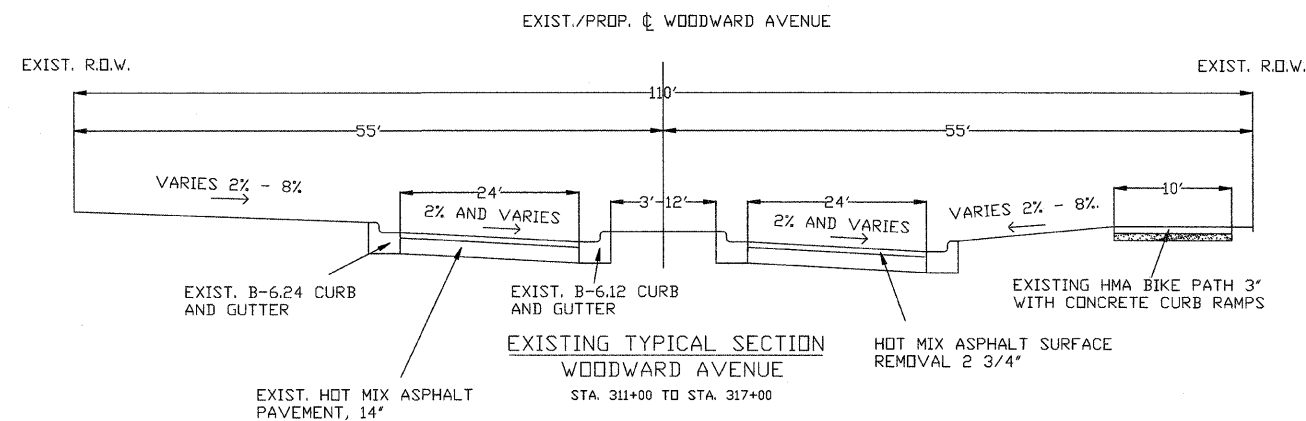
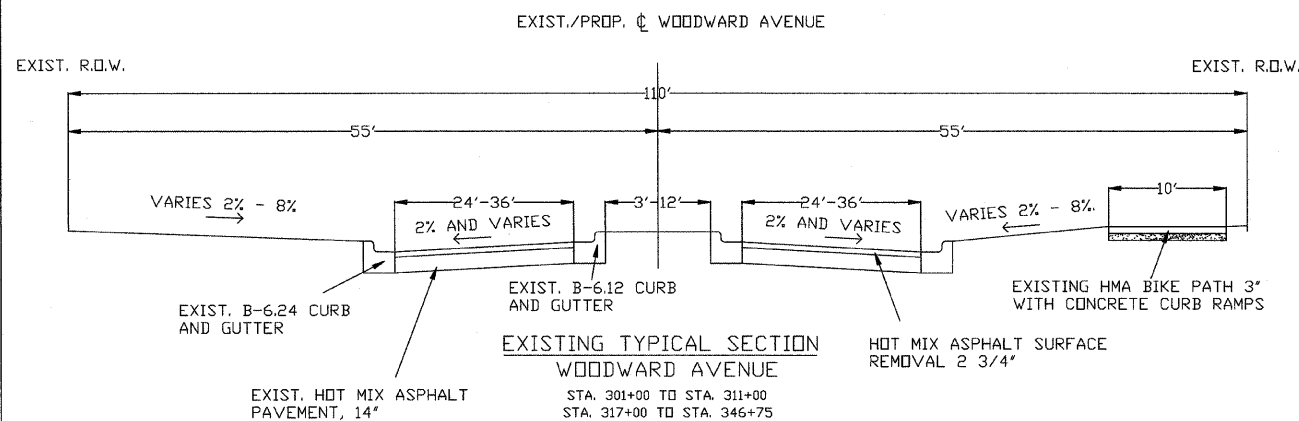

**NOTE:**  
MILLING TO BE DONE  
PRIOR TO PATCHING.

**CROSS SECTIONS ARE NOT TO SCALE**

<b>VILLAGE OF WOODRIDGE</b> <b>DEPARTMENT OF PUBLIC WORKS</b> 1 Plaza Drive, Woodridge IL 60517	DESIGNED - AF	REVISED 3/20/2012	<b>STATE OF ILLINOIS</b> <b>DEPARTMENT OF TRANSPORTATION</b>	<b>TYPICAL CROSS SECTIONS</b>	F.A.P. RTE.	SECTION	COUNTY	TOTAL SHEETS	SHEET NO.
	DRAWN - AF				2593	12-00069-00-RS	DUPAGE	16	4
	CHECKED - JDS						ILLINOIS		
	DATE - 1/24/2012					SCALE: NONE	STA. 301+00 TO STA. 346+75		

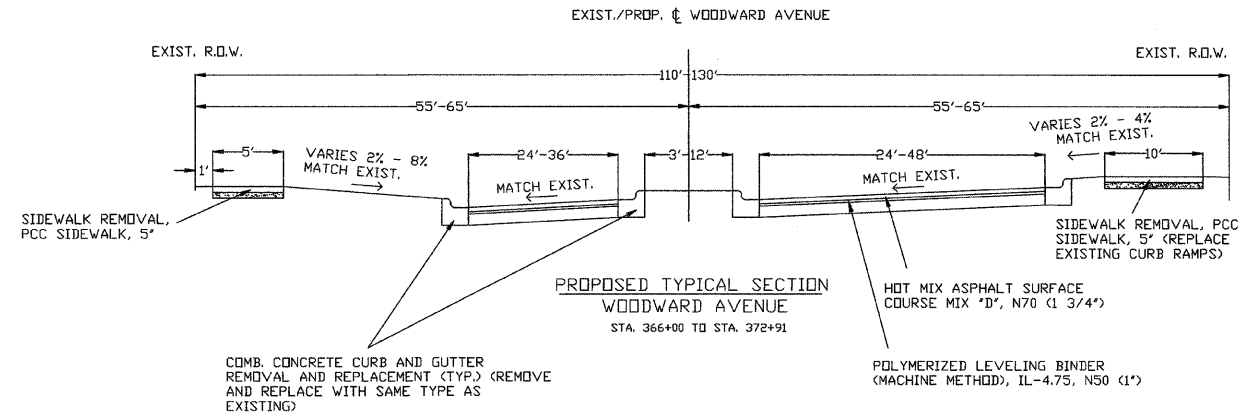
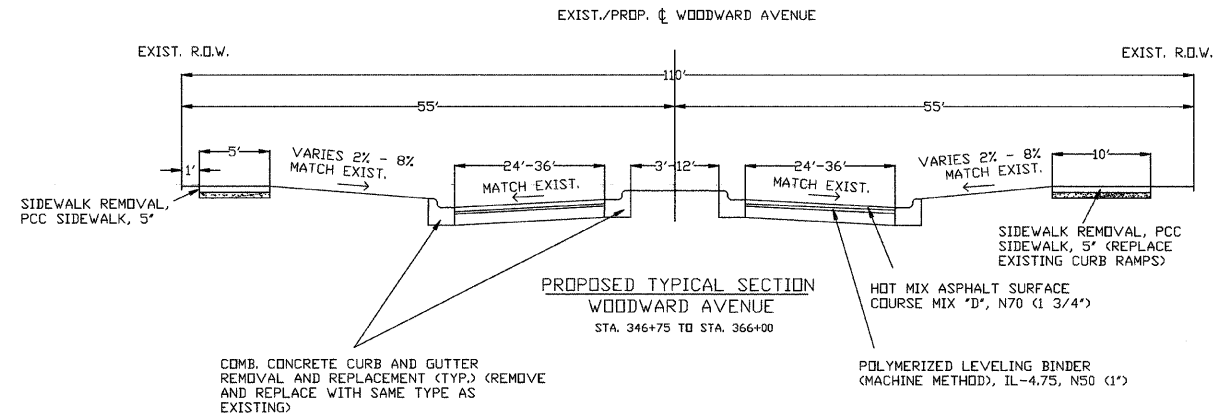
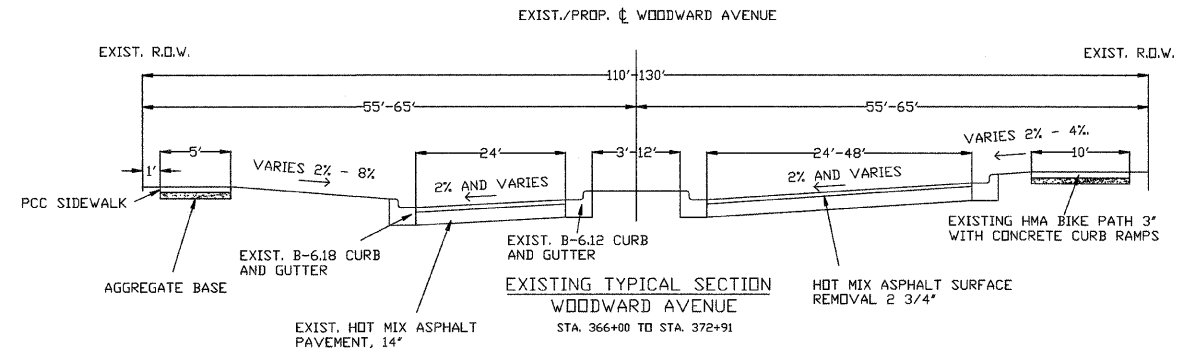
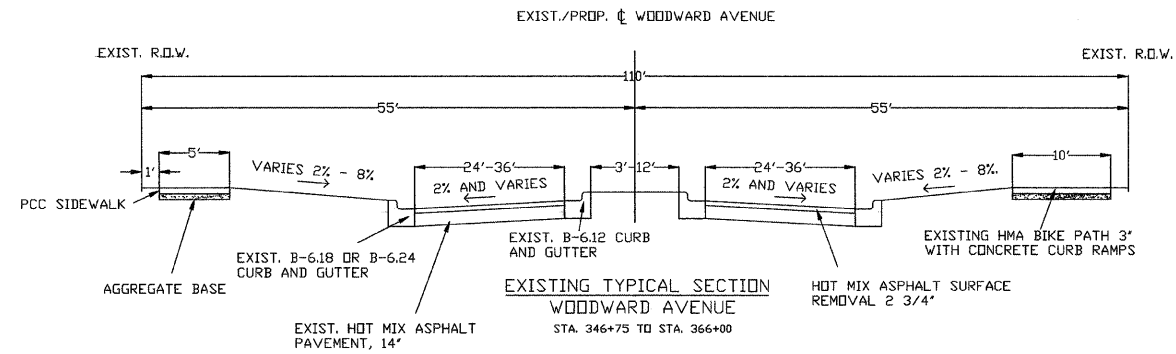

**NOTE:**  
MILLING TO BE DONE  
PRIOR TO PATCHING.

**CROSS SECTIONS ARE NOT TO SCALE**

VILLAGE OF WOODRIDGE  
DEPARTMENT OF PUBLIC WORKS  
1 Plaza Drive, Woodridge IL 60517 (815) 710-0700

DESIGNED - AF  
DRAWN - AF  
CHECKED - JDS  
DATE - 1/24/2012

REVISED 3/20/2012

STATE OF ILLINOIS  
DEPARTMENT OF TRANSPORTATION

TYPICAL CROSS SECTIONS

SCALE: NONE STA. 346+75 TO STA. 372+91

F.A.P. RTE.	SECTION	COUNTY	TOTAL SHEETS	SHEET NO.
2593	12-00069-00-RS	DUPAGE	16	5
ILLINOIS			CONTRACT NO. 63703	
			FEDERAL AID PROJECT	



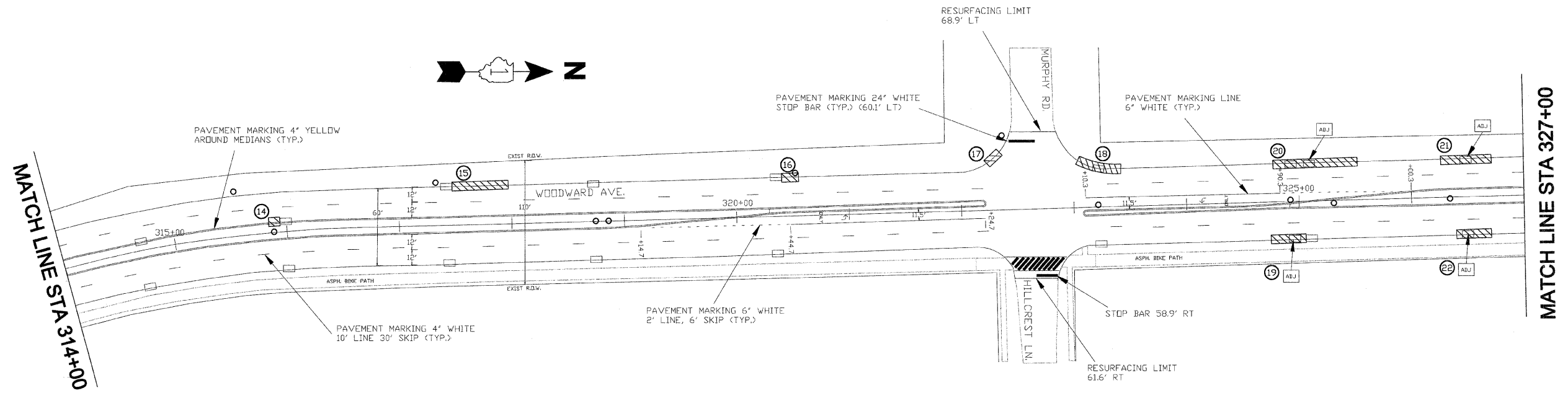

FOR SIDEWALK REPLACEMENT AND CURB AND GUTTER REPLACEMENT LOCATIONS SEE SHEET 11.

FOR TYPICAL PAVEMENT MARKINGS SEE SHEET 13.

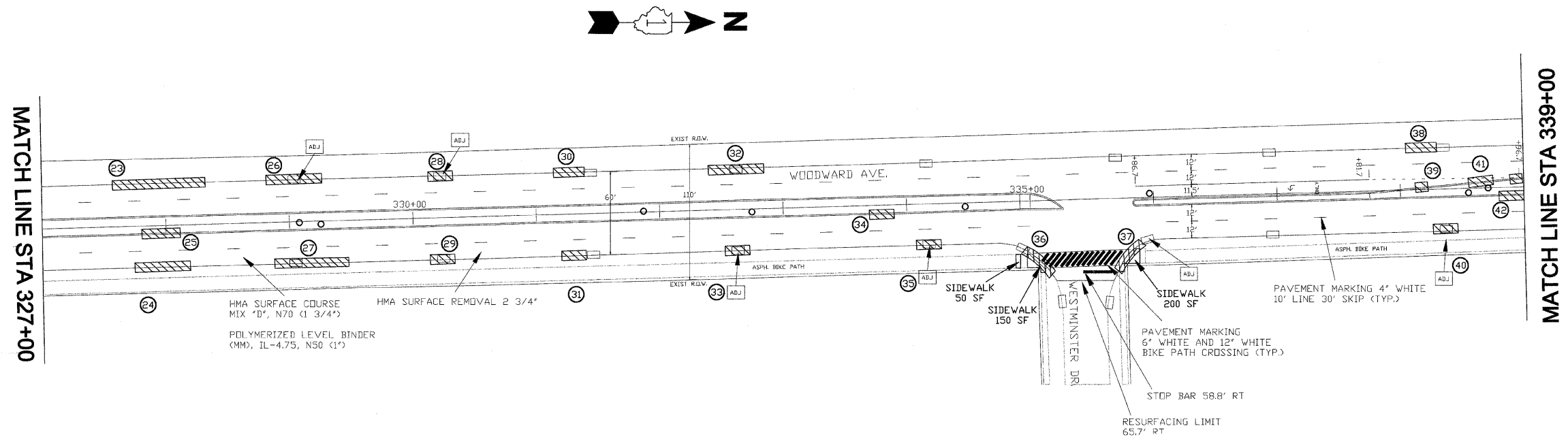

VILLAGE OF WOODRIDGE  
DEPARTMENT OF PUBLIC WORKS  
1 Plaza Drive, Woodridge IL 60517 (630) 778-0700

DESIGNED - AF  
DRAWN - AF  
CHECKED - JDS  
DATE - 1/24/2012

REVISED 3/20/2012

STATE OF ILLINOIS  
DEPARTMENT OF TRANSPORTATION

RESURFACING PLAN AND  
PAVEMENT MARKING PLAN

SCALE: 1" = 50' STA. 314+00 TO STA. 339+00

F.A.P. RTE.	SECTION	COUNTY	TOTAL SHEETS	SHEET NO.
2593	12-00069-00-RS	DUPAGE	16	7
ILLINOIS			CONTRACT NO. 63703	
			FEDERAL AID PROJECT	



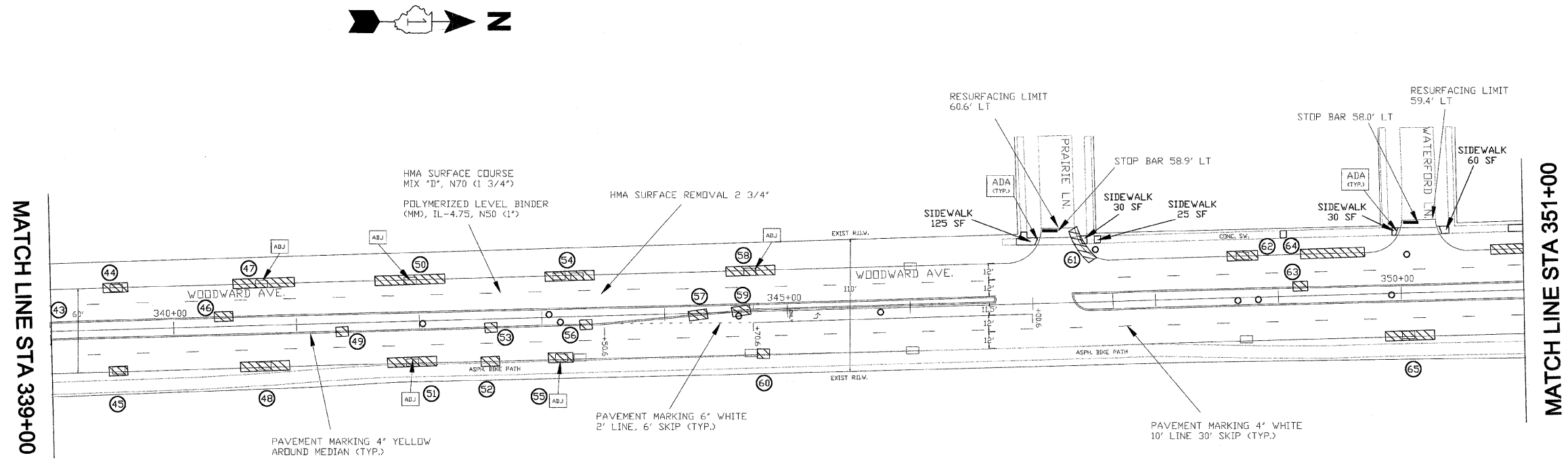

FOR SIDEWALK REPLACEMENT AND CURB AND GUTTER REPLACEMENT LOCATIONS SEE SHEET 11.

FOR TYPICAL PAVEMENT MARKINGS SEE SHEET 13.

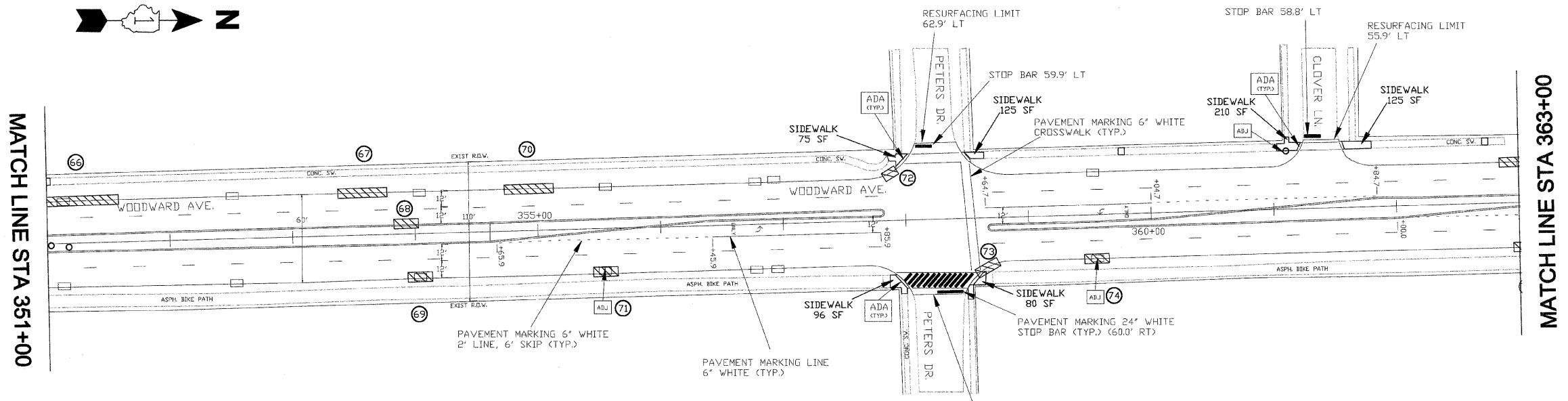

**CONTRACT 63703**

VILLAGE OF WOODRIDGE  
DEPARTMENT OF PUBLIC WORKS  
1 Plaza Drive, Woodridge IL 60517

DESIGNED - AF  
DRAWN - AF  
CHECKED - JDS  
DATE - 1/24/2012

REVISED 3/20/2012

STATE OF ILLINOIS  
DEPARTMENT OF TRANSPORTATION

RESURFACING PLAN AND  
PAVEMENT MARKING PLAN

SCALE: 1" = 50' STA. 339+00 TO STA. 363+00

F.A.P. RTE.	SECTION	COUNTY	TOTAL SHEETS	SHEET NO.
2593	12-00069-00-RS	DUPAGE	16	8
ILLINOIS			CONTRACT NO. 63703 FEDERAL AID PROJECT	



FOR SIDEWALK REPLACEMENT AND  
CURB AND GUTTER REPLACEMENT  
LOCATIONS SEE SHEET 11.

FOR TYPICAL PAVEMENT MARKINGS SEE  
SHEET 13.

**CONTRACT 63703**

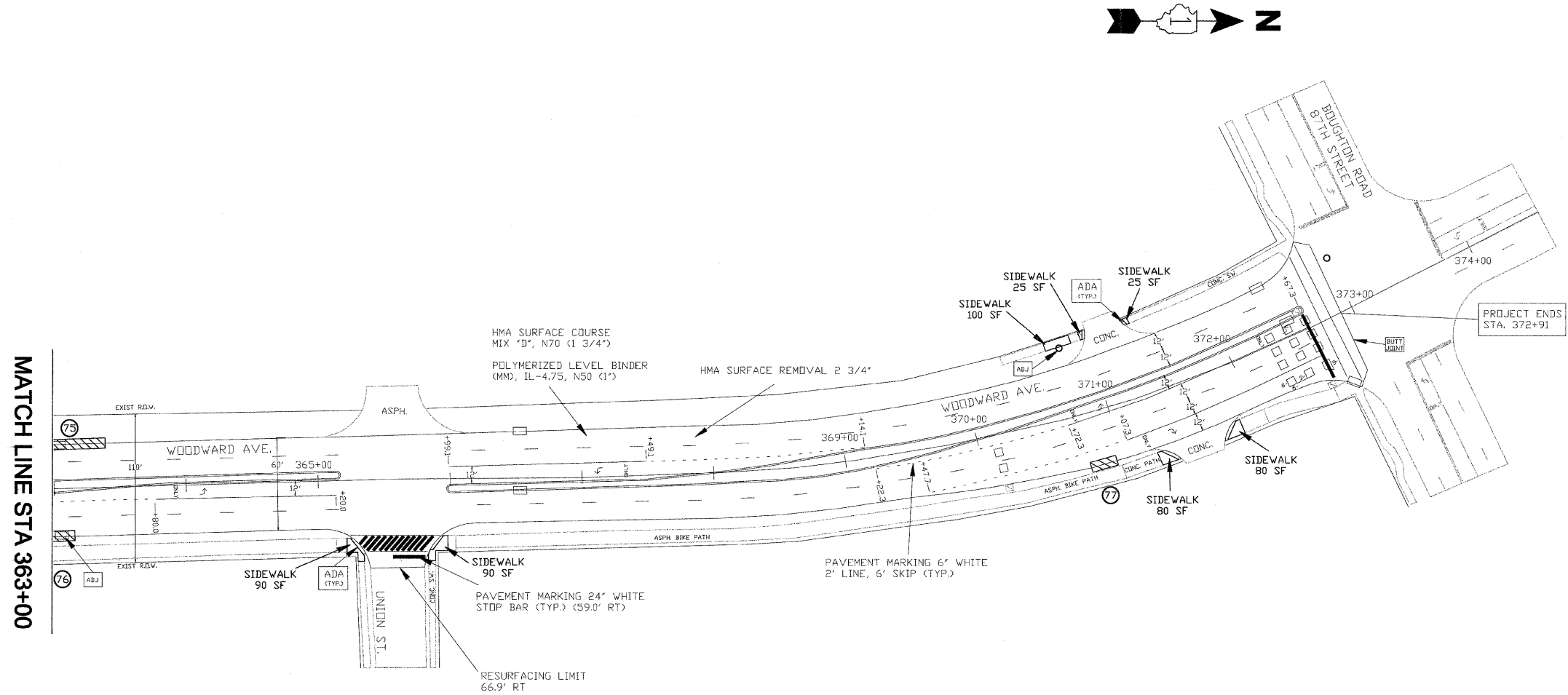

MATCH LINE STA 363+00

**VILLAGE OF WOODRIDGE**  
DEPARTMENT OF PUBLIC WORKS  
1 Plaza Drive, Woodridge IL 60517 (630) 778-0700

DESIGNED - AF	REVISED 3/20/2012
DRAWN - AF	
CHECKED - JDS	
DATE - 1/24/2012	

**STATE OF ILLINOIS**  
**DEPARTMENT OF TRANSPORTATION**

**RESURFACING PLAN AND  
PAVEMENT MARKING PLAN**  
SCALE: 1" = 50' STA. 363+00 TO STA. 372+91

F.A.P. RTE.	SECTION	COUNTY	TOTAL SHEETS	SHEET NO.
2593	12-00069-00-RS	DUPAGE	16	9
ILLINOIS			CONTRACT NO. 63703 FEDERAL AID PROJECT	



DETECTOR LOOPS SHALL BE INSTALLED  
AFTER BINDER IS INSTALLED BUT BEFORE  
SURFACE COURSE IS INSTALLED

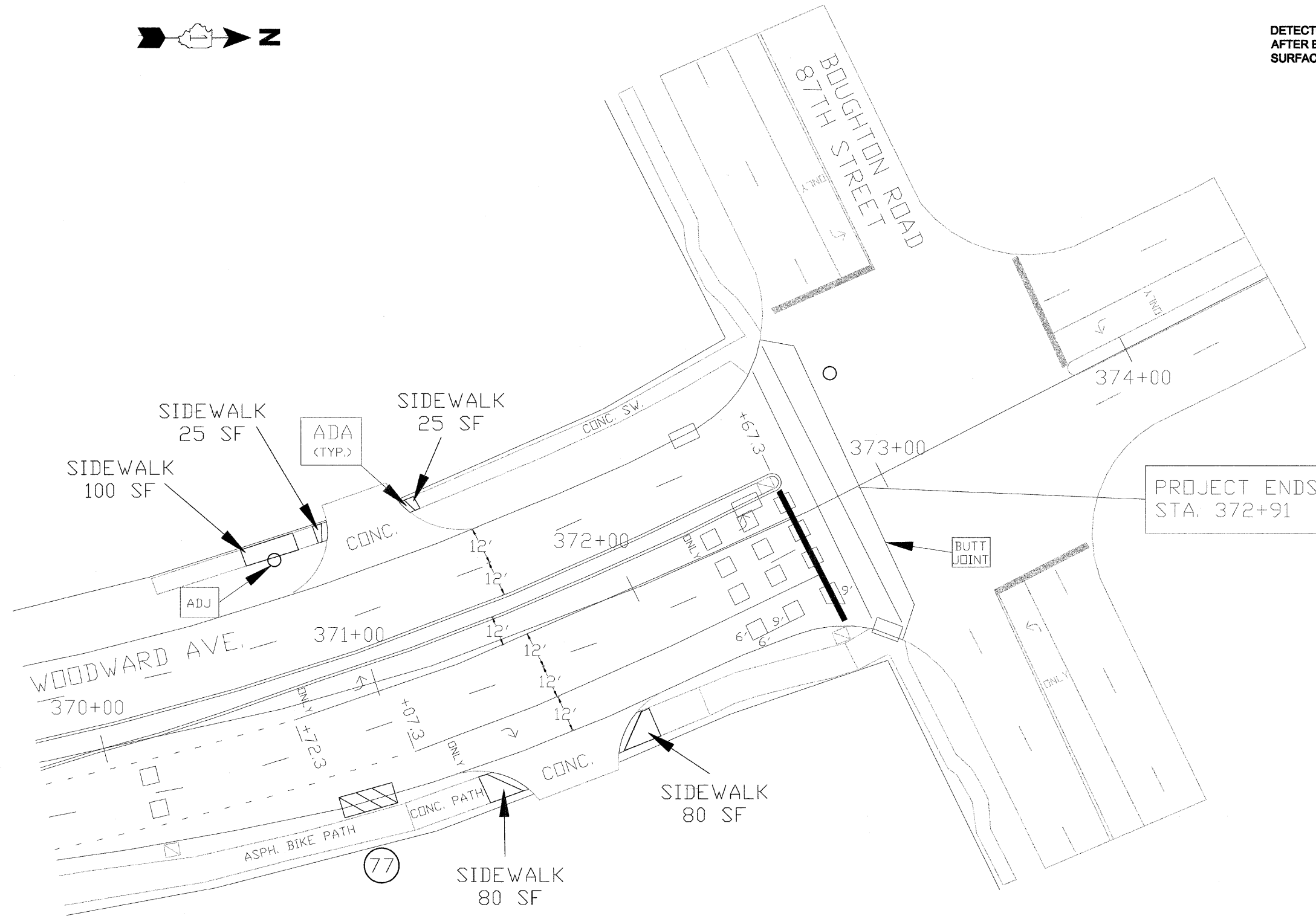

**CONTRACT 63703**

VILLAGE OF WOODRIDGE  
DEPARTMENT OF PUBLIC WORKS  
1 Plaza Drive, Woodridge IL 60517

DESIGNED - AF	REVISED 3/20/2012
DRAWN - AF	
CHECKED - JDS	
DATE - 1/24/2012	

STATE OF ILLINOIS  
DEPARTMENT OF TRANSPORTATION

WOODWARD AVENUE AND  
BOUGHTON ROAD  
DETECTOR LOOP PLAN  
SCALE: 1" = 20' STA. 369+70 TO STA. 372+91

F.A.P. RTE.	SECTION	COUNTY	TOTAL SHEETS	SHEET NO.
2593	12-00069-00-RS	DUPAGE	16	10
ILLINOIS			CONTRACT NO. 63703 FEDERAL AID PROJECT	

CURB AND GUTTER REMOVAL AND REPLACEMENT SCHEDULE						
LOC #	STA.	SIDE	60603800 COMBINATION CONCRETE CURB AND GUTTER, TYPE B-6.12 LENGTH (FT)	60604400 COMBINATION CONCRETE CURB AND GUTTER, TYPE B-6.18 LENGTH (FT)	60605000 COMBINATION CONCRETE CURB AND GUTTER, TYPE B-6.24 LENGTH (FT)	44000500 COMBINATION CURB AND GUTTER REMOVAL LENGTH (FT)
1	301+20	LT			20	20
2	307+20	LT			20	20
3	307+20	RT			25	25
4	308+20	RT			15	15
5	308+40	LT			10	10
6	309+50	LT			43	43
7	309+90	RT			20	20
8	310+45	RT			20	20
9	310+75	LT			35	35
10	311+60	RT			47	47
11	312+40	LT	25			25
12	312+40	RT			10	10
13	313+40	RT			20	20
14	315+90	LT	10			10
15	317+50	LT			50	50
16	320+50	LT			15	15
17	322+20	LT			10	10
18	323+20	LT			15	15
19	324+80	RT			31	31
20	324+85	LT			75	75
21	326+30	LT			45	45
22	326+45	RT			32	32
23	327+65	LT			70	70
24	327+80	RT			42	42
25	327+90	RT	30			30
26	328+80	LT			43	43
27	328+90	RT			60	60
28	330+15	LT			20	20
29	330+15	RT			20	20
30	331+20	LT			25	25
31	331+25	RT			20	20
32	332+40	LT			40	40
33	332+60	RT			15	15
34	333+75	RT	20			20
35	334+15	RT			15	15
36	335+00	RT			30	30
37	335+80	RT			30	30
38	338+10	LT			27	27
39	338+15	LT	10			10
40	338+40	RT			20	20
41	338+60	LT	15			15
42	338+80	RT	15			15
43	338+95	LT	10			10
44	339+55	LT			20	20
45	339+55	RT			15	15
46	340+40	LT	15			15
47	340+55	LT			50	50
48	340+55	RT			40	40
49	340+70	RT	10			10
50	341+65	LT			57	57
51	341+80	RT			40	40
52	342+50	RT			10	10
53	341+95	RT	10			10
54	343+05	LT			44	44
55	343+10	RT			20	20
56	343+40	RT	10			10
57	344+30	RT	15			15
58	344+58	LT			45	45
59	344+60	RT	15			15
60	344+70	RT			10	10
61	347+40	LT			25	25
62	348+75	LT			15	15
63	349+20	LT	12			12
64	349+25	LT			52	52
65	349+85	RT			40	40
66	350+80	LT			85	85
67	353+45	LT		45		45
68	353+85	LT	20			20
69	353+90	RT		20		20
70	354+75	LT		40		40
71	355+45	RT		15		15
72	356+90	LT		10		10
73	359+65	RT		20		20
74	359+55	RT		15		15
75	362+85	LT		55		55
76	362+90	RT		15		15
77	370+80	RT		15		15
			242	250	1603	2095
			FEET	FEET	FEET	FEET

RESURFACING LIMITS (BUTT JOINT SCHEDULE)						
STA.	SIDE	LOCATION	BUTT JOINT (MEASURED FROM CENTERLINE OF WOODWARD AVE.) (FT.)	PAVEMENT BUTT JOINT LENGTH (FT)	PAVEMENT BUTT JOINT WIDTH (FT)	40600982 HOT MIX ASPHALT SURFACE REMOVAL - BUTT JOINT (SQ. YD.)
301+00		I 55 CONC. BRIDGE DECK EDGE		48	10	53
306+95	RT	HERITAGE PARKWAY	60.2	45	10	50
322+60	LT	MURPHY ROAD	68.9	42	10	47
322+60	RT	HILLCREST LANE	61.6	39	10	43
335+40	RT	WESTMINSTER DRIVE	65.7	47	10	52
347+30	LT	PRAIRIE LANE	60.6	28	10	31
350+20	LT	WATERFORD LANE	59.4	28	10	31
358+30	LT	PETERS DRIVE	62.9	34	10	38
358+30	RT	PETERS DRIVE	61.0	43	10	48
361+40	LT	CLOVER LANE	55.9	29	10	32
365+50	RT	UNION STREET	66.9	41	10	46
372+91		BOUGHTON ROAD		110	10	122
						593
						SY

SIDEWALK REMOVAL AND REPLACEMENT SCHEDULE				
STA	SIDE	42400200 PCC SIDEWALK, 5" (SQ. FT)	42400800 DETECTABLE WARNINGS (SQ. FT)	44000600 SIDEWALK REMOVAL (SQ. FT)
306+50	RT	80	16	80
307+25	RT	50	16	50
334+95	RT	50	0	50
335+05	RT	150	16	150
335+80	RT	200	16	200
346+95	LT	125	8	125
347+40	LT	30	8	30
347+50	LT	25	0	25
349+10	LT	25	0	25
349+95	LT	30	8	30
350+40	LT	60	8	60
351+00	LT	75	0	75
358+00	LT	75	8	75
358+00	RT	96	16	96
358+50	LT	125	8	125
358+50	RT	80	16	80
359+80	LT	25	0	25
361+10	LT	210	8	210
361+65	LT	125	8	125
362+65	LT	25	0	25
365+20	RT	90	16	90
365+80	RT	90	16	90
370+80	LT	100	0	100
371+00	LT	25	8	25
371+15	RT	80	8	80
371+20	LT	25	8	25
371+70	RT	80	8	80
		2151	224	2151
		SQ. FT	SQ. FT	SQ. FT

DRAINAGE AND UTILITY STRUCTURE SCHEDULE				
STA	SIDE	60255500 MANHOLES TO BE ADJUSTED (EACH)	60260100 INLETS TO BE ADJUSTED (EACH)	COMMENTS
313+50	RT		1	DETERIORATED RINGS
324+95	RT		1	DETERIORATED RINGS
325+05	LT		1	DETERIORATED RINGS
326+50	RT		1	DETERIORATED RINGS
326+50	LT		1	-1"
329+00	LT		1	DETERIORATED RINGS
330+10	LT		1	DETERIORATED RINGS
332+75	RT		1	DETERIORATED RINGS
334+15	RT		1	DETERIORATED RINGS
335+95	RT		1	DETERIORATED RINGS
338+40	RT		1	DETERIORATED RINGS
340+80	LT		1	DETERIORATED RINGS
341+95	LT		1	-1"
341+95	RT		1	DETERIORATED RINGS
342+10	RT		1	DETERIORATED RINGS
343+20	RT		1	-1"
344+75	LT		1	DETERIORATED RINGS
355+50	RT		1	DETERIORATED RINGS
359+60	RT		1	DETERIORATED RINGS
361+10	LT	1		ADJUST FOR SIDEWALK
363+10	RT		1	DETERIORATED RINGS
370+90	LT	1		ADJUST FOR SIDEWALK
		2	20	
		EACH	EACH	

**CONTRACT 63703**

<b>VILLAGE OF WOODRIDGE</b> <b>DEPARTMENT OF PUBLIC WORKS</b> 1 Plaza Drive, Woodridge IL 60517 (815) 770-0200	DESIGNED - AF	REVISED 3/20/2012	<b>STATE OF ILLINOIS</b> <b>DEPARTMENT OF TRANSPORTATION</b>	<b>SCHEDULES</b>	F.A.P. RTE.	SECTION	COUNTY	TOTAL SHEETS	SHEET NO.
	DRAWN - AF				2593	12-00069-00-RS	DUPAGE	16	11
	CHECKED - JDS				ILLINOIS	CONTRACT NO. 63703			
	DATE - 1/24/2012			SCALE: NONE	STA.	TO STA.	FEDERAL AID PROJECT		

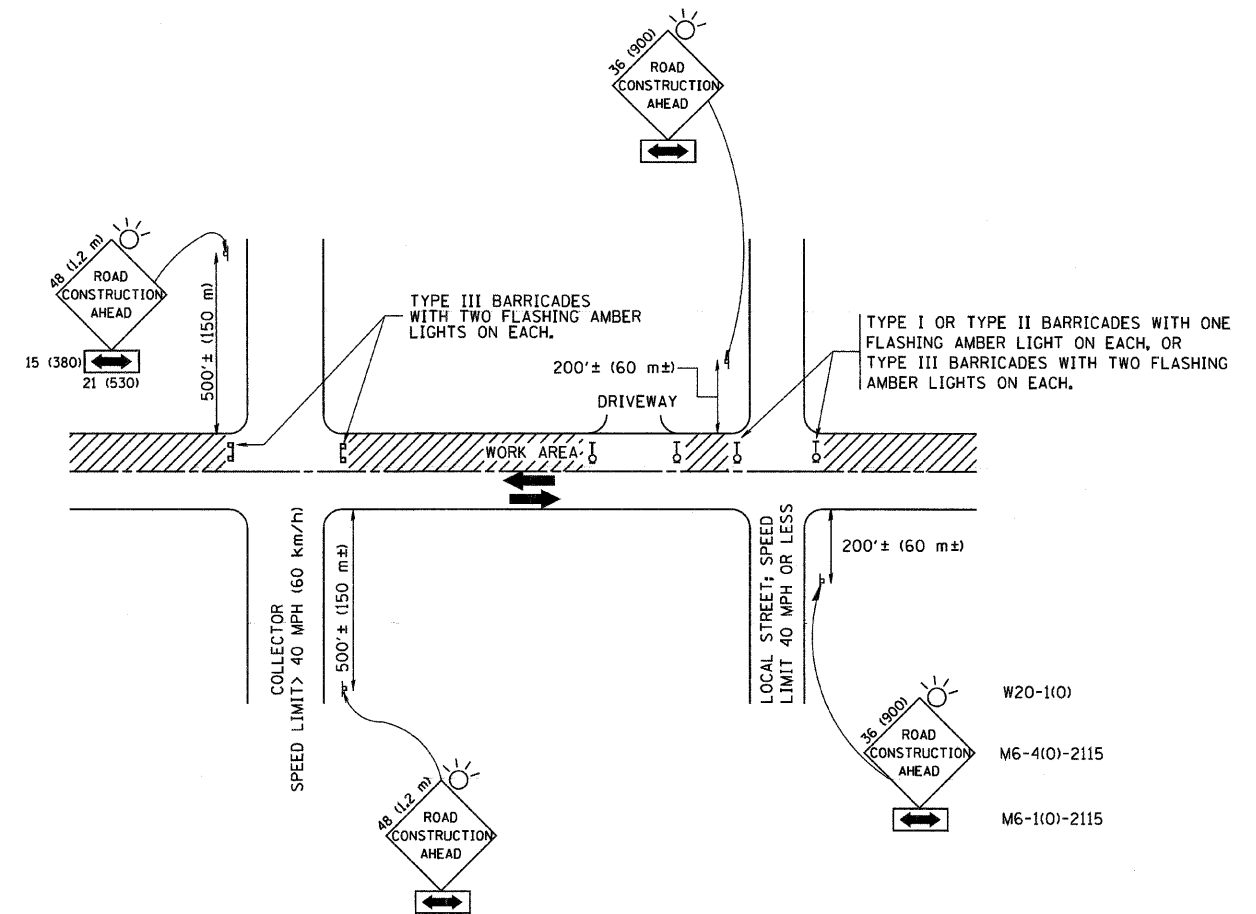

TRAFFIC CONTROL AND PROTECTION FOR SIDE ROADS, INTERSECTIONS, AND DRIVEWAYS

NOTES:

A. FOR NO LANE RESTRICTION ON THE SIDE ROAD OR DRIVEWAYS

1. SIDE ROAD WITH A SPEED LIMIT OF 40 MPH (60 km/h) OR LESS AS SHOWN ON THE DRAWING AND AS DIRECTED BY THE ENGINEER:
  - a) ONE ROAD CONSTRUCTION AHEAD SIGN 36 x 36 (900x900) WITH A FLASHER AND FLAG MOUNTED ON IT APPROXIMATELY 200' (60 m) IN ADVANCE OF THE MAIN ROUTE.
  - b) THE CLOSED PORTION OF THE MAIN ROUTE SHALL BE PROTECTED BY BLOCKING WITH TYPE I, TYPE II OR TYPE III BARRICADES, 1/3 OF THE CROSS SECTION OF THE CLOSED PORTION.
2. SIDE ROAD WITH A SPEED LIMIT GREATER THAN 40 MPH (60 km/h) AS SHOWN ON THE DRAWING AND AS DIRECTED BY THE ENGINEER:
  - a) ONE ROAD CONSTRUCTION AHEAD SIGN 48 x 48 (1.2 m x 1.2 m) WITH A FLASHER MOUNTED ON IT APPROXIMATELY 500' (150 m) IN ADVANCE OF THE MAIN ROUTE.
  - b) THE CLOSED PORTION OF THE MAIN ROUTE SHALL BE PROTECTED BY BLOCKING WITH TYPE III BARRICADES, 1/2 OF THE CROSS SECTION OF THE CLOSED PORTION.
3. WHEN THE SIDE ROAD LIES BETWEEN THE BEGINNING OF THE MAINLINE SIGNING AND THE WORK ZONE, A SINGLE HEADED ARROW (M6-1) SHALL BE USED IN LIEU OF THE DOUBLE HEADED ARROW (M6-4).

B. FOR A LANE CLOSURE ON A SIDE ROAD OR DRIVEWAY:

- USE APPLICABLE PORTIONS OF THE TYPICAL APPLICATION OF TRAFFIC CONTROL DEVICES (STD. 701501, STD. 701606 OR THE APPROPRIATE STANDARD). THE SPACING OF SIGNS AND BARRICADES SHALL BE ADJUSTED FOR FIELD CONDITIONS AS DIRECTED BY THE ENGINEER. THE DIRECTIONAL ARROW SHALL BE COVERED OR REMOVED WHEN NO LONGER CONSISTENT WITH THE SIDE ROAD LANE CLOSURE.
- C. ADVANCE WARNING SIGNS ARE TO BE OMITTED ON DRIVEWAY UNLESS OTHERWISE NOTED.
- D. THE TRAFFIC CONTROL AND PROTECTION FOR SIDE ROADS, INTERSECTIONS, AND DRIVEWAYS SHALL BE INCIDENTAL TO THE COST OF SPECIFIED TRAFFIC CONTROL STANDARDS OR ITEMS.

All dimensions are in millimeters (inches) unless otherwise shown.

FILE NAME = W:\diststd\22x34\tcl@.dgn	USER NAME = geglionabt	DESIGNED - LHA	REVISED - J. OBERLE 10-18-95
		DRAWN -	REVISED - A. HOUSEH 03-06-96
	PLOT SCALE = 50,000' / IN.	CHECKED -	REVISED - A. HOUSEH 10-15-96
	PLOT DATE = 1/4/2008	DATE - 06-89	REVISED - T. RAMMACHER 01-06-00

STATE OF ILLINOIS  
DEPARTMENT OF TRANSPORTATION

TRAFFIC CONTROL AND PROTECTION FOR  
SIDE ROADS, INTERSECTIONS, AND DRIVEWAYS

SCALE: NONE SHEET NO. 1 OF 1 SHEETS STA. TO STA.

F.A. RTE.	SECTION	COUNTY	TOTAL SHEETS	SHEET NO.
2593	12-00069-00-RS	DUPAGE	16	12
TC-10		CONTRACT NO. 63703		
FED. ROAD DIST. NO. 1 (ILLINOIS) FED. AID PROJECT				

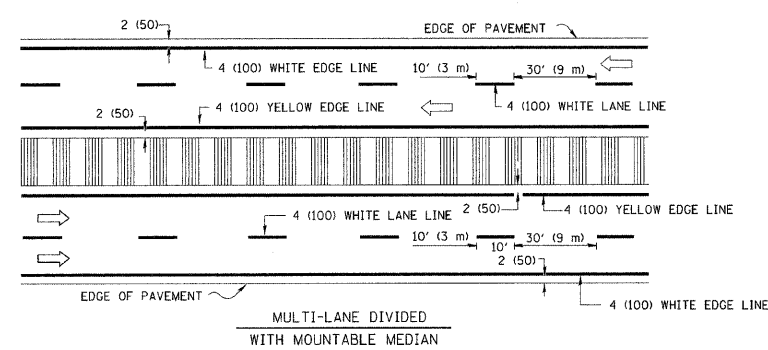
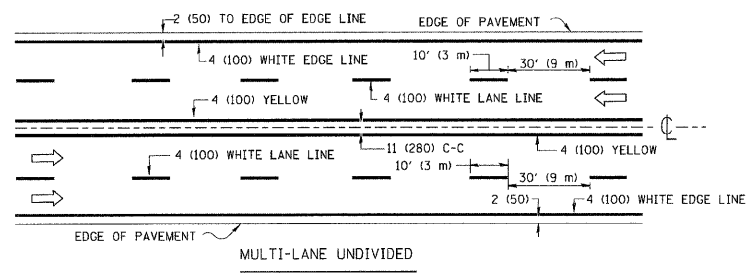
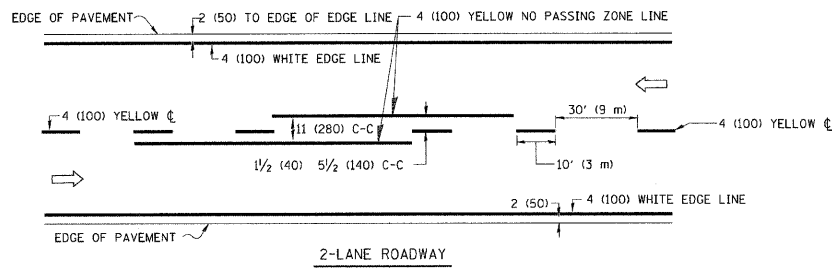

NOTE: MEDIANS WITH BARRIER CURB DO NOT REQUIRE AN EDGE LINE

TYPICAL LANE AND EDGE LINE MARKING

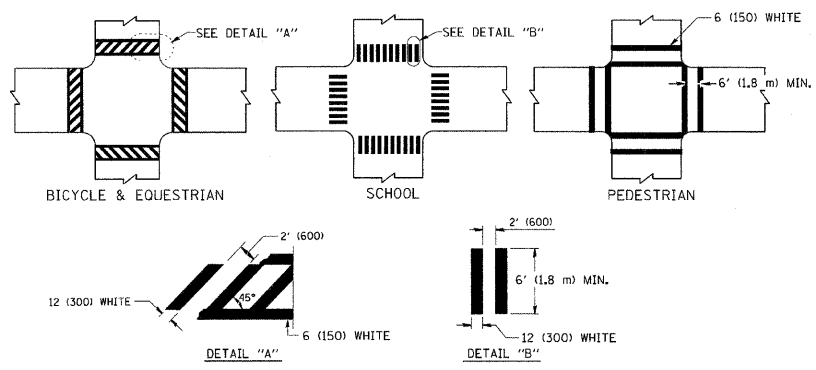

TYPICAL CROSSWALK MARKING

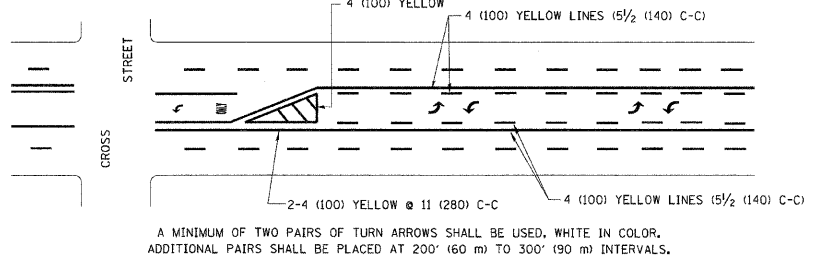
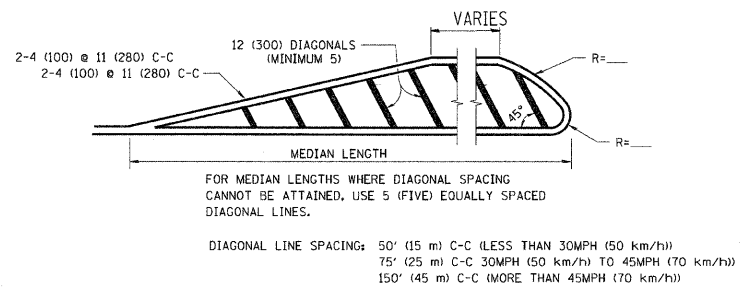
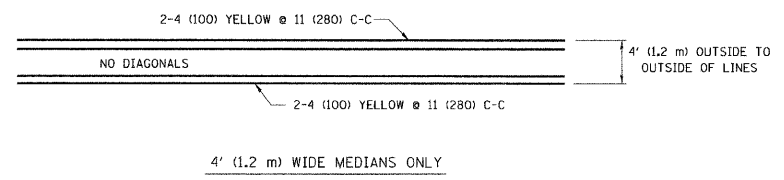

TYPICAL PAINTED MEDIAN MARKING

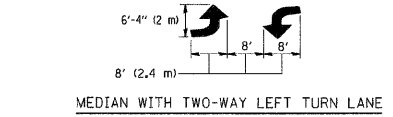

TYPICAL LEFT (OR RIGHT) TURN LANE

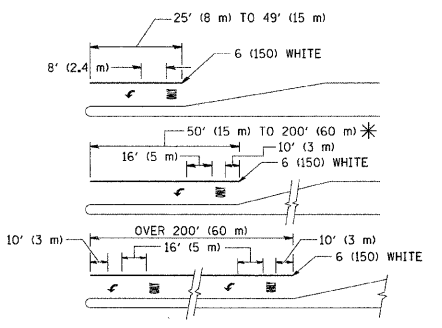

TYPICAL TURN LANE MARKING

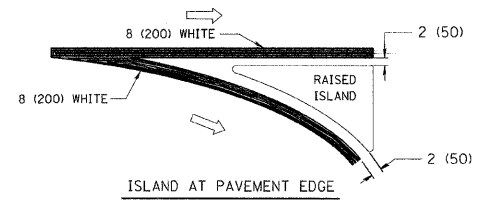
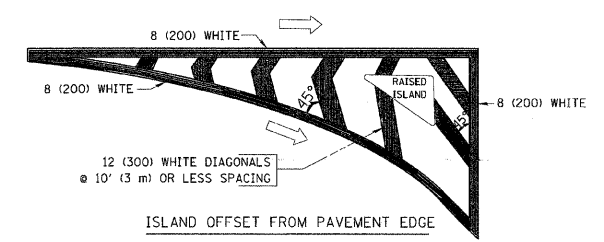

TYPICAL ISLAND MARKING

TYPE OF MARKING	WIDTH OF LINE	PATTERN	COLOR	SPACING / REMARKS
CENTERLINE ON 2 LANE PAVEMENT	4 (100)	SKIP-DASH	YELLOW	10' (3 m) LINE WITH 30' (9 m) SPACE
CENTERLINE ON MULTI-LANE UNDIVIDED PAVEMENT	2 @ 4 (100)	SOLID	YELLOW	11 (280) C-C
NO PASSING ZONE LINES: FOR ONE DIRECTION FOR BOTH DIRECTIONS	4 (100) 2 @ 4 (100)	SOLID SOLID	YELLOW YELLOW	5 1/2 (140) C-C FROM SKIP-DASH CENTERLINE 11 (280) C-C OMIT SKIP-DASH CENTERLINE BETWEEN
LANE LINES	4 (100) 5 (125) ON FREEWAYS	SKIP-DASH SKIP-DASH	WHITE WHITE	10' (3 m) LINE WITH 30' (9 m) SPACE
DOTTED LINES (EXTENSIONS OF CENTER, LANE OR TURN LANE MARKINGS)	SAME AS LINE BEING EXTENDED	SKIP-DASH	SAME AS LINE BEING EXTENDED	2' (600) LINE WITH 6' (1.8 m) SPACE
EDGE LINES	4 (100)	SOLID	YELLOW-LEFT WHITE-RIGHT	OUTLINE MOUNTABLE MEDIANS IN YELLOW; EDGE LINES ARE NOT USED NEXT TO BARRIER CURB
TURN LANE MARKINGS	6 (150) LINE; FULL SIZE LETTERS & SYMBOLS (8' (2.4m))	SOLID	WHITE	SEE TYPICAL TURN LANE MARKING DETAIL
TWO WAY LEFT TURN MARKING	2 @ 4 (100) EACH DIRECTION 8' (2.4m) LEFT ARROW	SKIP-DASH AND SOLID IN PAIRS	YELLOW WHITE	10' (3 m) LINE WITH 30' (9 m) SPACE FOR SKIP-DASH; 5 1/2 (140) C-C BETWEEN SOLID LINE AND SKIP-DASH LINE SEE TYPICAL TWO-WAY LEFT TURN MARKING DETAIL
CROSSWALK LINES (PEDESTRIAN) A. DIAGONALS (BIKE & EQUESTRIAN) B. LONGITUDINAL BARS (SCHOOL)	2 @ 6 (150) 12 (300) @ 45° 12 (300) @ 90°	SOLID SOLID SOLID	WHITE WHITE WHITE	NOT LESS THAN 6' (1.8 m) APART 2' (600) APART 2' (600) APART SEE TYPICAL CROSSWALK MARKING DETAILS.
STOP LINES	24 (600)	SOLID	WHITE	PLACE 4' (1.2 m) IN ADVANCE OF AND PARALLEL TO CROSSWALK, IF PRESENT; OTHERWISE, PLACE AT DESIRED STOPPING POINT, PARALLEL TO CROSSROAD CENTERLINE, WHERE POSSIBLE
PAINTED MEDIANS	2 @ 4 (100) WITH 12 (300) DIAGONALS @ 45° NO DIAGONALS USED FOR 4' (1.2 m) WIDE MEDIANS	SOLID	YELLOW; TWO WAY TRAFFIC WHITE; ONE WAY TRAFFIC	11 (280) C-C FOR THE DOUBLE LINE SEE TYPICAL PAINTED MEDIAN MARKING.
GORE MARKING AND CHANNELIZING LINES	8 (200) WITH 12 (300) DIAGONALS @ 45°	SOLID	WHITE	DIAGONALS: 15' (4.5 m) C-C (LESS THAN 30MPH (50 km/h)) 20' (6 m) C-C (30MPH (50 km/h) TO 45MPH (70 km/h)) 30' (9 m) C-C (OVER 45MPH (70 km/h))
RAILROAD CROSSING	24 (600) TRANSVERSE LINES; "RR" IS 6' (1.8 m) LETTERS; 16 (400) LINE FOR "X"	SOLID	WHITE	SEE STATE STANDARD 780001 AREA OF: "R"=3.6 SQ. FT. (0.33 m²) EACH "X"=54.0 SQ. FT. (5.0 m²)
SHOULDER DIAGONALS	12 (300) @ 45°	SOLID	WHITE - RIGHT YELLOW - LEFT	50' (15 m) C-C (LESS THAN 30MPH (50 km/h)) 75' (25 m) C-C (30 MPH (50 km/h) TO 45MPH (70 km/h)) 150' (45 m) C-C (OVER 45MPH (70 km/h))

FOR FURTHER DETAILS ON PAVEMENT MARKING REFER TO STANDARD SPECIFICATIONS FOR ROAD AND BRIDGE CONSTRUCTION AND STATE STANDARD 780001.

All dimensions are in inches (millimeters) unless otherwise shown.

FILE NAME =	USER NAME = drivakosgn	DESIGNED - EVERS	REVISED - T. RAMMACHER 10-27-94
ei:\pwwork\pwwid\drivakosgn\20108315\td3.dgn		DRAWN -	REVISED - C. JUCIUS 09-09-09
	PLOT SCALE = 50,000' / IN.	CHECKED -	REVISED -
	PLOT DATE = 9/9/2009	DATE - 03-19-90	REVISED -

STATE OF ILLINOIS  
DEPARTMENT OF TRANSPORTATION

DISTRICT ONE		F.A. -	SECTION	COUNTY	TOTAL SHEETS	SHEET NO.
TYPICAL PAVEMENT MARKINGS		2593	12-00069-00-RS	DUPAGE	16	13
SCALE: NONE		SHEET NO. 1 OF 1 SHEETS		STA.	TO STA.	
		FED. ROAD DIST. NO. 1		ILLINOIS	FED. AID PROJECT	

CONTRACT NO. 63703	
--------------------	--

VARIABLE - TO MEET EXISTING DIMENSIONS AND FIELD CONDITIONS (SEE NOTE ②)

PROP. CONC. CURB OR CURB AND GUTTER REPLACEMENT IN ACCORDANCE WITH STATE STANDARD 606001. (SEE NOTE ②)

SAW CUT FULL DEPTH - INCLUDED IN THE COST OF SIDEWALK, DRIVEWAY OR MEDIAN SURFACE REMOVAL PAY ITEM.

SEE STATE STANDARD 606001  
EXISTING OR PROPOSED HMA SURFACE (IF APPLICABLE)

1/4" (5) \*\*

18" (450) MAX.

EXISTING SIDEWALK, DRIVEWAY, MEDIAN SURFACE, SOD OR GROUND.

PROPOSED SIDEWALK, DRIVEWAY PAVEMENT, MEDIAN SURFACE OR SODDING SALT TOLERANT WITH TOP SOIL, 4" (100) SOD RESTORATION (SEE NOTE ①).

EXISTING CONCRETE PAVEMENT, CONCRETE BASE COURSE OR FLEXIBLE PAVEMENT

T/2 \*

SUITABLE BACKFILL MATERIAL (INCLUDED IN THE COST OF CURB OR CURB AND GUTTER REMOVAL AND REPLACEMENT)

3" (75) MIN.

PROPOSED 3/4" (20) PREFORMED EXPANSION JOINT AT CONCRETE SIDEWALKS, DRIVEWAYS, AND MEDIANS. (INCLUDED IN THE COST OF CURB OR CURB AND GUTTER REMOVAL AND REPLACEMENT.)

\* 3" (75) MINIMUM FROM TOP AND BOTTOM OF THE CONCRETE PAVEMENT OR BASE COURSE.

\*\* IF THE FINAL SURFACE OF THE PAVEMENT IS CONCRETE, THE GUTTER IS TO BE FLUSH WITH THE PAVEMENT.

UNSUITABLE SUB-BASE MATERIAL TO BE REMOVED, IF DIRECTED BY THE ENGINEER, SHALL BE REPLACED WITH EITHER SUB-BASE GRANULAR MATERIAL, TYPE B OR ADDITIONAL THICKNESS OF CONCRETE.

NOTE: ① SIDEWALK, DRIVEWAY PAVEMENT OR MEDIAN SURFACE SHALL BE SIMILAR TO THE MATERIAL BEING REMOVED AND WILL BE PAID FOR SEPARATELY.  
SODDING, SALT TOLERANT AND TOP SOIL, FURNISH AND PLACE 4" WILL BE PAID FOR SEPARATELY.

REMOVAL AND REPLACEMENT 4" (100) OR LESS IS INCLUDED IN THE COST OF CURB OR CURB AND GUTTER REMOVAL AND REPLACEMENT.

② FERTILIZER FOR THE PLACEMENT OF THE SOD IS NOT REQUIRED

REMOVAL AND REPLACEMENT IN EXCESS OF 4" (100) WILL BE PAID FOR IN ACCORDANCE WITH ARTICLE 109.04 OF THE STANDARD SPECIFICATIONS.

③ CURB OR CURB AND GUTTER REPLACEMENT SHALL MATCH THE SHAPE OF THE EXISTING CURB OR CURB AND GUTTER UNLESS OTHERWISE SPECIFIED.

④ FOR CURB OR CURB AND GUTTER REMOVAL AND REPLACEMENT ADJACENT TO FLEXIBLE PAVEMENT DELETE EPOXY COATED TIE BARS.

PROPOSED #6 (20) EPOXY COATED TIE BARS 24" (600) LONG AT 24" (600) CENTERS WILL NOT BE PAID FOR SEPARATELY. DELETE EPOXY COATED TIE BARS IF EXISTING TIE BARS ARE USUABLE AS DETERMINED BY THE ENGINEER. (SEE NOTE ③).

⑤ LONGITUDINAL BARS, IF ENCOUNTERED IN THE EXISTING CURB OR CURB AND GUTTER, ARE NOT TO BE REPLACED. CUTTING AND REMOVING LONGITUDINAL BARS SHALL BE INCLUDED IN THE COST OF CURB OR CURB AND GUTTER REMOVAL AND REPLACEMENT.

⑥ THE COST OF HMA SURFACE REMOVAL IN THE EXISTING GUTTER FLAG SHALL BE INCLUDED IN THE COST OF THE CURB AND GUTTER REMOVAL AND REPLACEMENT.

BASIS OF PAYMENT:  
THIS WORK WILL BE PAID FOR AT THE CONTRACT UNIT PRICE PER FOOT (METER) FOR "CURB REMOVAL AND REPLACEMENT" OR "COMBINATION CONCRETE CURB AND GUTTER REMOVAL AND REPLACEMENT".

⑦ THE REMOVAL AND REPLACEMENT OF THE EXISTING CURB OR CURB AND GUTTER SHALL BE DONE IN ACCORDANCE WITH THE APPLICABLE PORTIONS OF SECTION 440 AND 606 OF THE STANDARD SPECIFICATIONS.

⑧ THE LOCATIONS OF REMOVAL AND REPLACEMENT OF EXISTING CURB OR CURB AND GUTTER SHALL BE DETERMINED BY THE RESIDENT ENGINEER AT THE TIME OF CONSTRUCTION.

# CURB OR CURB AND GUTTER REMOVAL AND REPLACEMENT

ALL DIMENSIONS ARE IN INCHES (MILLIMETERS) UNLESS OTHERWISE SHOWN.

FILE NAME =	USER NAME = drivakosgn	DESIGNED - A. HOUSEH	REVISED - R. SHAH 10-03-96	<b>STATE OF ILLINOIS DEPARTMENT OF TRANSPORTATION</b>	<b>CURB OR CURB AND GUTTER REMOVAL AND REPLACEMENT</b>	F.A. -	SECTION	COUNTY	TOTAL SHEETS	SHEET NO.
ca:\pw_work\pwidot\drivakosgn\08108315\bd24.dgn	DRAWN -	REVISED - A. ABBAS 03-21-97	2593			12-00069-00-RS	DUPAGE	16	14	
PLOT SCALE = 50,000' / IN.	CHECKED -	REVISED - M. GOMEZ 01-22-01	<b>BD600-06 (BD-24)</b>			CONTRACT NO. 63703				
PLOT DATE = 12/15/2009	DATE - 03-11-94	REVISED - R. BORO 12-15-09	FED. ROAD DIST. NO. 1 ILLINOIS FED. AID PROJECT							
					SCALE: NONE	SHEET NO. 1 OF 1 SHEETS		STA.	TO STA.	

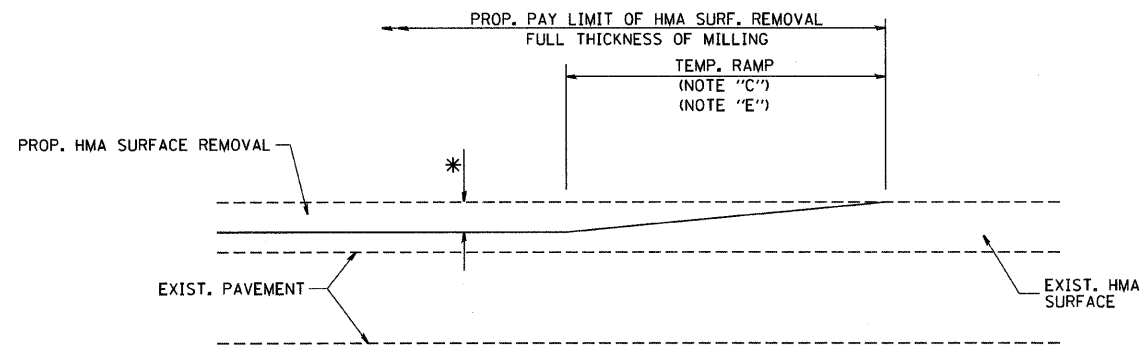

MILLED TEMPORARY RAMP  
(FOR BUTT JOINT AND HMA TAPER SEE DETAIL BELOW)

OPTION 1

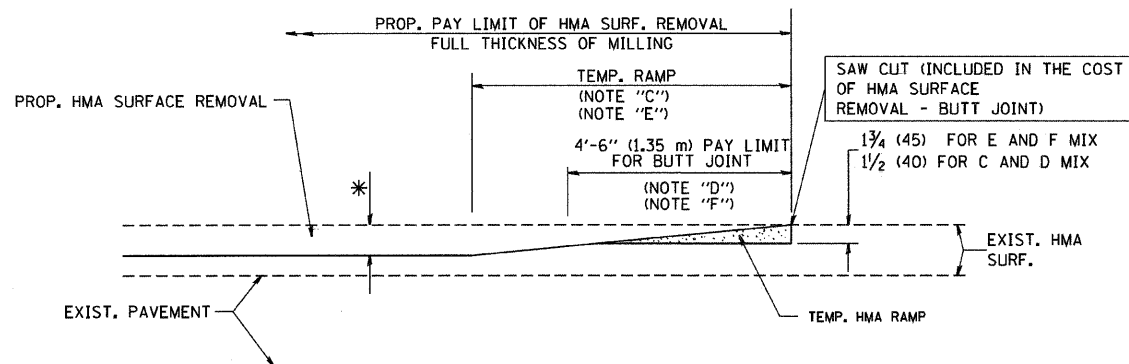

HMA CONSTRUCTED TEMPORARY RAMP  
(FOR BUTT JOINT AND HMA TAPER SEE DETAIL BELOW)

OPTION 2

TYPICAL TEMPORARY RAMP

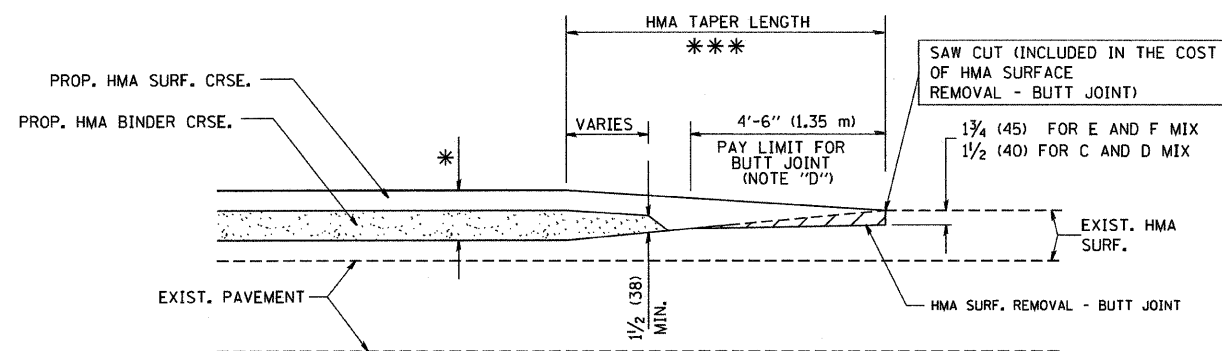

TYPICAL BUTT JOINT AND HMA TAPER  
FOR MILLING AND RESURFACING

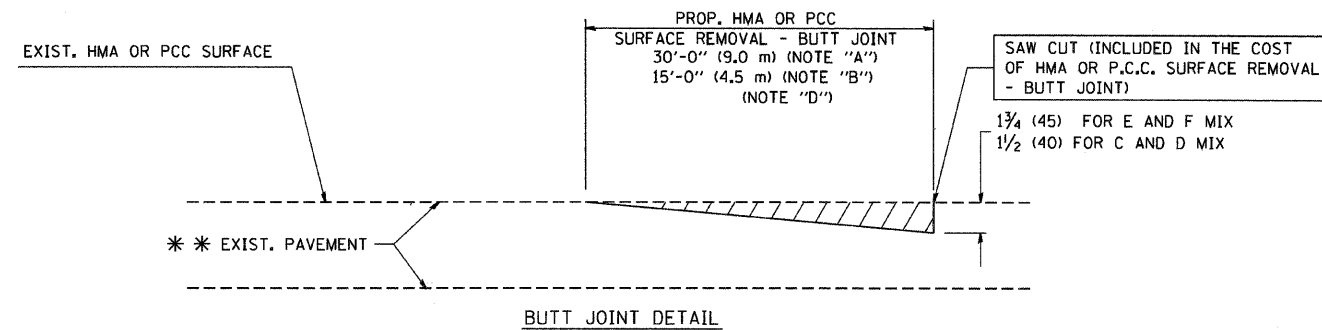

BUTT JOINT DETAIL

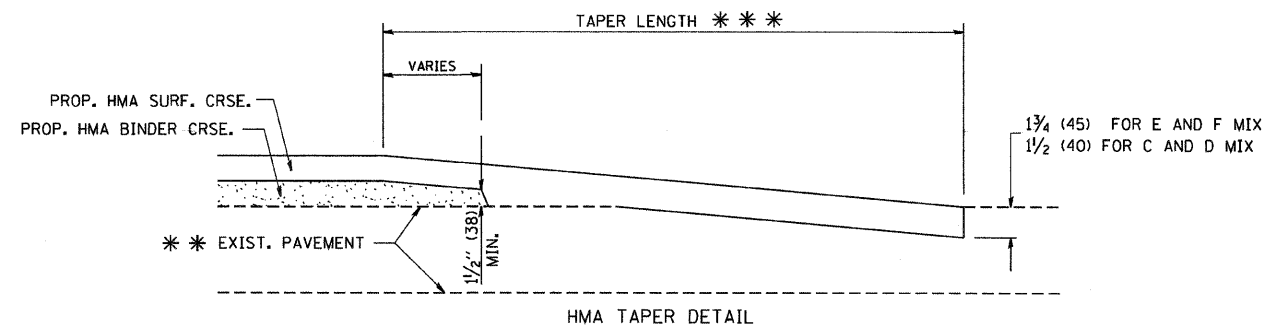

HMA TAPER DETAIL

TYPICAL BUTT JOINT AND HMA TAPER  
FOR RESURFACING ONLY

\*\*\* PC CONCRETE, HMA OR HMA RESURFACED PAVEMENT.

NOTES

- A: MAINLINE ROADWAYS AND MAJOR SIDE ROADS.
  - B: MINOR SIDE ROADS.
  - C: THE TEMP. RAMP SHALL BE CONSTRUCTED IMMEDIATELY UPON REMOVAL OF THE EXISTING HMA SURFACE.
  - D: THE BUTT JOINT SHALL BE CONSTRUCTED IMMEDIATELY PRIOR TO PLACING THE PROPOSED HMA COURSES.
  - E: TAPER THE TEMP. RAMP AT A RATE OF 3'-0" (900 mm) PER 1 INCH (25 mm) OF MILLING THICKNESS.
  - F: INSTALLATION AND REMOVAL OF THE 4'-6" (1.35 m) TEMP. RAMP IS INCLUDED IN COST OF HMA SURFACE REMOVAL - BUTT JOINT
  - G: SEE ARTICLE 406.08 AND 406.14 OF THE STANDARD SPECIFICATIONS FOR "HMA AND/OR PCC SURFACE REMOVAL, BUTT JOINT".
- \* SEE TYPICAL SECTIONS FOR MILLING THICKNESS.
- \*\*\* 20'-0" (6.1 m) PER 1 (25) RESURFACING (NOTE "A")  
10'-0" (3.0 m) PER 1 (25) RESURFACING (NOTE "B")

BASIS OF PAYMENT:

THE BUTT JOINT WILL BE PAID FOR AT THE CONTRACT UNIT PRICE PER SQUARE YARD (SQUARE METER) FOR "HOT-MIX ASPHALT SURFACE REMOVAL - BUTT JOINT" OR FOR "PORTLAND CEMENT CONCRETE SURFACE REMOVAL - BUTT JOINT".

ALL DIMENSIONS ARE IN INCHES (MILLIMETERS) UNLESS OTHERWISE SHOWN.

FILE NAME = W:\diststd\22x34\bd32.dgn	USER NAME = gaglianobt	DESIGNED - M. DE YONG	REVISED - R. SHAH 10-25-94
		DRAWN -	REVISED - A. ABBAS 03-21-97
	PLOT SCALE = 50.0000' / IN.	CHECKED -	REVISED - M. GOMEZ 04-06-01
	PLOT DATE = 1/4/2008	DATE - 06-13-90	REVISED - R. BORO 01-01-07

STATE OF ILLINOIS  
DEPARTMENT OF TRANSPORTATION

BUTT JOINT AND  
HMA TAPER DETAILS

F.A. RTE.	SECTION	COUNTY	TOTAL SHEETS	SHEET NO.
2593	12-00069-00-RS	DUPAGE	16	15
BD400-05 BD32		CONTRACT NO. 63703		
FED. ROAD DIST. NO. 1 ILLINOIS FED. AID PROJECT				

SCALE: NONE SHEET NO. 1 OF 1 SHEETS STA. TO STA.



**LOOPS NEXT TO SHOULDERS**

PROVIDE A PAVEMENT REPLACEMENT  
NOTE WHICH SHOULD EQUAL  
3' (900 mm) X WIDTH OF  
PAVED SHOULDER.

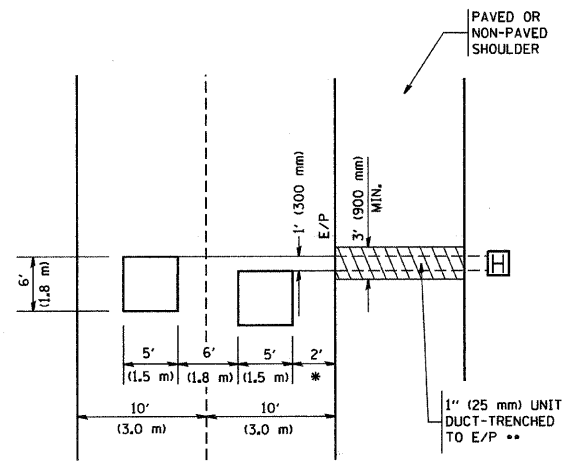

\* = (600 mm)

\*\* UNIT DUCT IS TO BE SHOWN ON PLAN SHEETS  
BUT SHALL NOT BE INCLUDED IN THE PAY ITEMS.

**LEFT TURN LANES WITH MEDIANS  
VOLUME DENSITY ("FAR OUT" DETECTION)  
ON SAME APPROACH  
(PROTECTED / PERMITTED LEFT TURN PHASING)**

HANDHOLE LOCATION MAY  
VARY DEPENDING ON GEOMETRICS  
AND DESIGN OF TRAFFIC SIGNALS.  
HEAVY-DUTY HANDHOLES TO BE  
USED WHEN THE MEDIAN IS  
MOUNTABLE. REFER TO STANDARD  
814001 TO ENSURE THAT HANDHOLE  
FITS IN MEDIAN.

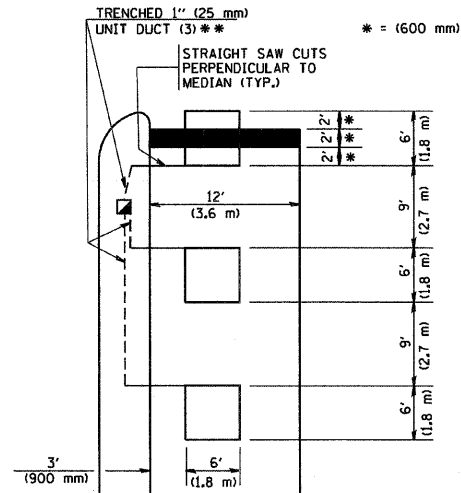

\*\* UNIT DUCT IS TO BE SHOWN ON PLAN SHEETS  
BUT SHALL NOT BE INCLUDED IN THE PAY ITEMS.

NOTE: DUAL LEFT TURNS NOT SHOWN REFER TO  
PLAN SHEET FOR DETECTOR LOOP REPLACEMENT

**LEFT TURN LANES WITHOUT MEDIANS  
VOLUME DENSITY ("FAR OUT" DETECTION)  
ON SAME APPROACH  
(PROTECTED / PERMITTED LEFT TURN PHASING)**

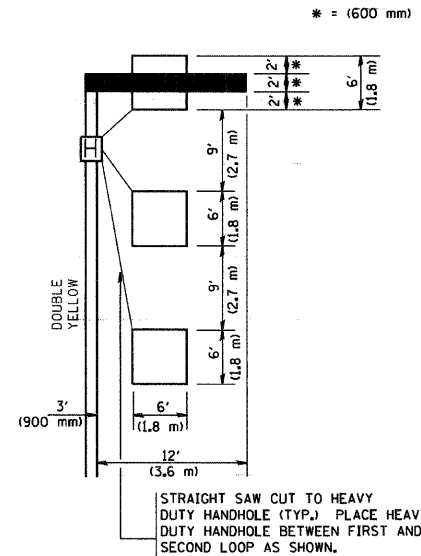

NOTE: DUAL LEFT TURNS NOT SHOWN REFER TO  
PLAN SHEET FOR DETECTOR LOOP REPLACEMENT

**ARTERIAL-VOLUME DENSITY ("FAR OUT" DETECTION)  
CROSS STREET-VOLUME DENSITY ("FAR OUT" DETECTION)**

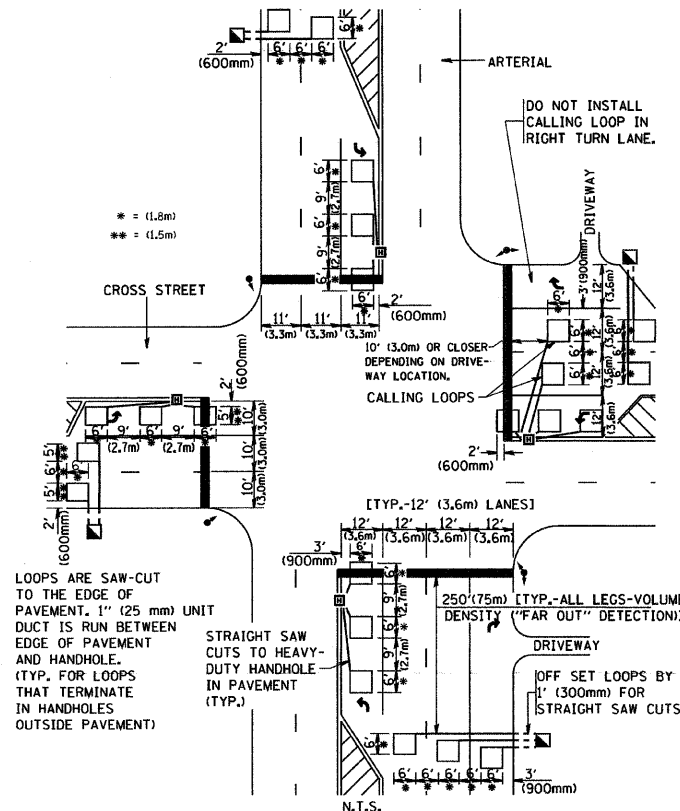

**DETAIL 1  
N.T.S.**

**ARTERIAL-VOLUME DENSITY ("FAR OUT" DETECTION)  
CROSS STREET-NON VOLUME DENSITY ("UPTIGHT" PRESENCE DETECTION)**

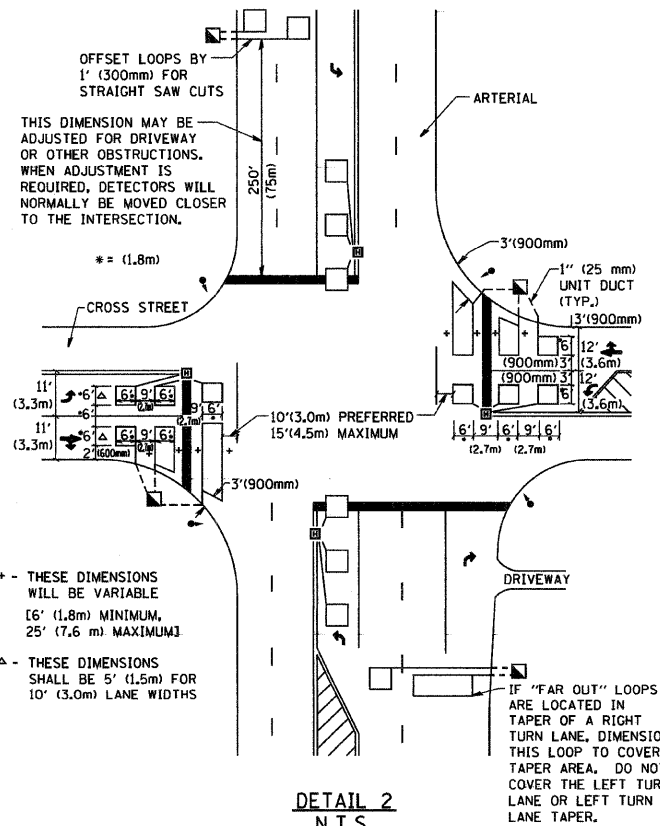

**DETAIL 2  
N.T.S.**

**NOTES:**

**VEHICLES LOOP DETECTORS**

- \* ALL LEAD IN CABLE SHALL BE TWO CONDUCTOR NO. 14 TWISTED, SHIELDED.
- \* EACH DETECTOR LOOP SHALL HAVE ITS OWN SAW CUT FROM THE LOOP TO THE EDGE OF PAVEMENT OR TO A HANDHOLE IN THE PAVEMENT.
- \* EACH DETECTOR LOOP SHALL HAVE ITS OWN ONE INCH (25 mm) UNIT DUCT BETWEEN THE EDGE OF PAVEMENT AND THE FIRST HANDHOLE OR JUNCTION BOX. EACH UNIT DUCT RUN SHALL BE SHOWN ON THE PLANS BY THE DESIGNER, BUT SHALL NOT BE PAID FOR SEPARATELY. THIS ITEM IS INCIDENTAL TO THE PAY ITEM FOR DETECTOR LOOPS.
- \* ONE DIMENSION OF ALL DETECTOR LOOPS SHALL BE SIX FEET (1.8 m)
- \* EACH LANE OF NON-LOCKING, PRESENCE DETECTION AND EACH LANE OF A DOUBLE LEFT TURN LANE REQUIRES A SEPARATE INDUCTIVE LOOP DETECTOR AND LEAD IN CABLE.
- \* WHEN NON-LOCKING, PRESENCE DETECTION IS USED, MORE THAN ONE LOOP PER LANE IS REQUIRED BEHIND THE STOP BAR (i.e. 1-1/2, 1-3/4, 2).
- \* WHEN SYSTEM LOOPS ARE REQUIRED ON AN APPROACH OF AN INTERSECTION, THE LOOPS USED FOR VOLUME DENSITY AND INTERSECTION TIMING SHALL ALSO BE USED AS SYSTEM DETECTORS. EACH ONE OF THESE TYPE OF LOOPS REQUIRES A SEPARATE TWO CONDUCTOR NO. 14 TWISTED SHIELDED CABLE AND A SEPARATE INDUCTIVE LOOP DETECTOR WHEN NEW CONTROLLERS ARE UTILIZED. THE DESIGNER SHALL LABEL THESE TYPES OF LOOPS AS "INTERSECTION AND SAMPLING (SYSTEM) DETECTORS" ON THE SIGNAL LAYOUT, THE INTERCONNECT PLAN AND THE SYSTEM CABLE PLAN. WHEN AN EXISTING CONTROLLER IS UTILIZED FOR THIS TYPE OF DETECTION, THE PAY ITEM "INDUCTIVE LOOP DETECTOR WITH SYSTEM OUTPUT" SHOULD BE USED.

**PLACEMENT OF DETECTORS**

THE FOLLOWING FIGURES REPRESENT THE MOST COMMON DETECTOR LOOP LOCATIONS AND SIZES. ADJUSTMENTS WILL BE NECESSARY FOR SPECIFIC GEOMETRIC CONSIDERATIONS.

LOCATIONS AND DEMENSIONS OF DETECTOR LOOPS ARE REQUIRED ON ALL SIGNAL LAYOUT PLAN SHEETS.

"FAR OUT" DETECTION REFERS TO LOCKING, PRESENCE TYPE DETECTION LOCATED IN THRU LANES, RIGHT TURN LANES, AND RIGHT TURN LANE TAPER AREAS (IF APPLICABLE). USUALLY 250' (75 m) IN ADVANCE OF STOP BARS. "UPTIGHT" DETECTION REFERS TO NON-LOCKING PRESENCE TYPE DETECTION LOCATED IN ALL LANES AND 10'-15' (3.0 m-4.5 m) BEHIND THE CROSSING STREET'S EDGE OF PAVEMENT EXTENDED.

**NOTE:**

ALL DETAILS AND NOTES SHOWN ARE FROM THE I.D.O.T. DISTRICT 1 TRAFFIC SIGNAL DESIGN GUIDELINES DATED JANUARY 1995

THIS DRAWING HAS BEEN PREPARED TO ASSIST THE RESIDENT ENGINEER FOR ALL ROADWAY RESURFACING OR S.M.A.R.T. PROJECTS WHERE THE DIMENSIONS ARE NOT SHOWN ON THE PLANS AND THE FINAL LOCATIONS FOR CROSSWALKS OR STOP BARS ARE NOT DETERMINED.

FILE NAME = W:\dststd\22x34\ts07.dgn	USER NAME = geglanoht	DESIGNED -	REVISED -	<b>STATE OF ILLINOIS DEPARTMENT OF TRANSPORTATION</b>	<b>DISTRICT 1 - DETECTOR LOOP INSTALLATION DETAILS FOR ROADWAY RESURFACING</b>			F.A. - RTE.	SECTION	COUNTY	TOTAL SHEETS	SHEET NO.	
PLOT SCALE = 50,0000 ' / IN.	PLOT DATE = 1/4/2008	DRAWN -	REVISED -		SCALE: NONE	SHEET NO. 1 OF 1 SHEETS	STA.	TO STA.	2593	12-00069-00-RS	DUPAGE	16	16
		CHECKED - R.K.F.	REVISED -						<b>TS-07</b>		<b>CONTRACT NO. 63703</b>		
		DATE -	REVISED -						FED. ROAD DIST. NO. 1 [ILLINOIS] FED. AID PROJECT				