

REVISIONS	DATE
BY	
PLAN	
NOTE BOOK	
ALIGNED CHECKED	
PLOTTED	
DATE	
NO.	

REVISIONS	DATE
BY	
PROFILE	
NOTE BOOK	
GRADES CHECKED	
PLOTTED	
DATE	
NO.	

COMPANY NAME: HR GREEN, INC.
 PROJECT CONTACT: J. McHUGH
 CLIENT: VILLAGE OF HOFFMAN ESTATES
 DATE PLOTTED: 4/6/2012 8:46:18 AM
 FILE NAME: 0177-pp-02.dgn
 PLOT DRIVER: pdt/cpl
 PLOT TABLE: standard-trans.tbl

ILLINOIS ROUTE 59

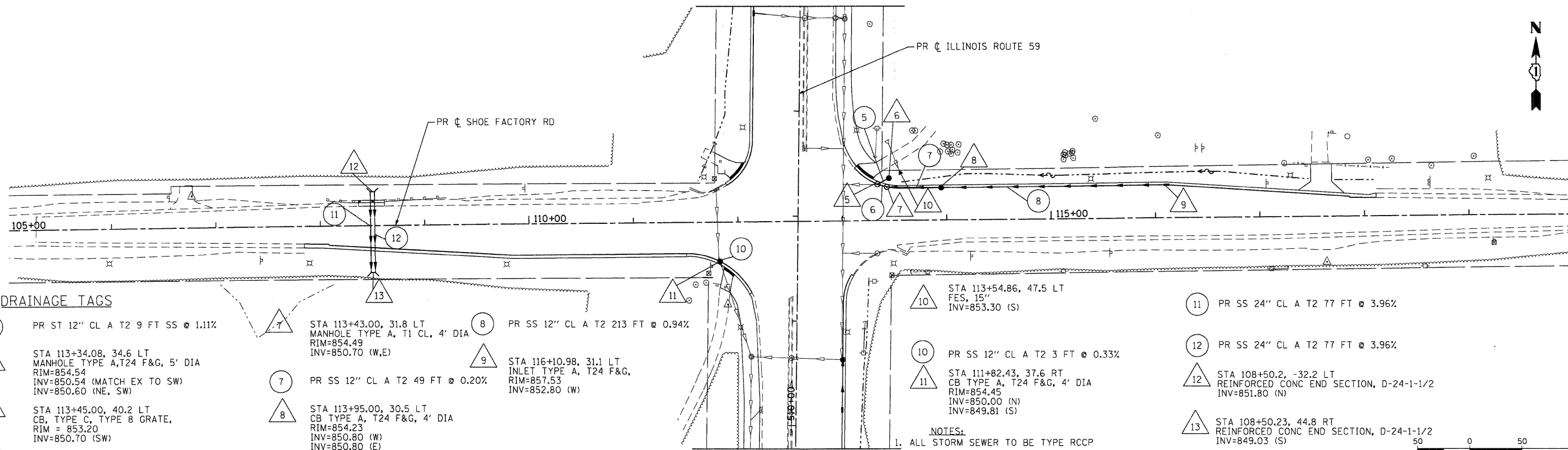

DRAINAGE TAGS

- 5 PR ST 12" CL A T2 9 FT SS @ 1.11%
- 5 STA 113+34.08, 34.6 LT
MANHOLE TYPE A, T24 F&G, 5' DIA
RIM=854.54
INV=850.54 (MATCH EX TO SW)
- 6 STA 113+45.00, 40.2 LT
CB, TYPE C, TYPE 8 GRATE,
RIM = 853.20
INV=850.70 (SW)
- 6 PR SS 12" CL A T2 7 FT @ 1.43%
- 7 STA 113+43.00, 31.8 LT
MANHOLE TYPE A, T1 CL, 4' DIA
RIM=854.49
INV=850.70 (W,E)
- 7 PR SS 12" CL A T2 49 FT @ 0.20%
- 8 STA 113+95.00, 30.5 LT
CB TYPE A, T24 F&G, 4' DIA
RIM=854.23
INV=850.80 (W)
INV=850.80 (E)
- 8 PR SS 12" CL A T2 213 FT @ 0.94%
- 9 STA 116+10.98, 31.1 LT
INLET TYPE A, T24 F&G,
RIM=857.53
INV=852.80 (W)
- 10 STA 113+54.86, 47.5 LT
FES, 15"
INV=853.30 (S)
- 10 PR SS 12" CL A T2 3 FT @ 0.33%
- 11 STA 111+82.43, 37.6 RT
CB TYPE A, T24 F&G, 4' DIA
RIM=854.45
INV=850.00 (N)
INV=849.81 (S)
- 11 PR SS 24" CL A T2 77 FT @ 3.96%
- 12 PR SS 24" CL A T2 77 FT @ 3.96%
- 12 STA 108+50.2, -32.2 LT
REINFORCED CONC END SECTION, D-24-1-1/2
INV=851.80 (N)
- 13 STA 108+50.23, 44.8 RT
REINFORCED CONC END SECTION, D-24-1-1/2
INV=849.03 (S)

- NOTES:
- ALL STORM SEWER TO BE TYPE RCCP
 - TRENCH BACKFILL TO BE TYPE FA-6
 - ALL TYPE 24 FRAME AND GRATES TO BE VANE DESIGN

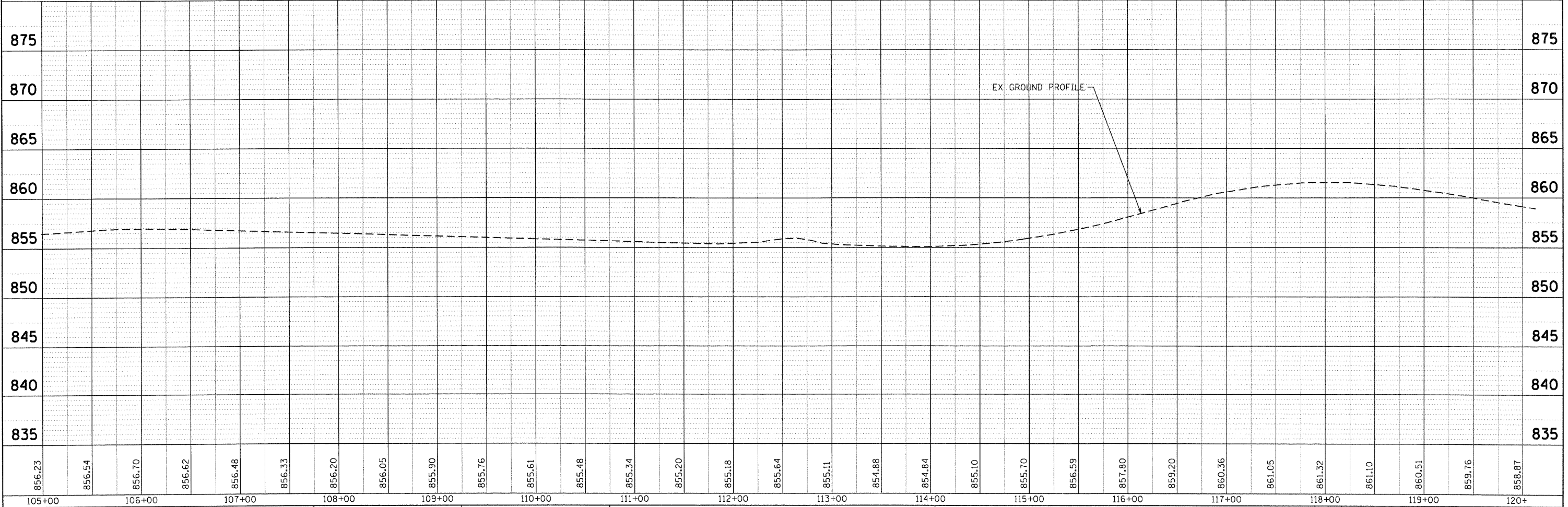

	USER NAME: SPernal DESIGNED: - DRAWN: - CHECKED: - PLOT DATE: 4/6/2012	REVISED: - REVISED: - REVISED: - REVISED: -	STATE OF ILLINOIS DEPARTMENT OF TRANSPORTATION	PROPOSED DRAINAGE PLAN SHOE FACTORY ROAD		F.A.P. R.T.E.: 338 SECTION: 10-00084-00-CH COUNTY: COOK CONTRACT NO.: 63711
	PLOT SCALE: 1"=50' DATE: 4/6/2012	SCALE: 1"=50' SHEET NO. 2 OF 2 SHEETS STA. 107+85 TO STA. 118+64		TOTAL SHEETS: 63 SHEET NO.: 15		