

QUANTITY  
 4 (100) LINE = 64.1 ft. (19.7 m)  
 21.1 sq. ft. (1.97 sq. m)

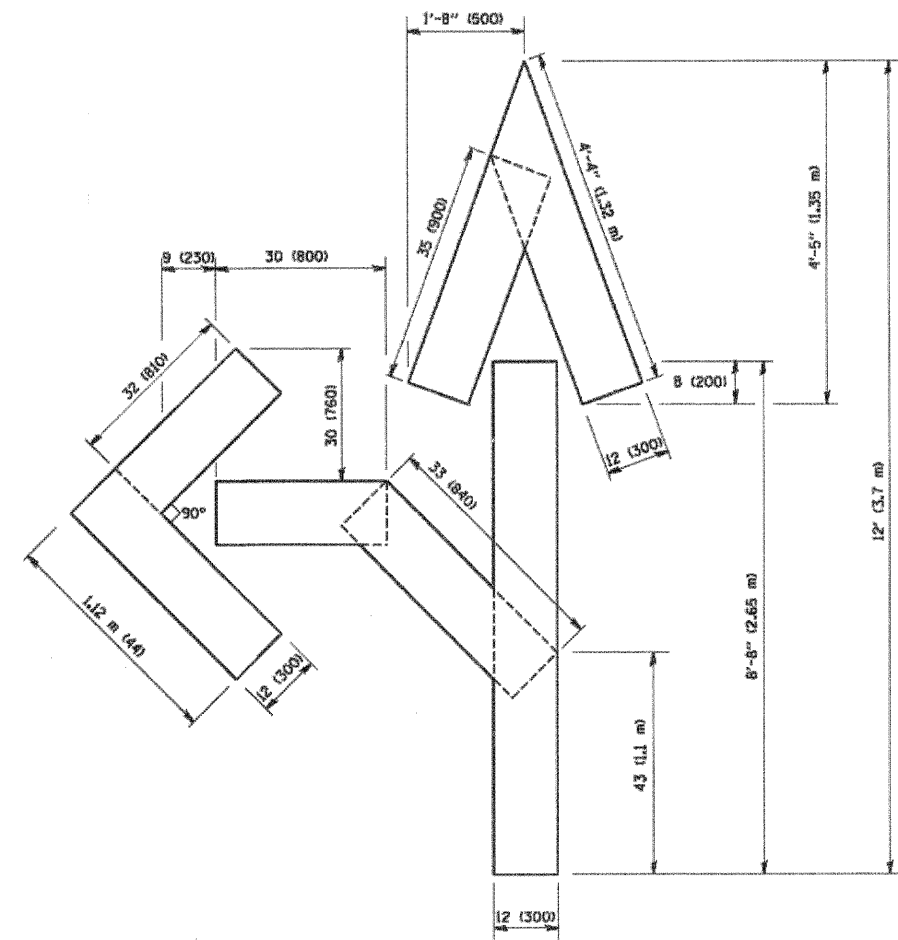

QUANTITY  
 4 (100) LINE = 82.5 ft. (25.3 m)  
 27.5 sq. ft. (2.53 sq. m)

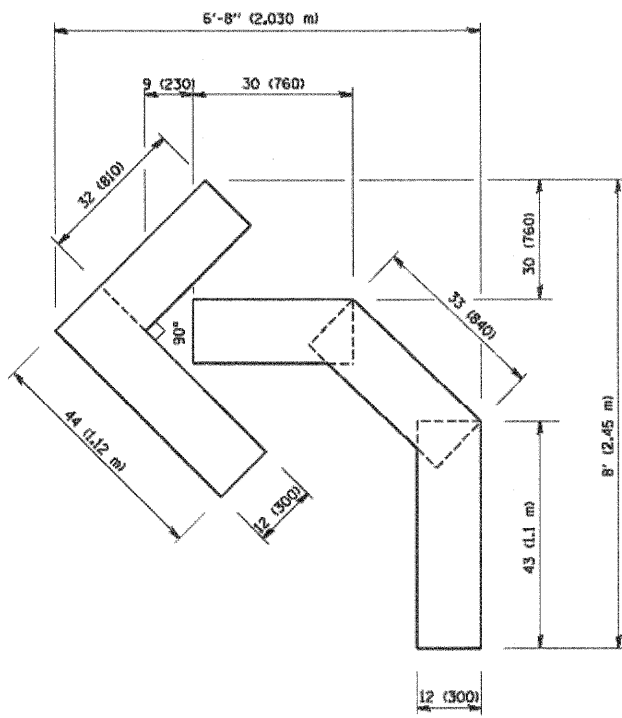

QUANTITY  
 4 (100) LINE = 45.5 ft. (13.9 m)  
 15.2 sq. ft. (1.39 sq. m)

All dimensions are in inches (millimeters) unless otherwise shown.

COMPANY NAME: HRGreen.com  
 PROJECT CONTACT: Illinois Professional Design Firm  
 CLIENT: #184-001322  
 DATE PLOTTED: 4/5/2012 5:17:38 PM  
 FILE NAME: 0177-dm1-11.dgn  
 PLOT USERS: srt  
 PLOT TABLE: standard-trans.tbl



USER NAME = geglsmat	DESIGNED -	REVISED - T. RAMMACHER 06-05-96
	DRAWN -	REVISED - T. RAMMACHER 11-04-97
PLOT SCALE = 5/8" = 1" / IN.	CHECKED -	REVISED - T. RAMMACHER 03-02-98
PLOT DATE = 5/5/2012	DATE = 09-28-1994	REVISED - E. GOMEZ 08-28-00

**STATE OF ILLINOIS  
 DEPARTMENT OF TRANSPORTATION**

PAVEMENT MARKING LETTERS AND SYMBOLS FOR TRAFFIC STAGING			
SCALE: NONE	SHEET NO. 1	OF 1 SHEETS	STA. TO STA.

F.A.P. RTE.	SECTION	COUNTY	TOTAL SHEETS	SHEET NO.
338	10-00084-00-CH	COOK	63	48
TC-16			CONTRACT NO. 63711	
FED. ROAD DIST. NO. 1 ILLINOIS FED. AID PROJECT				