

# MAINTENANCE OF TRAFFIC GENERAL NOTES

- THE CONTRACTOR SHALL GENERALLY FOLLOW THE CONSTRUCTION STAGING SEQUENCE AS HEREIN PRESENTED AND DEFINED IN THE TRAFFIC CONTROL SPECIAL PROVISIONS. DEVIATIONS OF SUB-STAGING SEQUENCE MAYBE SUBMITTED AS AN ALTERNATIVE STAGING PLAN UPON APPROVAL OF THE ENGINEER.
- TRAFFIC CONTROL AND PROTECTION SHALL BE PERFORMED IN ACCORDANCE WITH THE TRAFFIC CONTROL PLAN AND SECTION 701 OF THE STANDARD SPECIFICATIONS.
- THE FOLLOWING IDOT HIGHWAY TRAFFIC CONTROL STANDARDS ARE THE MINIMUM REQUIREMENTS FOR THE TRAFFIC CONTROL FOR THIS PROJECT: 701006, 701101, 701106, 701201, 701301, 701306, 701311, 701326, 701411, 701421, 701422, 701423, 701426, 701427, 701431, 701451, 701502, 701601, 701602, 701606, 701701, 701801, 701901 AND 704001.
- THE FOLLOWING IDOT DISTRICT 2 STANDARDS FOR TRAFFIC CONTROL SHALL ALSO BE ADDED: 38.1, 39.2, 40.1, 40.1g, 40.4, 91.2, 94.2
- THE FURNISHING, INSTALLATION AND RELOCATION OF ALL TEMPORARY TRAFFIC CONTROL DEVICES SHALL BE IN ACCORDANCE WITH THE MANUAL ON UNIFORM TRAFFIC CONTROL DEVICES AND THE STATE STANDARD SPECIFICATIONS.
- TEMPORARY CONCRETE BARRIER, DRUMS, AND TEMPORARY PAVEMENT MARKINGS SHALL BE INSTALLED THROUGHOUT THE LIMITS OF THE WORK ZONE AS SHOWN ON THE MAINTENANCE OF TRAFFIC TYPICAL SECTIONS AND PLAN SHEETS.
- THE CONTRACTOR SHALL MAINTAIN TWO-WAY TRAFFIC ON IL ROUTE 2 THROUGHOUT THE DURATION OF CONSTRUCTION EXCEPT DURING A TWO-WEEK PRE-STAGE PERIOD PRIOR TO THE INITIATION OF CONSTRUCTION YEAR 2013 STAGE 1 LANE CLOSURES AND TRAFFIC CONTROL IN ORDER TO CONSTRUCT THE BOX CULVERT AT STA. 294+75 PLUS THE STORM SEWER WORK FROM STA. 287+50 TO HARRISON AVENUE AND ALONG THE SOUTH SIDE OF HARRISON AVENUE. DURING THIS PRE-STAGE PERIOD, ALL IL 2 TRAFFIC SHALL BE DETOURED PER PLAN SHEET 155. USE IDOT STANDARD 701006 DURING WORK ALONG HARRISON AVENUE.
- THE CONTRACTOR SHALL COMPLETE THE STORM SEWER WORK WITHIN THE WESTERN HALF OF IL 2 FROM STA 325+50 TO 333+30 PRIOR TO THE CONSTRUCTION YEAR 2013 STAGE 1 CLOSURE OF NB IL 2. USE IDOT STANDARD 701421 FOR WORK ALONG IL 2 AND IDOT STANDARD 701301 FOR WORK ALONG AND ACROSS PRAIRIE ROAD.
- THE DURATION OF HARRISON AVENUE CLOSURE DURING STAGE 1B SHALL BE LIMITED TO 2-WEEKS. SEE SUB-STAGE 1B HARRISON AVENUE CLOSURE DETAIL PLAN, SHEET 157.
- SEE RAMP CLOSURE DETOUR TRAFFIC CONTROL FOR EACH RAMP CLOSURE.
- THE DURATION OF EACH RAMP CLOSURE SHALL BE LIMITED AS DEFINED IN THE SPECIAL PROVISIONS.
- THE DURATION OF THE SPRINGFIELD AVENUE CLOSURE DURING STAGE 2A SHALL BE LIMITED TO TWO WEEKS. SEE SUB-STAGE 2A SPRINGFIELD AVENUE ROAD CLOSURE DETAIL PLAN, SHEET 156.
- EACH STAGE, INCLUDING CORRESPONDING SUB-STAGES, SHALL BE COMPLETED PRIOR TO STARTING THE NEXT STAGE.
- WHERE THE PROPOSED WORK WILL IMPACT ALL OF THE ENTRANCES TO A PROPERTY, THE CONTRACTOR SHALL STAGE THE WORK TO MAINTAIN BI-DIRECTIONAL ACCESS AT ALL TIMES. STAGING SHALL BE COORDINATED WITH THE PROPERTY OWNER AND APPROVED BY THE ENGINEER.
- ALL ADVANCED WARNING SIGNS AND TEMPORARY PAVEMENT MARKINGS SHALL BE IN PLACE AND APPROVED BY THE ENGINEER PRIOR TO THE COMMENCEMENT OF ANY STAGE OR SUB-STAGE OF CONSTRUCTION.
- THE REMOVAL OF EXISTING AND/OR TEMPORARY PAVEMENT MARKINGS THAT ARE IN CONFLICT SHALL BE PAID AS TRAFFIC CONTROL PROTECTION STANDARD 701602.
- PROPOSED STORM SEWER SHALL BE CONSTRUCTED PRIOR TO PLACING THE PROPOSED HMA PAVEMENT FOR EACH STAGE. STORM SEWER PIPES THAT EXTEND ACROSS SUB-STAGES SHALL BE PLACED TO THE LIMITS POSSIBLE IN EACH SUB-STAGE AND COMPLETED PRIOR TO COMMENCING WITH THE NEXT SUB-STAGE UNLESS OTHERWISE APPROVED BY THE ENGINEER. SHORT TERM LANE CLOSURES, SUCH AS IDOT STANDARD DRAWING 701602, SHALL BE USED TO COMPLETE THE CONNECTION OF THE PROPOSED STORM SEWER PIPES TO THE EXISTING STORM SEWER SYSTEM. ONE 11-FOOT LANE MUST BE MAINTAINED IN EACH DIRECTION AT ALL TIMES EXCEPT AS NOTED IN THE MAINTENANCE OF TRAFFIC PLANS.
- THE CONTRACTOR SHALL COORDINATE WITH THE GREATER ROCKFORD MASS TRANSIT DISTRICT TO ASSURE THAT PROPER BUS STOP SIGNING IS PLACED BY THE DISTRICT FOR EACH STAGE OF THE PROJECT.

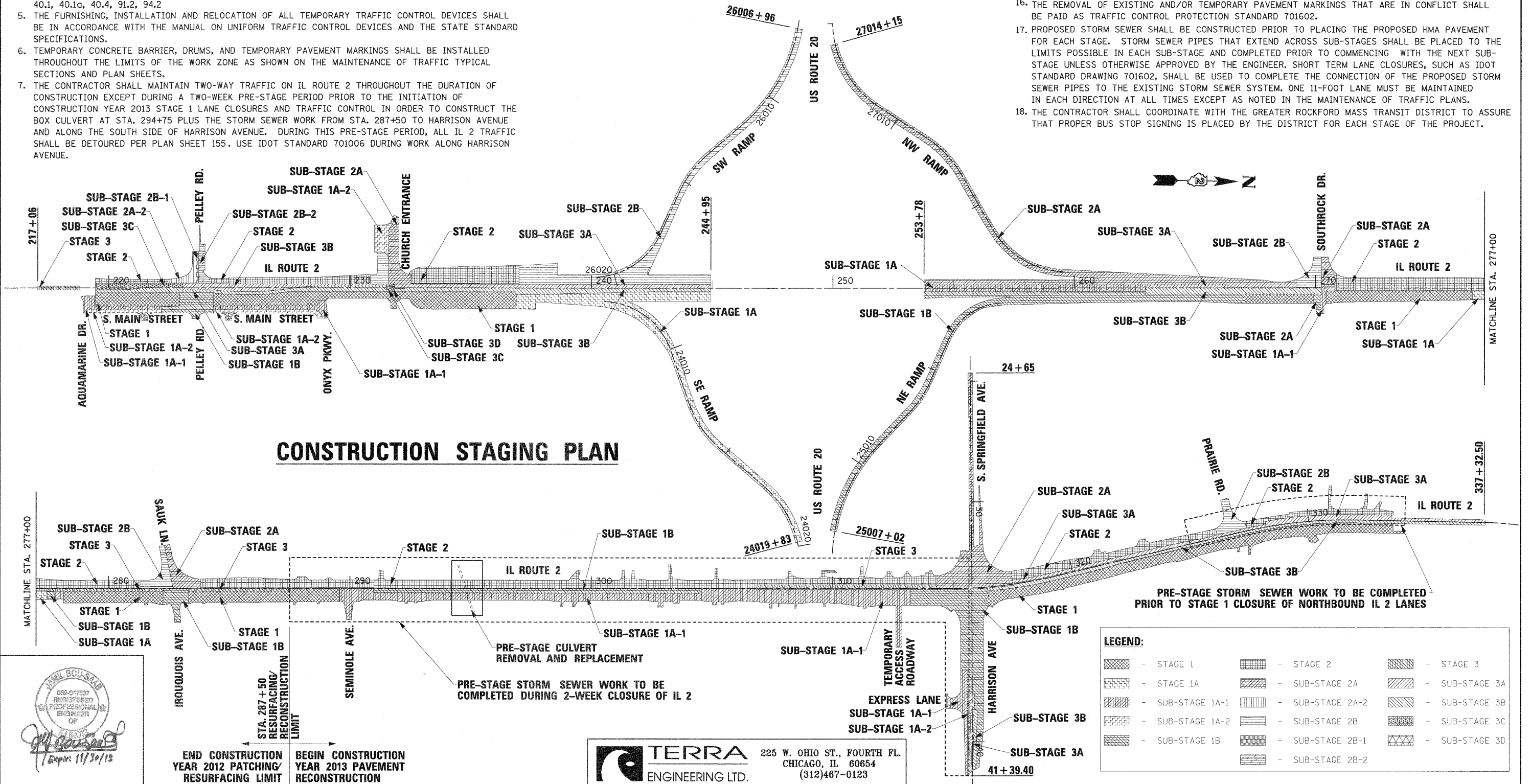

## CONSTRUCTION STAGING PLAN

**PROFESSIONAL ENGINEER**  
 082-047237  
 REGISTERED PROFESSIONAL ENGINEER OF ILLINOIS  
 [Signature]  
 Exp: 11/30/13

END CONSTRUCTION YEAR 2012 PATCHING/RESURFACING LIMIT  
 BEGIN CONSTRUCTION YEAR 2013 PAVEMENT RECONSTRUCTION

**TERRA ENGINEERING LTD.**  
 225 W. OHIO ST., FOURTH FL.  
 CHICAGO, IL 60654  
 (312)467-0123

STATE OF ILLINOIS  
 DEPARTMENT OF TRANSPORTATION

MAINTENANCE OF TRAFFIC  
 GENERAL NOTES & STAGING SCHEMATIC

F.A. RTE.	SECTION	COUNTY	TOTAL SHEETS	SHEET NO.
742	34R	WINNEBAGO	491	90
CONTRACT NO. 64515				
ILLINOIS FED. AID PROJECT				

FILE NAME = D201502-sht-staging01.dgn  
 USER NAME = TERRA  
 DESIGNED - BCB  
 DRAWN - CBC  
 CHECKED - DPA  
 DATE - 01/17/12

DESIGNED	REVIS
BCB	-
CBC	-
DPA	-
01/17/12	-

SCALE: SHEET NO. OF SHEETS STA. TO STA.