

ROAD CONSTRUCTION AHEAD  
 W20-I103(0)-48 W3-2(0)-48  
 STA 26009+50 STA 20014+50

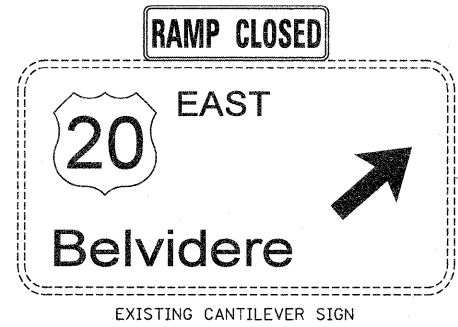
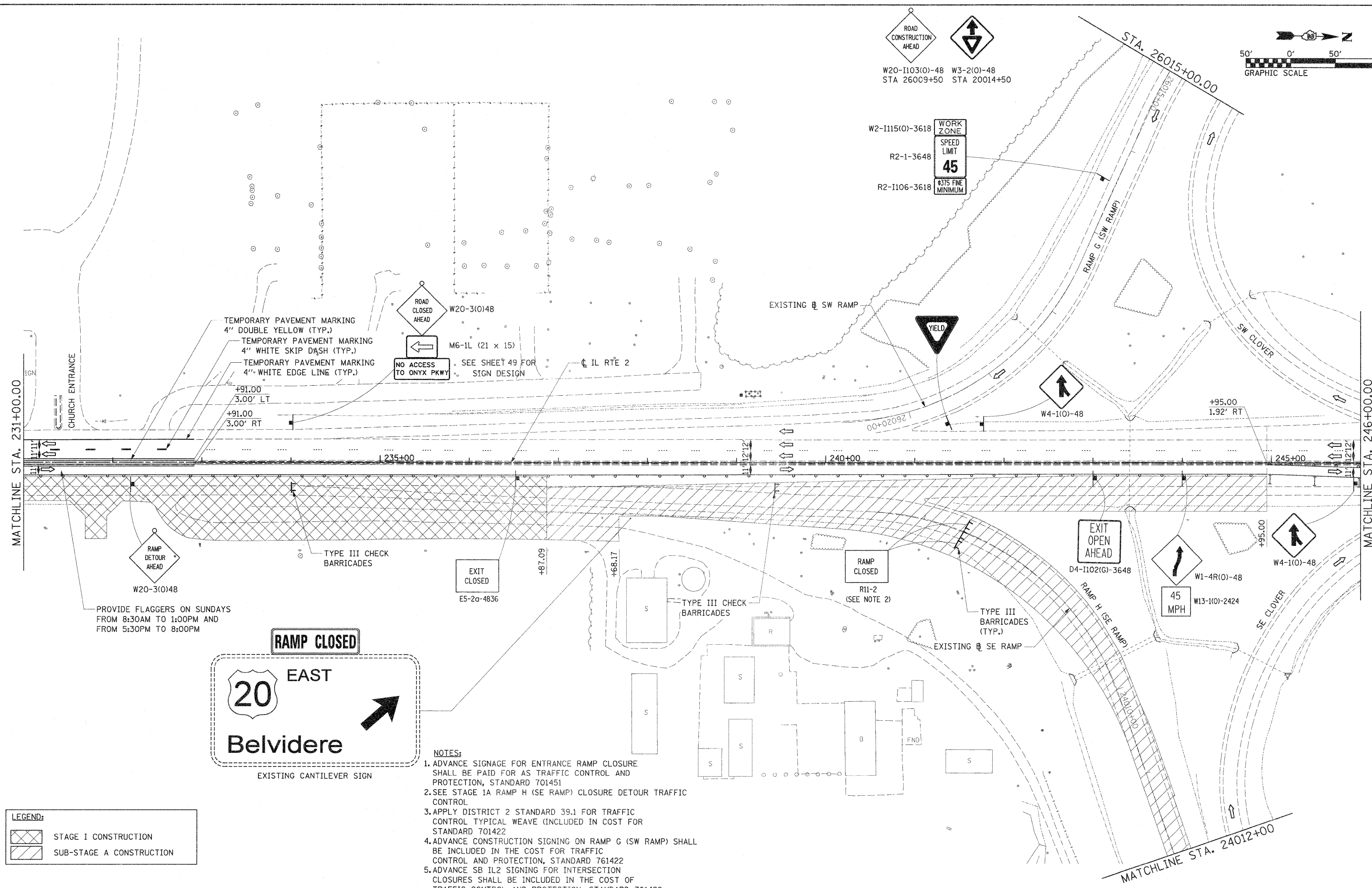
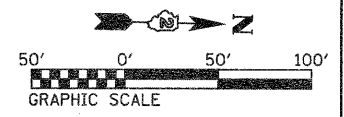

- NOTES:**
1. ADVANCE SIGNAGE FOR ENTRANCE RAMP CLOSURE SHALL BE PAID FOR AS TRAFFIC CONTROL AND PROTECTION, STANDARD 701451
  2. SEE STAGE 1A RAMP H (SE RAMP) CLOSURE DETOUR TRAFFIC CONTROL
  3. APPLY DISTRICT 2 STANDARD 39.1 FOR TRAFFIC CONTROL TYPICAL WEAVE (INCLUDED IN COST FOR STANDARD 701422)
  4. ADVANCE CONSTRUCTION SIGNING ON RAMP G (SW RAMP) SHALL BE INCLUDED IN THE COST FOR TRAFFIC CONTROL AND PROTECTION, STANDARD 761422
  5. ADVANCE SB IL2 SIGNING FOR INTERSECTION CLOSURES SHALL BE INCLUDED IN THE COST OF TRAFFIC CONTROL AND PROTECTION, STANDARD 701422

**LEGEND:**

	STAGE I CONSTRUCTION
	SUB-STAGE A CONSTRUCTION

FILE NAME = 0201500-ah-t-staging04.dgn	USER NAME = TERRA	DESIGNED - BCB	REVISED -	<b>STATE OF ILLINOIS DEPARTMENT OF TRANSPORTATION</b>	<b>MAINTENANCE OF TRAFFIC PLAN STAGE I AND SUB-STAGE A</b>			F.A. RTE. 742	SECTION 34R	COUNTY WINNEBAGO	TOTAL SHEETS 491	SHEET NO. 112
	PLOT SCALE = 50.0000' / IN.	DRAWN - CBC	REVISED -		SCALE: 1" = 50'	SHEET NO. 2 OF 10 SHEETS	STA. 231+00.00 TO STA. 246+00.00	CONTRACT NO. 64515		ILLINOIS FED. AID PROJECT		
	PLOT DATE = 1/16/2012	CHECKED - DPA	REVISED -									
		DATE - 01/17/12	REVISED -									