

DATE	
BY	
REVISIONS	
NO.	
DESCRIPTION	
DATE	
BY	
NO.	
DESCRIPTION	
DATE	
BY	
NO.	
DESCRIPTION	

DATE	
BY	
REVISIONS	
NO.	
DESCRIPTION	
DATE	
BY	
NO.	
DESCRIPTION	
DATE	
BY	
NO.	
DESCRIPTION	

- NOTE:
- CONTRACTOR SHALL HAVE OPTION OF PLACING STANDARD MANHOLES IN LIEU OF FLAT SLAB TOPS WHERE CONDITIONS PERMIT.
  - RIM ELEVATIONS & OFFSETS FOR DRAINAGE STRUCTURES CONSTRUCTED IN CONJUNCTION WITH GUTTER OR CURB & GUTTER ARE CALLED OUT TO THE EDGE OF PAVEMENT. ALL OTHER DRAINAGE STRUCTURES ARE CALLED OUT TO THE CENTER OF STRUCTURE.
  - WHERE PROPOSED DRAINAGE STRUCTURES ARE TO BE CONNECTED TO EXISTING STORM SEWERS AND PIPE CULVERTS, THE COST FOR PROVIDING THE CONNECTION SHALL BE INCLUDED IN THE COST OF THE ASSOCIATED DRAINAGE STRUCTURE PAY ITEMS.

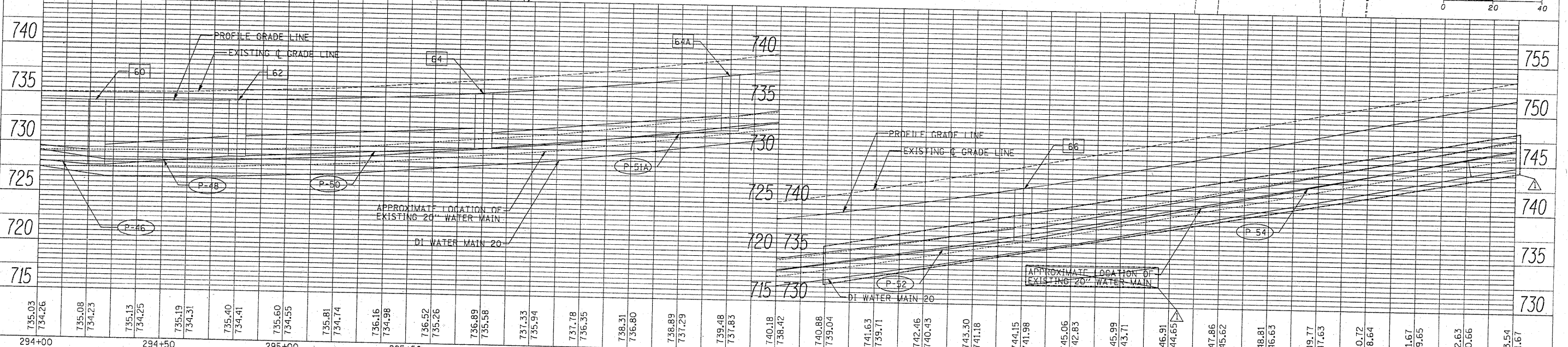
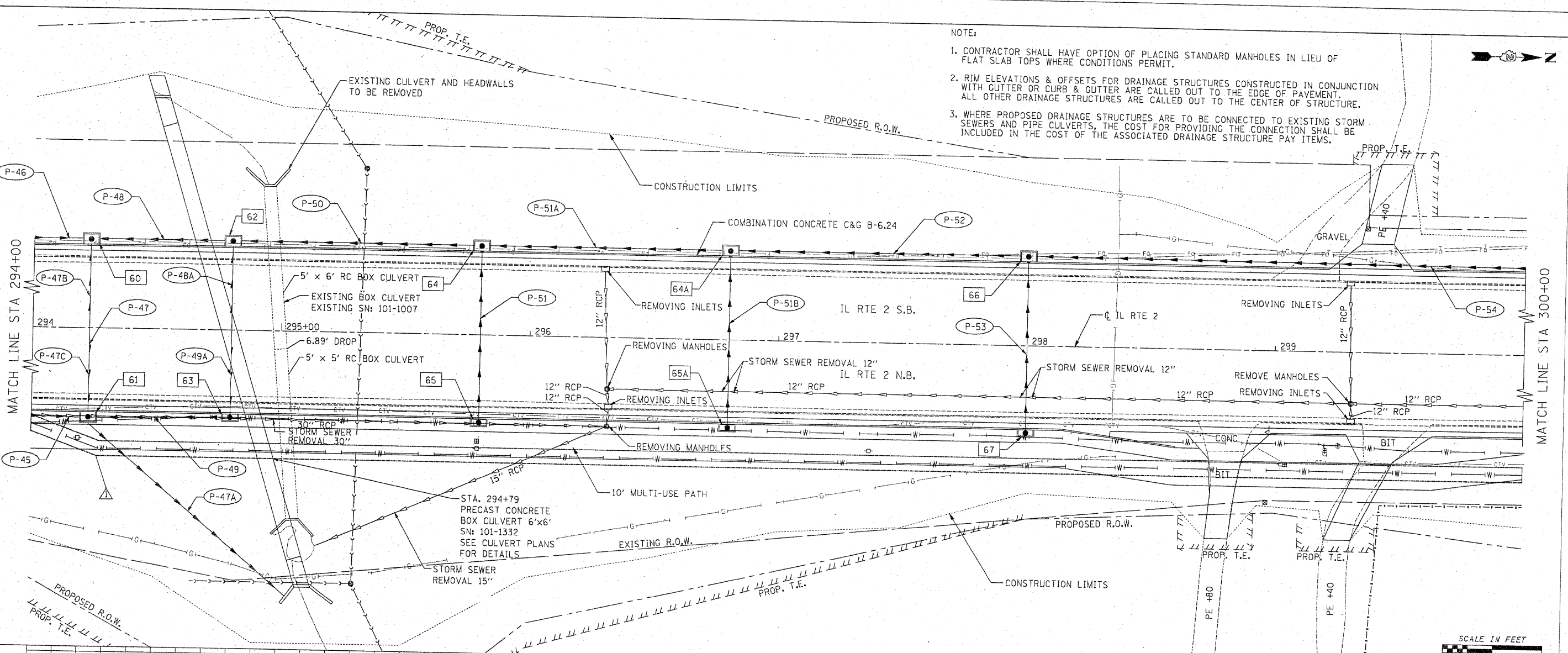

FILE NAME =	USER NAME = Plotted by Fred 576	DESIGNED - GE	REVISIONS - 03/26/2012	STATE OF ILLINOIS DEPARTMENT OF TRANSPORTATION		FAP 742 (IL 2) PROPOSED DRAINAGE PLAN AND PROFILE		F.A.P. RTE. 742	SECTION 34R	COUNTY WINNEBAGO	TOTAL SHEETS 491	SHEET NO. 207	CONTRACT NO. 64515
EX11823A\Plan Sheets\LPDP 14.dgn		DRAWN - GE		SCALE: 1" = 20'		SHEET NO. 14 OF 30 SHEETS		STA. 294+00	TO STA. 300+00	ILLINOIS FED. AID PROJECT			
		CHECKED - SL											
		DATE - 05/2011											