

NOTE:

1. CONTRACTOR SHALL HAVE OPTION OF PLACING STANDARD MANHOLES IN LIEU OF FLAT SLAB TOPS WHERE CONDITIONS PERMIT.
2. RIM ELEVATIONS & OFFSETS FOR DRAINAGE STRUCTURES CONSTRUCTED IN CONJUNCTION WITH GUTTER OR CURB & GUTTER ARE CALLED OUT TO THE EDGE OF PAVEMENT. ALL OTHER DRAINAGE STRUCTURES ARE CALLED OUT TO THE CENTER OF STRUCTURE.
3. WHERE PROPOSED DRAINAGE STRUCTURES ARE TO BE CONNECTED TO EXISTING STORM SEWERS AND PIPE CULVERTS, THE COST FOR PROVIDING THE CONNECTION SHALL BE INCLUDED IN THE COST OF THE ASSOCIATED DRAINAGE STRUCTURE PAY ITEMS.

PLAN	SURVEYED	BY	DATE
	DESIGNED		
	CHECKED		
	IN CHARGE		
	NO. OF MAY CHECKED		
	CADD FILE NAME		

PROFILE	SURVEYED	BY	DATE
	DESIGNED		
	CHECKED		
	IN CHARGE		
	NO. OF MAY CHECKED		
	STRUCTURE NOTATIONS CHKD		

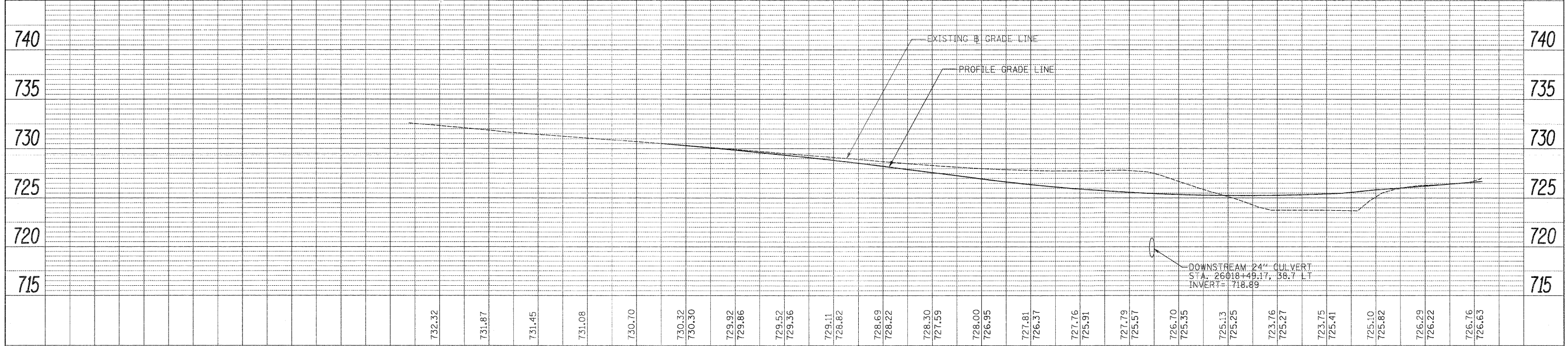
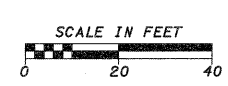
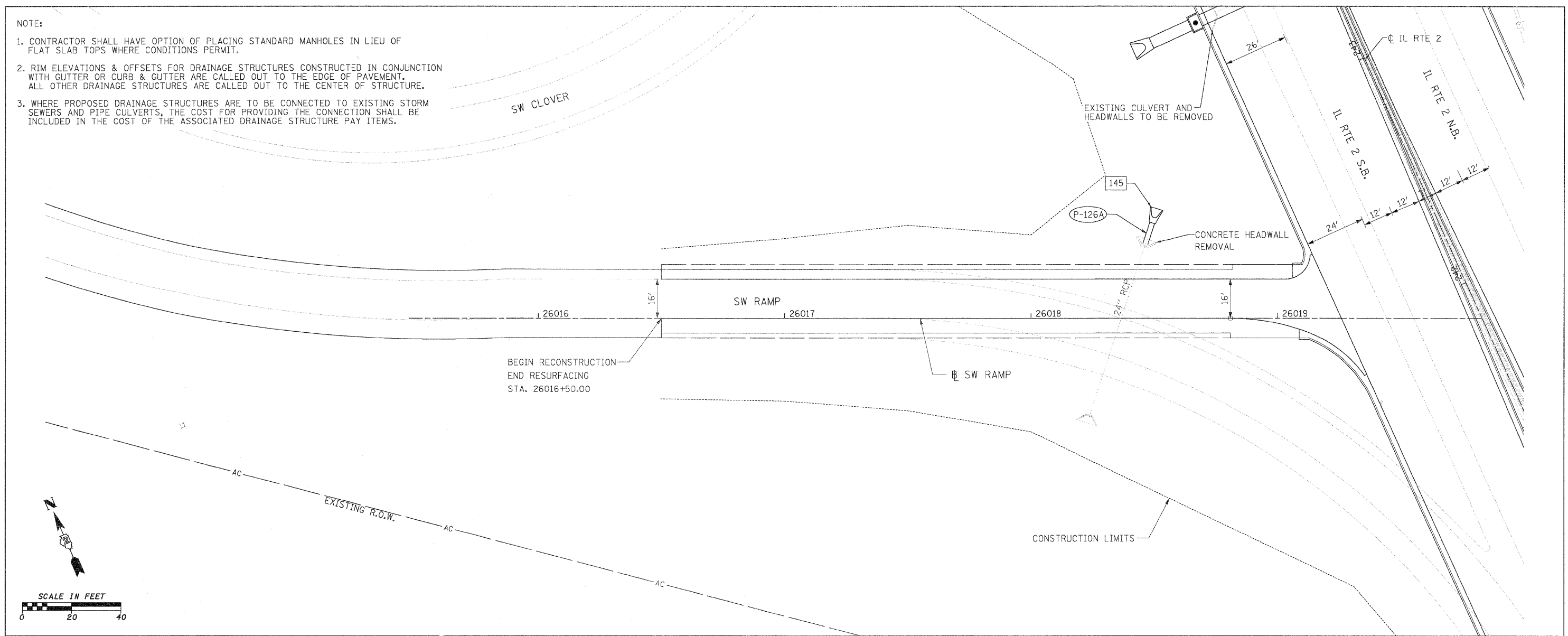

FILE NAME =	USER NAME = *USER*	DESIGNED - GE	REVISED -	STATE OF ILLINOIS DEPARTMENT OF TRANSPORTATION	SW RAMP PROPOSED DRAINAGE PLAN AND PROFILE	F.A.P. RTE. 742	SECTION 34R	COUNTY WINNEBAGO	TOTAL SHEETS 491	SHEET NO. 216		
FILE#	PLOT SCALE = *SCALE*	DRAWN - GE	REVISED -			SCALE: 1" = 20'	SHEET NO. 23 OF 30 SHEETS	STA. 26015+50	TO STA. 26019+50	CONTRACT NO. 64515		
	PLOT DATE = *DATE*	CHECKED - SL	REVISED -			ILLINOIS FED. AID PROJECT						
		DATE - 05/2011	REVISED -									