

| LEGEND | |
|-----------------------------------|--|
| PROPOSED SIGNAL HEAD W/ BACKPLATE | |
| PROPOSED SIGNAL HEAD | |
| PROPOSED HANDHOLE | |
| PROPOSED DOUBLE HANDHOLE | |
| PROPOSED CONTROLLER | |
| PROPOSED PED. PUSHBUTTON DETECTOR | |
| PROPOSED SIGNAL POST | |
| PROPOSED PED. SIGNAL HEAD | |
| EXISTING TRAFFIC SIGNAL | |
| PROPOSED LIGHTING CONDUIT | |
| EXISTING HANDHOLE | |
| EXISTING DOUBLE HANDHOLE | |

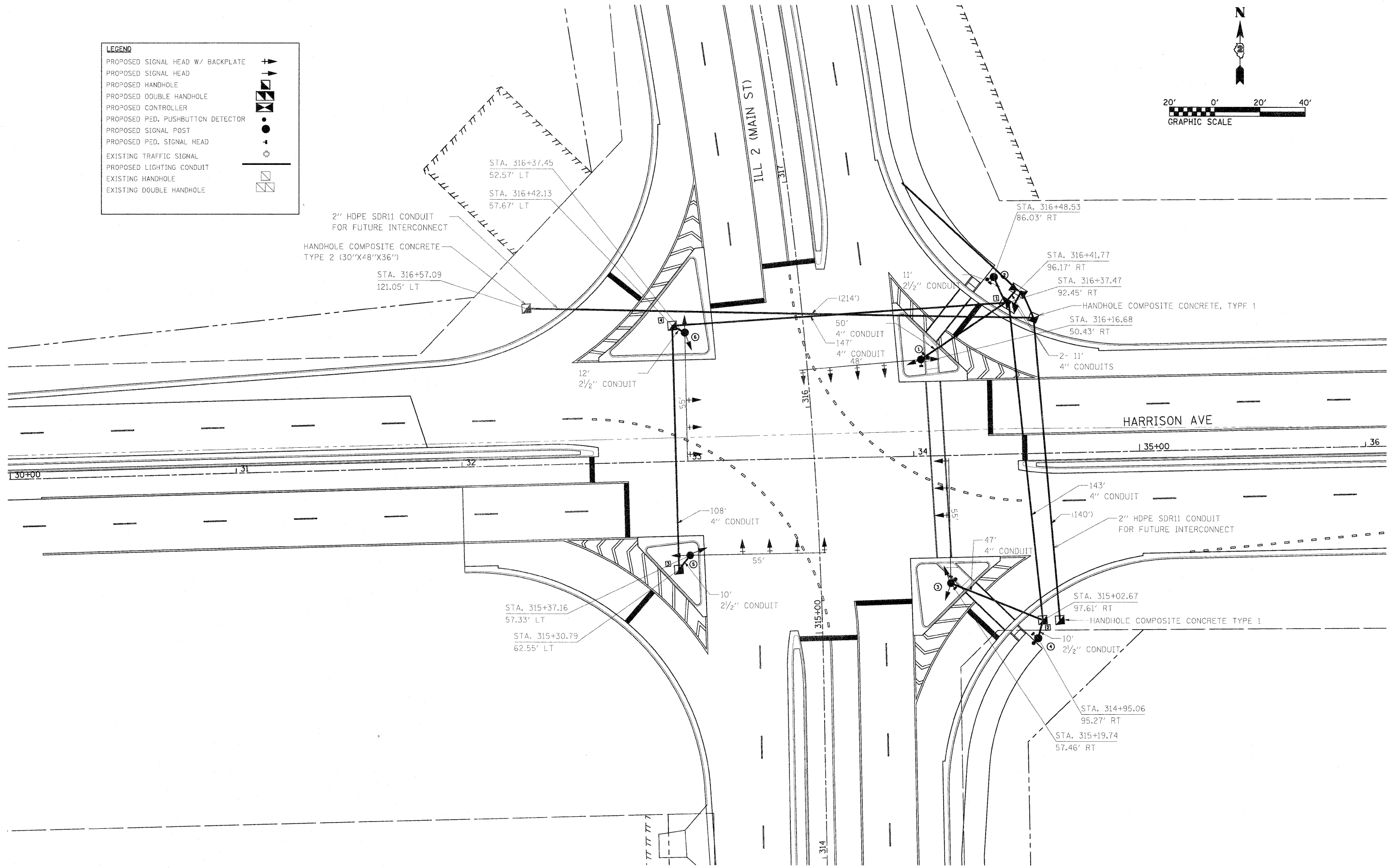
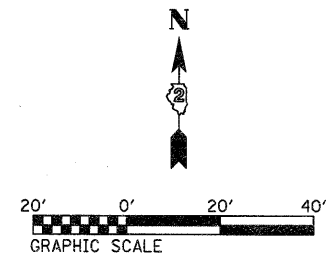

FILE NAME = 0201500-sh1-ta02.dgn
 USER NAME = TERRA
 PLOT SCALE = 20.0000' / IN.
 PLOT DATE = 2/24/2012

DESIGNED - MCH
 DRAWN - MCH
 CHECKED - DPA
 DATE - 01/17/12

REVISED -
 REVISED -
 REVISED -
 REVISED -

**STATE OF ILLINOIS
 DEPARTMENT OF TRANSPORTATION**

**TRAFFIC SIGNAL INSTALLATION PLAN
 IL ROUTE 2 AND HARRISON AVENUE**

SCALE: 1" = 20' SHEET NO. 1 OF 5 SHEETS STA. TO STA.

| F.A. RTE. | SECTION | COUNTY | TOTAL SHEETS | SHEET NO. |
|---------------------------|---------|-----------|--------------|-----------|
| 742 | 34R | WINNEBAGO | 491 | 296 |
| CONTRACT NO. 64515 | | | | |
| ILLINOIS FED. AID PROJECT | | | | |