

BY	DATE
SURVEYED	
PLOTTED	
REVISIONS	
NOTE BOOK	
AREAS CHECKED	
NO.	

BY	DATE
SURVEYED	
PLOTTED	
REVISIONS	
NOTE BOOK	
AREAS CHECKED	
NO.	

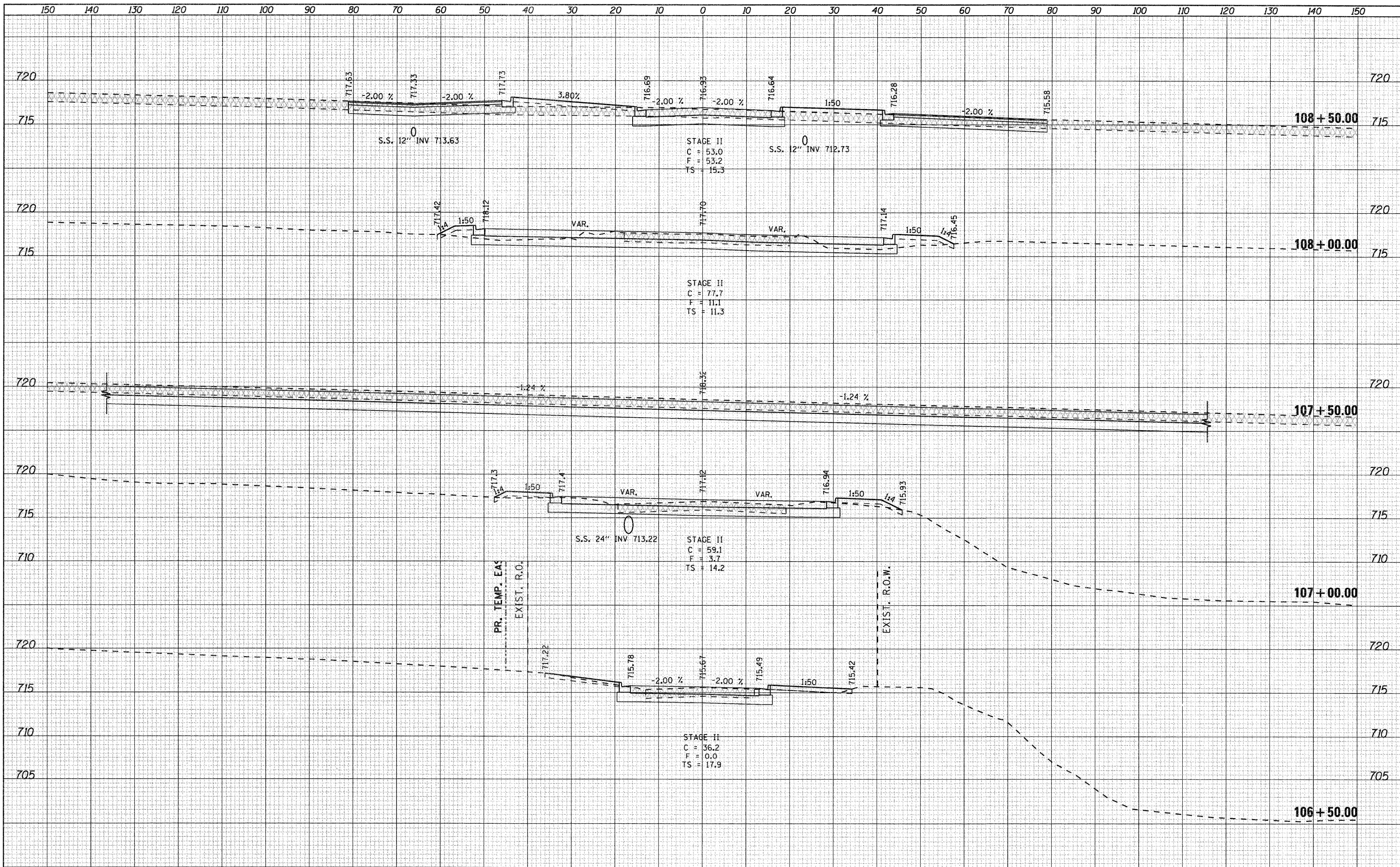

FILE NAME = g:\2010\trans\bl02001\dgn\cross sections\001500	USER NAME = pats	DESIGNED -	REVISED -	STATE OF ILLINOIS DEPARTMENT OF TRANSPORTATION	FAP 742 (IL 2) PELLEY ROAD	F.A.P. RTE. = 742	SECTION = 34R	COUNTY = WINNEBAGO	TOTAL SHEETS = 491	SHEET NO. = 465	
PLOT SCALE = 10.0000' / IN.	PLOT DATE = 1/23/2012	DRAWN -	REVISED -			SCALE:	SHEET NO. OF SHEETS	STA. 106+50.00 TO STA. 109+00.00	CONTRACT NO. 64515		ILLINOIS FED. AID PROJECT
		CHECKED -	REVISED -								
		DATE -	REVISED -								