

DATE	
BY	
REVIEWED	
APPROVED	
ALIGNMENT CHECKED	
GRADES CHECKED	
NOTE BOOK NO.	
FILE NAME	

DATE	
BY	
REVIEWED	
APPROVED	
GRADES CHECKED	
NOTE BOOK NO.	
FILE NAME	

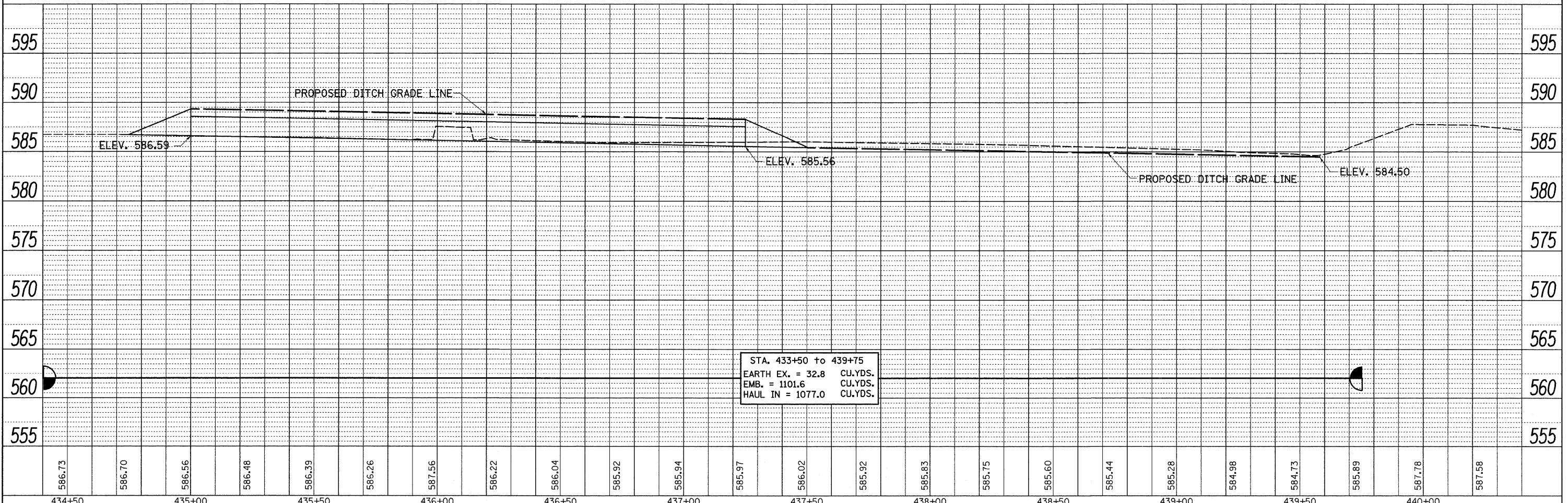
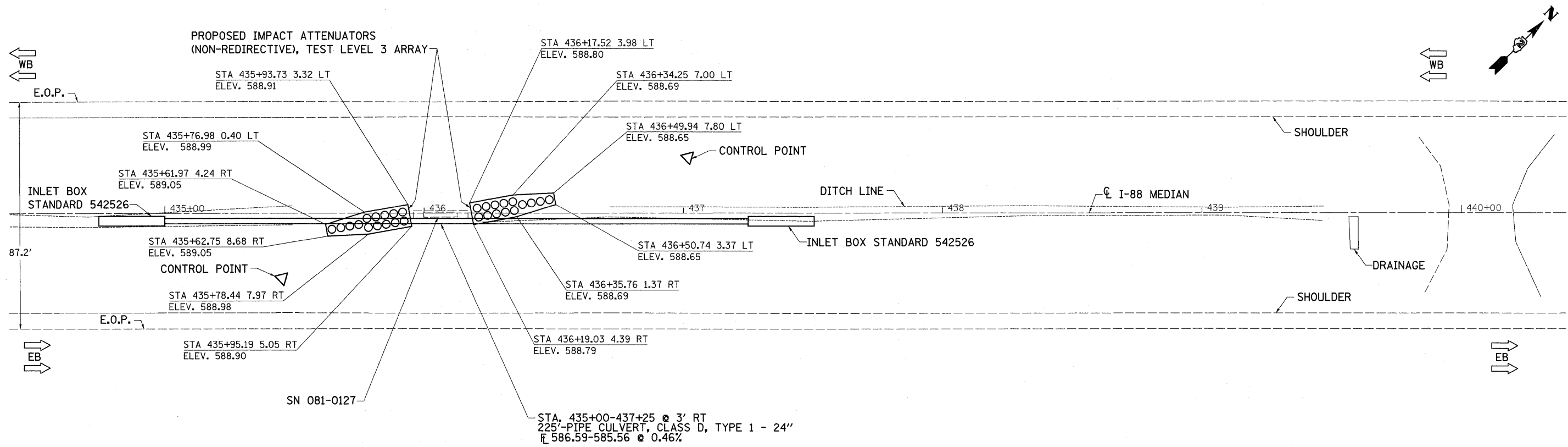

STA. 433+50 to 439+75
 EARTH EX. = 32.8 CU.YDS.
 EMB. = 1101.6 CU.YDS.
 HAUL IN = 1077.0 CU.YDS.

FILE NAME =	USER NAME = ankneyde	DESIGNED -	REVISED -	STATE OF ILLINOIS DEPARTMENT OF TRANSPORTATION	I-88 PLAN & PROFILE	F.A.I. RTE.	SECTION	COUNTY	TOTAL SHEETS	SHEET NO.
ct:\pw\work\pwsdot\ankneyde\d0292974\0205212-sht-plnprf.dgn	DRAWN -	REVISED -	*			D2 SAFETY 2012-2	**	151	45	
PLOT SCALE = 20.0000' / 1"	CHECKED -	REVISED -	CONTRACT NO. 64H77							
PLOT DATE = Tue May 01 07:09:55 2012	DATE -	REVISED -	ILLINOIS FED. AID PROJECT							
SCALE:		SHEET OF SHEETS		STA. TO STA.		ILLINOIS FED. AID PROJECT				