

F.A.I. RTE.	SECTION	COUNTY	TOTAL SHEETS	SHEET NO.
80	D3 FENCE REPAIR 2012-1	LASALLE	7	1
		ILLINOIS	CONTRACT NO. 66B69	

**INDEX OF SHEETS**

1. COVER SHEET
2. GENERAL NOTES
3. SUMMARY OF QUANTITIES
4. SITE PLAN FOR BRIDGE MAINTENANCE HEADQUARTERS
- 5 - 7. CHAIN LINK FENCE DETAILS

**STANDARDS**

- 000001-06 STANDARD SYMBOLS, ABBREVIATIONS AND PATTERNS
- 701001-02 OFF-ROAD OPERATIONS 2L, 2W, MORE THAN 15' (4.5 m) AWAY
- 701006-03 OFF-ROAD OPERATIONS 2L, 2W, 15' (4.5 m) TO 24" (600 mm) FROM PAVEMENT EDGE
- 701901-02 TRAFFIC CONTROL DEVICES

**STATE OF ILLINOIS**  
**DEPARTMENT OF TRANSPORTATION**  
**DIVISION OF HIGHWAYS**

**PROPOSED**  
**HIGHWAY PLANS**

**FAI 80 (I-80)**  
**SECTION D3 FENCE REPAIR 2012-1**

**FURNISHING AND INSTALLING SECURITY FENCE**  
**LASALLE COUNTY**  
 C-93-018-12

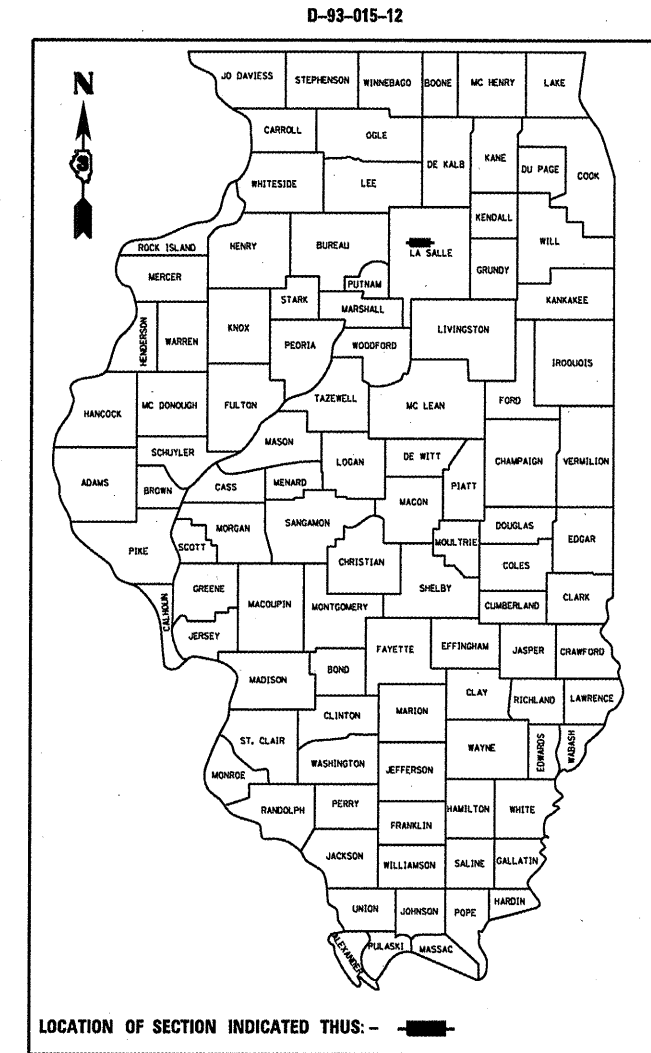

**PROJECT LOCATION**  
**DISTRICT 3**  
**BRIDGE MAINTENANCE HEADQUARTERS**

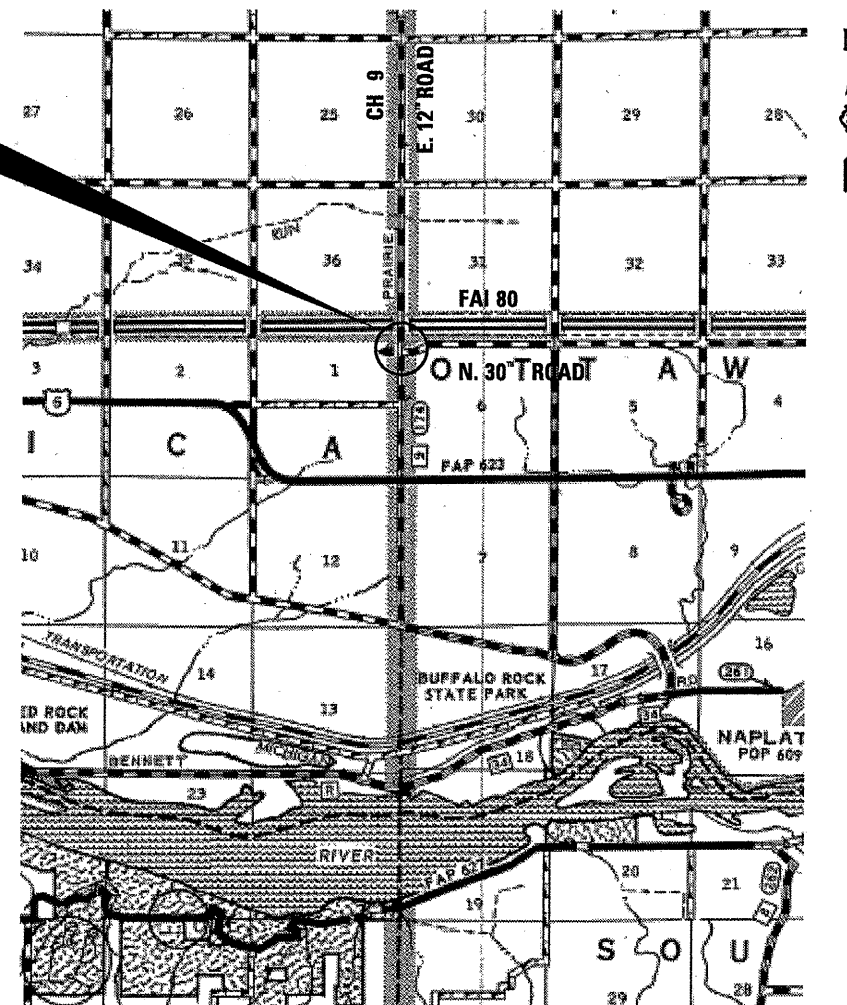

POINT LOCATION

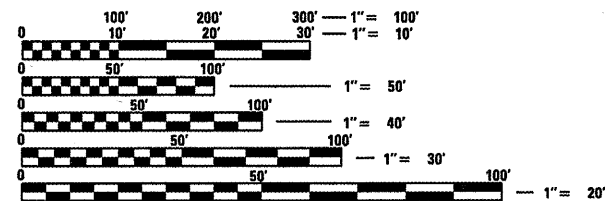

FULL SIZE PLANS HAVE BEEN PREPARED USING STANDARD ENGINEERING SCALES. REDUCED SIZED PLANS WILL NOT CONFORM TO STANDARD SCALES. IN MAKING MEASUREMENTS ON REDUCED PLANS, THE ABOVE SCALES MAY BE USED.

J.U.L.I.E.  
 JOINT UTILITY LOCATION INFORMATION FOR EXCAVATION  
 1-800-892-0123  
 OR 811

**DISTRICT 3 NO. 815-434-6131**  
**PROJECT ENGINEER: JOE KANNEL P.E.**  
**UNIT CHIEF: RON WOODSHANK**  
**TOWNSHIP: UTICA AND OTTAWA**

**CONTRACT NO. 66B69**

STATE OF ILLINOIS  
 DEPARTMENT OF TRANSPORTATION  
 DIVISION OF HIGHWAYS

SUBMITTED 3-30 2012  
*Eric S. Therkelsen*  
 DEPUTY DIRECTOR OF HIGHWAYS, REGION ENGINEER

May 11 2012  
*John D. Baranzelli, P.E.*  
 ENGINEER OF DESIGN AND ENVIRONMENT

May 2012  
*William R. Frey*  
 DIRECTOR OF HIGHWAYS, CHIEF ENGINEER

**PRINTED BY THE AUTHORITY**  
**OF THE STATE OF ILLINOIS**